

LET ALBUQUERQUE

CHANGE YOUR PERSPECTIVE

ON MEETINGS 



THE SOUTHWEST'S PREMIER MEETING FACILITY

Planning an event at the Albuquerque Convention Center is a decision to embolden attendees with a panoramic view that inspires fresh perspectives and new ideas – **the Albuquerque Convention Center is uniquely unconventional.**

The Albuquerque Convention Center is a flexible, multi-purpose event center located in the heart of a vibrant downtown between the Sandia Mountains and the Rio Grande.

With over 270,000 sq. ft. of meeting and exhibit space, the convention center comprises two complexes housed under one roof—making it the ideal facility to host your next meeting, tradeshow, convention, banquet or concert. The professional event staff is at your service to ensure that your event runs smoothly.

SMG, the world leader of public facility management, proudly provides food and beverage services exclusively for the Albuquerque Convention Center and its Kiva Auditorium. SMG's food and beverage expertise extends from elegantly catered events for up to 6,000 guests to thematic portable food carts and permanent concession stands designed to create a memorable experience for visitors.

Alliance Audio Visual is the preferred in-house audio visual provider at the convention center and has received rave reviews from local and national hotel management groups, corporations and professional organizations.

Just minutes away from the Albuquerque International Sunport and within steps of many hotels and restaurants, the Albuquerque Convention Center is the Southwest's premier meeting facility.



VISITABQ.ORG/MEET



@MeetABQ

. V I S I T .

ALBUQUERQUE

CHANGE YOUR PERSPECTIVE

CONTACT:
Meet@VisitABQ.org
800.733.9918

©Michael Barley

©Howard Harley

ALBUQUERQUE CONVENTION CENTER



» MEET THE NEW ALBUQUERQUE CONVENTION CENTER

A major destination hospitality investment boasting a \$25 million update to the SMG-managed Albuquerque Convention Center where you'll find state-of-the-art facilities, equipment and top-of-the-line service. This beautifully designed complex represents the unique splendor and architecture of the region.

Upgrades Include:

- New territorial-style portal façade
- Massive windows with panoramic views
- Impressive three-story fireplace in the West Building Lower Level atrium
- New ballroom outdoor entertainment balcony
- A complete renovation of West Building Upper Level ballrooms
- Installation of a new service corridor and service elevator for the ballrooms
- West Building Lower Level kitchen renovation including food service equipment
- Exhibit hall refresh with new airwalls



VISITABQ.ORG/MEET



@MeetABQ

.VISIT.

ALBUQUERQUE

CHANGE YOUR PERSPECTIVE

CONTACT:
Meet@VisitABQ.org
800.733.9918

ALBUQUERQUE CONVENTION CENTER FLOOR PLAN

UPPER LEVEL

WEST BUILDING

- Kiva Auditorium
 - » Box Office
 - » Concessions
 - » Kiva Boardroom

Ballroom A, B, C

- » Buena Vista Balcony
- Overlooks Civic Plaza

Skybridge to East Building

EAST BUILDING

Meeting Room 210–240

Suite A–H

Convention Center Parking

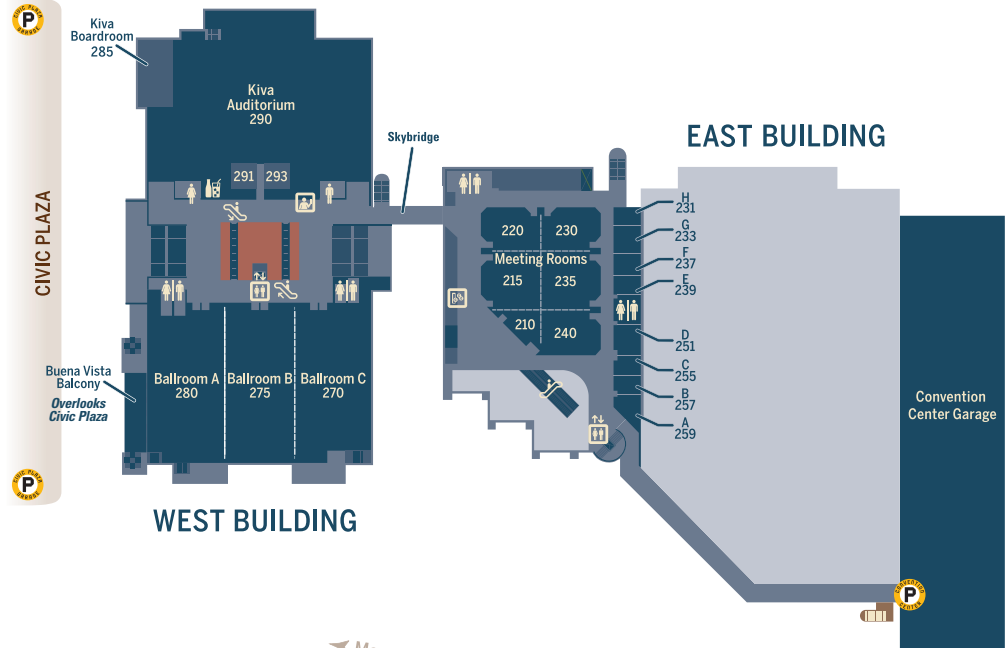

MAIN LEVEL

WEST BUILDING

Hall 3 & 4

Guest Services

Civic Plaza Outdoor Event Space

2nd Street Entrance

EAST BUILDING

Hall 1 & 2

Meeting Room 110–140

Zia Lounge 113

Box Office

2nd Street Entrance

Tijeras Boulevard Entrance

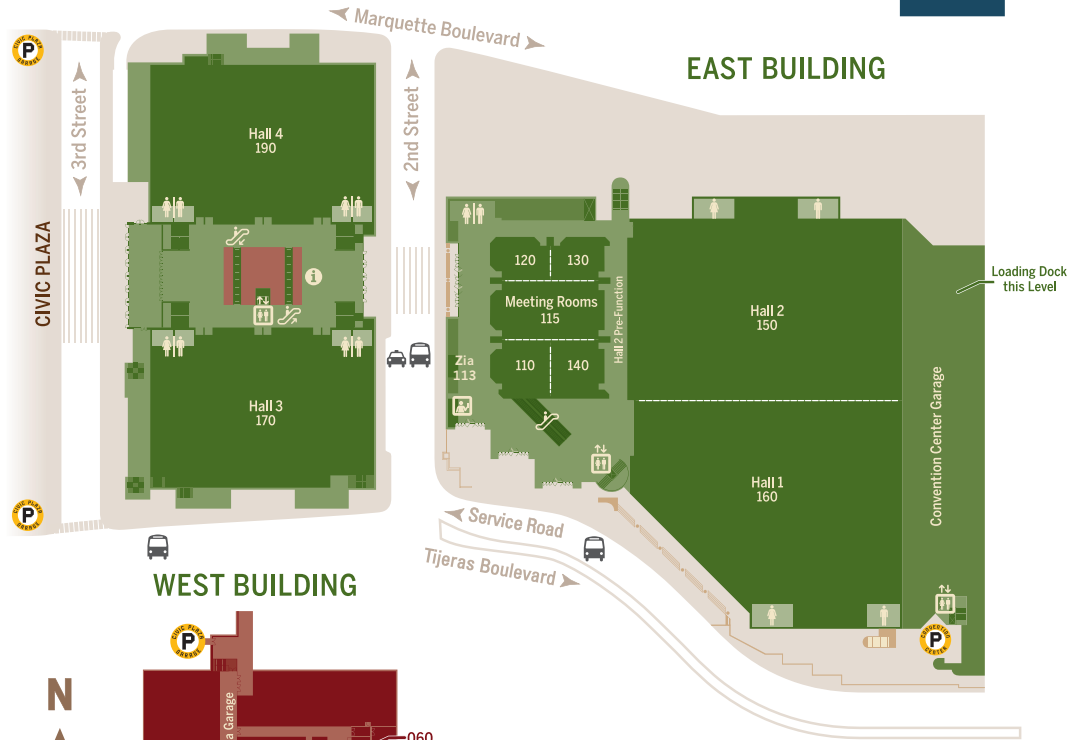

LOWER LEVEL

WEST BUILDING

Conference Center

The Hub 055

La Sala (Lounge)

Civic Plaza Parking

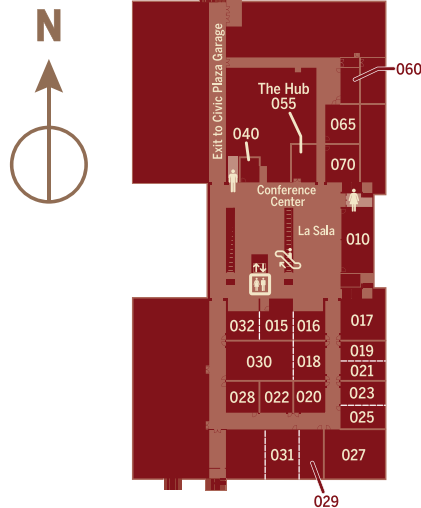

LEGEND

- Box Office
- Concessions
- Elevator
- Escalator
- Guest Services
- Parking
- Pick-up & Drop-off
- Restroom
- Vending

All areas of the Albuquerque Convention Center are accessible to people with mobility impairments.



Worldwide Entertainment and Conference Venue Management

WEST BUILDING

MEETING ROOM INFORMATION AND FEATURES

ROOM # AND ROOM NAME	ROOM DIMENSIONS		ROOM CAPACITIES			EXHIBIT CAPACITIES
	SQUARE FEET	SIZE(FT)	THEATER/ RECEPTION	CLASSROOM STYLE	BANQUET SEATING	10'X10' BOOTHS

UPPER LEVEL | MEETING ROOMS, SUPPORT ROOMS, BALLROOMS, AUDITORIUM

EAST MEETING ROOMS Ceiling Height 12'							UPPER EAST LOBBY - 3,400 SQ. FT.	
210 Tijeras	728	48 x 36 x 32	48	30	48			
215 San Miguel •	2,940	49 x 60	242	162	160			
220 Ruidoso •	2,156	49 x 44	130	81	120			
230 Pecos •	2,156	49 x 44	130	81	120			
235 Mesilla •	2,940	49 x 60	242	162	160			
240 La Cienega	2,205	49 x 45	162	93	140			
Combined •	10,192	98 x 104	794	486	480			

EAST SUPPORT ROOMS Ceiling Height 9'10"								
Hall 1 Show Offices								
Suite A/B	560	20 x 28	40	32	30			
Suite C	300	20 x 15	20	18	20			
Hall 2 Show Offices								
Suite D	460	20 x 23	30	20	40			
Suite E/F	860	20 x 43	80	40	60			
Suite G (Has Restroom)	460	20 x 23	30	20	40			
Suite H (Has Restroom)	243	Triangle						

WEST BALLROOMS Ceiling Height 15'11"		UPPER WEST LOBBY - 3,400 SQ. FT.		BUENA VISTA BALCONY: 1,974 SQ. FT. 21X94		
Ballroom A/Balcony	9,996	68 x 147	642	408	460	
Ballroom B	8,880	60 x 147	300	300	320	
Ballroom C	12,348	84 x 147	801	544	550	
Combined Ballrooms	31,164	211 x 147	2,400	1,360	1,910	

WEST KIVA AUDITORIUM Angle Opera Seating for 2,300						
285 Kiva Boardroom (Credenza, LCD)			FIXED SEATING FOR 18 PEOPLE			
291 Pima Press Room	380	19 x 20	40	24	30	
293 Maya Conference Room	532	19 x 28	40	32	40	

MAIN LEVEL | MEETING ROOMS, EXHIBIT HALLS LOBBY - 4,600 SQ. FT.

EAST MEETING ROOMS Ceiling Height 13'						
110 Galisteo	2,450	50 x 49	180	114	160	
115 Brazos	5,880	60 x 98	462	234	380	
120 Doña Ana	1,715	35 x 49	138	75	110	
130 Cimarron	1,715	35 x 49	138	75	110	
140 Aztec	2,450	50 x 49	180	114	160	
Total Combined	14,210	98 x 145	1,155	648	910	
113 Zia Lounge/Office	300	11 x 27				

EXHIBIT HALLS Pre-function Space 5,040 Square Feet, 140' x 36'						
Hall 1 & 2 Ceiling Height 30' Floor to Truss, 17' Additional to Roof Hall 3 Ceiling Height 20' Hall 4 Ceiling Height 16'-20'						
East Hall 1	57,600	270 x 240	5,170	2,604	3,450	266
East Hall 2	48,600	270 x 180	3,262	1,842	3,080	233
Hall 1 & 2 Combined	106,200	270 x 420	9,048	4,566	7,178	503
West Hall 3	30,173	143 x 211	-	-	-	144
West Hall 4	30,173	143 x 211	-	-	-	144

WEST LOWER LEVEL | MEETING ROOMS LOBBY - 3,400 SQ. FT.

La Sala Lobby	7,600					
La Sala Lounge	1200					
MEETING ROOMS Ceiling Height 10'						
10 Anasazi	1,600	32 x 50	101	72	80	
15 Zuni	875	35 x 25	58	32	50	
16 Acoma	1,064	28 x 38	71	40	60	
17 Apache	980	35 x 28	49	48	32	
18 Cochiti	1,520	38 x 40	101	72	80	
19 Isleta	700	35 x 20	47	32	40	
20 Laguna	972	27 x 36	65	48	60	
21 Jemez	665	35 x 19	44	32	40	
22 San Juan	567	31 x 27	63	43	40	
23 Nambé	630	35 x 18	42	32	40	
25 Navajo	630	35 x 18	42	32	40	
27 Picuris	2,000	40 x 50	133	100	120	
28 Santo Domingo	837	27 x 31	56	40	50	
29 Sandia	880	40 x 22	58	40	50	
30 Taos	2,128	38 x 56	142	120	120	
31 Santa Ana	1,280	40 x 32	85	60	80	
32 Tesuque	924	28 x 33	62	40	60	
60 Chaco	680	20 x 34	56	32	30	
65 Hopi	864	32 x 27	70	36	50	
70 Tewa	899	31 x 29	70	36	50	
COMBINED						
16 Acoma, 32 Tesuque, 15 Zuni	2,863	28 x 96	191	112	160	
18 Cochiti & 30 Taos	3,648	38 x 96	243	216	230	
27 Picuris, 29 Sandia, 31 Santa Ana	4,160	40 x 104	276	200	260	
19 Isleta & 21 Jemez	1,365	35 x 39	91	64	90	
23 Nambé & 25 Navajo	1,260	35 x 36	84	64	90	
65 Hopi & 70 Tewa	1,728	64 x 27	110	84	110	

CONVENTION CENTER AMENITIES

- Located in the center of Downtown Albuquerque
- 4 miles from the airport
- Easy access to Interstates 25 and 40
- Over 900 convention-style hotel rooms located within walking distance
- Exceptional service from trained professionals
- An on-site preferred audio-visual provider
- Competitive electric rates
- Free Wi-Fi
- Computer networking
- Telephone and data line services
- Convenient on-site business center
- 718 covered parking spaces adjacent to ACC
- Versatile public areas
- 167,562 total square feet of exhibit space (including 106,200 clear-span)
- 2,300-seat auditorium
- 31 meeting rooms
- 31,000-square-foot ballroom and balcony
- Capable of handling more than 9,000 attendees
- Outdoor special event staging areas
- Initial meeting room setup at no charge
- Booking and management of Civic Plaza events

HIGH-QUALITY FOOD SERVICE

- Exclusive on-site food & beverage provider
- Custom menus
- Local and national menus
- Banquet space for up to 6,000
- Personalized service
- Themed events available

VENDOR SERVICES AVAILABLE

- Audio/visual services by Alliance Audio Visual
- Conference recording/duplication
- Event planning
- Exhibit and booth decorators
- Security companies
- Sound/lighting
- High speed/wireless internet connectivity

TECHNICAL SPECIFICATIONS

East Exhibit Halls	West Exhibit Halls
UTILITIES OUTER WALLS	UTILITIES
<ul style="list-style-type: none"> • Water (hot/cold) • Drains • Gas 	<ul style="list-style-type: none"> • Water (hot/cold) • Drains • Gas • Compressed air (limited)
OVERHEAD	ELECTRICITY
<ul style="list-style-type: none"> • Water (hot/cold) • Compressed air 	<ul style="list-style-type: none"> • 120v, 20-100 amps • 208v, 20-100 amps, single phase • 208v, 20-100 amps, three phase
ELECTRICITY	CEILING HEIGHT
<ul style="list-style-type: none"> • 120v, 20-60 amps • 208v, 20-60 amps, single phase • 208v, 20-60 amps, three phase • 480v, 20-60 amps 	<ul style="list-style-type: none"> • 16'-20'
CEILING HEIGHT	LIGHTS
<ul style="list-style-type: none"> • 30' 	<ul style="list-style-type: none"> • Fluorescent
LIGHTS	FLOOR & COLUMNS
<ul style="list-style-type: none"> • Metal halide - 1,000 watts 	<ul style="list-style-type: none"> • Tile over concrete • Floor load - 10,000 lbs/wheel or 10 tons/axle • Columns at 25'-30' on center
FLOOR & COLUMNS	LOADING
<ul style="list-style-type: none"> • Sealed concrete • Floor load-unlimited • Column Free 	<ul style="list-style-type: none"> • Off street • Overhead doors 16' w x 12' h
LOADING & DOCK DOORS	NOTE
<ul style="list-style-type: none"> • 24' w loading dock covered • (10) truck bays-one w/ dock leveler • Two Dock Doors-22' w x 15' h • Five Dock Doors-14' w x 15' h 	<p>Maximum capacities shown. Capacities subject to change based on staging and audio visual. Classroom set are (4) per 8'x18" table. Banquet set are (10) per 72" round.</p>
FREIGHT ELEVATOR/ MEETING ROOM AREA	
<ul style="list-style-type: none"> • 8' w x 8' h x 16' d • 10,000 lbs capacity 	