

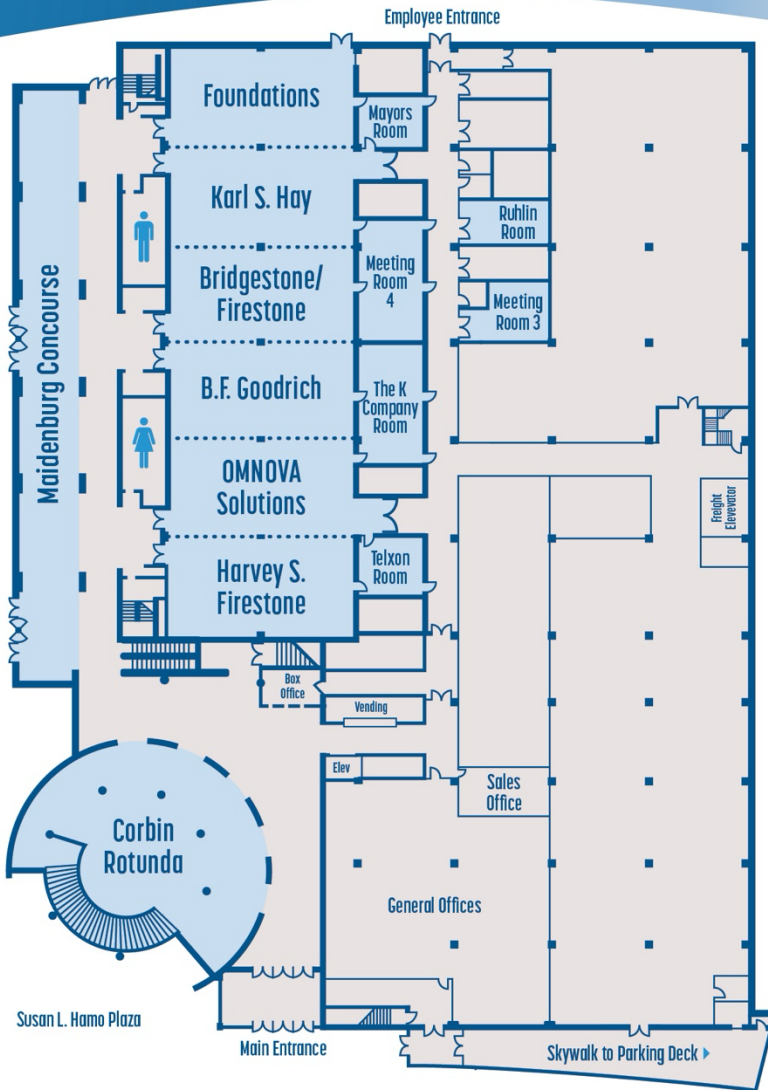

JOHN S. KNIGHT CENTER

LEVEL

1



All capacities listed below are estimated. The actual capacities will depend on the specific set-up of each location.

Rev. 08.2024

Room Name	Room Size	Sq. Ft.	Banquet	Theater	Classroom	Ceiling
Harvey S. Firestone Room	28.5 x 58	1,653	80	120	60	11' 11"
OMNOVA Solutions	30 x 58	1,740	80	120	64	11' 11"
B.F. Goodrich Room	30 x 58	1,740	80	120	64	11' 11"
Bridgestone / Firestone Room	30 x 58	1,740	80	120	64	11' 11"
Karl S. Hay Room	30 x 58	1,740	80	120	64	11' 11"
Foundations Room	27 x 58	1,566	80	120	58	11' 11"
Telxon Room	16.25 x 21	340	16	30	12	11' 11"
The K Company Room	20.5 x 37.5	768	40	54	24	11' 11"
Meeting Room 3 (L-shaped)	10 x 8.5 + 7.5 x 18 = 400	340	16	30	12	11' 3"
Meeting Room 4	20.5 x 37.5	768	40	54	24	11' 11"
Ruhlin Room	12.25 x 21	340	16	30	12	11' 10"
Mayors Room	16.25 x 21	340	16	30	12	11' 11"
Maidenburg Concourse	18 x 181.75	2,948	N/A	N/A	N/A	30'
Corbin Rotunda	78' Diameter	3,000	100	120	N/A	13' / 35'



77 E. Mill St., Akron, OH 44308



330.374.8900 | 800.245.4254



johnsknightcenter.org



JOHN S. KNIGHT CENTER

LEVEL 2

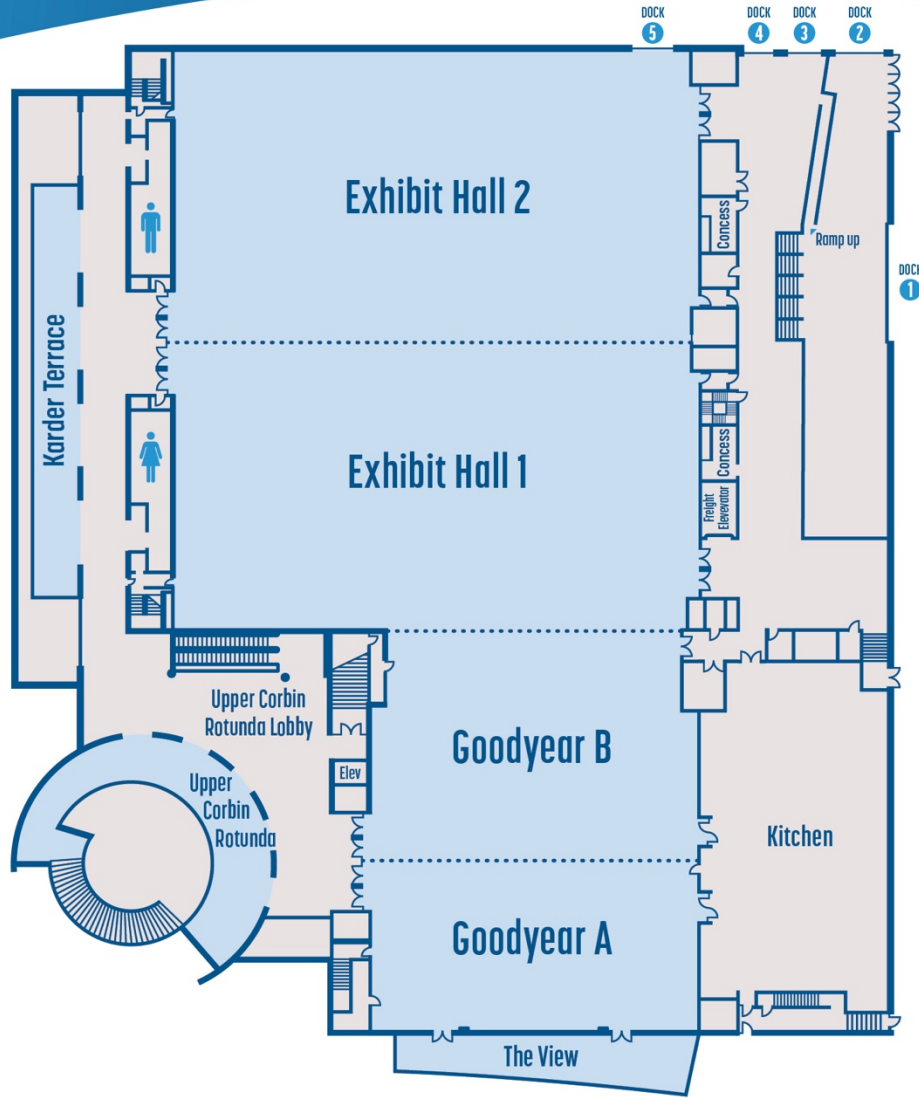

All capacities listed below are estimated. The actual capacities will depend on the specific set-up of each location.

Rev. 08.2024

Room Name	Room Size	Sq. Ft.	Banquet	Theater	Classroom	Booths	Ceiling
Upper Corbin Rotunda	21 x 60	1,260	100	N/A	N/A	N/A	35'
Upper Corbin Rotunda Lobby	72 x 78	4,000	N/A	N/A	N/A	N/A	11' 9"
Goodyear Rooms	117 x 102	11,678	630	900	424	60	20'
Goodyear Room A	49 x 102	4,998	280	400	182	25	20'
Goodyear Room B	48 x 102/19.5 x 91.5	6,680	350	500	242	28	20' / 15'
Exhibit Halls 1 & 2	160 x 179	28,640	1,440	2,880	1,050	168	35'
Exhibit Hall 1	90 x 160	14,400	720	1,400	525	84	35'
Exhibit Hall 2	89 x 160	14,240	720	1,400	525	84	35'
Karder Terrace	13 x 128	1,664	N/A	N/A	N/A	N/A	9' 7"
The View	108 x 9-22	1,370	80	-	-	-	-



77 E. Mill St., Akron, OH 44308



330.374.8900 | 800.245.4254



johnsknightcenter.org