

# SHERATON ALBUQUERQUE AIRPORT HOTEL

**2910 Yale Blvd. SE  
Albuquerque, NM 87106**

**phone** 505.843.7000  
**toll free** 888.625.4937  
**fax** 505.246.8188  
**email** info@sheratonabqairport.com  
**website** sheratonalbuquerqueairport.com

The Sheraton Albuquerque Airport Hotel, provides an ideal location within walking distance of the Albuquerque International Sunport and just minutes from the Nob Hill Shopping, Dining and Entertainment District. The property boasts newly renovated public and meeting space inspired by the intricate details, warm tones and textures of the southwest landscape, as well as the historic Pueblo tribes. This 15-story, 276-room high-rise is surrounded by the beautiful Sandia and Manzano mountains and aims to create an inviting stay for different generations. The Sheraton Albuquerque Airport is a unique property where modern travelers can rediscover the past. We offer a state of the art fitness center and an outdoor pool, allowing you to focus on wellness during your stay. Enjoy comfortable accommodations with a beautiful view, and 24-hour complimentary airport transportation.

Our full service restaurant, The Left Turn, features upscale American cuisine with a Southwestern twist for breakfast, lunch, dinner, and room service throughout the day. The LT Lounge offers a wide range of premium beverages and appetizers. With 12,000 square feet of meeting space, including the 6,000-square-foot Anasazi Ballroom, Sheraton Albuquerque Airport provides a phenomenal event space for any occasion. At Sheraton, we believe life is better when shared. You can enjoy an inviting and productive experience in the heart of the Sheraton lobby. Feel free to surf the web on our terminals or bring your laptop for complimentary wireless broadband. With a lobby designed so you can socialize with new friends or old, at Sheraton Albuquerque Airport, you know you belong.



Total Guestrooms	246	Parking Spaces	340
Queen/Queen	100	Parking Fee	\$10.95
Committable Sleeping Rooms	150	On-Site Restaurants	1
Suites	2	Restaurant Seating Capacity	85
Wheelchair Accessible Sleeping Rooms	6	Private Dining Capacity	No
Total Meeting Space (sq. ft.)	11,767	Bar	Yes
Largest Meeting Room (sq. ft.)	5,870	Swimming Pool	Yes
Maximum Meeting Capacity	630	Spa	No
Maximum Banquet Capacity	460	Workout Facility	Yes
Data Port Ready	Yes	Laundry/Valet Service	Yes
High Speed Internet/Wi-Fi in Guest Rooms	Yes	Business Center	Yes
Internet Fee (Guest Rooms)	\$9.95	Gift Shop	No
High Speed Internet/Wi-Fi in Meeting Rooms	Yes	Room Service Hours	6am-11pm
On-Site A/V	Yes	Pet Friendly	Yes
Airport Shuttle	Yes	Miles to Abq. Sunport	0
Fee for Airport Shuttle	\$0	Miles to Abq. Convention Center	3.7
Courtesy Shuttle Miles from Hotel	1	Miles to shopping (Nob Hill)	3

# BUILDING FACILITIES AND ROOM CAPACITIES

ROOM	SQ. FT.	DIMENSIONS	CEILING	THEATRE	CLASSROOM	BANQUET	CONFERENCE	RECEPTION
Anasazi Ballroom	5870	57' x 103'	16'	630	350	460	-	610
Chaco	1938	57' x 34'	16'	190	130	130	55	205
Bandelier	1938	57' x 34'	16'	190	130	130	55	205
Tijeras	1938	57' x 34'	16'	190	130	130	55	205
Chaco & Bandelier	3876	57' x 68'	16'	380	260	260	-	400
Bandelier & Tijeras	3876	57' x 68'	16'	380	260	260	-	400
Alvarado Ballroom	3900	65' x 60'	12'	280	215	260	-	400
Gran Quivera	1950	65' x 30'	12'	140	90	130	45	200
GQ I	960	32' x 30'	12'	80	45	50	25	100
GQ II	960	32' x 30'	12'	80	45	50	25	100
Valle Grande	1950	65' x 30'	12'	140	90	130	45	200
VG I	960	32' x 30'	12'	80	45	50	25	100
VG II	960	32' x 30'	12'	80	45	50	25	100
Bernalillo	504	28' x 18'	8'	50	24	30	25	40
Rio Grande	504	28' x 18'	8'	50	24	30	25	40
Vista Norte Boardroom	550	25' x 22'	10'	-	-	-	12	-

Exterior Meeting Space - 14,00 Sq. Ft.

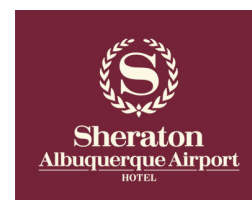
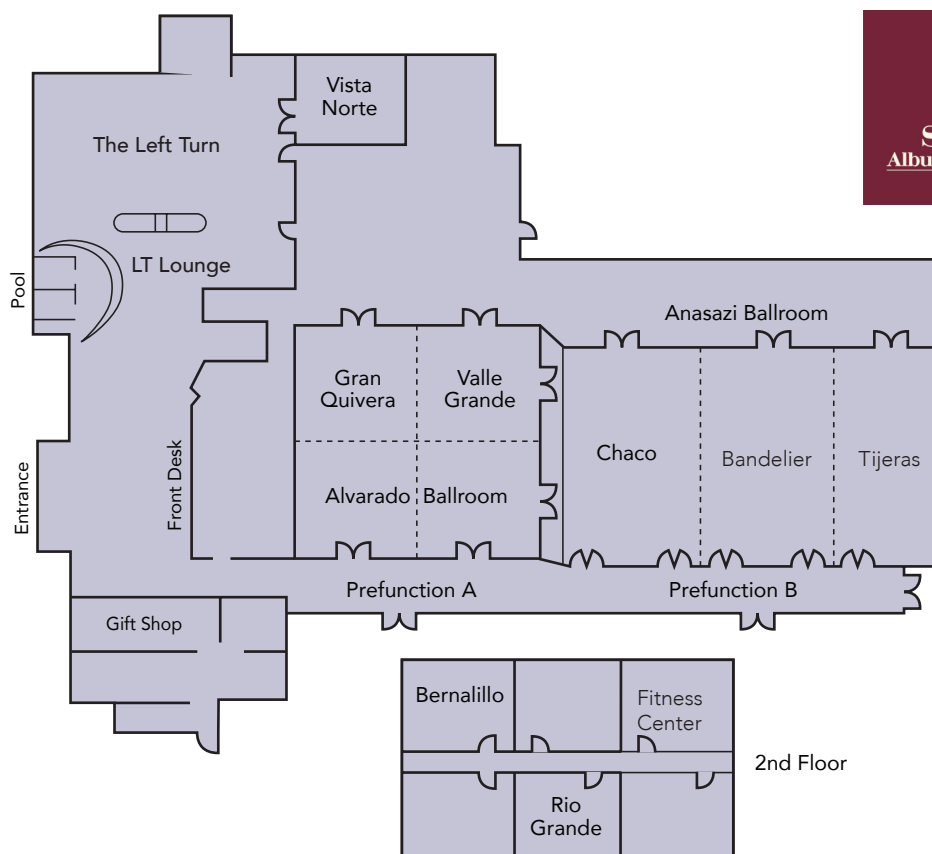

1.800.733.9918

ALBUQUERQUE  
CHANGE YOUR PERSPECTIVE

meet@visitabq.org  
visitabq.org/meetings