



Anaheim Convention Center

Meeting & Exhibit Space





Anaheim

The Anaheim Convention Center (ACC) is consistently ranked as one of the top meeting venues in the U.S. in terms of its size, attendance, overall building services and amenities.

The LEED® certified 1.8 million-square-foot ACC is the largest convention center on the West Coast. This ultra-modern facility boasts the capability to host mega-conventions, meetings, tradeshows and events with ease.

ACC offers over one million square feet of exhibit space including three ballrooms totaling 238,000 square feet. The 2017 expansion, ACC North, adds 200,000 square feet of space with a 100,000 square foot carpeted column-free multi-purpose space featuring north-facing windows and movable airwalls for a variety of meeting room layout options.

In addition, the picturesque outdoor Palm Courts, Arena Plaza and Grand Plaza offer sunny possibilities for year-round special events, receptions and networking.

Anaheim Convention Center by the numbers

- Total facility area: **1.8 million square feet**
- Exhibit space: **Over one million square feet**
- Seating space: **Arena seating for 7,500**
- Meeting rooms: **99**
- Meeting space: **352,000 square feet**
- Three ballrooms: **238,000 square feet total**
Two ballrooms: **100,000 square feet each**
One ballroom: **38,000 square feet**
- Pre-function lobby space: **222,192 square feet**
- Outdoor event space: **200,000 square feet**
- Total acreage: **53**

MORE REASONS TO CHOOSE THE ANAHEIM CONVENTION CENTER



Anaheim Convention Center Grand Plaza

EASY ACCESS

Anaheim is centrally located with four airports all within an hour's drive. The closest, John Wayne Airport, Orange County (SNA), is only 13 miles away.

FLEXIBLE SPACES OF ACC NORTH

Opened in 2017, ACC North includes 100,000 square feet of carpeted space on the 100 level and an additional 100,000 square feet of carpeted, column-free space on the 200 level, with direct access to an over 10,000 square foot outdoor balcony. This expansion includes natural light on each level with blackout capabilities, up to 35 rooms on the 200 level and up to 13 rooms on the 100 level with meeting rooms grouped into neighborhoods to allow for customizable climate and lighting control. The multi-purpose rooms and pre-function spaces feature 2,000 lbs. on ten foot centers. That's over 2,100 points to hang!

EXHIBIT SPACE

The ACC features over one million square feet of exhibit space, making it the largest exhibit facility on the West Coast. All halls are directly accessible from spacious pre-function areas.

GRAND PLAZA

Featuring two beautiful cascading fountains, palm and orange trees, the Grand Plaza is the ideal year-round outdoor venue for lunches, receptions, outdoor exhibits and more. Located in front of the ACC, between the Hilton Anaheim and Anaheim Marriott, this area has 36,000 square feet of usable space.

THE ARENA

The mid-century modern domed Arena is the original part of the convention center complex. It features 28,000 square feet (flat floor) and seats up to 7,500.

ARENA PLAZA

The Arena Plaza offers 64,000 square feet of usable space and can accommodate receptions up to 5,500 people. It includes a courtyard area with a dramatic fountain centerpiece.



ACC Arena Plaza

CATERING SERVICES

Our CIA-certified chefs are ready to customize your food and beverage experience with the freshest farm to fork ingredients from our local partners in Southern California. We feature unique culinary experiences throughout the building within each exhibit hall and lobby. On our plaza, we specialize in local award-winning food truck events with up to 27 local chef-owned and operated artisan food trucks paired with our local Anaheim brews.

ACC GREEN PRACTICES

This LEED® certified building features eco-friendly policies that include on-site recycling, a rooftop herb garden, composting, energy and water conservation, solar panels and use of other sustainable solutions.

ADVANCED TECHNOLOGY AND PRODUCTION SERVICES

The ACC features a newly upgraded wired and wireless network with an industry-best 10-gigabyte connection from Smart City Networks, the nation's convention telecommunications and Internet services leader. Free WiFi accessibility is available throughout the ACC. PSAV, the ACC's on-site, preferred production partner, supports the A/V rigging and meeting needs during events.

CONCIERGE KIOSK

Concierge Kiosk is staffed by helpful professionals on request to provide visitors with information on restaurants, attraction tickets, transportation options, maps and general destination information.

VISIT ANAHEIM DESTINATION SERVICES

As destination experts, Visit Anaheim ensures a seamless experience for meeting professionals and their guests. Our consultative approach allows us to customize our entire collection of services to best fit the needs of each client, including efficient site visits, local housing experts, and strategic marketing, communications and welcome programs to maximize attendee engagement.

ACC CAMPUS

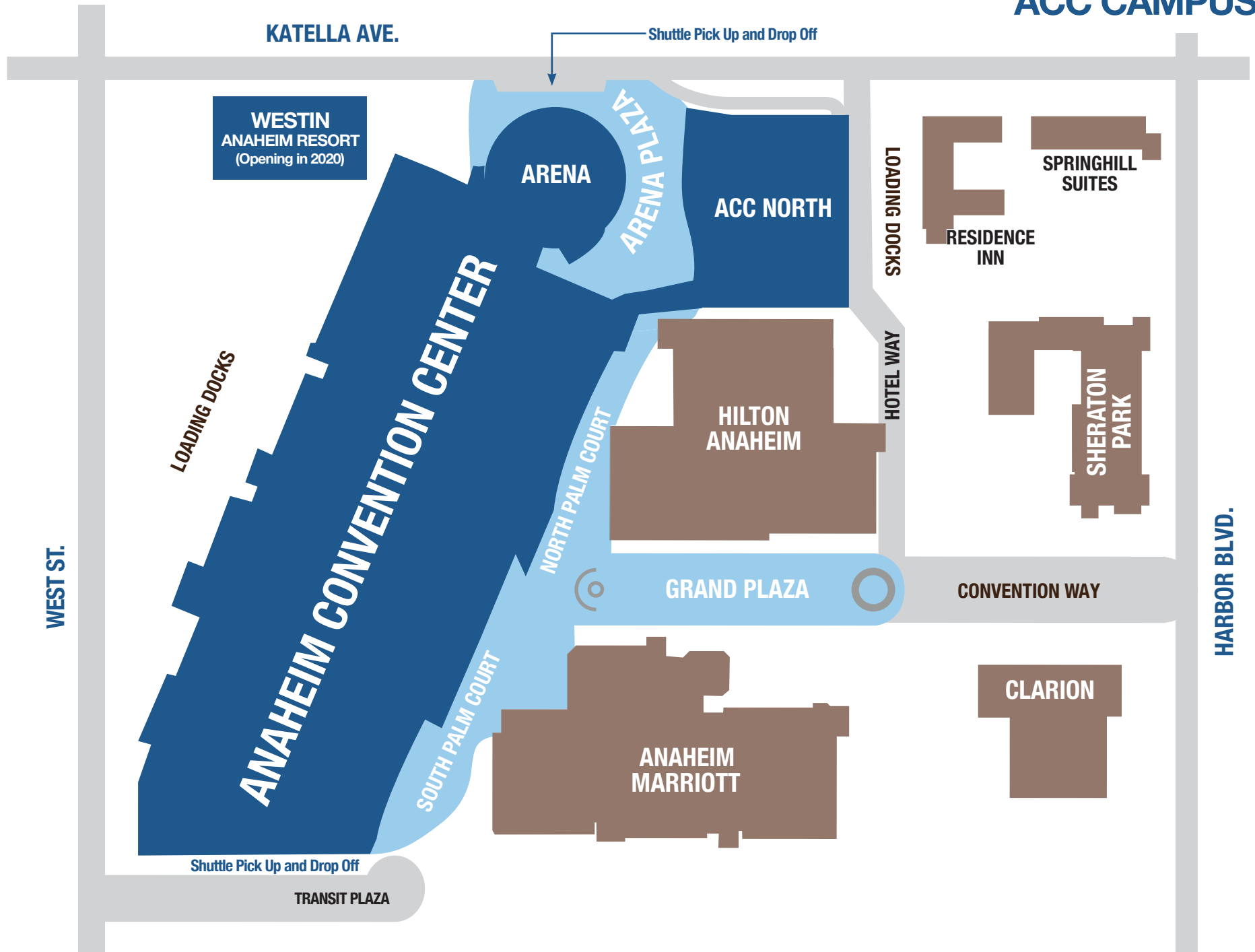

THE ANAHEIM CAMPUS



Experience sun-soaked Southern California with the convenience of a meeting destination that's just steps away from everywhere you'll want to be.



EXCEPTIONAL HOTELS

Linked by the plazas, **four world-class hotels** – Anaheim Marriott, Hilton Anaheim, Sheraton Park Hotel at the Anaheim Resort and Westing Anaheim Resort (coming in 2020) – offer business amenities, luxury and a **combined 3,705 rooms** and **317,000 square feet of well-appointed, newly renovated function space**.



WALKABILITY

Having this centralized destination allows exhibitors and attendees to **walk everywhere** to work, stay and even play – all in the **Anaheim Resort™** district. Many options for dining, entertainment, shopping and a thriving nightlife are all within walking distance.



CULINARY EXPERIENCES

More than **100 nearby restaurants**, from grab-and-go options to upscale chains to **only-in-Anaheim fine dining restaurants** and **artisanal eateries**, create the city's expansive culinary footprint.



ENTERTAINMENT & NIGHTLIFE

Concerts at the **House of Blues® Anaheim**, an **award-winning craft-beer scene**, trendy bars and lounges, happy-hour hangouts, the **Disneyland® Resort**, pro sports and line-dancing at **THE RANCH Restaurant and Saloon®** are all a little more than a two-step away.

ACC Tri Level Floor Plan Diagram

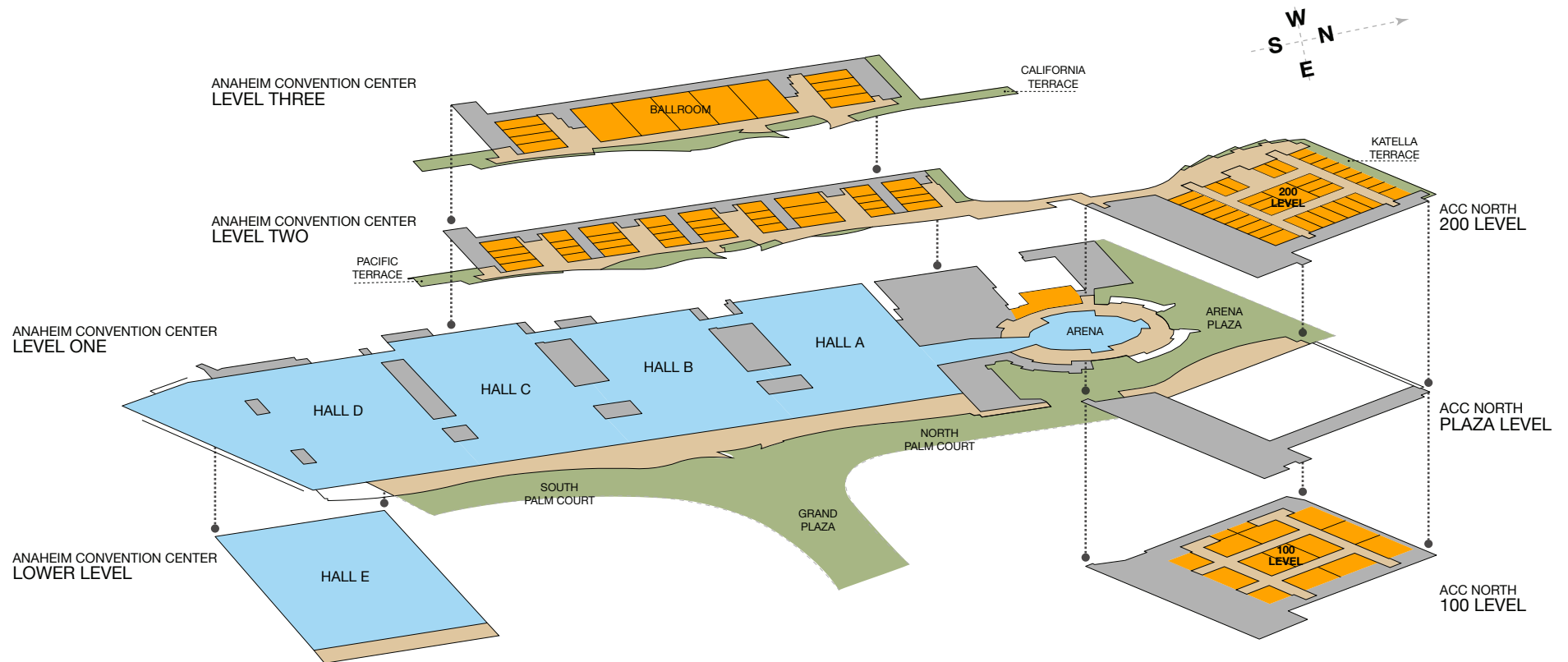

LEGEND

- EXHIBIT SPACE
- MEETING ROOM
- PRE-FUNCTION SPACE
- TERRACE/PLAZA

ANAHEIM CONVENTION CENTER

LEVEL ONE



ANAHEIM CONVENTION CENTER CAPACITIES

EXHIBIT HALLS AND ARENA

EXHIBIT HALLS — 813,607 Total Square Feet

ROOM NAME	DIMENSIONS	SQUARE FEET	CEILING HEIGHT	THEATER	BANQUET	10' X 10' BOOTHES	8' X 10' BOOTHES	TOTAL BOOTHS
Hall A	250' x 530'	145,841	18'6"—24'	12,000	9,000	718	18	736
Hall B	250' x 530'	147,335	20'6"—25'	12,250	9,200	718	18	736
Hall C	245' x 575'	155,673	20'6"—25'	12,900	9,700	759	32	791
Hall D	325' x 472'–530'	221,284	25'	15,000	13,800	1,140	–	1,140
Hall E	270' x 535'	143,474	13'8"	–	8,000	650	–	650

ARENA — 28,140 Total Square Feet (flat floor) - 7,500 Capacity, Stadium Style Seating

ROOM NAME	DIMENSIONS	SQUARE FEET	CEILING HEIGHT	THEATER	CLASSROOM	BANQUET	10' X 10' BOOTHES
Arena	146' x 207'	28,140	45'–89'	7,500	–	1,200	145
Arena Lobby	75' x 144'	10,800	8'–21'6"	–	–	–	40
AR1	62' x 50'	3,100	15'	350	175	200	–
AR2	57' x 50'	2,100	15'	150	75	75	–
AR1 + AR2 Combined	62' x 100'	5,200	15'	500	250	275	–

ANAHEIM CONVENTION CENTER

LEVEL TWO

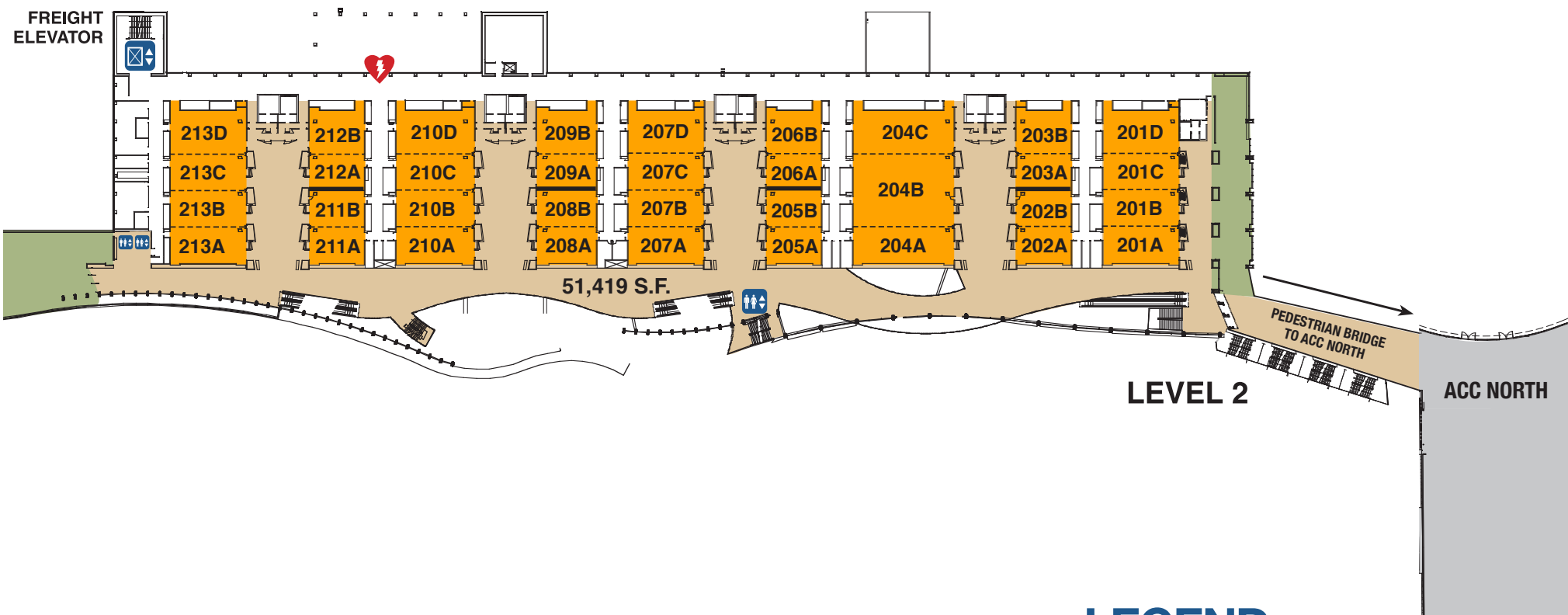

LEGEND

- PRE-FUNCTION SPACE
- MEETING ROOM
- TERRACE
- FIRST AID STATION WITH DEFIBRILLATOR
- PASSENGER ELEVATOR
- FREIGHT ELEVATOR

ANAHEIM CONVENTION CENTER CAPACITIES

LEVEL TWO

SECOND LEVEL MEETING ROOMS — 65,583 Square Feet

ROOM NAME	DIMENSIONS	SQUARE FEET	CEILING HEIGHT	THEATER	CLASS-ROOM 8' X 18" TABLES	BANQUET 66" ROUNDS
OVER HALL A						
201A	62'6" x 30'	1,875	17'6"	188	124	130
201B	62'6" x 30'	1,875	17'6"	188	124	130
201C	62'6" x 30'	1,875	17'6"	188	124	130
201D	62'6" x 36'	2,250	17'6"	225	152	150
201AB	62'6" x 60'	3,750	17'6"	376	248	260
201ABC	62'6" x 90'	5,625	17'6"	564	372	390
201ABCD	62'6" x 126'	7,875	17'6"	789	524	540
202A	45'6" x 30'	1,365	17'6"	136	92	100
202B	45'6" x 30'	1,365	17'6"	136	92	100
202AB	45'6" x 60'	2,730	17'6"	272	184	200
203A	45'6" x 30'	1,365	17'6"	136	92	100
203B	45'6" x 36'	1,638	17'6"	164	112	110
203AB	45'6" x 66'	3,003	17'6"	300	204	210
204A	83' x 30'	2,490	17'6"	249	168	170
204B	83' x 60'	4,980	17'6"	498	336	340
204C	83' x 36'	2,988	17'6"	299	200	200
204AB	83' x 90'	7,470	17'6"	747	504	510
204BC	83' x 90'	7,968	17'6"	797	536	540
204ABC	83' x 126'	10,458	17'6"	1,046	704	710
OVER HALL B						
205A	45'6" x 30'	1,365	17'6"	136	92	100
205B	45'6" x 30'	1,365	17'6"	136	92	100
205AB	45'6" x 60'	2,730	17'6"	272	184	200
206A	45'6" x 30'	1,365	17'6"	136	92	100
206B	45'6" x 36'	1,638	17'6"	164	112	110
206AB	45'6" x 66'	3,003	17'6"	300	204	210
207A	62'6" x 30'	1,875	17'6"	188	124	130
207B	62'6" x 30'	1,875	17'6"	188	124	130
207C	62'6" x 30'	1,875	17'6"	188	124	130
207D	62'6" x 36'	2,250	17'6"	225	152	150

ROOM NAME	DIMENSIONS	SQUARE FEET	CEILING HEIGHT	THEATER	CLASS-ROOM 8' X 18" TABLES	BANQUET 66" ROUNDS
207AB	62'6" x 60'	3,750	17'6"	376	240	260
207ABC	62'6" x 90'	5,625	17'6"	564	372	390
207ABCD	62'6" x 126'	7,875	17'6"	789	524	540
208A	49' x 30'	1,470	17'6"	147	100	100
208B	49' x 30'	1,470	17'6"	147	100	100
208AB	49' x 60'	2,940	17'6"	294	200	200
209A	49' x 30'	1,470	17'6"	147	100	100
209B	49' x 36'	1,764	17'6"	176	120	120
209AB	49' x 66'	3,234	17'6"	323	220	220
OVER HALL C						
210A	64'6" x 30'	1,935	17'6"	194	128	130
210B	64'6" x 30'	1,935	17'6"	194	128	130
210C	64'6" x 30'	1,935	17'6"	194	128	130
210D	64'6" x 36'	2,322	17'6"	232	152	160
210AB	64'6" x 60'	3,870	17'6"	388	256	260
210ABC	64'6" x 90'	5,805	17'6"	582	384	390
210ABCD	64'6" x 126'	8,127	17'6"	814	536	550
211A	45'6" x 30'	1,365	17'6"	136	92	100
211B	45'6" x 30'	1,365	17'6"	136	92	100
211AB	45'6" x 60'	2,730	17'6"	272	184	200
212A	45'6" x 30'	1,365	17'6"	136	92	100
212B	45'6" x 36'	1,638	17'6"	164	112	110
212AB	45'6" x 66'	3,003	17'6"	300	204	210
213A	62'6" x 30'	1,875	17'6"	188	124	130
213B	62'6" x 30'	1,875	17'6"	188	124	130
213C	62'6" x 30'	1,875	17'6"	188	124	130
213D	62'6" x 36'	2,250	17'6"	225	152	150
213AB	62'6" x 60'	3,750	17'6"	376	248	260
213ABC	62'6" x 90'	5,625	17'6"	564	372	390
213ABCD	62'6" x 126'	7,875	17'6"	789	524	540

ANAHEIM CONVENTION CENTER

LEVEL THREE



LEGEND

- PRE-FUNCTION SPACE
- MEETING ROOM
- TERRACE
- FIRST AID STATION WITH DEFIBRILLATOR
- PASSENGER ELEVATOR
- FREIGHT ELEVATOR

ANAHEIM CONVENTION CENTER CAPACITIES

LEVEL THREE

THIRD LEVEL MEETING ROOMS — 15,840 Square Feet

ROOM NAME	DIMENSIONS	SQUARE FEET	CEILING HEIGHT	THEATER	CLASSROOM 8' X 18" TABLES	BANQUET 66" ROUNDS
303A	66' x 30'	1,980	17'6"	198	132	140
303B	66' x 30'	1,980	17'6"	198	132	140
303C	66' x 30'	1,980	17'6"	198	132	140
303D	66' x 30'	1,980	17'6"	198	132	140
303AB	66' x 60'	3,960	17'6"	396	264	270
303ABC	66' x 90'	5,940	17'6"	594	396	420
303ABCD	66' x 126'	7,920	17'6"	792	528	560
304A	66' x 30'	1,980	17'6"	198	132	140
304B	66' x 30'	1,980	17'6"	198	132	140
304C	66' x 30'	1,980	17'6"	198	132	140
304D	66' x 30'	1,980	17'6"	198	132	140
304AB	66' x 60'	3,960	17'6"	396	264	270
304ABC	66' x 90'	5,940	17'6"	594	396	420
304ABCD	66' x 126'	7,920	17'6"	792	528	560

THIRD LEVEL BALLROOMS — 38,058 Square Feet

ROOM NAME						
Ballroom A	120' x 63'	7,560	27'3"-28'3"	756	504	510
Ballroom B	122' x 62'6"	7,625	27'3"-28'3"	763	508	510
Ballroom C	123' x 62'6"	7,688	27'3"-28'3"	769	512	520
Ballroom D	122' x 62'6"	7,625	27'3"-28'3"	763	508	510
Ballroom E	120' x 63'	7,560	27'3"-28'3"	756	504	510
Ballroom AB	Combined	15,185	27'3"-28'3"	1,519	1,012	1,020
Ballroom ABC	Combined	22,873	27'3"-28'3"	2,288	1,524	1,540
Ballroom ABCD	Combined	30,498	27'3"-28'3"	3,051	2,032	2,050
Ballroom ABCDE	Combined	38,058	27'3"-28'3"	3,807	2,536	2,560

ACC NORTH

100 LEVEL



This space can also be used as one room at 100,000 sq. ft., or two rooms at 50,000 sq. ft., or many other combinations.

LEGEND

- MEETING ROOM
- SHOW OFFICES
- PRE-FUNCTION SPACE
- PASSENGER ELEVATOR
- FREIGHT ELEVATOR

ACC NORTH CAPACITIES

100 LEVEL

100,000 gsf of carpeted, flexible multipurpose meeting or exhibit space

Maximum of 13 meeting rooms (Ranging from 3,435 S.F. - 5,720 S.F.)

Ceiling Height = 25 ft

ROOM NAME	SQUARE FEET	THEATER	CLASSROOM	BANQUET ROUNDS	10' X 10' BOOTHS
Entire First Level	100,000	10,000	4,160	8,320	500
151	3,435	370	230	280	
152	5,500	610	370	450	
153	3,500	380	240	280	
154	5,400	570	350	430	
155	5,350	570	350	430	
156	5,600	610	370	450	
157	5,350	570	350	430	
158	5,720	610	370	450	
159	5,350	570	350	430	
160	5,600	610	370	450	
161	5,395	570	350	430	
162	5,470	570	350	430	
163	5,460	570	350	430	
Combinations					
154+158	11,120	1,180	720	880	
155+157+159	16,050	1,710	1,050	1,290	
156+160	11,200	1,220	740	900	
161+162+163	16,325	1,710	1,050	1,290	

ACC NORTH

200 LEVEL



This space can also be used as one room at 100,000 sq. ft., or two rooms at 50,000 sq. ft., or many other combinations.

LEGEND

- MEETING ROOM
- PRE-FUNCTION SPACE
- TERRACE
- FIRST AID STATION
- PASSENGER ELEVATOR
- FREIGHT ELEVATOR

ACC NORTH CAPACITIES

200 LEVEL

100,000 gsf of carpeted, pillar-free, flexible multipurpose meeting space

Maximum of 34 meeting rooms (Ranging from 1,200 S.F. - 5,325 S.F.)

Ceiling Height = 25 ft

ROOM NAME	SQUARE FEET	THEATER	CLASSROOM	BANQUET ROUNDS	10' X 10' BOOTHS
Entire Second Level	100,000	10,000	4,160	8,320	500
251 A	1,745	180	110	130	
251 B	1,745	180	110	130	
251 C	1,745	180	110	130	
251 AB / 251 BC	3,490	370	230	280	
251 ABC	5,235	570	350	430	
252 A	1,745	180	110	130	
252 B	1,745	180	110	130	
252 C	1,745	180	110	130	
252 AB / 252 BC	3,490	370	230	280	
252 ABC	5,235	570	350	430	
253 A	1,745	180	110	130	
253 B	1,745	180	110	130	
253 C	2,500	270	170	200	
253 AB	3,490	370	230	280	
253 BC	4,245	440	270	320	
253 ABC	5,990	640	390	480	
254 A	1,730	180	110	130	
254 B	1,730	180	110	130	
254 AB	3,460	370	230	280	
255 A	1,775	190	120	140	
255 B	1,775	190	120	140	
255 C	1,775	190	120	140	
255 AB / 255 BC	3,550	380	240	280	
255 ABC	5,325	570	350	430	
256 A	2,187	220	130	160	
256 B	2,187	220	130	160	
256 AB	4,374	470	290	350	
257	5,325	570	350	430	
258 A	2,187	220	130	160	
258 B	2,187	220	130	160	

ACC NORTH CAPACITIES

200 LEVEL

ROOM NAME	SQUARE FEET	THEATER	CLASSROOM	BANQUET ROUNDS	10' X 10' BOOTHS
258 AB	4,374	470	290	350	
259 A	1,730	180	110	130	
259 B	1,730	180	110	130	
259 AB	3,460	370	230	280	
260 A	1,775	190	120	140	
260 B	1,775	190	120	140	
260 C	1,775	190	120	140	
260 AB / 260 BC	3,550	380	240	280	
260 ABC	5,325	570	350	430	
261 A	2,187	220	130	160	
261 B	2,187	220	130	160	
261 AB	4,374	470	290	350	
262 A	1,200	130	80	90	
262 B	1,200	130	80	90	
262 C	1,200	130	80	90	
262 AB / 262 BC	2,400	260	160	200	
262 ABC	3,600	400	240	290	
263 A	1,200	130	80	90	
263 B	1,200	130	80	90	
263 C	1,200	130	80	90	
263 AB / 263 BC	2,400	260	160	200	
263 ABC	3,600	400	240	290	
264 A	1,200	130	80	90	
264 B	1,200	130	80	90	
264 C	1,750	180	110	130	
264 AB	2,400	260	160	200	
264 BC	2,950	320	190	240	
264 ABC	4,150	440	270	320	

Combinations					
251+252+253	14,715	1,580	970	1,190	
255+257+260	15,975	1,710	1,050	1,290	
256+258+261	13,122	1,410	870	1,050	
262+263+264	11,350	1,220	750	900	

ACC NORTH

PLAZA LEVEL

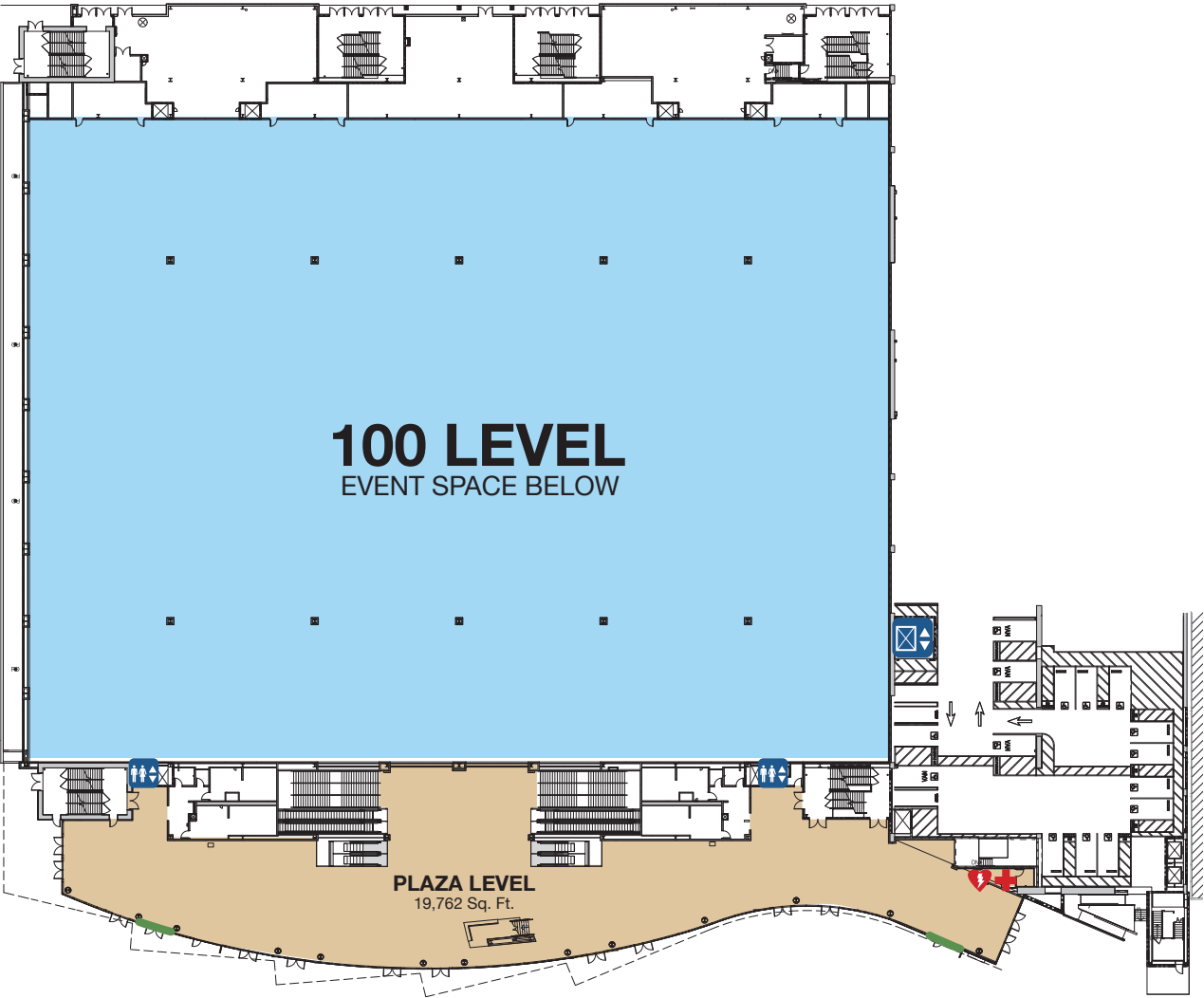

ARENA PLAZA
(Street Level)

LEGEND

- EXHIBIT SPACE
- PRE-FUNCTION SPACE
- LOADING DOORS
- FIRST AID STATION
- PASSENGER ELEVATOR
- FREIGHT ELEVATOR

ACC NORTH

PLAZA LEVEL

- Street Level entrance into ACC North Building.
- Visit Anaheim Satellite Concierge Desk (located on the southwest side of the building).
- Charging station underneath the main staircase with (18) plug-ins.
- Equipment Lift for move-in/move-out 100 Level .
- 100,000 square feet of flexible space with (10) columns; space is divisible into 13 rooms.
- (2) show offices: North Show Office A & North Show Office B. Please note that these show offices are also accessible via the service corridor on the 100 Level.
- Registration kiosks and signage for the 100 Level can be placed in the Plaza Level lobby. Please also note that this lobby is public space.

200 LEVEL

- 100,000 square feet of flexible space (no columns); space is divisible into 35 rooms
- Features the Katella Terrace (10,000 square feet). Please note that the Katella Terrace is booked separately.
- Registration kiosks and signage for the 200 Level can be placed in the 200 Level lobby. Please also note that this lobby is public space.

PARKING LEVELS

- Car Park #1 is adjacent to ACC North. Interstitial parking is located on Levels 3 & 4 of Car Park #1. From these parking levels, guests would proceed to the elevators and head to the Plaza Level for entry into ACC North. There is no direct access into the building from these levels.
- Level 5 of Car Park #1 corresponds with the 200 level of ACC North. This parking level features freight door access into the 200 level as well. Please check with your Event Manager for specifics on use for move- in/move-out.

- GENERAL INFORMATION: Ceiling Height/Height Restrictions: The ceiling height is 25' on each level. Please note that there is a 23' foot height restriction on both levels of ACC North.
- Weight Loads: 100 Level: 350PSF 200 Level: 250PSF or HS15-44 axle load Pre-function Space: 100 PSF Service Corridors: 125 PSF Bridge Connection: 100 PSF Parking Levels: 40PSF Roof: 20 PSF (Reducible)

AIR WALLS

- There are (600) air wall panels on the 100 Level and (800) panels on the 200 Level.
- It is estimated that the full set-up of the space will take approximately (10) people 9-10 hours. This time estimate is to move air walls only and does not include the set-up of equipment in the space.
- Please note that air wall movement will need to be scheduled and coordinated with your Event Manager to allow for the proper amount of time for room resets.

BRANDING

- General: With respect to exterior branding in ACC North, show branding is the only type of branding permitted. No commercial or sponsored graphics are permissible.
- Clings: Clings are permitted on the glass windows/ doors of ACC North except the Bridge Connection. There will be no approvals for glass window clings on the Bridge Connection. However, clings are permitted on the walls within the Bridge Connection. A branding plan should be submitted for approval prior to the creation of any graphics. Floor clings/graphics are approved on carpet ONLY. NOTE: There are no clings permitted on the terrazzo flooring.
- Banners: Please note that there are no exterior hang points for ACC North. All branding on the exterior windows must be via the installation of clings.
- Katella Terrace: No banners may be installed on the railing of the Katella Terrace.

- Small Balconies: Banners may be installed on the five small balconies on the west side of the building; however, the length of the banners cannot extend lower than the bottom of the railing. There is an additional banner install location on the two support columns located on the southwest exterior directly underneath the Bridge Connection. A banner may be installed in this location and eye bolts are available for this purpose.
- Bridge Connection: No banners may be installed from the beams on the interior of the Bridge Connection. The only approved banners on the bridge are those that are installed on the existing banner hanging rod locations.

CARPET PROTECTION

- When rolling handcarts, show boxes, electrical carts, hand pulled pallet jacks, etc. on any carpeted area, reinforced visqueen must be used to create a path for all equipment.
- When employing any heavy mechanized lift (forklift, scissor lift, cherry picker, motorized pallet jack, etc.), a path of visqueen covered by Masonite must be laid down. This carpet protection is required whenever equipment is moved.
- The Anaheim Convention Center has an approved tape that must be used when taping down cords/lines in any carpeted space. The tape is 3M Clear Scotch Tape #3565. If an identifying colored or warning tape needs to be used, the 3M 3565 tape must be placed on the carpet first. No other tape is permitted.
- For the terrazzo flooring, the only approved tape for use is painters tape.
- No items are permitted to be taped or affixed to any walls within or on the exterior of the ACC without prior approval of the Convention Center Manager.

ACC NORTH

ELECTRICAL

- Electrical boxes are located on the floor of each level. The boxes are located on a 30' x 30' grid. The floor boxes are designed for convenience in flexible access of power and utilities. The boxes are connected via a conduit "bailout" system which allows large power cable distribution under the floor to minimize cable ramping. The loading dock bays have additional points of entry to the bailout system to facilitate cabling access for the shows. The 100 Level and 200 Level have dedicated high amperage show power "Company Switches" that serve in addition to the floor boxes. Both levels have (2) two 400amp and (2) two 200amp gears. There are auxiliary company switches on the loading dock, which can feed both levels via in wall access on the 100 Level and vertical bailout access to 200 Level. All power is fed 208/120v 3ph. The floor boxes on the 100 Level are 100amp total distributed and includes standard 120v gfci, 30amp 3ph or Hubbell pin and sleeve. Level 200 has two box configurations: 100amp total and 60amp total alternating every other box. The modes of distribution are respectively similar, but different in amperage.
- There is power in the ceiling for rigging and signage. The ceiling power is 30amp 3phase at every 30 feet.
- There are also 30amp 3phase convenience outlets and data jacks on the walls throughout the entire public space. The pre-function areas also include 60amp floor boxes near the exterior walls and 100amp dedicated pin and sleeve power distributed north and south on the interior walls.
- The balcony spaces also have 120v power and network data connectivity.
- It is not required to line up the booths to an electrical grid; however, you run the risk of having a box in the middle of a booth or aisle where it may be inconvenient to access. NOTE: All utilities come from floor boxes including air, gas, water, phone & internet.

- Arena Plaza: A majority of the power in the Arena Plaza is located on the east side and near the Reader board. In terms of power on the Arena Plaza, it is as follows:
- Eight 60amp quelarco One 30amp 480v 3pho Five 30amp 3pho Two 100amp Hubbell pin and sleeve o One 400amp 480v source on camlock

*Please see your Event Manager
for a map of the locations.*

FIRE ALARM SYSTEM/FIRE LANES

- General: The ACC North is comprised of (1) one fire zone. An alarm on either level will result in the evacuation of the entire building.
- Fire Bypass: In order to conduct hazing or pyrotechnics, a request must be submitted to your Event Manager. To bypass the system, clients are required to pay for (1) Security Guard at the panel & (3) Crowd Control personnel for fire watch purposes.
- Beam Detectors: There are beam detectors in the ceiling that connect to detect points in both the Plaza Level Lobby & the 200 Level Lobby. The beams points cannot be broken. Thus, there are currently some rig points that are not usable. If the beam connection is interrupted, then this will activate the fire alarm system.
- Fire Access Lanes: There are (2) fire access lanes on the north side of ACC North (Katella Ave) that need to be kept clear at all times.
- Arena Plaza: There is a 20-foot fire lane required in the Arena Plaza. It is located on the west side of ACC North between the Plaza Level entrance and the Arena Plaza Fountain. There is also a fire hydrant located in the Arena Plaza just north of the east Arena entrance doors that requires clearance. No equipment may be placed in this area. Please speak with your Event Manager for additional details. FIRST AID • The primary First Aid Office is located on the Bridge Connection next to the 200 Level entrance. A secondary First Aid Office is located on 100 Level as well. INTERNET

- 1• 10 Gig Back Bone with a 10 Gig backup
- 2• High density Cisco wireless
- 3• Gigabit backbone
- 4• Cisco Gigabit switches
- 5• Fiber optics on a 30X30 grid on each floor
- 6• All cabling is Cat6 LIGHTING
- 7• LED dimmable-lights are available throughout the space.
- 8• Lights can be disabled individually as a preset function.
- 9• Lights that are turned ON in a partitioned space can be dimmed from OFF, 20%, 40%, 60%, 80% and 100%. Lights that have been turned OFF do not have a secondary dim up feature; they simply remain off.
- 10• Labor charges may apply for light programming. There is a minimum (2) hour labor charge per current rates. Please check with your Event Manager.

RIGGING

- 1• 100 Level & Plaza/Street Level: General Service Contractors are permitted to rig & hang signage (including those on the existing banner rods) on both the 100 Level & Plaza Level.
- 2• 200 Level/Bridge Connection/ 200 Level Pre-Function: PSAV is the exclusive rigging provider on the 200 Level, which includes the pre-function space and Bridge Connection. PSAV's exclusivity does extend to all banner rods and all rig points in these areas.

*Please also see the ACC Floor & Rigging Loads
document for additional information.*

ANAHEIM CONVENTION CENTER

Frequently Asked Questions & Answers

We welcome you to the Anaheim Convention Center (ACC) and look forward to working with you. The information contained herein is provided by Visit Anaheim and is intended as a guide only. Please do not hesitate to contact your ACC Event Manager with any additional questions or for more information on any of the items below.

Acronyms

ACC Anaheim Convention Center
GSC General Service Contractor
HVAC Heating, Ventilation and
Air Conditioning

ACC Exclusive Vendors

Catering Services - Aramark
Production Services - PSAV
Technology Services - SmartCity

ARENA

- All events in the arena must have an electrician on standby during show hours.
- Rigging points are permanent and rigging must be done by PSAV. The West side of the arena has more rigging points than North.
- There is a fee per unit per day for the eight spotlights, plus labor.
- The sound system in the arena is a Bose system and generally not suitable for general sessions. Contact PSAV for details.

AV & HOUSE SOUND

- PSAV is the preferred vendor for A/V and the exclusive provider for all rigging in the ballroom, meeting rooms and arena, as well as halls and ACC North 100 Level for all exhibit events.
- Patching into house sound is not permitted.
- PSAV must provide the microphones and mixers into the house sound system to ensure a uniform audio experience and to protect the integrity of the sound system. Clients may provide their own stand alone sound systems in the meeting spaces and ballroom if they do not wish to use PSAV.
- Use of the recording bay in the ballroom and meeting space is available for a fee.

CAD DRAWINGS

- The client's AV company, GSC or production company is responsible for developing CAD drawings.

ELECTRIC AND HVAC

- Regular electrician hours are 7:00 am - 11:30 pm. Early/late calls will result in double time charges.
- Any of ACC's approved electrical contractors may be used. Groups without a GSC and a large amount of power will be required by the ACC to use an approved contractor.
- Convenience wall outlets in each meeting room may be used at no charge. Always check with your electrical contractor on requirements and use or with the facility if it applies.
- Regular HVAC hours are 7 am - 11:30 pm. Calls before 7 am will result in double time charges and must be discussed with your Event Manager. ACC comfort zone is 68 - 72 degrees.

FOOD SERVICE & CONCESSION STANDS

- Concession stands inside the halls may be opened based on attendance and food and beverage minimum. Concession stand revenue does not apply to meeting room food and beverage credits. Seating for concession areas is provided by Aramark at no charge. Outside of the concession area, a rental fee will apply.
- 10% of the net catered revenue (excluding service fee and tax) at ACC will be credited to meeting room rental. This does not apply to the exhibit halls and the Arena unless they are used as meeting space.
- China service is available for up to 6,000 people (subject to availability) and is not recommended for exhibit halls. Buffet standard in all halls is biodegradable flatware and dishes.
- Food and beverage revenue from any room that has been sublet will not apply to meeting room credits.

ANAHEIM CONVENTION CENTER

Frequently Asked Questions & Answers

LOADING DOCKS, SECOND & THIRD FLOOR LOAD-IN AND STORAGE

- Load-in for ballrooms and 2nd/3rd floor meeting space is through the freight elevator located at the Hall E docks. There is about a 300 ft. push to the elevator.
- There are 37 non-exclusive docks (six in ACC North). They are shared between shows. GSCs are required to marshal loading docks.
- Hall A & the Arena share six non-exclusive docks. ACC North has six docks. Production or GSC trailers may be left in docks overnight during contracted dates.
- Pallet or box deliveries cannot arrive prior to the first day of move in.
- All freight is handled by your GSC.

OUTDOOR SPACE

- California and Katella Terraces - events must be set 25' from railing per fire code. * The Arena Plaza may be used exclusively by groups using the Arena and ACC North.
- The Grand Plaza may be used by groups in Halls A-E. Please consult with your Visit Anaheim sales representative or your ACC Event Manager for more information.
- There is no rental fee for food and beverage events on the Arena or Grand Plazas. For other events, a rental fee may apply.

PARKING

- 10 complimentary staff parking passes are provided. Additional passes may be available from your Event Manager at the standard parking fee.
- Parking availability is based on event need and designated parking will be determined by the Parking Manager or Parking Supervisor. ACC does have agreements with overflow lots close by if needed and available.
- On move in/out days, exhibitors may come in/out in paid parking lots. On event days parking is based on once in, once out only.

RE-KEY FEES

Each meeting room typically has 4-5 cylinders. Should a key be lost, a replacement fee will be charged. There is a charge to high-secure a room.

SIGNAGE & SPONSORSHIPS

- All signage must be approved through your Event Manager.
- Sponsorship signage is not allowed on the exterior of the building or street pole banners.
- Sponsorship window clings may be used on the ACC doors facing the lobby if they are not visible from the outside. Clings promoting the event in general, without sponsorship information, can be shown outside.
- Fees for interior sponsorship signage will be charged per piece, or based on the overall sponsorship amount, as determined by your Event Manager.
- * Clings promoting the event may be used on the pavers with Event Manager approval. Damages to the pavers will incur a fee.
- * There are designated areas for signage on the outside of the building for each exhibit hall and the placement of signage should be discussed with your Event Manager.

STAFFING

- Firewatch staff members may be required in the exhibit hall. Clients may use an approved outside security vendor for positions other than firewatch, with a schedule to be submitted to the ACC Crowd Control supervisor for review and approval.
- ACC has the right to require security as deemed necessary. ACC security and crowd control staff are required for public events and any event in the arena. Clients may use an approved vendor for a private event, with submittal of the proper paperwork.
- Armed security is not allowed and if this is needed for an event, it will be scheduled through the facility and provided by the Anaheim Police Department.
- Each event is required to have their own crowd control staff (one for every 500 people). This may vary depending on the type of event.
- Public events are required to utilize ACC staff for ticketing.
- An ACC nurse is required for open hours for all events with 300+ people. Certain types of events may require a nurse during move in and move out. Nurse stations are located in Lobby Hall A/B, Hall D, Arena, 3rd level and ACC North and will be scheduled at event location.

Frequently Asked Questions & Answers

- The rental fee includes one standard room set (theater, rounds, etc) for each meeting room. A standard set also includes chairs, a riser, a lectern, a registration table, head table water and an easel, by request. Additional easels or lecterns may incur charges based on available inventory.
- A schoolroom setup includes 8x18 tables with white vinyl and four chairs per table.
- Table linens can be provided for a fee.
- Rounds are 66", 10 chairs per table. There will be a charge for banquet table linens for non-food functions.
- ARAMARK will provide standard linens at no charge for meeting rooms with meal service.
- 6,000 chairs are included in the rental of the exhibit hall and both levels of ACC North for a general session. Additional chairs may be rented depending on inventory.
- Up to 20 pieces of complimentary riser will be provided in the arena, meeting rooms & ballroom and ACC North, as needed.
- Room re-sets on the same day or overnight will incur a fee unless the space is reset to a catered food function. A reset fee will apply to go from a catered function back to a meeting room setup.

- Trash and cleaning of the exhibit hall is the responsibility of the GSC during move in/out of halls. ACC handles trash receptacles and concession trash in the non-exhibit areas. During the event, the GSC cleans the booths & aisle carpet.
- There is a charge for compactors and bin drop off. Should an exhibitor leave trash by a trash receptacles, the GSC is required to remove it.

- Convention center hourly employees are represented by unions, including SEIU, Teamsters, AMEA and IBEW Local 46, UNITE HERE local 11, IATSE.
- Union workers are not required, but most General Service Contractors utilize union workers and have union guidelines.

- Vehicles for display inside exhibit halls must have less than 1/ tank of gas, the battery must be disconnected and flooring protection.
- Vehicles also must be clearly marked on floor plan.

- ACC provides complimentary tap water (in Cambros®) in finger lobbies and next to meeting space upon request at no charge. Pitchers & cups will be provided for the speaker/head tables upon request. ACC will provide a water station inside meeting rooms for a fee per room.
- ARAMARK will provide water coolers inside meeting rooms by request at a rate per cooler. Water on the exhibit show floor or in the first floor registration area is ordered through ARAMARK.
- Corkage for custom logo water bottles is 50% of the retail sale price per bottle.

NOTES

[illegible]



Visit Anaheim

2099 S. State College Blvd. Suite 600
P.O. Box 4270 Anaheim, CA 9280
714.765.2800 | visitanahaim.org/meetings
email: meeting.inquiry@visitanahaim.org

