



ANAHEIM
CONVENTION
CENTER
&
MEETING
EXHIBIT
SPACE



visit
Anaheim
YOUR SOCAL
MEETING DESTINATION



THE LARGEST CONVENTION CENTER ON THE WEST COAST

The Anaheim Convention Center (ACC) is consistently ranked as one of the top meeting venues in the U.S. in terms of its size, attendance, overall building services and amenities.

The LEED® certified 1.8 million-square-foot ACC is the largest convention center on the West Coast. This ultra-modern facility boasts the capability to host mega-conventions, meetings, tradeshows and events with ease.

ACC offers over one million square feet of exhibit space including three ballrooms totaling 238,000 square feet. The 2017 expansion, ACC North, adds 200,000 square feet of space with a 100,000 square foot carpeted column-free multi-purpose space featuring north-facing windows and movable airwalls for a variety of meeting room layout options.

In addition, the picturesque outdoor Palm Courts, Arena Plaza and Grand Plaza offer sunny possibilities for year-round special events, receptions and networking.

BY THE NUMBERS

- Exhibit space: **Over one million square feet**
- Seating space: **Arena seating for 7,500**
- Meeting rooms: **99**
- Meeting space: **352,000 square feet**
- Total facility area: **1.8 million square feet**
- One ballroom: **38,000 square feet**
- Two ballrooms: **100,000 square feet each**
- Three ballrooms: **238,000 square feet total**
- Pre-function lobby space: **222,192 square feet**
- Outdoor event space: **200,000 square feet**
- Total acreage: **53**

MORE REASONS TO CHOOSE THE ANAHEIM CONVENTION CENTER



ACC NORTH

Opened in 2017, ACC North includes 100,000 square feet of carpeted space on the 100 level and an additional 100,000 square feet of carpeted, column-free space on the 200 level, with direct access to an over 10,000 square foot outdoor balcony. This expansion includes natural light on each level with blackout capabilities, up to 35 rooms on the 200 level and up to 13 rooms on the 100 level with meeting rooms grouped into neighborhoods to allow for customizable climate and lighting control. The multi-purpose rooms and pre-function spaces feature 2,000 lbs. on ten foot centers. That's over 2,100 points to hang!

EXHIBIT SPACE

The ACC features over one million square feet of exhibit space, making it the largest exhibit facility on the West Coast. All halls are directly accessible from spacious pre-function areas.

GRAND PLAZA

Featuring two beautiful cascading fountains, palm and orange trees, the Grand Plaza is the ideal year-round outdoor venue for lunches, receptions, outdoor exhibits and more. Located in front of the ACC, between the Hilton Anaheim and Anaheim Marriott, this area has 36,000 square feet of usable space.

THE ARENA

The Arena is part of the convention center complex. It features 28,000 square feet (flat floor) and seats up to 7,500, much larger than most other convention center arenas.

ARENA PLAZA

The Arena Plaza offers 64,000 square feet of usable space and can accommodate receptions up to 5,500 people. It includes a courtyard area with a dramatic fountain centerpiece.

EASY ACCESS



BY AIR

- **JOHN WAYNE AIRPORT (SNA)** offers more than 45 nonstop destinations throughout the U.S., Canada, and Mexico, with more than 250+ average daily arrivals and departures.
13.5 miles / 20 Minutes from ACC
- **LONG BEACH AIRPORT (LGB)** offers domestic flights to more than 20 destinations within the U.S. and averages around 80 daily arrivals and departures.
18 miles / 30 Minutes from ACC
- **LOS ANGELES INTERNATIONAL AIRPORT (LAX)** is the 5th busiest airport in the world and averages 1,200 daily flights.
35 miles / 50 minutes from ACC
- **ONTARIO INTERNATIONAL AIRPORT (ONT)** is a full-service airport that offers daily nonstop commercial jet service to more than two dozen major airports in the U.S., Mexico, Central America and Taiwan.
37 miles / 43 minutes from ACC

GROUND TRANSPORTATION

ANAHEIM REGIONAL TRANSPORTATION INTERMODAL CENTER (ARTIC) OCVIBE.COM/ARTIC

This majestic \$182.5 million landmark and 67,000 sq. ft. terminal (within walking distance of Anaheim's Honda Center® and Angel Stadium of Anaheim) acts as a modernized SoCal transit hub serving Orange County.

- Located 2½ miles from ACC
- Provides access to Metrolink (local trains), Amtrak®, Orange County Transit Authority (OCTA) buses, Anaheim Resort Transportation (ART), shuttles, taxis, and tour & charter buses

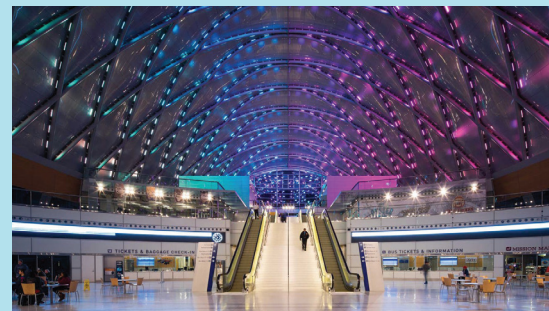



CATERING SERVICES

Our chefs are ready to customize your food and beverage experience with the freshest farm to fork ingredients from our local partners in Southern California. We feature unique culinary experiences throughout the building within each exhibit hall and lobby. On our plaza, we specialize in local award-winning food truck events with up to 27 local chef-owned and operated artisan food trucks paired with our local Anaheim brews.

GREEN PRACTICES

The ACC is a LEED® certified building featuring eco-friendly policies that include on-site recycling, a rooftop herb garden, composting, energy and water conservation, solar panels and the use of other sustainable solutions.

TECHNOLOGY SERVICES

The ACC features wired and wireless networks with an industry-best 10 GB connection from Smart City Networks, the nation's convention telecommunications and internet services leader. Free WiFi accessibility is available throughout the ACC.

PRODUCTION SERVICES

Encore, the ACC's on-site preferred production partner, provides A/V, rigging and meeting needs during events.

For the most up-to-date information regarding technology and production services, please visit our website.

CONCIERGE KIOSK

The "Dine Shop Play" is a concierge kiosk located at the pre-function space of exhibit halls, presenting deals on the Attendee Perks Pass for restaurants, shopping area and experiences near the Anaheim Convention Center.

VISIT ANAHEIM DESTINATION SERVICES

As destination experts, Visit Anaheim ensures a seamless experience for meeting professionals and their guests. Our consultative approach allows us to customize our entire collection of services to best fit the needs of each client, including efficient site visits, pre-planning support, and destination welcome and concierge program to maximize attendee engagement.

SUSTAINABILITY AT ANAHEIM CONVENTION CENTER



We embrace our responsibility to lead in sustainability—making eco-friendly choices that reduce our environmental impact. Since 2004, our in-house environmental team has driven sustainable initiatives. By 2011, we expanded efforts with an environmental internship program to further our mission.

KEY FOCUS AREAS

- **Sourcing** – Locally grown, organic, and humane food sourcing.
- **Waste Management** – Reducing landfill waste and promoting recycling.
- **Energy Conservation** – Cutting consumption through efficient practices.
- **Education & Awareness** – Training staff and guests on sustainability.

EXPANDED INITIATIVES

- Fair Trade & Rainforest Alliance Partnerships
- Sustainable Beverage Programs
- Green Zone Recycling Center
- Food Donation Program
- Green Roof for Energy Efficiency



SUSTAINABILITY CONTINUED

SUSTAINABLE MENU DEVELOPMENT

- **Farm to Fork** – Sourcing local, organic ingredients within 120 miles, cutting 500,000+ miles of food travel annually.
- **Brandt Beef** – Grass-fed, humane-certified beef from a family-owned SoCal ranch.
- **Sustainable Seafood** – First convention center recognized by Monterey Bay Aquarium's Seafood Watch.
- **Ethically Sourced Coffee** – Serving Rainforest Alliance & Fair-Trade Certified brews.



MORE ECO-FRIENDLY CHOICES

- rBGH-Free Dairy & Cage-Free, Humane-Certified Eggs
- Free-Range & Organic Poultry, Pork & Lamb
- Composting & Waste Reduction Initiatives
- Sustainable Event Planning – Utilize our Event Checklist to align your meeting with social, environmental, and economic sustainability goals.

COMPOSTING FOR A SUSTAINABLE FUTURE

- Partnering with Orange Home Grown Foundation to support a healthy, sustainable food system.
- 65,000 lbs. of kitchen scraps composted annually, including fruits, vegetables, and coffee grounds.
- On-site dehydrators process waste, producing 250 lbs. of compost in 2023.

AT THE ANAHEIM CONVENTION CENTER, SUSTAINABILITY ISN'T JUST A GOAL- IT'S OUR COMMITMENT TO THE FUTURE.



ACCESSIBILITY

SERVICES

WHEELCHAIR/MOBILITY SCOOTER RESERVATIONS IN ANAHEIM:

- **Soaring Scooters:** 855-981-7627
- **D&R Mobility Scooter Rental:** 714-883-8761
- **One-Stop Mobility:** 714-533-1444
- **Scooter Bug Rentals:** 1-800-726-8284
- **OK Medical Supply:** 562-367-9690

Wheelchair and scooter rentals are subject to availability. It's recommended to reach out well before the event.

ASL INTERPRETERS/CART SERVICES

Events are responsible for contracting with ASL Interpreters/ CART Services.

SERVICE ANIMALS

Under ADA regulations, the definition of a "service animal" is limited to a dog or a miniature horse that is individually trained to do work or perform tasks for an individual with a disability. The task(s) performed by the animal must be directly related to the person's disability. Under the ADA, "comfort", "therapy", and/ or "emotional support" animals do not qualify as service animals.



ACCESSIBLE PARKING

The most accessible parking options are available in Car Park 1 and Car Park 4. Let the attendant know you need ADA parking to be directed appropriately.

ELEVATORS

- **ACC South:** One (1) elevator in Lobby D and one (1) elevator in Lobby B
- **ACC North:** Two (2) elevators, one (1) on each side of the lobby level

ACCESSIBLE SEATING IN THE ACC ARENA

ADA seating is located on the Arena floor as there are no elevators located in the Arena.

EMERGENCY EVACUATION

The Safe Rooms/Area of Refuge (on the 2nd & 3rd floors) are for mobility impaired guests that cannot traverse the emergency stairwells.

ACCESSIBILITY CONTINUED

FAMILY RESTROOMS & FACILITIES AT THE ANAHEIM CONVENTION CENTER

FAMILY RESTROOMS:

Total of 6 conveniently located in Lobby A, ACC North Plaza Level, and other accessible areas.

RESTROOMS WITH CHANGING TABLES:

- **ACC North:**
Total of 15 restrooms: 10 standard (5 men's, 5 women's) and 5 dedicated family restrooms. Each features changing stations.
- **ACC South & Arena:**
Total of 17 restrooms: 16 standard (8 men's, 8 women's) and 1 family restroom near Hall A. All equipped with changing stations.
- **Exhibit Halls:** Total of 22 restrooms: 12 standard (4 men's, 8 women's). Includes 10 with convenient counters for changing.
- **Meeting Rooms on 2nd & 3rd Floors:**
Total of 14 restrooms: 8 standard (4 men's, 4 women's) with all having changing counters.

MOTHER'S ROOM

There are **two (2) lactation rooms** available for use within ACC South: room 109 located in Lobby A and room 127 located in Lobby D. There is (1) lactation room located at ACC North on the Plaza Level.

ACCESSIBILITY FEATURES:

- **ADA Accessible Doors:** 15 push-button doors are available for easy access and are located at key entry points, including Exhibit Halls A to E, and both ACC North and ACC Lobby entries.



ANAHEIM CONVENTION CENTER MARSHALING YARD

CLAUDINA MARSHALING YARD

The Anaheim Convention Center (ACC) officially opened the Claudina Marshaling Yard, located on the corner of Anaheim Blvd. and Claudina Way. The 6 acres of on-grade asphalt is just off the 5 freeway, within 2 miles of the ACC.

The Claudina Marshaling Yard's proximity to the Anaheim

Convention Center is a significant advantage for event organizers. This yard enhances the efficient management of material handling for events, ensuring timely operations from start to finish. The yard supports everything from receiving freight and preparing for move-in and move-out to providing storage during event days, all of which contribute to smoother, streamlined event logistics.

MARSHALING YARD-CLAUDINA LOT

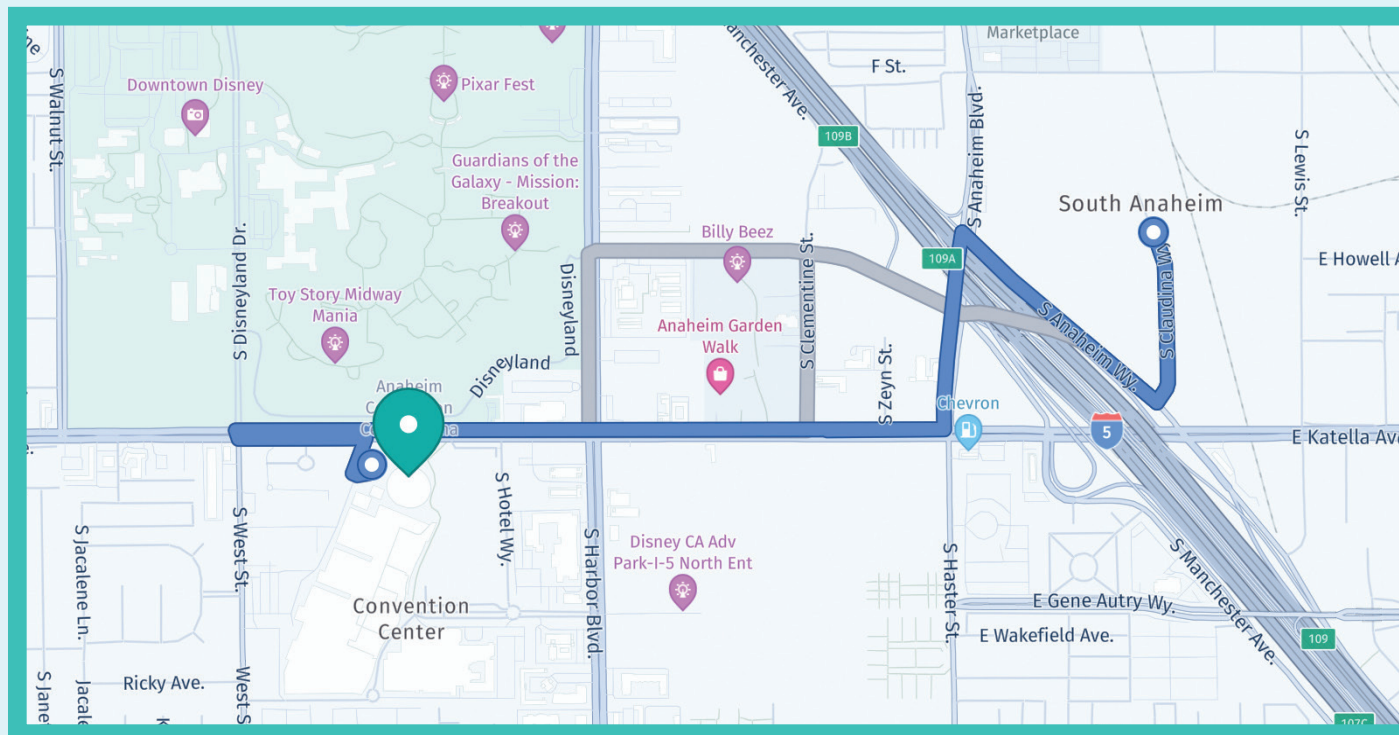

CLAUDINA LOT

1629 S. Claudina Way
Anaheim, CA 92805
2.1 Miles to ACC

ACC PLANNING TOOLKIT



Below are common expenses for events at the Anaheim Convention Center (ACC). A complete list of potential charges are available, your event manager may provide an estimate for planning.

ACC PARKING

Parking is currently \$25 per day with no in and out privileges, no overnight parking. Rate subject to change.

MEDICAL SERVICES PERSONNEL

Medical services personnel is required during move in, event days and/or move out when there are over 300 attendees and if move in/out activity involves use of forklifts or aerial lifts.

CROWD CONTROL PERSONNEL

Crowd Control personnel to include fire watch, ticket taking and public safety are exclusively provided by ACC personnel.

SECURITY

Each event is required to have security personnel. ACC has the right to determine the minimum level of security required for each event. A minimum of one (1) security

personnel for every 500 attendees is required. If armed security is required, it needs to be scheduled through the ACC and provided by the Anaheim Police Department exclusively.

ELECTRICAL

The ACC has contractual agreements with approved electrical providers. The client's selected electrical service provider is responsible for providing show power to all event areas as well as all food related portable concession locations within the facility. This includes any retail foods (i.e. outdoor food trucks, portables in the Arena Plaza, Grand Plaza areas) These are located outdoors and are part of the Anaheim Convention Center property.

ROOM RESET FEES

Rental of each meeting room includes one complimentary standard set (classroom, theater or rounds.) Reset fees for either same day or overnight resets are billable at 50% of the prevailing room rental rate. Reset fees do not apply if the reset is to a catered function.

TRASH AND CLEANING

The ACC cleans all common areas. Registration and/or exhibit areas are the responsibility of the general service contractor /client to arrange trash disposal. Drop off bins and compactors are an additional charge based on event needs.

ACC LABOR OVERTIME

Personnel will be billed for extended service hours and on classified federal holidays.

- Double time will be charged for any electrician/HVAC technician labor calls that begin before 7:00AM and end after 11:30PM.
- Time-and-one-half will be charged for all personnel classifications, on holidays. Additional labor fees may apply based on event specifications.

WATER SERVICE

Water bottle filling stations are available in all public lobbies and exhibit halls. Water service for speakers/head tables (individual water bottles) and water coolers are available for purchase through ACC Catering.

ACC PLANNING TOOLKIT CONTINUED

CHAIRS

General sessions held in the exhibit halls include a maximum of 2,000 complimentary chairs. Additional chairs are provided at prevailing rates.

TABLE LINENS

Standard table linens will be provided for meeting rooms with meal service set in rounds. Upgraded linens are an additional charge. All meetings set in rounds, without meal service, will incur a per table linen fee. Classroom set includes complimentary vinyl table coverings. If linens are preferred for classroom style set up, a per-table linen fee will apply.

ROOM KEY AND RE-KEYS

There is a charge to re-key meeting rooms to high-secure a room. Up to five (5) complimentary copies of the key may be provided. Additional copies are chargeable. A replacement fee will apply if keys are lost.

ADVERTISING / BRANDING

Sponsorship and advertising include banners, signs or other

items that are displayed in public areas are subject to a flat rate or a percentage of sponsorship. Your ACC event manager will provide a copy of the fees and guidelines.

UNIONS

Union workers are not required; however, unions are represented in the building and most general contractors utilize union workers and have union guidelines.

FLOOR PLAN APPROVAL

Client is responsible to submit floor plans for approvals to both Anaheim Fire & Rescue and ACC management prior to any sales of exhibit space. Approvals are required with a minimum of thirty (30) days prior to the event.

Fees apply for submitting plans to AF&R.

CAD DRAWINGS / DIAGRAMS

Client AV company, general service contractor or production company is responsible for creating diagrams or CAD drawings.



EXCLUSIVE AND PREFERRED PROVIDERS

CATERING SERVICES

Aramark Sports & Entertainment Services is the exclusive food and beverage service provider. They have a wide variety of menu and service options available.

PRODUCTION SERVICES

Encore is the preferred vendor for A/V and is the exclusive provider for all rigging labor and rigging equipment in the Ballroom, meeting rooms, Arena and ACC North, as well as the exhibit halls when used

for non-exhibit events. House sound is exclusively managed through Encore. Mixing of sound systems is not permitted.

TECHNOLOGY SERVICES

Smart City Networks is the exclusive data provider for client and exhibitor voice, data, internet, cable TV and networking services. Cable pulling is exclusive to Smart City as well.

ACC CAMPUS

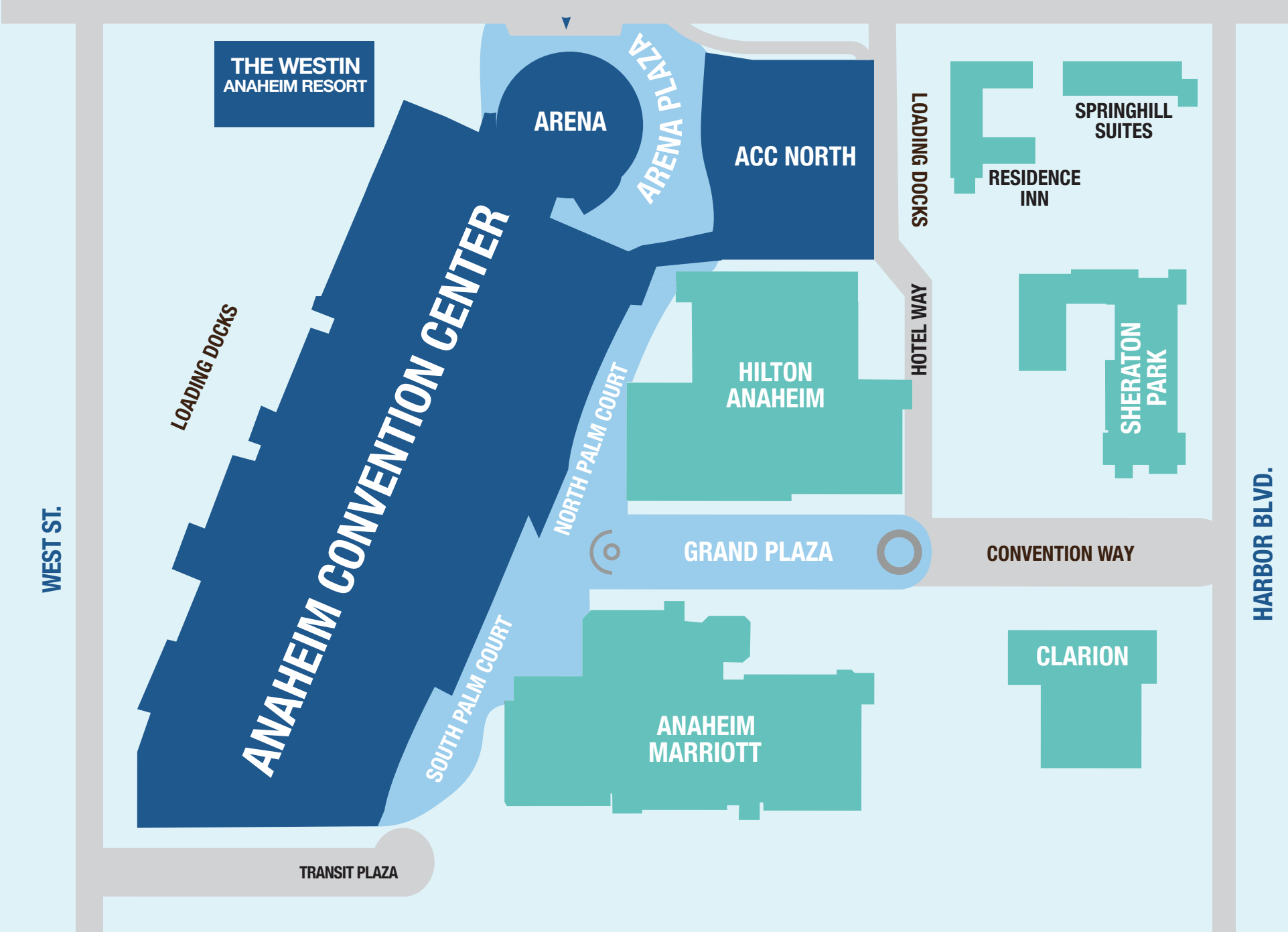

PARTNER HOTELS

- 1 Anaheim Castle Inn & Suites
- 2 Anaheim Fairfield Inn by Marriott
- 3 Anaheim Majestic Garden Hotel
- 4 Anaheim Marriott
- 5 Anaheim Portofino Inn & Suites
- 6 Cambria Hotel & Suites Anaheim Resort
- 7 Clarion Hotel Anaheim Resort
- 8 Clementine Hotel & Suites Anaheim
- 9 Cortona Inn & Suites Anaheim Resort
- 10 Courtyard Anaheim Theme Park Entrance
- 11 Courtyard by Marriott Anaheim Resort / Convention Center
- 12 Desert Palms Hotel & Suites Anaheim Resort
- 13 Disneyland® Resort, Disney's Grand Californian Hotel® & Spa
- 14 Disneyland® Resort, Disneyland® Hotel
- 15 Disneyland® Resort, Pixar Place Hotel
- 16 DoubleTree Suites by Hilton™ Hotel Anaheim Resort
- 17 Element Anaheim Resort Convention Center
- 18 Four Points by Sheraton Anaheim
- 19 Grand Legacy at The Park
- 20 Hampton Inn & Suites Anaheim Resort Convention Center
- 21 Hilton Anaheim
- 22 Homewood Suites by Hilton Anaheim Resort
- 23 Hotel Indigo
- 24 Hotel Lulu
- 25 Howard Johnson Anaheim Hotel and Water Playground
- 26 Hyatt House at Anaheim Resort
- 27 Hyatt Place at Anaheim Resort
- 28 JW Marriott, Anaheim Resort
- 29 Residence Inn by Marriott Anaheim
- 30 Sheraton Park Hotel at the Anaheim Resort
- 31 Sonesta Anaheim Resort
- 32 SpringHill Suites Anaheim-Maingate
- 33 SpringHill Suites at Anaheim Resort
- 34 The Anaheim Hotel
- 35 The Westin Anaheim Resort

GARDEN GROVE HOTELS:

- 36 Anaheim Marriott Suites
- 37 Delta Hotels Anaheim Garden Grove
- 38 Embassy Suites by Hilton Anaheim South
- 39 Great Wolf Lodge®
- 40 Hampton Inn & Suites by Hilton Anaheim/Garden Grove
- 41 Hilton Garden Inn Anaheim/Garden Grove
- 42 Homewood Suites by Hilton Anaheim-Main Gate Area
- 43 Hyatt Regency Orange County
- 44 Residence Inn Anaheim Resort Area/Garden Grove
- 45 Sheraton Garden Grove

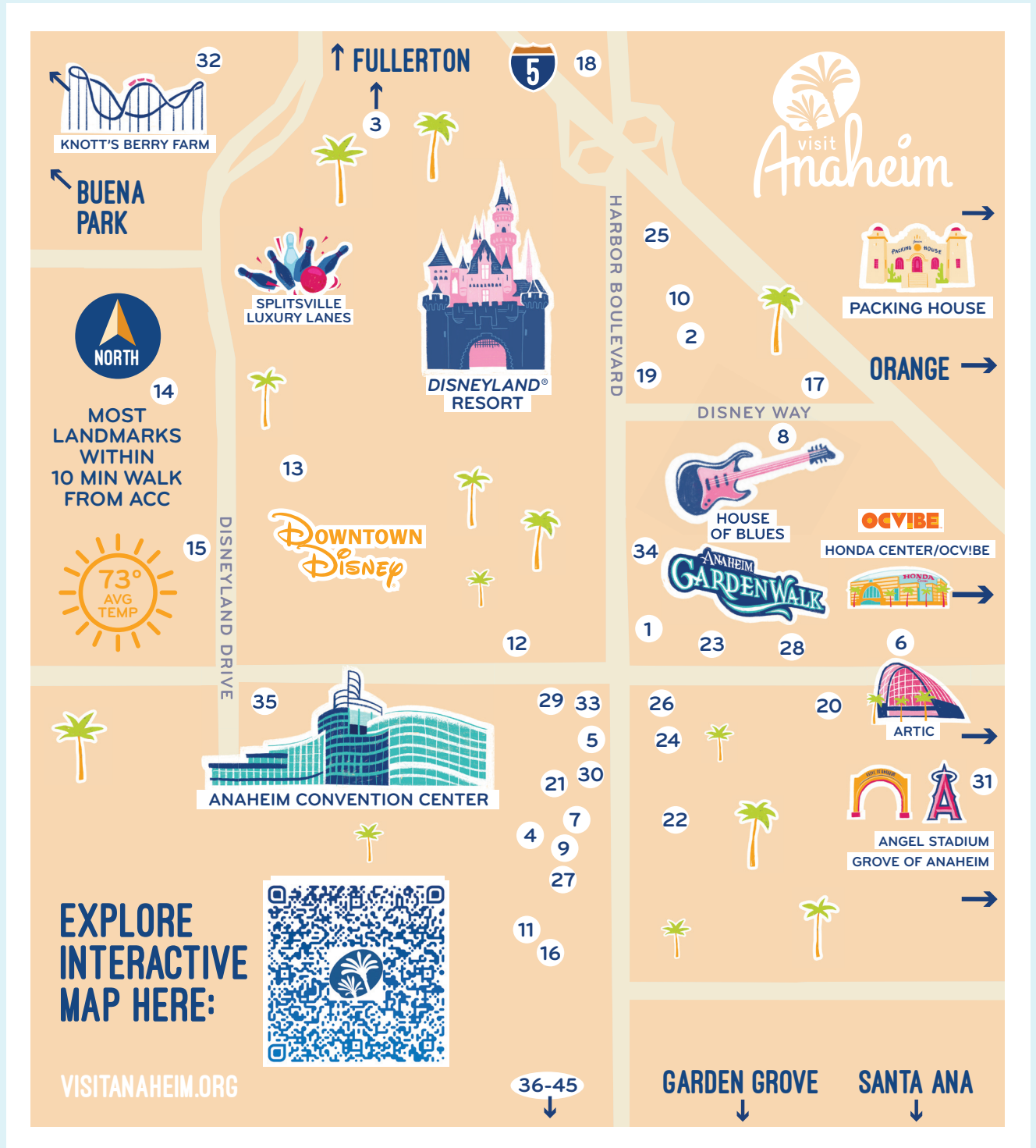



Orange County: 505 Hotels / 61,233 Rooms* • Garden Grove: 25 hotels / 4,413 rooms*

Within 2 miles: 112 Hotels / 23,478 Rooms

Within 1 mile: 79 Hotels / 18,333 Rooms

Within 1/2 mile: 41 Hotels / 9,670 Rooms

Within 100 yards: 11 Hotels / 4,873 Rooms



Data sourced in March 2025. *Source: Costar STR.

ACC | Number of Hotel Rooms and proximity to the Anaheim Convention Center

EXPERIENCE SUN-SOAKED SOUTHERN CALIFORNIA WITH THE CONVENIENCE OF A MEETING DESTINATION THAT'S JUST STEPS AWAY FROM EVERYWHERE YOU'LL WANT TO BE.



EXCEPTIONAL HOTELS

Linked by the plazas, four world-class hotels – Anaheim Marriott, Hilton Anaheim, Sheraton Park Hotel at the Anaheim Resort and The Westin Anaheim Resort – offer business amenities, luxury and a combined 3,705 rooms and 317,000 square feet of well-appointed, newly renovated function space. There are 11 hotels, totaling 4,873 rooms within 100 yards of the convention center.

AFTER HOURS

Our nightlife scene is evolving with OCVICE developments underway. In the meantime, visitors can enjoy concerts at the House of Blues® Anaheim, entertainment at Downtown Disney® District, shopping at the Anaheim GardenWalk, happy-hour hangouts on rooftop lounges, pro sports games at Honda Center and event more to explore at the Anaheim Packing District and Downtown Anaheim.

CULINARY EXPERIENCES

While Anaheim is a top convention destination, dining here is anything but conventional. With over 500 restaurants, we're very much a foodie city. Our eateries run the gamut – from unique diners and health-conscious hotspots, ethnic enclaves with authentic favorites to the ever-expanding brewery scene. There's a flavor for every tastebud.

WALKABILITY AND SAFETY

Anaheim's safety score continues to rank high among the top U.S. cities. The ACC's central location enables exhibitors and attendees alike to easily walk to and from hotels, entertainment, and restaurants, safely. Visitors will be steps away from all the excitement when walking around Anaheim.

ACC TRI LEVEL FLOOR PLAN DIAGRAM

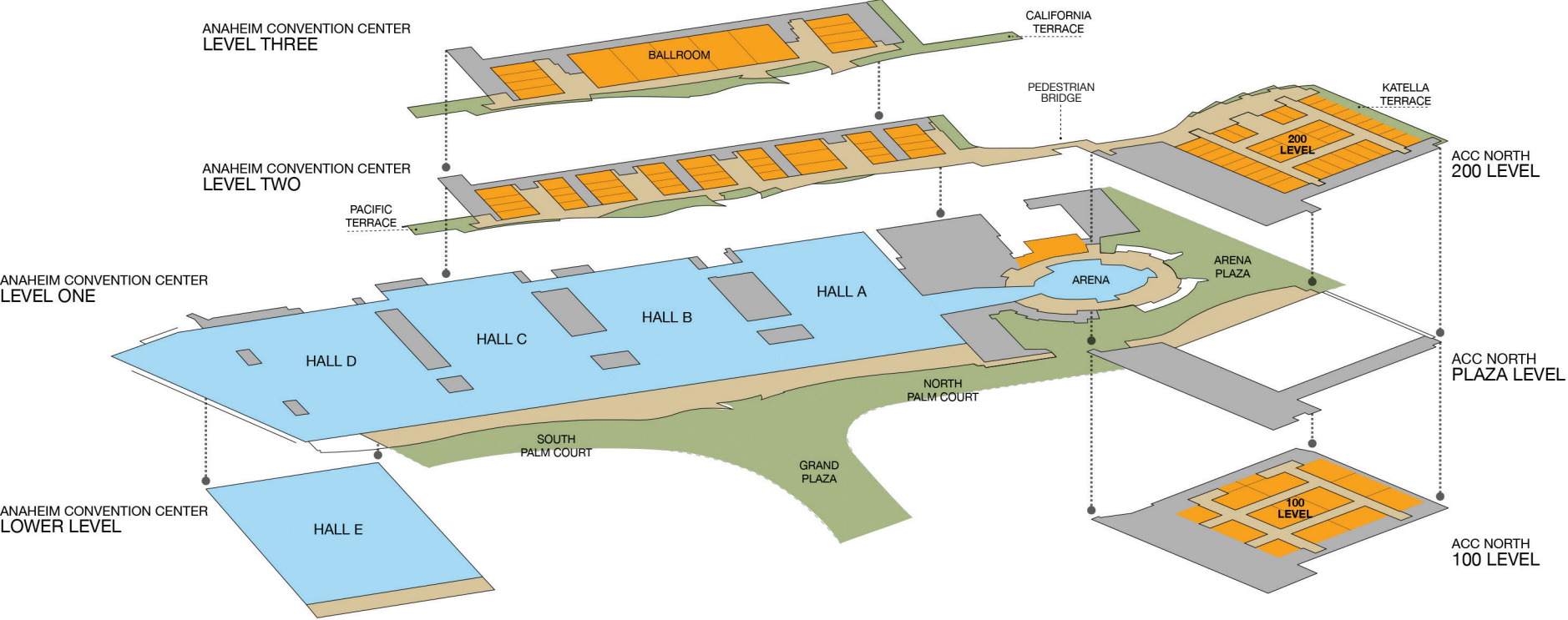

LEGEND

- EXHIBIT SPACE
- MEETING ROOM
- PRE-FUNCTION SPACE
- TERRACE/PLAZA

ANAHEIM CONVENTION CENTER LEVEL ONE



ANAHEIM CONVENTION CENTER CAPACITIES

EXHIBIT HALLS AND ARENA

EXHIBIT HALLS – 813,607 Total Square Feet

ROOM NAME	DIMENSIONS	SQUARE FEET	CEILING HEIGHT	THEATER	BANQUET	10' X 10' BOOTHES	8' X 10' BOOTHES	TOTAL BOOTHES
Hall A	250' x 530'	145,841	18'6"-24'	12,000	9,000	718	18	736
Hall B	250' x 530'	147,335	20'6"-25'	12,250	9,200	718	18	736
Hall C	245' x 575'	155,673	20'6"-25'	12,900	9,700	759	32	791
Hall D	325' x 472'-530'	221,284	25'	15,000	13,800	1,140	–	1,140
Hall E	270' x 535'	143,474	13'8"	–	8,000	650	–	650

ARENA – 28,140 Total Square Feet (flat floor) - 7,500 Capacity, Stadium Style Seating

ROOM NAME	DIMENSIONS	SQUARE FEET	CEILING HEIGHT	THEATER	CLASSROOM	BANQUET	10' X 10' BOOTHES
Arena	146' x 207'	28,140	45'-89'	7,500	–	1,200	145
Arena Lobby	75' x 144'	10,800	8'-21'6"	–	–	–	40
AR1	62' x 50'	3,100	15'	350	175	200	–
AR2	57' x 50'	2,100	15'	150	75	75	–
AR1 + AR2 Combined	62' x 100'	5,200	15'	500	250	275	–

ANAHEIM CONVENTION CENTER LEVEL TWO

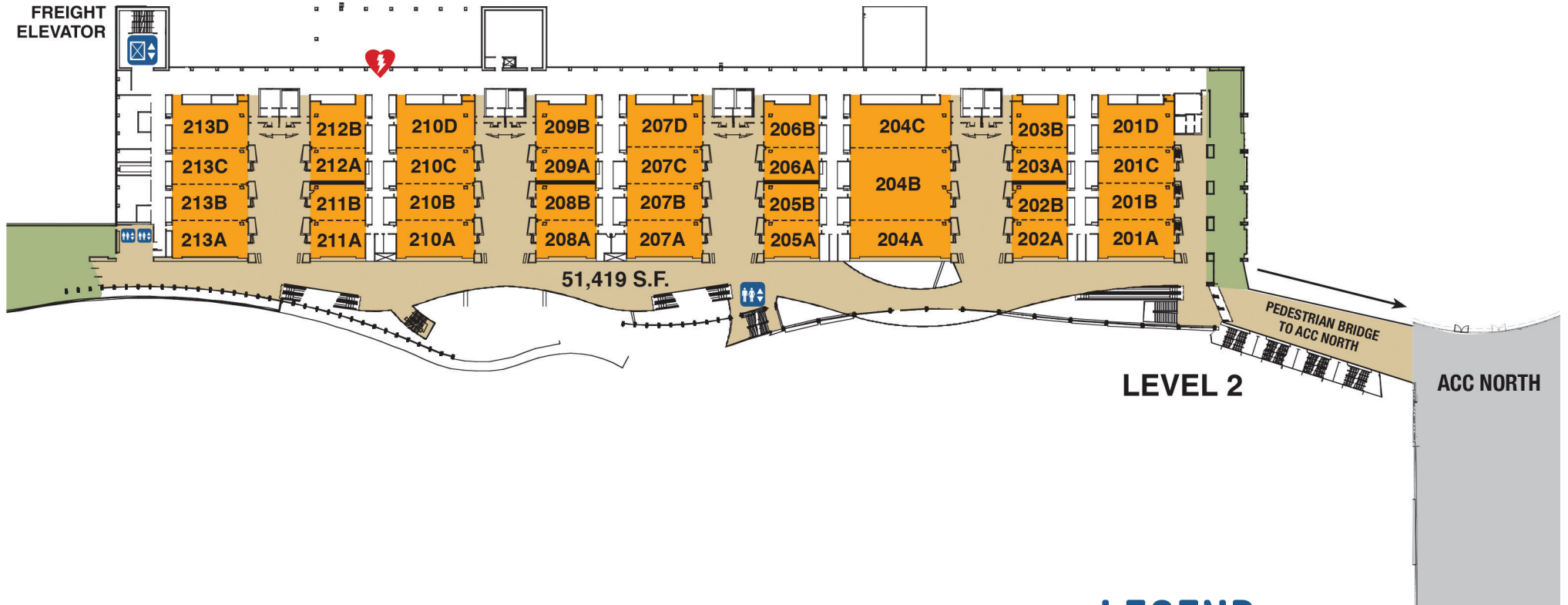

LEGEND

- PRE-FUNCTION SPACE
- MEETING ROOM
- TERRACE
- + ⚡ FIRST AID STATION WITH DEFIBRILLATOR
- ↑ ↓ PASSENGER ELEVATOR
- ⓧ ↑ ↓ FREIGHT ELEVATOR

ANAHEIM CONVENTION CENTER CAPACITIES

LEVEL TWO

SECOND LEVEL MEETING ROOMS – 65,583 Square Feet

ROOM NAME	DIMENSIONS	SQUARE FEET	CEILING HEIGHT	THEATER	CLASS-ROOM 8' X 18" TABLES	BANQUET 66" ROUNDS
OVER HALL A						
201A	62'6" x 30'	1,875	17'6"	188	124	130
201B	62'6" x 30'	1,875	17'6"	188	124	130
201C	62'6" x 30'	1,875	17'6"	188	124	130
201D	62'6" x 36'	2,250	17'6"	225	152	150
201AB	62'6" x 60'	3,750	17'6"	376	248	260
201ABC	62'6" x 90'	5,625	17'6"	564	372	390
201ABCD	62'6" x 126'	7,875	17'6"	789	524	540
202A	45'6" x 30'	1,365	17'6"	136	92	100
202B	45'6" x 30'	1,365	17'6"	136	92	100
202AB	45'6" x 60'	2,730	17'6"	272	184	200
203A	45'6" x 30'	1,365	17'6"	136	92	100
203B	45'6" x 36'	1,638	17'6"	164	112	110
203AB	45'6" x 66'	3,003	17'6"	300	204	210
204A	83' x 30'	2,490	17'6"	249	168	170
204B	83' x 60'	4,980	17'6"	498	336	340
204C	83' x 36'	2,988	17'6"	299	200	200
204AB	83' x 90'	7,470	17'6"	747	504	510
204BC	83' x 90'	7,968	17'6"	797	536	540
204ABC	83' x 126'	10,458	17'6"	1,046	704	710
OVER HALL B						
205A	45'6" x 30'	1,365	17'6"	136	92	100
205B	45'6" x 30'	1,365	17'6"	136	92	100
205AB	45'6" x 60'	2,730	17'6"	272	184	200
206A	45'6" x 30'	1,365	17'6"	136	92	100
206B	45'6" x 36'	1,638	17'6"	164	112	110
206AB	45'6" x 66'	3,003	17'6"	300	204	210
207A	62'6" x 30'	1,875	17'6"	188	124	130
207B	62'6" x 30'	1,875	17'6"	188	124	130
207C	62'6" x 30'	1,875	17'6"	188	124	130
207D	62'6" x 36'	2,250	17'6"	225	152	150

ROOM NAME	DIMENSIONS	SQUARE FEET	CEILING HEIGHT	THEATER	CLASS-ROOM 8' X 18" TABLES	BANQUET 66" ROUNDS
207AB	62'6" x 60'	3,750	17'6"	376	240	260
207ABC	62'6" x 90'	5,625	17'6"	564	372	390
207ABCD	62'6" x 126'	7,875	17'6"	789	524	540
208A	49' x 30'	1,470	17'6"	147	100	100
208B	49' x 30'	1,470	17'6"	147	100	100
208AB	49' x 60'	2,940	17'6"	294	200	200
209A	49' x 30'	1,470	17'6"	147	100	100
209B	49' x 36'	1,764	17'6"	176	120	120
209AB	49' x 66'	3,234	17'6"	323	220	220
OVER HALL C						
210A	64'6" x 30'	1,935	17'6"	194	128	130
210B	64'6" x 30'	1,935	17'6"	194	128	130
210C	64'6" x 30'	1,935	17'6"	194	128	130
210D	64'6" x 36'	2,322	17'6"	232	152	160
210AB	64'6" x 60'	3,870	17'6"	388	256	260
210ABC	64'6" x 90'	5,805	17'6"	582	384	390
210ABCD	64'6" x 126'	8,127	17'6"	814	536	550
211A	45'6" x 30'	1,365	17'6"	136	92	100
211B	45'6" x 30'	1,365	17'6"	136	92	100
211AB	45'6" x 60'	2,730	17'6"	272	184	200
212A	45'6" x 30'	1,365	17'6"	136	92	100
212B	45'6" x 36'	1,638	17'6"	164	112	110
212AB	45'6" x 66'	3,003	17'6"	300	204	210
213A	62'6" x 30'	1,875	17'6"	188	124	130
213B	62'6" x 30'	1,875	17'6"	188	124	130
213C	62'6" x 30'	1,875	17'6"	188	124	130
213D	62'6" x 36'	2,250	17'6"	225	152	150
213AB	62'6" x 60'	3,750	17'6"	376	248	260
213ABC	62'6" x 90'	5,625	17'6"	564	372	390
213ABCD	62'6" x 126'	7,875	17'6"	789	524	540

ANAHEIM CONVENTION CENTER

LEVEL THREE

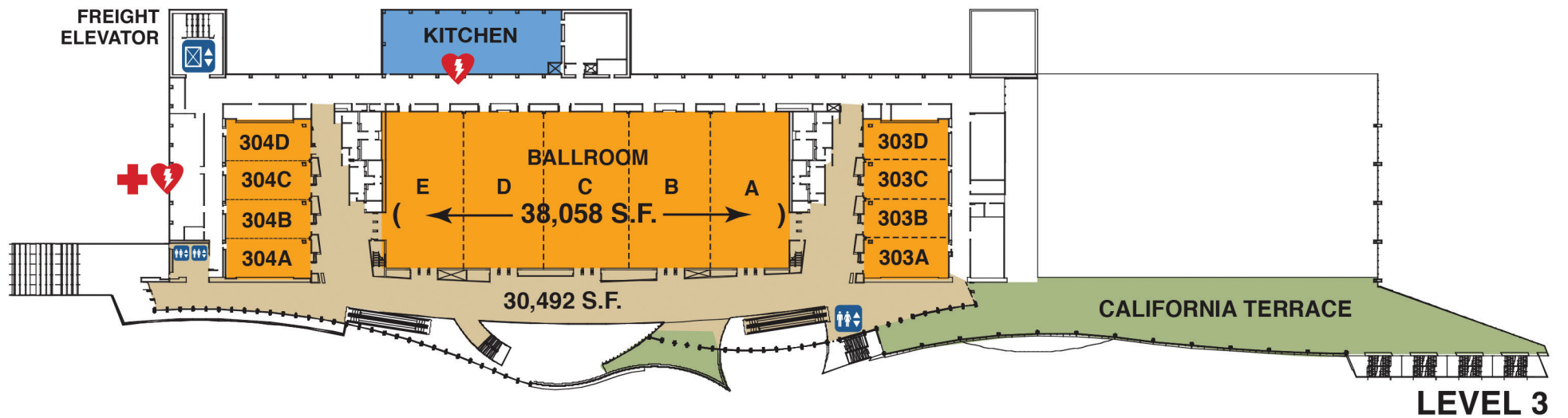

LEGEND

- PRE-FUNCTION SPACE
- MEETING ROOM
- TERRACE
- + ♥ ⚡ FIRST AID STATION WITH DEFIBRILLATOR
- ↑ ↓ PASSENGER ELEVATOR
- ⊠ ↑ ↓ FREIGHT ELEVATOR

ANAHEIM CONVENTION CENTER CAPACITIES

LEVEL THREE

THIRD LEVEL MEETING ROOMS – 15,840 Square Feet

ROOM NAME	DIMENSIONS	SQUARE FEET	CEILING HEIGHT	THEATER	CLASSROOM 8' X 18" TABLES	BANQUET 66" ROUNDS
303A	66' x 30'	1,980	17'6"	198	132	140
303B	66' x 30'	1,980	17'6"	198	132	140
303C	66' x 30'	1,980	17'6"	198	132	140
303D	66' x 30'	1,980	17'6"	198	132	140
303AB	66' x 60'	3,960	17'6"	396	264	270
303ABC	66' x 90'	5,940	17'6"	594	396	420
303ABCD	66' x 126'	7,920	17'6"	792	528	560
304A	66' x 30'	1,980	17'6"	198	132	140
304B	66' x 30'	1,980	17'6"	198	132	140
304C	66' x 30'	1,980	17'6"	198	132	140
304D	66' x 30'	1,980	17'6"	198	132	140
304AB	66' x 60'	3,960	17'6"	396	264	270
304ABC	66' x 90'	5,940	17'6"	594	396	420
304ABCD	66' x 126'	7,920	17'6"	792	528	560

THIRD LEVEL BALLROOMS – 38,058 Square Feet

ROOM NAME	DIMENSIONS	SQUARE FEET	CEILING HEIGHT	THEATER	CLASSROOM 8' X 18" TABLES	BANQUET 66" ROUNDS
Ballroom A	120' x 63'	7,560	27'3"-28'3"	756	504	510
Ballroom B	122' x 62'6"	7,625	27'3"-28'3"	763	508	510
Ballroom C	123' x 62'6"	7,688	27'3"-28'3"	769	512	520
Ballroom D	122' x 62'6"	7,625	27'3"-28'3"	763	508	510
Ballroom E	120' x 63'	7,560	27'3"-28'3"	756	504	510
Ballroom AB	Combined	15,185	27'3"-28'3"	1,519	1,012	1,020
Ballroom ABC	Combined	22,873	27'3"-28'3"	2,288	1,524	1,540
Ballroom ABCD	Combined	30,498	27'3"-28'3"	3,051	2,032	2,050
Ballroom ABCDE	Combined	38,058	27'3"-28'3"	3,807	2,536	2,560

ACC NORTH

100 LEVEL



This space can also be used as one room at 100,000 S.F., or two rooms at 50,000 S.F., or many other combinations.

LEGEND

- MEETING ROOM
- SHOW OFFICES
- PRE-FUNCTION SPACE
- ↑
↓
↑
↓ PASSENGER ELEVATOR
- ⊠
↓
⊠
↓ FREIGHT ELEVATOR

ACC NORTH CAPACITIES

100 LEVEL

100,000 gsf of carpeted, flexible multipurpose meeting or exhibit space
 Maximum of 13 meeting rooms (Ranging from 3,435 S.F. - 5,720 S.F.)
 Ceiling Height = 25 ft

ROOM NAME	DIMENSIONS	SQUARE FEET	THEATER	CLASSROOM <i>8' x 18" Tables</i>	BANQUET ROUNDS <i>66" Rounds</i>	10' X 10' BOOTHS
Entire First Level		100,000	10,000	4,160	5,000	500
151	55'9" x 58'4"	3,252	355	219	260	16
152	55'9" x 89'8"	4,999	544	336	408	24
153	55'9" x 58'4"	3,252	355	219	260	16
154	87'2" x 60'10"	5,303	570	350	430	26
155	59'8" x 89'8"	5,350	570	350	430	26
156	87'2" x 61'	5,317	570	350	430	26
157	59'8" x 89'8"	5,350	570	350	430	26
158	92'2" x 60'10"	5,607	610	370	450	27
159	59'8" x 89'8"	5,350	570	350	430	26
160	92'2" x 61'	5,622	610	370	450	26
161	60'11" x 88'4"	5,381	570	350	430	26
162	60'11" x 89'8"	5,462	570	350	430	26
163	60'11" x 88'4"	5,381	570	350	430	26
COMBINATIONS						
154 + 158	179'4" x 60'10"	10,910	1,180	720	880	53
155 + 157 + 159	179' x 89'8"	16,050	1,710	1,050	1,290	78
156 + 160	179'4" x 61'	10,939	1,180	720	880	52
161 + 162 + 163	60'11" x 266'4"	16,224	1,710	1,050	1,290	78

ACC NORTH

200 LEVEL



This space can also be used as one room at 100,000 S.F., or two rooms at 50,000 S.F., or many other combinations.

LEGEND

- MEETING ROOM
- PRE-FUNCTION SPACE
- TERRACE
- ♥+ FIRST AID STATION
- ↑
↓
↑
↓ PASSENGER ELEVATOR
- ↑
↓
↑
↓ FREIGHT ELEVATOR

ACC NORTH CAPACITIES

200 LEVEL

100,000 gsf of carpeted, pillar-free, flexible multipurpose meeting space

Maximum of 35 meeting rooms (Ranging from 1,200 S.F. - 5,325 S.F.)

Ceiling Height = 25 ft

ROOM NAME	DIMENSIONS	SQUARE FEET	THEATER	CLASSROOM 8' x 18" Tables	BANQUET ROUNDS 66" Rounds	10' X 10' BOOTHS
Entire Second Level		100,000	10,000	4,160	8320	500
251 A	58'7" x 28'4"	1,660	180	110	130	8
251 B	58'7" x 29'8"	1,738	180	110	130	8
251 C	58'7" x 29'8"	1,738	180	110	130	8
251 AB	58'7" x 58'	3,398	360	220	260	16
251 BC	58'7" x 59'4"	3,476	360	220	260	16
251 ABC	58'7" x 87'8"	5,136	540	330	430	24
252 A	58'7" x 29'8"	1,738	180	110	130	8
252 B	58'7" x 29'8"	1,738	180	110	130	8
252 C	58'7" x 29'8"	1,738	180	110	130	8
252 AB / 252 BC	58'7" x 59'4"	3,476	360	230	260	16
252 ABC	58'7" x 89'	5,214	540	350	390	24
253 A	58'7" x 29'8"	1,738	180	110	130	8
253 B	58'7" x 29'8"	1,738	180	110	130	8
253 C	58'7" x 43'5"	2,543	270	170	200	12
253 AB	58'7" x 59'4"	3,476	370	230	280	16
253 BC	58'7" x 73'1"	4,281	440	270	320	20
253 ABC	58'7" x 102'9"	6,019	640	390	460	29
254 A	29'8" x 58'4"	1,731	180	110	130	8
254 B	29'8" x 58'4"	1,731	180	110	130	8
254 AB	59'4" x 58'4"	3,462	360	230	260	16
255 A	59'8" x 29'8"	1,770	190	120	140	8
255 B	59'8" x 29'8"	1,770	190	120	140	8
255 C	59'8" x 29'8"	1,770	190	120	140	8
255 AB / 255 BC	59'8" x 59'4"	3,540	380	240	280	16
255 ABC	59'8" x 89'	5,310	570	360	420	24
256 A	29'8" x 73'3"	2,173	220	130	160	10
256 B	29'8" x 73'3"	2,173	220	130	160	10
256 AB	59'4" x 73'3"	4,346	440	290	320	24
257	59'8" x 89'8"	5,350	570	350	430	26
258 A	29'8" x 73'3"	2,173	220	130	160	10
258 B	29'8" x 73'3"	2,173	220	130	160	10

ACC NORTH CAPACITIES

200 LEVEL



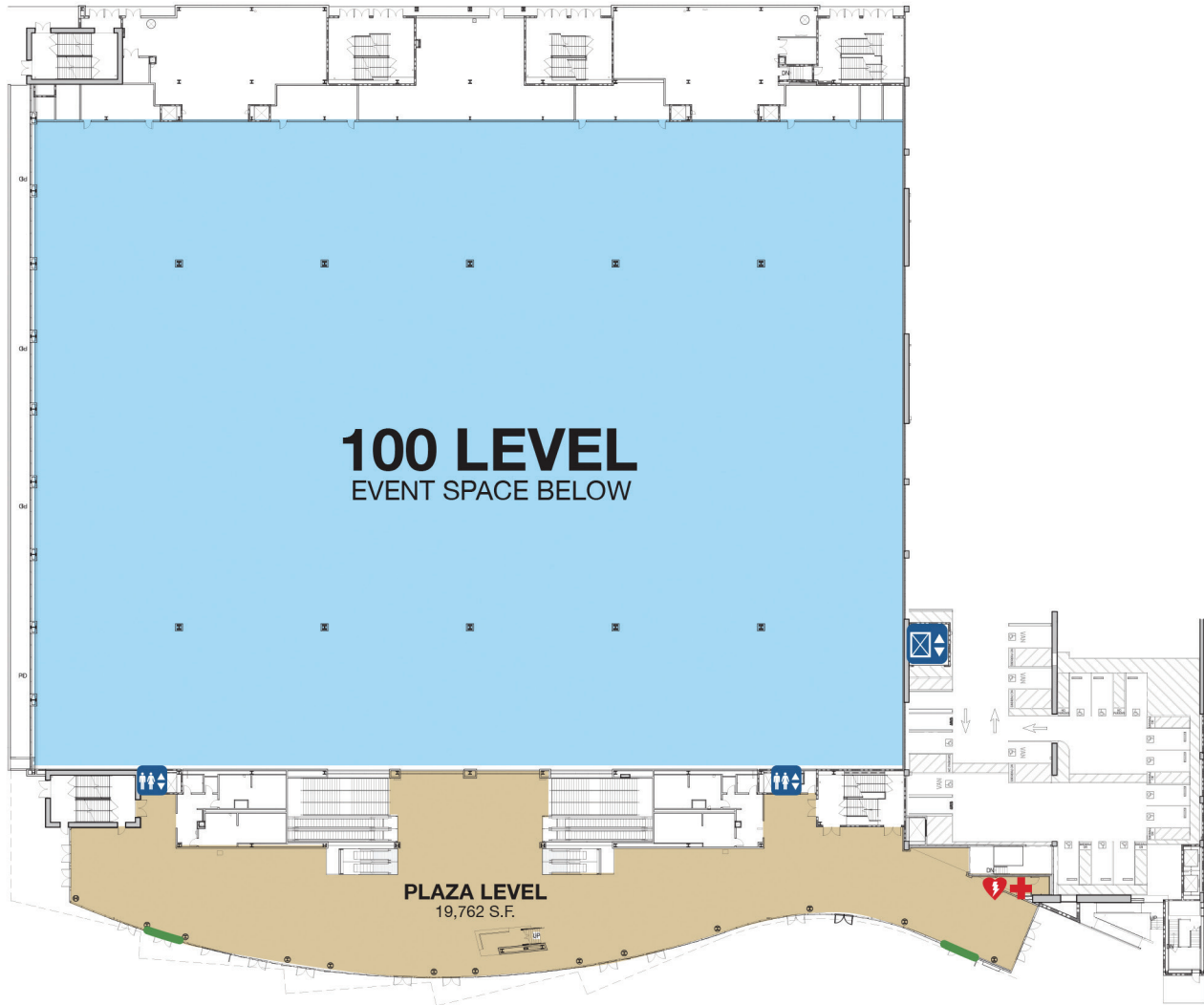

ROOM NAME	DIMENSIONS	SQUARE FEET	THEATER	CLASSROOM <i>8' x 18" Tables</i>	BANQUET ROUNDS <i>66" Rounds</i>	10' X 10' BOOTHS
258 AB	59'4" x 73'3"	4,346	470	290	320	20
259 A	29'8" x 58'4"	1,731	180	110	130	8
259 B	29'8" x 58'4"	1,731	180	110	130	8
259 AB	59'4" x 58'4"	3,462	370	230	260	16
260 A	59'8" x 29'8"	1,770	190	120	140	8
260 B	59'8" x 29'8"	1,770	190	120	140	8
260 C	59'8" x 29'8"	1,770	190	120	140	8
260 AB / 260 BC	59'8" x 59'4"	3,540	380	240	280	16
260 ABC	59'8" x 89'	5,310	570	360	420	24
261 A	29'8" x 73'3"	2,173	220	130	160	10
261 B	29'8" x 73'3"	2,173	220	130	160	10
261 AB	59'4" x 73'3"	4,346	440	290	320	20
262 A	40'4" x 28'4"	1,143	130	80	90	
262 B	40'4" x 29'8"	1,197	130	80	90	
262 C	40'4" x 29'8"	1,197	130	80	90	
262 AB	40'4" x 58'	2,340	260	160	180	
262 BC	40'4" x 59'4"	2,394	260	160	180	11
262 ABC	40'4" x 87'8"	3,537	400	240	270	16
263 A	40'4" x 29'8"	1,197	130	80	90	
263 B	40'4" x 29'8"	1,197	130	80	90	
263 C	40'4" x 29'8"	1,197	130	80	90	
263 AB / 263 BC	40'4" x 59'4"	2,394	260	160	200	11
263 ABC	40'4" x 89'	3,591	400	240	290	16
264 A	40'4" x 29'8"	1,197	130	80	90	
264 B	40'4" x 29'8"	1,197	130	80	90	
264 C	40'4" x 43'4"	1,748	180	110	130	8
264 AB	40'4" x 59'4"	2,394	260	160	200	11
264 BC	40'4" x 73'	2,945	320	190	240	14
264 ABC	40'4" x 102'8"	4,142	440	270	320	20
COMBINATIONS						
251 + 252 + 253	58'7" x 279'5"	16,369	1,720	1,070	1,280	77
255 + 257 + 260	179' x 89'8"	15,970	1,710	1,070	1,270	74
256 + 258 + 261	178' x 73'3"	13,038	1,350	870	960	64
262+ 263 + 264	40'4" x 279'4"	11,270	1,240	750	880	52

ACC NORTH PLAZA LEVEL

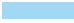

ARENA PLAZA
(Street Level)

LEGEND

-  EXHIBIT SPACE
-  PRE-FUNCTION SPACE
-  LOADING DOORS
-  FIRST AID STATION
-  PASSENGER ELEVATOR
-  FREIGHT ELEVATOR



Visit Anaheim

2099 S. State College Blvd. Suite 600 | P.O. Box 4270 Anaheim, CA 92806
714.765.2800 | meetings@visitanaheim.org | visitanaheim.org/meetings

