



ARLINGTONSM TEXAS



ARLINGTON.ORG/MEETINGS

What can a CVB do for you?

Unique venues make your event memorable!

COMING TO ARLINGTON IN 2018

TEXAS *Live!*



Arlington Convention Center



Texas Live! Coming in 2018

THE CORDISH COMPANIES, TEXAS RANGERS AND LOEWS HOTELS & CO., PARTNER FOR TEXAS LIVE!

2018

\$250 million world-class dining, entertainment and hospitality destination

2019

\$150 million flagship hotel, Live! by Loews

2020

\$1 billion ballpark and preservation of Globe Life Park

Incoming restaurants and attractions include: Revolver Brewery, the iconic Lockhart Smokehouse, and a restaurant from celebrity chef Guy Fieri.

For more information, or to submit an RFP to our top notch sales and services team: www.arlington.org/meetings



ARLINGTON
CONVENTION & VISITORS BUREAU

LOEWS



Welcome to Arlington!

On behalf of the Arlington Convention & Visitors Bureau, we invite you to explore the American Dream City's many offerings for meeting professionals. Our convenient location in the country, just 10 minutes from DFW International Airport, makes us the perfect headquarters for events of any size. Arlington offers the facilities, services and attractions to make your event a success, so get ready for first-class entertainment in addition to the Arlington Convention Center's 100,000 square feet of flexible meeting space.

Arlington prepares for the newly-announced 100,000 square foot Texas Live! Entertainment Complex. Texas Live! will offer your guests multiple best-in-class restaurants and entertainment venues, along with a signature event space with a capacity of 5,000 people. Expect to see a new 300+ room upscale hotel with 35,000 square feet of convention space adjacent to Globe Life Park upon completion in 2018. This is the next chapter in a City of Arlington partnership with the Texas Rangers that spans more than four decades.

The Entertainment District offers major league excitement at Globe Life Park in Arlington, home to the Texas Rangers. Or catch a thrill at Six Flags Over Texas and Hurricane Harbor. And of course, the incredible AT&T Stadium, home of the Dallas Cowboys, is more than just a sports focus. It is also a contemporary art gallery! Convention delegates looking for an after-hours excursion can explore the dining and shopping options in the lifestyle centers of Lincoln Square or the Arlington Highlands and the Parks Mall at Arlington.

This Meeting Planner Guide provides a quick snapshot of Arlington's many meeting and hotel options. However, we welcome the opportunity to customize our CVB services to your specific needs. We know your time is valuable, so rest assured that you are in reliable hands with our sales and services team.

We look forward to welcoming you to Arlington!

Ron Price
President & CEO
Arlington Convention & Visitors Bureau



Chef Spotlight

Justin Shipley
Executive Chef, ACC
Levy Restaurants

Catering for large groups isn't normally thought of as leading-edge cuisine...

Whether you are feeding four people or a crowd of 400, you always want to give the guest the greatest experience possible. I like to stay up to date on the most current food trends, then put my own touch on them. When catering to large groups, I create the dish like I am going to make it for one or two people, then my staff and I execute it for the larger group. I want the guest to feel as if we made each dish specifically for them. By reading food blogs, consistently trying new restaurants and dishes, and using the freshest quality ingredients, we can give the guest the best possible experience.

What is your personal philosophy about client service; and how will you continue to set the ACC apart in terms of catering?

I give our partners exactly what they want so every event is memorable for our guests. I do everything possible to ensure a great experience by creating a special dish or customized menu to make their vision a reality. By consistently going above and beyond the clients' and guests' expectations, the catering experience at ACC will be better than ever!

What is your favorite thing about being a chef and what drew you to this line of work?

My favorite thing about being a chef is being able to create a dish that is completely my own and having people tell me, "This is the best dish I have ever had!" Being a chef is a great outlet for personal creativity. As I was growing up I was always in the kitchen with my mom and grandmother helping cook and create our family meals. We would then all sit down together and enjoy each other's company and the great meal we created together. I wanted to be able to experience this feeling of pride and community for the rest of my life, so cooking for other people and having them enjoy my creations just felt right.

Chef Justin's Famous
~ **FRIED GREEN TOMATOES** ~
WITH CRAB SALAD
Traditional Fried Green Tomatoes with a southern twist, topped with a spicy crab salad and creole yogurt! Serves 4.

CREOLE YOGURT DRESSING:

- 1 cup Greek yogurt
- 1/2 tsp. cayenne pepper
- The juice of 1 lemon-or-1 tbsp. lemon juice
- 6 tbsp. milk
- 1 tsp. Cajun seasoning

CRAB SALAD:

- 1 tbsp. onions (diced small)
- 1 tbsp. jalapenos (seeded & minced)
- 2 tbsp. olive oil
- 1 pound jumbo lump crab
- 4 tsp. chives
- 1 tbsp. roasted red peppers (diced small)
- The juice of 1 lime-or-1 tbsp. lime juice
- 1/4 cup chopped green onions
- Salt & pepper to taste

FRIED GREEN TOMATOES:

- Vegetable oil for frying

- 4 green tomatoes
- 1/4 cup buttermilk
- 1 cup flour
- 2 cups cornmeal
- 1 tbsp garlic powder
- 1 tsp. cayenne pepper
- 1 tsp. paprika
- 4 whole eggs
- Salt & pepper to taste
- 1/2 cup capers

DIRECTIONS: Pour vegetable oil to a depth of 1/4"-1/2" in a large cast-iron skillet and heat to 350°F.

YOGURT DRESSING: Mix all ingredients in a bowl and chill in refrigerator until ready to serve.

CRAB SALAD: Saute diced onions and jalapenos in pan with olive oil until onions are translucent. Remove from heat and place in

fridge to chill. Once cooled, mix with all other ingredients gently as to not break up crab too much. Season to taste with salt and pepper. Refrigerate until ready to use.

FRIED GREEN TOMATOES:

Slice green tomatoes 1/4 inch thick. Season both sides with salt and pepper. Set aside on a towel lined plate. In separate bowls mix together 3/4 cups flour with the cayenne pepper, paprika, salt and pepper. Beat together eggs and buttermilk in a separate bowl. Dredge the tomatoes in a seasoned flour, followed by the eggs then cornmeal/flour mix. Shake off any excess. Add 2-3 tomatoes to your oil at a time and fry to golden brown. About 1-2 minutes. Remove capers from oil and set on paper towels to drain. Place on plate. Top with crab salad, drizzle yogurt dressing, then garnish with fried capers, green onions and sprinkle with some Cajun seasoning.



ARLINGTON CONVENTION Center



“Hosting our summit at multiple locations over the years, without a doubt I can say the quality of the food and service was 5 stars above all others. I think the best way to sum up the quality was several associates asked if “to-go” boxes were available! This along with the service provided by your staff made for “Best in Class.” You and your team are beating your competition in great stride.”

– Brian W. PepsiCo.



>>> PHOTO: Dan Pope



TOP 10 ACC FACTS

- 1. 10 minutes from** DFW International Airport
- 2. Free public wifi** available throughout the facility
- 3. 90,000 sq.ft.**, all on one level, including Exhibit Hall, Grand Hall, and Meeting Rooms
- 4. Open space** 50,000 sq.ft. of column-free exhibit floor
- 5. Located** in the heart of the Arlington Entertainment District
- 6. Award-winning** chef and catering
- 7. Designed** for ease of access for efficient set-up and teardown
- 8. Copious** amounts of convenient parking
- 9. New LED** lighting in exhibit hall
- 10. Dramatic views** of AT&T Stadium, Six Flags Over Texas and Globe Life Park

ARLINGTON CONVENTION Center

Sheraton Arlington HOTEL >> Just outside the ACC doors

THE GRAND HALL

30,000 sq.ft. of flexible, column-free carpeted space that provides an impressive backdrop and is divisible for banquets, meetings and events.

- 6,000 sq.ft. indoor pre-function gallery
- Outdoor waterfront terrace
- 30-foot ceilings
- More than 100 hang points
- Separate three bay truck dock

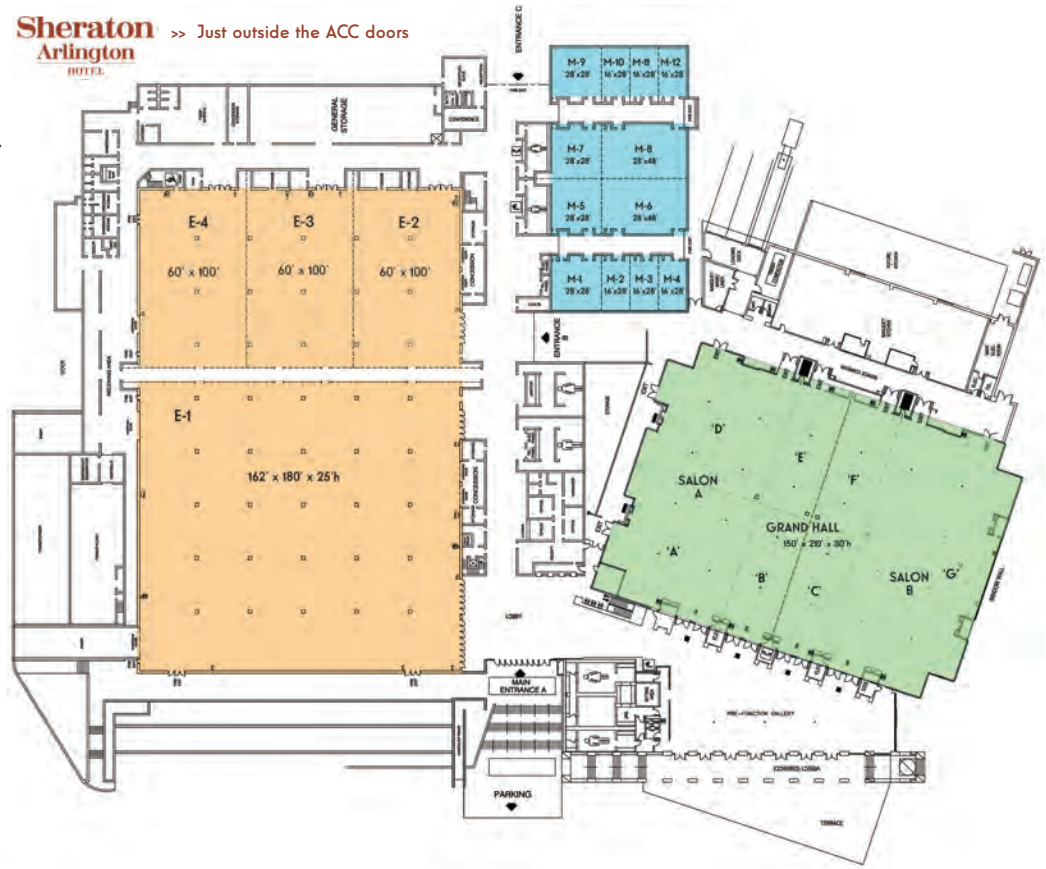

THE EXHIBIT HALL

48,600 sq.ft. of column-free space for up to 276 10'x10' booths, seating for 5,000 theater-style or 2,800 in a banquet format.

- 30-foot utility centers throughout the show floor
- More than 1,000 pounds per sq.ft. floor load factor
- Two drive-in access doors
- Separate six bay truck dock
- Expansive 25-foot ceilings

GRAND HALL	Function Room	Square Feet	Ceiling Height	Theatre	Classroom Seating	Banquets	Exhibit Booths 10 x 10
	Grand Hall	30,000	30'	3,000	1,500	1,800	150
Salon A	15,000	30'	1,500	650	770	70	
Salon B	15,000	30'	1,500	650	770	70	
Gallery	6,000	22'					
Terrace	4,700						

EXHIBIT HALL	Function Room	Square Feet	Ceiling Height	Theatre	Classroom Seating	Banquets	Exhibit Booths 10 x 10
	E- (1-4)	48,600	25'	5,000	3,900	2,800	276
E-1	29,160	25'	2,800	2,400	1,500	157	
E-2	6,000	25'	670	500	320	32	
E-3	6,000	25'	670	500	320	32	
E-4	6,000	25'	670	500	320	32	

MEETING ROOMS

Complementing the Exhibit Hall and the Grand Hall is an additional 8,500 square feet of divisible meeting space available for breakout sessions or smaller meetings. Up to 12 separate meeting rooms, each offering individual climate, lighting and sound controls. Also available are dedicated internet and telephone services.

MEETING ROOMS	Function Room	Square Feet	Ceiling Height	Theatre	Classroom Seating	Banquets
	M1	784	10'	72	40	48
M2	448	10'	49	30	24	
M3	448	10'	49	30	24	
M4	448	10'	48	30	24	
M5	784	12'	72	40	48	
M6	1,344	12'	144	80	96	
M7	784	12'	72	40	48	
M8	1,344	12'	144	80	96	
M9	784	10'	72	40	48	
M10	448	10'	49	30	24	
M11	448	10'	49	30	24	
M12	448	10'	48	30	24	





GLOBE LIFE *Park*



FACT The 48,114-seat open-air ballpark offers guided tours through the batting cages, press box, dugout and more.

GLOBE LIFE PARK IN ARLINGTON, HOME OF THE TEXAS RANGERS, offers more than just championship baseball. With flexible indoor and outdoor spaces, renowned cuisine, this extraordinary venue is a stunning backdrop for any event.



- ✦ Corporate Outings
- ✦ Seminars
- ✦ Trade Shows
- ✦ On-Field Events
- ✦ Team Building
- ✦ Job Fairs
- ✦ Concerts
- ✦ Cocktail Parties
- ✦ Luncheons
- ✦ Races
- ✦ Weddings
- ✦ Festivals



VENUES & CAPACITY **SEATED** **COCKTAIL** **PRESENTATION**

HALL OF FAME 6,500 sq.ft.			
Level One	200	350	300
Level Two	200	300	50
Level Three	200	350	200

THEATER	235	N/A	235
----------------	-----	-----	-----

JACK DANIEL'S CLUB 17,000 sq.ft.			
	500	1,000	250

CAPITAL ONE CLUB 9,100 sq.ft.			
Top Tier	160	200	200
Bottom Tier	90	215	50

HYUNDAI CLUB	80	150	100
---------------------	----	-----	-----

CAPTAIN MORGAN CLUB 4,000 sq.ft.			
Level One	120	200	125
Level Two	130	200	125

CHOLULA PORCH 4,000 sq.ft.	375	800	350
-------------------------------------	-----	-----	-----

- | | |
|-------------------------------|----------------------------|
| BUDWEISER BOWTIE PLAZA | DUGOUT |
| FIELD RENTAL | WARNING TRACK |
| KID'S ZONE | VISITOR'S CLUBHOUSE |
| CONCOURSE | BOARDROOMS |
| SUITE RENTALS | PARKING LOT RENTALS |

GRAND SLAM EXTRAS:

- ✦ Ballpark Tours
- ✦ Appearances by:
 - Rangers Mascot "Captain"
 - Six Shooters
 - Alumni Players
- ✦ Rangers Merchandise
- ✦ Audio / Visual Setup
- ✦ Scoreboard Message
- ✦ Field Lights
- ✦ Valet Parking
- ✦ Batting Cage Experience
- ✦ Fly-balls in the Outfield
- ✦ On-Field Banquet / Concerts / Activities

AT&T STADIUM

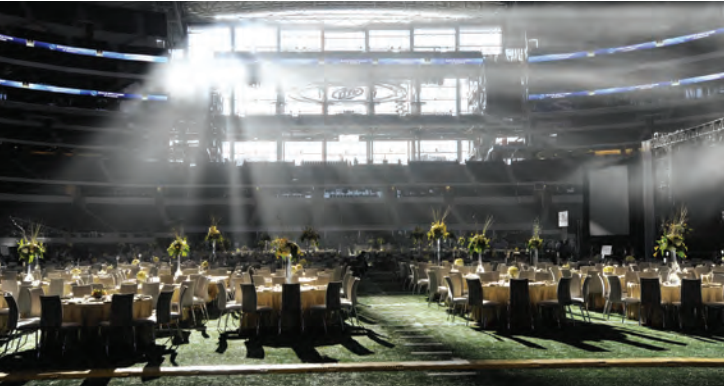

FACT Available guided art tours share the unique collection of museum quality contemporary art within the Stadium.

Contact: specialevents@dallascowboys.net | 817-892-8000

EVENT SPACE **RP** **B-10** **B-8** **TH** **CR**

Direct access to load-in, load-out. Full Power available. 10 x 10 Booth Capacity: 490

FIELD | 98,000 sq.ft. Home of the Cowboys Star. Retractable roof.
5,000 2,500 2,000 REQUEST REQUEST

MILLER LITE CLUB | 9,300 sq.ft. Experience the excitement of having your event in a room directly adjacent to the Field.
350 220 184 150 51

DRAFT KING'S FANTASY SPORTS LOUNGE | 9,300 sq.ft. Adjacent to the Field on the Visitor's side of the stadium.
350 220 184 150 51

COWBOY'S LOCKER ROOM | 2,400 sq.ft. Evening only 6:30 pm start
Work on your own team strategy, inspire and motivate your guests by meeting in the Cowboys Locker Room.

HALL OF FAME LEVEL
150 120 72 125 60

POST-GAME INTERVIEW ROOM | 2,700 sq.ft.
150 120 72 150 80

INFORMATION TECHNOLOGY AMPHITHEATRE
INFORMATION TECHNOLOGY CONFERENCE ROOM

MAIN CONCOURSE

MAIN LEVEL CLUB SOUTH | 30,000 sq.ft.
2,500 400 344 130 135

MAIN LEVEL CLUB NORTH | 33,000 sq.ft.
2,500 740 704 150 216

AT&T ENDZONE EAST | 24,500 sq.ft. Panoramic platform view overlooking the field as well as the water feature in the East Plaza.
2,500 780 720 1300 498

AT&T ENDZONE WEST | 24,500 sq.ft. Panoramic Platform view overlooking the field and a view of downtown Fort Worth
2,500 780 720 1300 498

WELCOME TO AT&T STADIUM, the home of true Texas-sized hospitality. The \$1.3 billion venue was built to impress and offers more than 22 flexible event locations to provide the perfect setting for your team. Boost your attendance and excite your participants at the home of America's Team!

SILVER LEVEL **RP** **B-10** **B-8** **TH** **CR**

AMERICAN AIRLINES LOUNGE | 8,700 sq.ft. Vaulted ceilings with spacious surroundings.
500 250 208 150 90

SILVER LEVEL LOUNGE | 8,700 sq.ft. Experience the Silver lining near the top of the stadium. This club has a view of the skyline.
500 250 208 150 90

FORD ENDZONE | 14,500 sq.ft. East side End Zone Platform, Silver level Reception 350

MILLER LITE ENDZONE West side End Zone Platform, Silver level Reception 350

STAR LEVEL

MEDIA PRESS BOX | 3,500 sq.ft.
200 100 64 100 75

UPPER CONCOURSE LEVEL

DR PEPPER ENDZONE | 14,000 sq.ft. Highest level, amazing view, East side
500 300 256 N/A N/A

PEPSI ENDZONE | 14,000 sq.ft. Highest level, amazing view, West side
500 300 256 N/A N/A

UPPER CONCOURSE EAST ANNEX BAR | 2,400 sq.ft.
150 100 N/A N/A N/A

BACARDI BAR | 2,400 sq.ft.
150 100 N/A N/A N/A

KEY: RP = RECEPTION, BQ-10 = BANQUET
BQ-8 = BANQUET, TH = THEATRE, CR = CLASSROOM

sales@arlington.org



FACT Six Flags Over Texas is the original Six Flags Theme Park, opening on August 5, 1961.

THE MORE THE MERRIER! Six Flags is in the business of fun, so why have your event anywhere else? Options abound for many groups. Explore options like special pricing, two private and covered pavilions, meal vouchers, even personalized tickets with your company name on them. The picnic pavilions and indoor show venues can serve as meeting sites, complete with audio/visual set-up.

GROUP SIZE

Six Flags Over Texas features several venue options for groups looking for out of the box meeting locations.

Indoor theaters vary in seating capacity and style. Subject to availability.

- Crazy Horse Saloon 250
- Lone Star Theater 350
- Majestic Theater 850
- Southern Palace 930
- Music Mill 9500

Outdoor picnic pavilions are also available and seat 1000.

- AV Requests
- Set up and technical support available.
 - AV fees vary by request.
 - PA system available in pavilions at no additional charge

• Venue access requires park admission. 100 ticket minimum group size.



**YOU BRING THE TEAM...
WE'LL BRING THE SCREAM!**

- 212 acres of excitement
- 44 rides
- 12 roller coasters
- 5 water rides
- Live Shows
- Top-Tier Entertainment
- Catered Meetings
- Great group rates



THE UNIVERSITY OF TEXAS AT ARLINGTON

COLLEGE PARK Center

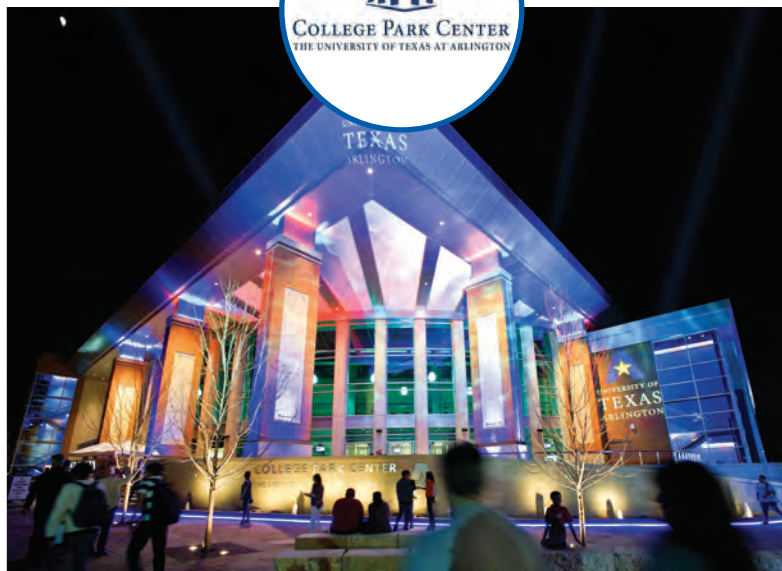

FACT The U.S. Green Building Council recognized College Park Center with a LEED Gold certification.

OUR NEW HOME COURT Designed as a home for three of UT Arlington's Division I teams, College Park Center can easily accommodate a variety of athletic competitions: basketball, volleyball, wrestling, cheerleading, plus dance and martial arts events.

BUILT FOR BUSINESS College Park Center's size and location in Arlington's downtown business district make it a perfect place for corporate events, including:

- + Conferences
- + Trade shows
- + Training sessions
- + Orientations
- + Product launches



PARTIES DONE RIGHT The arena and Hospitality Suite are available for private parties, corporate functions, receptions, and special occasions. We'll also help you plan your event; everything from designing the room layout and securing audio and video equipment to choosing the menu and cleaning up afterward!

COLLEGE PARK CENTER is a 218,000-square-foot facility set on the eastern edge of the University of Texas at Arlington campus in Arlington's downtown business district. The state-of-the-art venue is perfect for athletic, entertainment, and corporate functions.

SPECIFICATIONS

LAYOUT

- 12,000 sq.ft. arena floor (8,400 sq.ft. sports configuration)
- Seating for up to 7,000 for sporting events
- Seating for up to 6,300 for concert/stage events
- Portable 120' x 60' basketball floor
- Accommodates 120 (8' x 10') booths

A/V COMPONENTS

- Daktronics end hung video board (14' x 25' LED video screen)
- Daktronics four-sided center-hung video board
- Two 200-amp and four 400-amp electrical services at floor level (Stage Right)
- One 200-amp electrical service at catwalk level
- Full broadcast and video production capabilities
- Wireless Internet

AMENITIES

- Two practice courts (7,700 square feet each)
- 2,800-square-foot Hospitality Suite, divisible into three sections
- Full concessions and catering services
- Three dock bays, one drive-up truck dock
- Back of house accommodates 25 cars, eight trucks or seven buses



ONLINE Tools

IF YOU'RE LOOKING TO HOST an annual meeting, conference, reunion or activity in Arlington, there will be lots to do before the big event! Visit our website and you'll find planning tools that are just a click or two away.



ARLINGTON.ORG/MEETINGS

The Meeting Planner section of our website is devoted to making your job easier.

- Meet the experienced sales and services team members that will assist you.
- Initiate a quick search to see which Arlington venues will work for you.
- Browse the Meeting Planner Toolkit with photos and blurbs about Arlington for use with attendance building.
- View capacities and/or floorplans for event venues.
- Review ACVB client testimonials.
- Submit an RFP or email to our team for a personal consultation at sales@arlington.org or call **817-265-7721**.

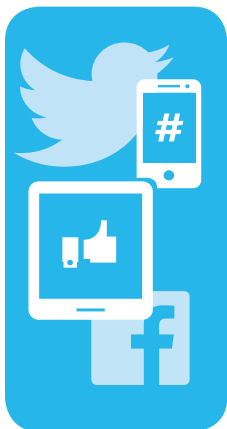

HOW CAN YOU GENERATE BUZZ AND BUILD YOUR ATTENDANCE?

- **GET SOCIALLY SAVVY** Spread the word through your social media like Facebook and Twitter. Tag us in your posts and tweets.
- **ONLINE/WEBSITE** Update event info. Is your early bird discount beginning or ending? What room block(s) at which hotel(s) did you establish through the Sales and Services Team at the Arlington CVB? What clothing should people pack for your newly-booked evening event? Link to the CVB's "Things to Do" pages. These are all things that your guests will WANT to know.
- **COMPANY INTRANET** If you have a company intranet, don't neglect it! This is the perfect vehicle for keeping staff members informed about important announcements and registration for your event.





LOCATION *is everything*

ARLINGTON, TEXAS

A convenient location and varied transportation options are valuable assets that encourage attendance. Because of a central location in the continental United States between Dallas and Fort Worth and a placement at the crossroads of five interstate highways, Arlington offers unparalleled accessibility.



BY AIR Arlington is 10 miles from Dallas/Fort Worth International Airport, the third busiest airport in the world and no more than 4 hours by air from every major city in the country. Most of our hotels offer complimentary shuttles to and from DFW Airport.

Arlington is 30 minutes from Dallas Love Field, home to carrier Southwest Airlines. The Love Field Modernization Program (LFMP) renovations are also underway: a centralized concourse with 20 gates, a remodeled lobby, expanded baggage claim area and a new ticketing wing. For corporate, cargo and recreational pilots, the Arlington Municipal Airport also offers accessibility and convenience.

BY TRAIN Amtrak operates multiple trains in the DFW area, like the Heartland Flyer out of Fort Worth and the Texas Eagle out of Dallas. The Trinity Railway Express (TRE) commuter train connects to the downtown areas of Dallas and Fort Worth, with stops at DFW Airport. Trains operate Monday through Saturday.

BY CAR Arlington sits at the crossroads of five interstate highways, making the average drive time to most major cities in the state and region approximately three to five hours.

BY BUS - Dan Dipert Tours & Coaches (817-654-3622) and Roadrunner Charters (972-692-5477) proudly provide motorcoaches and shuttle buses in a variety of sizes and capacities for your mass transportation needs. For booking options, contact jessicac@dandipert.com or donna@roadrunnercharters.com. Mention the Arlington CVB to both Dan Dipert Tours & Coaches and Roadrunner Charters.

BY TROLLEY Guests of participating hotels receive complimentary trolley transportation to the Arlington Welcome Center, Six Flags Over Texas, Hurricane Harbor, Globe Life Park in Arlington, AT&T Stadium, plus additional shopping, dining and entertainment locations. See page 24 for details.

“A good CVB is a remarkable support system. Arlington has taken the time to learn about TASC. They support us, and they have developed a real relationship. They take the time needed to do that. I love it that they are passionate about their city, that they partner with us, and that they care about our success. If you don’t use a CVB, you just added hours to your job.”

- Terry Hamm, Director, Texas Association of Student Councils

ARLINGTON HOTELS

- 1 Baymont Inn & Suites
- 2 Blue Cypress Hotel
- 3 Candlewood Suites
Arlington
- 4 Comfort Suites Arlington
- 5 Courtyard Dallas Arlington
- 6 Courtyard Dallas Arlington
South
- 7 Crowne Plaza Suites
- 8 Days Inn - South Arlington
- 9 Days Inn Arlington
- 10 DoubleTree by Hilton
- 11 Extended Stay America -
Six Flags
- 12 Extended Stay America
Hotel Arlington
- 13 Fairfield Inn & Suites
- 14 Hampton Inn & Suites
Arlington South
- 15 Hampton Inn & Suites
Arlington North
- 16 Hawthorn Suites by
Wyndham Arlington
- 17 Hilton Arlington
- 18 Hilton Garden Inn
- 19 Hilton Garden Inn S
- 20 Holiday Inn Arlington NE-
Rangers Ballpark
- 21 Holiday Inn Express &
Suites Arlington
- 22 Holiday Inn Express
- 23 Homewood Suites by Hilton
- 24 Homewood Suites by Hilton
Arlington South
- 25 Howard Johnson Express
Inn
- 26 Hyatt Place Arlington
- 27 InTown Suites
- 28 InTown Suites
- 29 InTown Suites
- 30 InTown Suites
- 31 La Quinta Inn & Suites
Six Flags Drive
- 32 La Quinta Inn & Suites
South
- 33 Microtel Inn & Suites
- 34 Quality Inn at Arlington
Highlands
- 35 Quality Inn & Suites Six
Flags Area
- 36 Ranger Inn & Suites
- 37 Red Roof Inn
- 38 Residence Inn Arlington
- 39 Residence Inn Dallas
Arlington South
- 40 Rodeway Inn
- 41 Sanford House Inn & Spa
- 42 Sheraton Arlington Hotel
- 43 Sleep Inn Arlington Near
Six Flags
- 44 SpringHill Suites by
Marriott
- 45 Studio 6
- 46 Studio 6 - South
- 47 Super 8 Arlington
- 48 The Thornton Inn
- 49 TownePlace Suites by
Marriott
- 50 Wingate by Wyndham

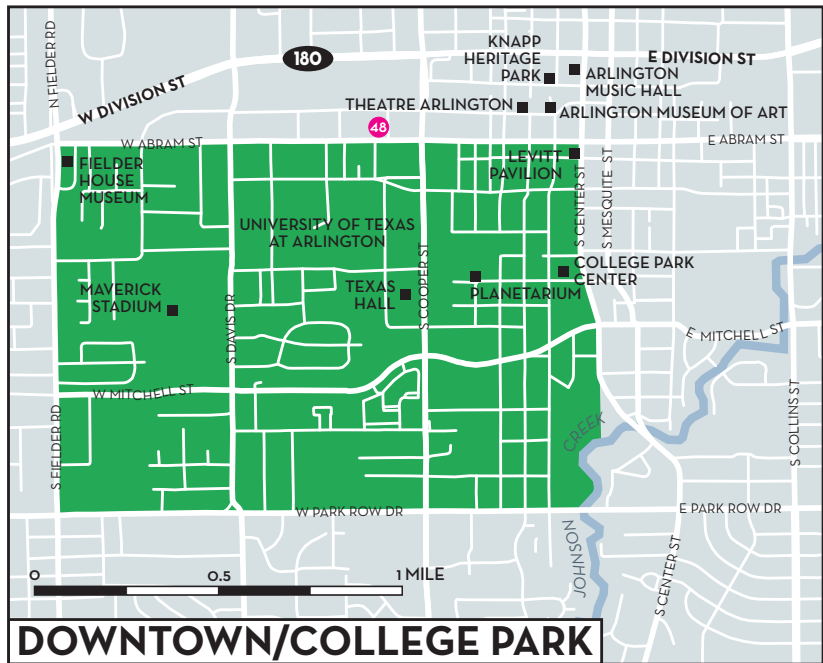
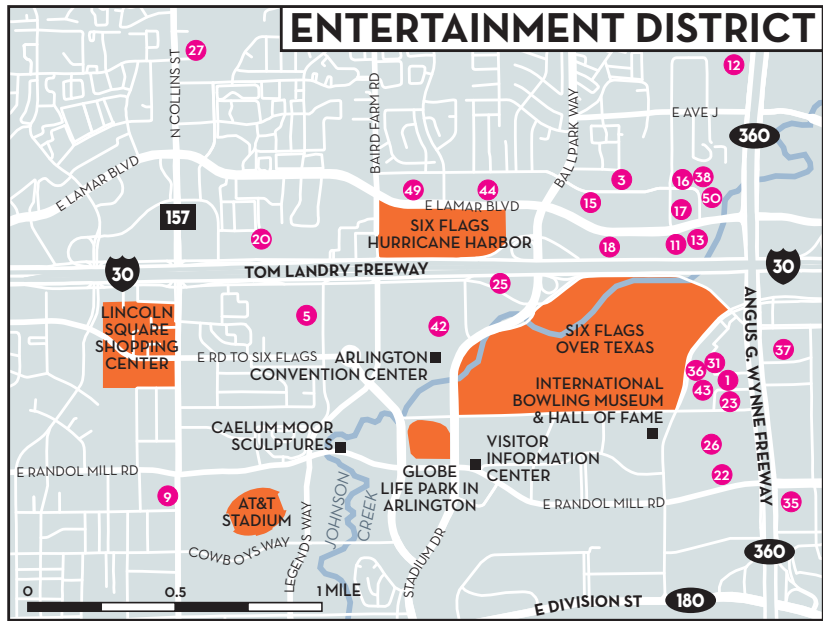

ARLINGTON OVERVIEW

NEIGHBORHOODS

- ENTERTAINMENT DISTRICT
- DOWNTOWN/COLLEGE PARK
- SHOPPING DISTRICT

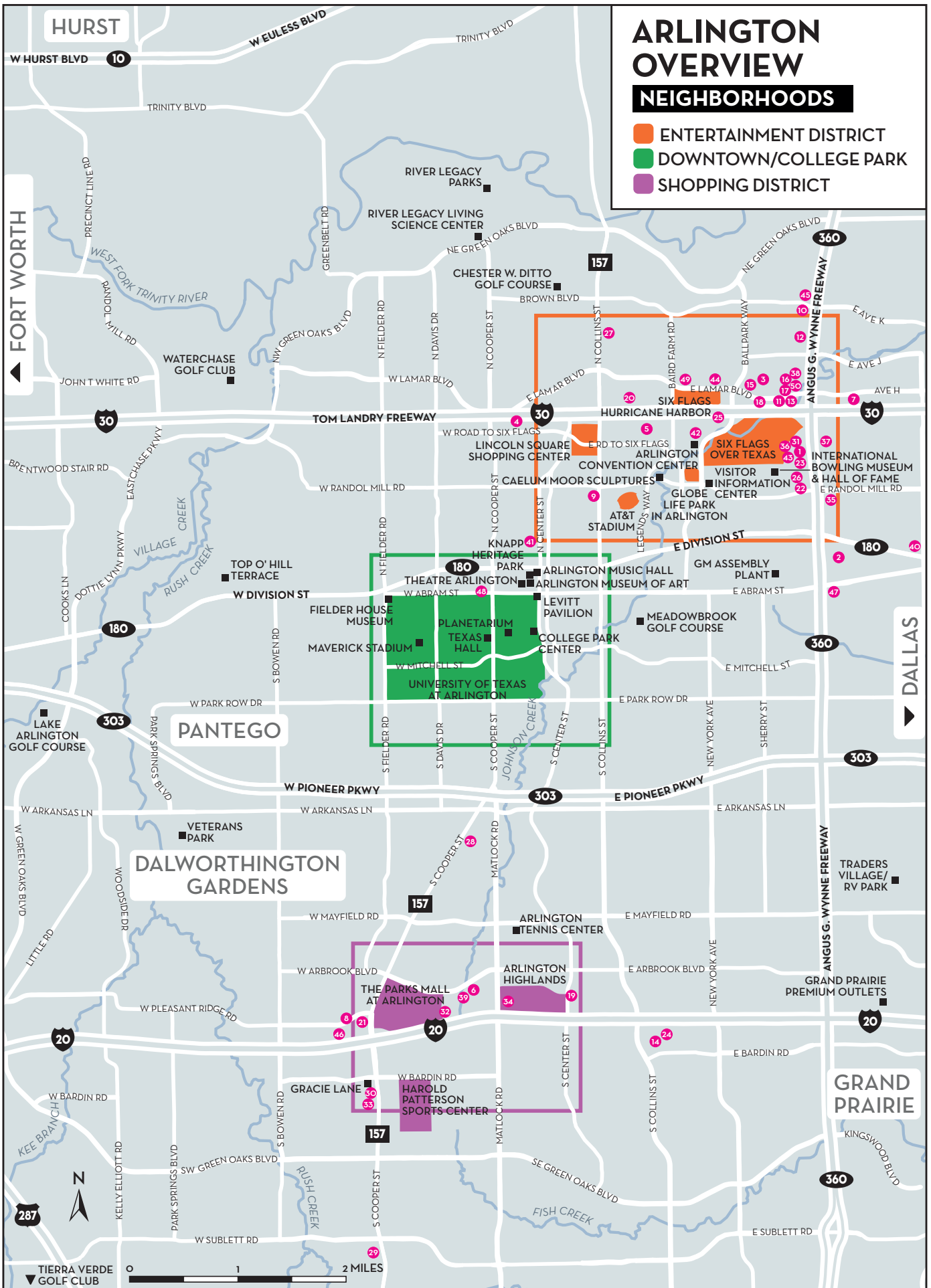

HURST

W HURST BLVD 10

FORT WORTH

DALLAS

PANTEGO

DALWORTHINGTON GARDENS

GRAND PRAIRIE



0 1 2 MILES

TIERRA VERDE GOLF CLUB



SHERATON *Arlington*



1500 Convention Center Drive

ARLINGTON.ORG/MEETINGS

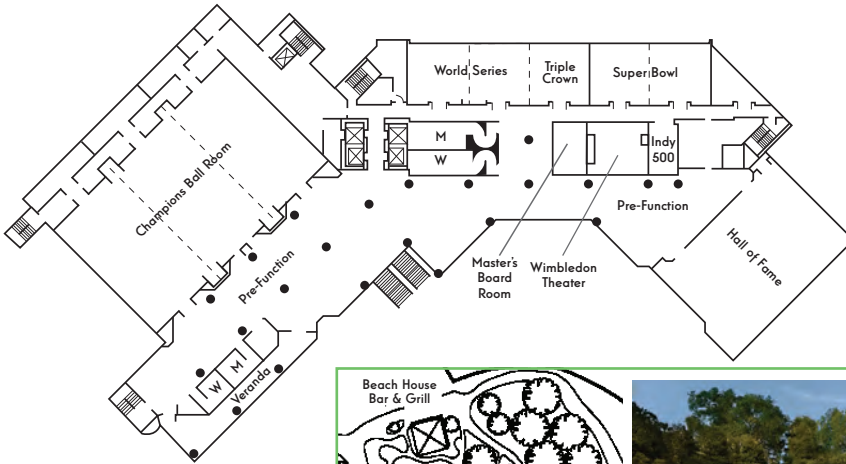

Plaza on the Hill

Our private outdoor meeting space, adjacent to the pool, features a private Yacht Club and 4,300 sq. ft. of space capable of accommodating up to 300 guests.



MEETING ROOM	DIMENSION	SQ. FT.	CEILING	RECEPTION	BANQUET	THEATRE	CLASSROOM	CONFERENCE	U-SHAPE
Champions Ballroom (total)	100'x60'	6,000	14'	700	500	675	350	N/A	N/A
Champions I, II & III (each)	33'x60'	1,980	14'	225	150	220	120	50	40
Hall of Fame	68'x48'	3,264	12'	250	200	300	150	40	40
World Series (total)	51'x25'	1,275	9'	115	80	100	60	40	40
World Series I & II (each)	25'x25'	625	9'	50	40	50	30	20	20
Triple Crown	25'x25'	625	9'	60	40	50	30	20	20
Super Bowl (total)	51'x25'	1,275	9'	115	80	100	60	40	40
Super Bowl I & II (each)	25'x25'	625	9'	50	40	50	30	20	20
Wimbledon Theatre	25'x23'	575	9'	45	40	50	30	20	20
Master's Boardroom	25'x14'	350	9'	N/A	N/A	N/A	N/A	12	N/A
Indy 500	25'x12'	300	9'	N/A	N/A	16	12	12	N/A
World Cup*	23'x55'	1,189	12'	115	80	120	60	40	40
Stanley Cup*	24'x55'	1,109	12'	85	70	90	50	30	30
The Plaza*	N/A	4,300	16'	500	350	500	N/A	N/A	N/A
Yacht Club*	30'x28'	840	9'	50	40	55	32	28	26
Poolside Pavilion*	N/A	2,859	16'	200	160	N/A	N/A	N/A	N/A

Dimensions outlined above are approximate. *Denotes space not shown on diagram below.

QUICK INFO

MEETING ROOMS

18

SQ.FT. EVENT SPACE

26,000

TOTAL ROOMS/DOUBLES

311/143

MILES TO ACC

0

MILES TO DFW AIRPORT

9

- **Parkside Grille**
Regional and American cuisine. Breakfast buffet, lunch and dinner
- **Parkside Bar**
Upscale lounge with Southwest flair
- **The Market Place**
Serving up Starbucks® Coffee, snacks and more
- Copy and printing services
- 24-hour business center
- Outdoor jogging trails
- 24-hour fitness center
- Outdoor pool & hot tub
- Room service
- Complimentary DFW International Airport Shuttle
- Free parking
- Entertainment District Trolley stop
- On-site catering
- On-site audio-visual services
- Adjacent to ACC





HILTON *Arlington*



2401 E. Lamar Blvd



ARLINGTON.ORG/MEETINGS

QUICK INFO

MEETING ROOMS

20

SQ.FT. EVENT SPACE

11,000

TOTAL ROOMS/DOUBLES

308/125

MILES TO ACC MILES TO DFW AIRPORT

1 10

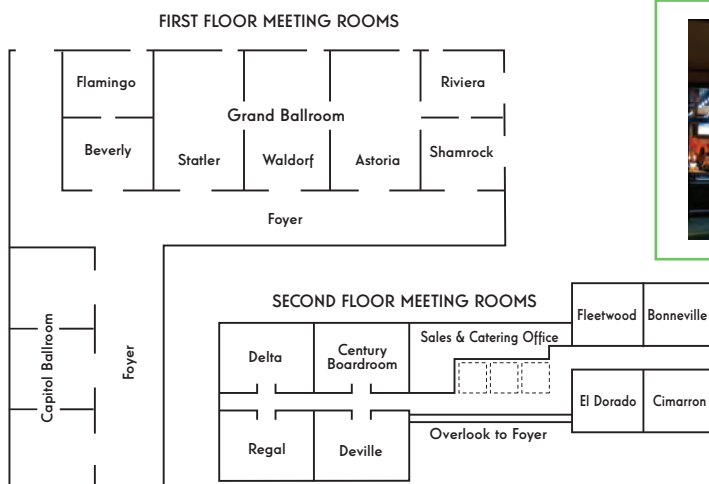

R Bar & Grill

Wood burning pizza oven along with a cocktail and craft beer program features cocktails made with fresh juices, house made bitters and mixers – something for everyone.

MEETING ROOM	L x W x H	SQ. FT.	CLASSROOM	THEATRE	BANQUET	RECEPTION	U-SHAPE	CONFERENCE
FIRST FLOOR								
Grand Ballroom	120'x42'x14'	5,040	320	600	350	500	-	-
Beverly	24'x21'x14'	504	25	50	30	50	18	20
Flamingo	24'x21'x14'	504	25	50	30	50	18	20
Statler	24'x42'x14'	1,008	60	120	70	120	30	34
Waldorf	24'x42'x14'	1,008	60	120	70	120	30	34
Astoria	24'x42'x14'	1,008	60	120	70	120	30	34
Shamrock	24'x21'x14'	504	25	50	30	50	18	20
Riviera	24'x21'x14'	504	25	50	30	50	18	20
Capitol Ballroom	90'x30'x12'	2,700	150	320	200	320	-	-
Capitol I, II or III	30'x30'x12'	900	50	100	60	110	25	30
SECOND FLOOR								
Delta	18'x24'x8'	432	24	40	30	30	15	15
Century Boardroom	12'x18'x8'	220	-	-	-	-	-	12
Regal	18'x24'x8'	432	24	40	30	30	15	15
Deville	18'x24'x8'	432	24	40	30	30	15	15
Bonneville	18'x24'x8'	432	24	40	30	30	15	15
Fleetwood	18'x24'x8'	432	24	40	30	30	15	15
El Dorado	18'x24'x8'	432	24	40	30	30	15	15
Cimarron	18'x24'x8'	432	24	40	30	30	15	15

Dimensions outlined above are approximate.

- **R Bar & Grill**
Features locally sourced Texas chef-inspired cuisine. Casual yet innovative menu. Outdoor patio with firepit.

- **FIRST**
Bountiful breakfast buffet
- Upgraded event and meeting spaces
- Concierge
- 24-hour front desk
- 24-hour business center
- 24-hour fitness center
- Free Wi-Fi access in all guest rooms
- Indoor/outdoor heated pool
- Room service
- Complimentary DFW International Airport Shuttle
- Entertainment District Trolley stop
- On-site catering and audio-visual services
- PURE™ Allergy Friendly Rooms
- Free self parking



CROWNE PLAZA Arlington



700 Avenue H East



ARLINGTON.ORG/MEETINGS

QUICK INFO

MEETING ROOMS

8

SQ.FT. EVENT SPACE

8,400

TOTAL ROOMS/DOUBLES

200/57

MILES TO ACC MILES TO DFW AIRPORT

2 7

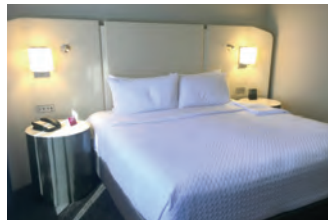
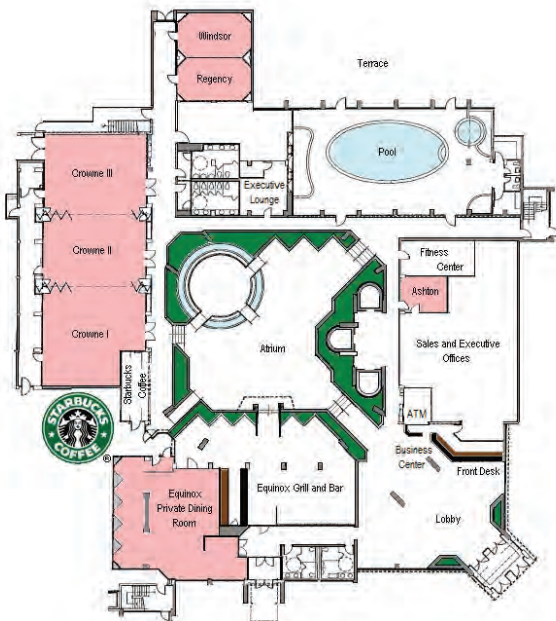

- **Equinox Grill & Bar**
Regional and American cuisine. Breakfast buffet, lunch and dinner
- Watch the game and enjoy a full bar and menu
- Gorgeous seven-story atrium
- Starbucks® Coffee bar
- Business center
- Concierge services
- Free wifi
- 24-hour fitness center
- Indoor pool & hot tub
- Room service
- Guest Laundry
- Courtesy DFW International Airport shuttle
- Entertainment District Trolley stop
- On-site catering
- On-site audio-visual services
- Free parking
- IHG Rewards Club

MEETING ROOM	SQ. FT.	DIMENSIONS	CLASSROOM	THEATRE	BANQUET	RECEPTION	U-SHAPE	CONFERENCE	CEILING
Crowne Ballroom	2,870	84'x35'	150	225	220	170	72	84	11'
Crowne I	1,085	33'x35'	42	90	60	-	27	33	11'
Crowne II	840	24'x35'	36	-	40	-	27	30	11'
Crowne III	945	27'x35'	36	80	70	-	27	33	11'
Regency	365	14'x24'	-	-	-	-	14	16	11'
Windsor	365	14'x24'	14	24	18	-	-	12	11'
Ashton	192	12'x16'	-	-	-	-	-	8	11'
Equinox	1,296	36'x36'	39	40	56	56	23	25	11'





DOUBLETREE by Hotel Hilton Arlington DFW South



700 Avenue H East

ARLINGTON.ORG\MEETINGS

QUICK INFO

MEETING ROOMS

8

SQ.FT. EVENT SPACE

7,200

TOTAL ROOMS/DOUBLES

237/139

MILES TO ACC

1.5

MILES TO DFW AIRPORT

10

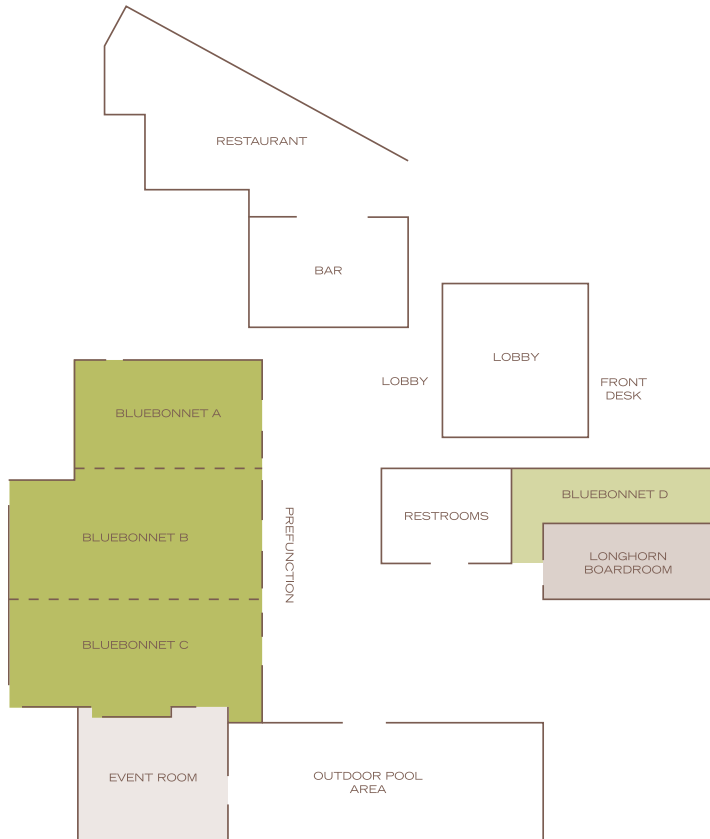

- Complimentary Wi-Fi
- Outdoor pool with individual cabanas
- 24-hour fitness center
- Entertainment District Trolley stop
- Made Market 24-hour pantry with fresh salads, sandwiches and snacks
- Complimentary business center / connectivity area
- Complimentary DFW International Airport Shuttle
- Onsite Brass Spur Bar & Grill is a stylish place for dinner and cocktails
- Free self parking
- Room service
- Warm chocolate chip cookies
- Concierge
- Recently renovated
- Free parking
- Onsite catering
- Hilton Honors guest loyalty program

Name of Room	Sq. Ft	Dimensions (L x W x H)	Theatre	Class Room	Banquet	U-Shape	Conf / Hollow Square
Blue Bonnet Ballroom	4,230	118 x 56 x 10	400	150	300	120	130
Blue Bonnet A	600	24 x 40 x 10	50	30	60	24	28
Blue Bonnet B	1,450	56 x 28 x 10	150	50	100	60	64
Blue Bonnet C	1,450	56 x 32 x 10	150	50	100	12	16
Event Room	920	32 x 20 x 10	60	25	40	30	34
Blue Bonnet D	443	31 x 11 x 10	30	15	20	24	28
Longhorn Board Room	349	23 x 13 x 10	-	-	-	-	12
Pre-Function	2,237	84 x 21 x 12	-	-	-	-	-



HOLIDAY INN *Arlington*



1311 Wet N Wild Way

ARLINGTON.ORG/MEETINGS

QUICK INFO

MEETING ROOMS

5

SQ.FT. EVENT SPACE

2,900

TOTAL ROOMS/DOUBLES

147/65

MILES TO ACC

1.5

MILES TO DFW AIRPORT

9

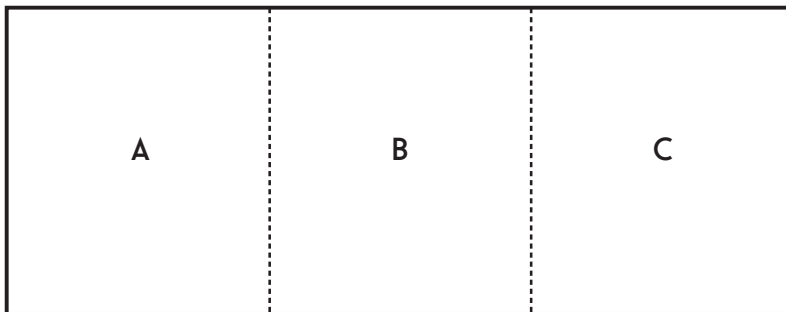

COWBOY'S BALLROOM

FUNCTION ROOM	SQ.FT.	DIMENSIONS	THEATRE	CLASSROOM	BANQUET	HOLLOW SQUARE	EXHIBITS 8X10
Ballroom	2,418	75'x30'	180	120	150	75	50
A	806	25'x30'	60	40	50	25	
B	806	25'x30'	60	40	50	25	
C	806	25'x30'	60	40	50	25	

Dimensions outlined above are approximate..

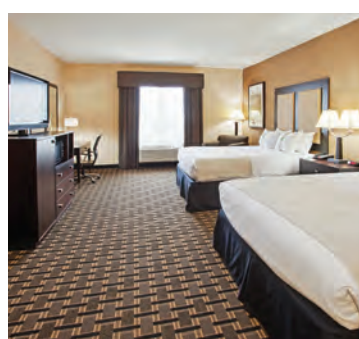

- **The Draft Bar & Grill**
Enjoy a full-service bar and American cuisine
- 24-hour front desk
- 24-hour business center
- Free self-serve laundry options
- Free wifi
- 24-hour fitness center
- Indoor pool & hot tub
- Room service
- Complimentary DFW International Airport Shuttle
- Free parking
- Entertainment District Trolley stop
- On-site catering
- On-site event assistance
- Audio-visual services
- 100% smoke free
- Additional breakout spaces:
Board room: 12 ppl
Media room: 10 ppl



UNIQUE Venues

“We connect meeting professionals with an array of unique venues and elite services, as well as unmatched entertainment options.”

- Ellen Brown, Director National Accounts

>>> Howell Family Farms - Barn



HOWELL FAMILY FARMS • 4016 WEST DIVISION ST.

Historically-registered cottage and barn offering a secluded feel with all the “big city” comforts like crystal chandeliers. Cottage with a wrap-around porch, stone ceremony stage, baseball outfield (able to accommodate a very large tent), or Barn: Upstairs reception room is 70’ x 40’ and downstairs area: 70’ x 15’.

SEATED DINNER	200
COCKTAILS	300
DINNER/DANCE	180
DOWNSTAIRS	46-80

AV, tables & chairs, valet parking, ability to bring in offsite catering



THE SANFORD HOUSE INN & SPA • 506 N. CENTER ST.

Magnificent Bed & Breakfast, Restaurant, Bar, Spa, Salon & Event Facility. The elegant house is nestled into an outdoor grand courtyard, blooming with flowers and shaded by majestic trees.

LARGE PAVILION AND GAZEBO	200
RENOIR ROOM	50
RESTAURANT	70

Custom menu from Executive Chef, AV, complimentary wifi



1010 COLLINS ENTERTAINMENT • 1010 N. COLLINS ST.

Tailgate and celebrate in the Entertainment District, across from AT&T Stadium, 18,000+ sq.ft. of interior event space. Tables, chairs, drapes and centerpieces, three high-definition presentation screens, mood lighting, AV.

DINNER/DANCE	800
RECEPTION	1,000
CLASSROOM	1,500
THEATRE	2,000
OUTDOOR GARDEN	3,000
INDOOR ROOM	
200 dinner, 250 classroom	
300 theatre	

STUDIO MOVIE GRILL

STUDIO MOVIE GRILL LINCOLN SQUARE • 452 LINCOLN SQUARE

All new location! SMG modernized the traditional movie-going experience by combining first-run movies with full-service, in-theater dining plus a full service bar. Expect from-scratch items and fresh ingredients. Private event packages include state-of-the-art digital projection and presentation equipment, complete audio/video capabilities, wifi, and F&B packages developed by in-house chefs.

9 screening rooms with luxury VIP leather recliners and rocker type seating. Combined 1,116 seating covering 45,540 SQ FT. Mezzanine - 5,580 SQ FT.



INTERNATIONAL BOWLING MUSEUM & HALL OF FAME TRAINING & RESEARCH CENTER • 621 SIX FLAGS DR.

Groups from 20-400 come alive at our International Bowling Museum & Hall of Fame. Journey back to where bowling began. Discover an interactive museum brimming with one-of-a-kind bowling artifacts and a cutting-edge glimpse at the far-flung future of this global pastime. Individual, group, and team lessons with Team USA coaches (1-15 bowlers), AV, wifi, ADA accessible.

18,000 SQ.FT. of usage space
2 breakout rooms, mini movie theater, prep kitchen, offsite catering allowed.

24,000 SQ.FT. training venue with sound system. 20 state-of-the-art lanes with projectors and screens. 16 training cameras, pro-shop, weight room.



Downtown Levitt Pavilion

EVENT Venues

ALLEY CATS ENTERTAINMENT CENTER • 2008 W. PLEASANT RIDGE RD.

DETAILS: Event packages include in-house catering, full-service bar, AV audio equipment, and breakout meeting rooms. 40,000 sq. ft. of attractions for meetings include: giant arcade, 24 bowling lanes, laser-tag, Putt-Putt Golf, indoor rock-climbing, and more.

MEETING ROOMS	5
CAPACITY BANQUET	150
CAPACITY THEATER	200
SQFT	2,300

ARLINGTON MUSEUM OF ART • 201 W. MAIN ST.

DETAILS: Offsite catering allowed, flexible floor plan allowing for multiple configurations, kitchen facilities available.

MEETING ROOMS	3
CAPACITY BANQUET	350
CAPACITY THEATER	500
SQFT	7,000

DAIREDS SALON & SPA PANGÉA, CAFÉ & CONFERENCE CENTER • 2400 W IH-20

DETAILS: Housed together in a dramatic 18,000 square-foot facility, Daireds offers services and treatments typically found in destination spas, packaged in a convenient urban setting providing guests with everything but an overnight stay. The perfect destination for social events, office parties, meetings or private lunches, the Conference Centre at Daireds provides an inspirational atmosphere, in-house catering, and special packages to bring the spa experience to your conference or party guests

MEETING ROOMS	1
CAPACITY BANQUET	50
CAPACITY THEATER	90
SQFT	864

ARLINGTON MUSIC HALL • 224 N CENTER ST.

DETAILS: Hospitality Room with full-service bar and concessions for events up to 150 people, prep kitchen with off-site catering allowed, and flexible floor plan (with portable stage) for a variety of uses.

MEETING ROOMS	3
CAPACITY BANQUET	100
CAPACITY THEATER	1070
SQFT	FLEX

TIERRA VERDE GOLF CLUB • 7005 GOLF CLUB DR.

DETAILS: Full-service restaurant and bar for events, award-winning golf course, stunning vistas, indoor and outdoor patio options.

MEETING ROOMS	2
CAPACITY BANQUET	200
CAPACITY THEATER	275
SQFT	3,200

BOB DUNCAN • 2800 S. CENTER ST. (IN VANDERGRIF PARK)

DETAILS: Caterer's kitchen, onsite and off-site catering options, tables & chairs included, excellent AV.

MEETING ROOMS	4
CAPACITY BANQUET	300
CAPACITY THEATER	500
SQFT	7,500

UT ARLINGTON - BLUEBONNET BALLROOM • UT ARLINGTON CAMPUS

DETAILS: Inhouse catering, ballroom can be divided into smaller rooms.

MEETING ROOMS	1
CAPACITY BANQUET	500
CAPACITY THEATER	900
SQFT	10,640

RIVER LEGACY PARK • 701 NORTHWEST GREEN OAKS BLVD.

DETAILS: Scenic outdoor pavillions and flexible indoor options, adjacent 1,300-acre park and the Trinity River.

MEETING ROOMS	FLEX
CAPACITY BANQUET	150
CAPACITY THEATER	250
SQFT	FLEX

PLANETARIUM AT UNIVERSITY OF TEXAS ARLINGTON • 700 PLANETARIUM PL.

DETAILS: Unique venue setting with spectacular AV opportunities.

MEETING ROOMS	FLEX
CAPACITY BANQUET	75
CAPACITY THEATER	148
SQFT	FLEX



HUB & SPOKE Attractions

Arlington provides a wealth of hotel and venue options, plus our central location between Dallas and Ft. Worth, 10 minutes from D/FW International Airport, means you will always have convenient access to all the best attractions in the Metroplex!

FORT WORTH MUSEUM OF SCIENCE & HISTORY • 1600 GENDY ST, FT. WORTH, TX 76107

Located in the heart of the Fort Worth Cultural District. The museum's environment of learning includes the Children's Museum, Dino Labs and Dino Dig, Energy Blast and Innovation Studios. The Noble Planetarium and Omni Theater, IMAX Dome make this an experience you won't forget! The entire Museum may be rented for private after hour events.

MEETING ROOMS	3
CAPACITY BANQUET	300
CAPACITY THEATER	300
SQFT	17,000+

GEORGE W. BUSH PRESIDENTIAL LIBRARY & MUSEUM • 2943 SMU BLVD, DALLAS, TX 75205

Explore the interactive museum galleries, sit in the Oval Office, enjoy the Texas Rose Garden, eat lunch in the restaurant or café, and stroll through the 15-acre park filled with native Texas prairie grasses and wildflowers.

MEETING ROOMS	7
CAPACITY BANQUET	600
CAPACITY THEATER	360
SQFT	2,3275

KIMBELL ART MUSEUM • 3333 CAMP BOWIE BLVD, FORT WORTH, TX 76107

The Kimbell Art Museum in Fort Worth hosts an excellent art collection, as well as traveling art exhibitions, and educational programs. Due to specific facility rental policy, please contact apeters@kimbellmuseum.org for more information.

CAPACITY BANQUET	FLEX
CAPACITY THEATER	FLEX
SQFT	FLEX

LONE STAR PARK • 1000 LONE STAR PARKWAY, GRAND PRAIRIE, TX 75050

Host up to 10,000 attendees with the heart-pounding excitement of live thoroughbred racing. Luxurious Penthouse Suites with spectacular views. Rentals include tables and chairs, linens, full catering menu and AV. 18 luxury suites, Alysheba Room accommodates 100-350 VIP Lounge accommodates 100-150

MEETING ROOMS	FLEX
CAPACITY BANQUET	1,200
CAPACITY THEATER	FLEX
SQFT	280,000

MEDIEVAL TIMES DINNER & TOURNAMENT • 2021 N. STEMMONS FWY, DALLAS, TX 75356

Go back in time with a short drive to Dallas for dinner and live entertainment. In addition to a great feast, your group will also witness exciting jousts, falconry, horsemanship and timeless chivalry. All of this in an incredible medieval castle setting!

MEETING ROOMS	1
CAPACITY BANQUET	200
CAPACITY THEATER	1,000
SQFT	65,000

PEROT MUSEUM OF NATURE AND SCIENCE • 2201 N. FIELD ST, DALLAS, TX 75201

From dinosaurs to DNA, amaze your brain at the 180,000 square-foot museum in Victory Park. See 11 mind-blowing exhibit halls of prehistoric creatures, outer space, wild weather, glistening gems, robots, sports, and more. Exhilarating 3D films, a Wolfgang Puck Café and outdoor leapfrog forest complete the day of family fun. The entire Museum may be rented for private after hour events.

MEETING ROOMS	FLEX
CAPACITY BANQUET	1,000
CAPACITY THEATER	297
SQFT	14,500+

RIPLEY'S BELIEVE IT OR NOT • 601 E. PALACE PARKWAY, GRAND PRAIRIE, TX 75050

Unique venue with multiple attractions under one roof: wax museum, mirror maze and more. Plus oddities from across the globe! Tables and chairs, offsite catering allowed.

MEETING ROOMS	FLEX
CAPACITY BANQUET	125
CAPACITY THEATER	125
SQFT	8,000

THE SIXTH FLOOR MUSEUM AT DEALEY PLAZA • 411 ELM ST, DALLAS, TX 75202

Impress your guests with a view from history at The Sixth Floor Museum! Gain private access to the exhibition "John F. Kennedy and the Memory of a Nation" and get creative with our seventh floor event venue, which features more than 4,500 square feet of flexible space with exposed brick walls, 14-foot ceilings and expansive windows overlooking historic Dealey Plaza and beautiful downtown Dallas.

MEETING ROOMS	2
CAPACITY BANQUET	200
CAPACITY THEATER	250
SQFT	4,500

SELECT AND LIMITED SERVICE HOTELS

HOTEL KEY







		ROOMS			CONFERENCE/MEETING FACILITIES					TRAVEL
		TOTAL ROOMS	DOUBLES	# OF COMMITTABLE ROOMS	TOTAL SQ.FT. MEETING/EXHIBIT	# OF MEETING ROOMS	BANQUET CAPACITY (#PPL)	THEATER CAPACITY (#PPL)	CLASSROOM CAPACITY (#PPL)	DISTANCE TO ACC (MILES)
Baymont Inn & Suites 2401 Diplomacy Dr.		95	55	60	400	1	26	26	26	1
Blue Cypress Hotel 117 S. Watson Rd.		192	96	100	9500	2	790	1055	400	2
Comfort Suites Arlington 411 W. Rd. to Six Flags Dr.		108	44	60	2500	2	60	70	75	1.5
Courtyard by Marriott North 1500 Nolan Ryan Expy.		147	95	30	1300	2	40	40	30	0.2
Courtyard by Marriott South 711 Highlander Blvd.		103	45	50	1879	3	90	130	40	7.5
Hampton Inn & Suites Arlington South 1100 East I-20		98	36	50	1344	2	64	70	50	7
Hampton Inn & Suites Arlington North 2200 Brookhollow Plaza Dr.		103	30	20	1456	3	40	35	30	1
Hawthorn Suites by Wyndham 2401 Brookhollow Plaza Dr		129	24	70	861	2	30	45	24	1
Hilton Garden Inn Arlington South 521 East I-20		135	68	70	8232	5	300	500	275	9
Hilton Garden Inn North 2190 E. Lamar Blvd.		132	67	60	2500	4	120	150	120	1
Holiday Inn Express & Suites 2451 East Randol Mill Rd.		102	64	30	651	1	32	50	35	1
Holiday Inn Express & Suites (I-20) 1721 Pleasant Pl.		101	23	Varies	450	1		50	30	1
Homewood Suites by Hilton 2401 Rd. to Six Flags Street East		89	13	39	294	1	18	25	18	1.5
Homewood Suites by Hilton Arlington-South 4550 Waxwing, Dr.		101	7	Varies	1800	2	80	75	50	7
Hyatt Place Arlington 2380 E Rd. to Six Flags		127	58	76	1200	2	50	60	50	0.2
La Quinta Inn & Suites Six Flags Drive 825 North Watson Rd.		178	90	30/60	4400	5	200	350	240	1
La Quinta Inn & Suites South 4001 Scots Legacy Dr.		128	86	25	700	1	35	40	25	9.9
Quality Inn at Arlington Highlands 121 East I-20		128	58	76	1200	2	50	60	50	0.2







For a complete list of hotels in Arlington, see our map on page



HOTEL KEY

ROOMS CONFERENCE/MEETING FACILITIES TRAVEL

-  DFW AIRPORT SHUTTLE
-  ON-SITE CATERING
-  FREE TROLLEY STOP
-  FREE WI-FI
-  BUSINESS CENTER

Hotel Name & Address	Icons	TOTAL ROOMS	DOUBLES	# OF COMMITTABLE ROOMS	TOTAL SQ.FT. MEETING/EXHIBIT	# OF MEETING ROOMS	BANQUET CAPACITY (#PPL)	THEATER CAPACITY (#PPL)	CLASSROOM CAPACITY (#PPL)	DISTANCE TO ACC (MILES)
Residence Inn by Marriott North 1050 Brookhollow Plaza Dr.		114	24	40	650	1	40	40	24	1
Residence Inn by Marriott South 801 Highlander Blvd.		96	7	40	1024	2	60	90	30	7.5
Sanford House Inn & Spa 506 N. Center St.		12	3	NA	2370	1	50	60	40	2.3
The Thornton Inn B&B 719 W Abram St.		5	1	N/A	550	1	15	0	12	3.2
TownePlace Suites by Marriott 1709 East Lamar Blvd.		94	22	60	0	0	0	0	0	1.1
Wingate by Wyndham 1024 Brookhollow Plaza Dr.		92	23	N/A	650	2	25	40	35	1.5

For a complete list of hotels in Arlington, see our map on page

ARLINGTON TROLLEY Service



Guests of participating Arlington Entertainment Area Management District (AEAMD) hotels receive complimentary trolley transportation to the Arlington Welcome Center, Six Flags Over Texas, Hurricane Harbor, Globe Life Park, AT&T Stadium and more! We offer four options to serve our clients. Service guidelines and hotel information available at www.arlingtontrolley.com.



FOR MEETING PLANNERS

Supplementary Convention Shuttle Service

- Groups receive one hour of complimentary service for every 80 room nights consumed in Trolley District hotels. See complete list of hotels www.arlingtontrolley.com.
- Each additional hour is \$100 (hourly) in 2017*. Service available at a minimum of three consecutive hours per vehicle.
- Capacity: 35 persons seated, air-conditioned, heated and ADA equipped.
- Service available from AEAMD Trolley District hotels to any venue in Arlington.

Request service through CVB Operations/Services two months prior to service date (application & contract required): fidel@arlington.org.

FOR ATTENDEES

FREE Regular Route Trolley Service

- Regular service from participating hotels during peak season is available to Six Flags Over Texas, Hurricane Harbor, International Bowling Museum and Hall of Fame, Globe Life

Park and AT&T Stadium (non-event days) and Arlington Convention Center (on request).

- Downtown Express service is available March through September during specified hours/days. www.arlingtontrolley.com/schedules.

This service may be accessed with a boarding pass (distributed to registered guests at AEAMD Trolley District hotels).

FREE Trolley Service to the Ballpark

- Service is independent of convention group service and is available for AEAMD Trolley District hotels to Globe Life Park for all home and post-season games.
- Service overflow vehicles available to AEAMD Trolley Hotels that anticipate groups of 35+ (over regular load, schedule with hotel sales / services representative).

Fare-Based Trolley Service to AT&T Stadium for Events

- Round-trip service for select AEAMD Trolley District hotels to AT&T Stadium events (fare-based). See complete list of hotels and fares. www.arlingtontrolley.com/attractions/att-stadium/#events

* Rates are subject to change



ARLINGTON CVB *Destination*

SPOTLIGHT ON FIDEL MITCHELL, *Convention Services Manager*

Our sales & services team is standard on paper, but not in practice. Get to know the 'Siri of Arlington,' our Convention Services Manager. Fidel is committed to brilliant customer service, and works alongside you to ensure that your Arlington event is a success.

INDUSTRY AFFILIATIONS:

- Texas Alliance of Convention, Meeting & Operations Managers (TxACOM)
- Event Service Professionals Association (ESPA) Annual Planning Committee
- Texas Association of Convention & Visitor Bureaus (TACVB)
- Dallas Fort Worth Association Executives Toastmasters
- Tarrant County College Southeast Campus - Culinary Arts / Hospitality Management, Advisory Committee

What do you like best about your job?

The people! I undoubtedly work with the best coworkers, city partners and clients! They all make my job a pleasure to do daily.

What's your favorite way to unwind at the end of the day?

The best part of my day is picking my black lab, Ella, up after work and taking her on a long walk to River Legacy Parks.

Tell us something people might not know about you.

Well, I've actually had the privilege of living in 5 different countries, most of them islands!



Fidel Mitchell
Convention Services Manager
 fidel@arlington.org
 817-704-7594

ARLINGTON CVB *Services*

■ **Digital Print Collateral** - The Arlington CVB can provide you with electronic attractions and restaurant coupons, Arlington Visitors Guide and more.

■ **Public Relations Assistance** - The Arlington CVB PR & Marketing Department can assist a group with efforts to publicize an event with a host of free tools. Whether it's a sporting event or a convention, we are more than ready to help get the word out.

■ **Transportation Coordination/Arlington Trolley** - Complimentary trolley service is available based on room night stays at participating Arlington Trolley District hotels. The Arlington CVB Team will determine eligibility, make arrangements and oversee the schedule with the Arlington Trolley service providers.

■ **Corporate Social Responsibility (CSR)** reflects a company's sense of responsibility towards the community and environment. CSR oriented companies will find a wealth of opportunities to express these interests in Arlington, and Fidel is happy to assist in that process.

■ **Attendance Builders** - The Arlington CVB will assist with pre-promotion of your conference. Opportunities include

“The Arlington CVB is the Siri of the City.”

a welcome video or Arlington collateral that can be distributed at your conference the year prior.

■ **Incentive to “Come Early, Stay Late!”** - Arlington is not only a great place to hold a conference but it is an excellent place to vacation. Connect with us and let us share all the reasons why your attendees should arrive a few days early with family. www.arlington.org/stay-play

■ **Other Services & Products** - Need access to tour guides, speakers, trade show services, printers, flowers, gifts and premium items, audiovisual, off-site venues and entertainment? The Arlington CVB can connect you with some of the best in the business. Our goal is to ensure your success!

ADDITIONAL SERVICES INCLUDE:

- Volunteer Services
- Speaker and Entertainment Coordination
- Housing Assistance
- Site Visits And FAM Tours

Get Social With Us:

 /VisitArlingtonTexas  /visit_arlington



After

5

LIGHT UP THE NIGHT with live music, comedy, pubs, karaoke bars and more. Sample a local beer from an award-winning brewery. Whether you want to dress up or scoot a boot, you'll find a vibrant scene to entertain you. Take off your lanyard! Arlington awaits.

- **ARLINGTON IMPROV & BLACK DOG PIZZA** | Arlington Highlands
Wed 6 pm-11 pm, Thurs 4:30 pm-10 pm, Fri-Sat 11 am-2 am, Sun 12 pm-midnight
- **BLUE MESA GRILL** | 550 Lincoln Square
Mon-Thurs 11 am-10 pm, Fri-Sat 11 am-11 pm, Sun 9 am-10 pm
Bar open until 2 am Thurs-Sat >>> *Known for an extensive tequila selection*
- **BOOMERJACK'S GRILL & BAR** | two locations
Lincoln Square Shopping Center & Arlington Highlands Shopping Center
Mon-Sun 10:30 am-2 am
- **BOSTON'S RESTAURANT & SPORTS BAR** | 2501 E. Lamar
Wed-Sun-11 am-1 am, Thu-Sat 11 am-2 am
- **BREAKOUT ARLINGTON** | 3811 S. Cooper St., Suite 02208
Based on game availability. See website to book games until midnight.
>>> *Real life games & puzzles to escape a room before the clock runs out.*
- **BUFFALO WINGS & RINGS** | 2150 E. Lamar Blvd. Suite 110
Sun-Thurs 11 am-12am, Fri-Sat 11 am-1 am >>> *Club-level sports experience*
- **DAIQUIRI DEPOT** | 2544 E. Abrams St. #100
Mon-Thurs 2 pm-11 pm, Fri 11 am-12 am, Sat 11 am-12 am, Sun 12 pm-8 pm
- **DALLAS WINGS WNBA AT COLLEGE PARK CENTER** | 600 S. Center St.
See current season schedule
- **DIVISION BREWING** | 506 E. Main St.
Sat 1 pm-6 pm, Thurs 4 pm-10 pm >>> *Locally owned & operated brewery*
- **FREE PLAY ARLINGTON ARCADE** | 400 E. South St.
Arcade, bar, and restaurant
- **HOOLIGANS PUB** | 310 E Abram St. #150 (Downtown Arlington)
Mon-Fri 4 pm-2:30 am, Sat-Sun 2 pm-2:30 pm
- **HUMPERDINK'S RESTAURANT & BREW PUB** | 700 Six Flags Dr.
Mon-Sun 11 am-2:00 am >>> *Microbrewery*
- **J. GILLIGAN'S BAR & GRILL** | 400 E. Abrams (Downtown Arlington)
Mon-Sun 10 am-11 pm, Fri-Sat 10 am-12 am
>>> *As seen on the Travel Channel, invented the Irish Nacho*
- **J.R BENTLEY'S, AN ENGLISH PUB** | 406 W. Abram St.
Mon-Sat 11 am-2 am >>> *Extensive imported beer selection*
- **K1 SPEED INDOOR RACING** | 1801 E. Lamar Blvd.
Mon-Thurs noon-10pm, Fri 11 am-11 pm, Sat 10 am-11 pm, Sun 10 am-8 pm
- **KOOL KEG** | 207 S. East St.
Mon-Fri 12 pm-12 am, Sat 11 am-1 am
- **LEGAL DRAFT BEER CO.** | 500 E. Division St.
Varied hours >>> *Craft beer from a German Brewmaster*
- **THE MELTING POT FONDUE RESTAURANT** | 4000 Five Points Blvd., Ste.119
Mon-Thurs 5 pm-10 pm, Fri 5 pm-11 pm, Sat 3:30 pm-11 pm, Sun 3 pm-9 pm
>>> *Selection of more than 100 wines*
- **THE ROCK WOOD FIRED KITCHEN** | 2300 E. Lamar Blvd.
Mon-Sun 11:30 am-12 am
- **SHERLOCK'S BAKER STREET PUB & GRILL** | Lincoln Square Shopping Center
Mon-Sun 11 am-2 am



Hours are subject to change.



ARLINGTON.ORG/MEETINGS
817-265-7721 | sales@arlington.org

Top 10 reasons to select Arlington for your next event.

- 1) **HOTEL BLOCKS** – No need to call around town to determine pricing when we can help you gather room block pricing. Talk about one-stop-shopping!
- 2) **PLANES, TRAINS, AUTOMOBILES...AND TROLLEYS** – We're perfectly situated next to DFW International Airport, and our Services team is ready and willing to help you and your group/attendees get where they need to be. Need a party bus, stagecoach or our friendly neighborhood Arlington Trolley? They will pull out the stops, no pun intended, to get your group rolling (pun intended).
- 3) **ONE WORD: LOCATION, LOCATION, LOCATION!** – Few destinations are as traveler-friendly as Arlington. DFW International Airport serves more than 24 scheduled airlines, providing non-stop service from more than 200 U.S. domestic and international cities combined.
- 4) **CHAMPAGNE TASTE ON A BEER BUDGET** – Have a 'different' budget or meeting size? Give us a try. Compared to other U.S. destinations, you'll find Arlington accommodations and venues are among the best deals.
- 5) **WE'RE FREE TO YOU** – Imagine having a team of experts dedicated to your event and its success. Answering your questions. Trouble-shooting your needs. How much would you pay for this? Put your wallet away...our priceless services are complimentary to meeting and event planners that utilize hotel rooms in Arlington.
- 6) **PERSONALIZED SERVICE** – We've made a reputation of taking every client's vision and making it happen. Don't doubt the talent! Our VP of Convention Services once wrangled a live boxing kangaroo for a client's event. Ka-pow!
- 7) **DID SOMEBODY SAY SHOPPING??** – Can shopping solve all the world's problems? Maybe. Looking fabulous at your meeting or convention is a good place to start. Arlington offers amazing retail therapy—the Parks at Arlington Mall, Lincoln Square, Arlington Highlands and Grand Prairie Premium Outlets are within 5 short miles of each other. Let the healing begin.
- 8) **MORE TO A MEETING THAN A MEETING** – Hear the crack of the bat at Globe Life Park, take a whirl on a roller coaster, dine in a rustic barn...Arlington is all about experiences. Go on and brag to your friends and make 'em ask "do you ever work?"
- 9) **MAKING THE IMPOSSIBLE POSSIBLE** – Questions because something unexpected has happened to your event plans? We are a phone call away with vendor support and logistic suggestions to keep things on track.
- 10) **WE'RE NATURALLY BEAUTIFUL** – Breaktime! Stretch your legs and refocus beside the ACC's scenic lake. Or burn off the ACC's decadent bread pudding on the adjacent outdoor walking trails. Arlington boasts River Legacy Park, which is a 1,300-acre urban oasis that follows the scenic Trinity River. And it's hard to find a more beautiful course than the award-winning Tierra Verde Golf Club. We have the nifty Audubon-Society sanction to prove it. Or how about a spin on the Entertainment District segway tour?

The Enterprise Way

Need a rental?

Whether you need a car, truck or 15 passenger van,
Enterprise is the perfect choice. And, we'll pick your customers up.

*Reference discount code # **L9C1291** on your next rental.*

*For more information, visit www.enterprise.com
or call (817) 459-4001 to speak with a representative.*



We'll pick you up.®