



**Huntington**  
Convention  
Center of Cleveland



# Map and Center Overview

Huntington Convention Center of Cleveland



- Exhibit Halls
- Ballrooms
- Meeting Rooms
- Exhibit Hall Concessions
- The UPS Store, Bagel Boulevard and Starbucks
- Show Offices
- Public Restrooms
- Back of House
- ➔ Connections to Hilton and Public Auditorium
- P Huntington Park Garage
- ⊗ Elevators
- 💧 Water Bottle Refill Stations
- Lactation Stations



# Level 1



## Atrium Ballroom

- Wooden Feature Wall
- Colored LED Lights
- Multiple Configurations
- 20,000 total sqft

## Atrium Lobby

- The UPS Store
- Bagel Boulevard
- Starbucks
- Floor to Ceiling Windows
- Siegel & Shuster Tribute Plaza
- 8,200 sqft

# Level 2

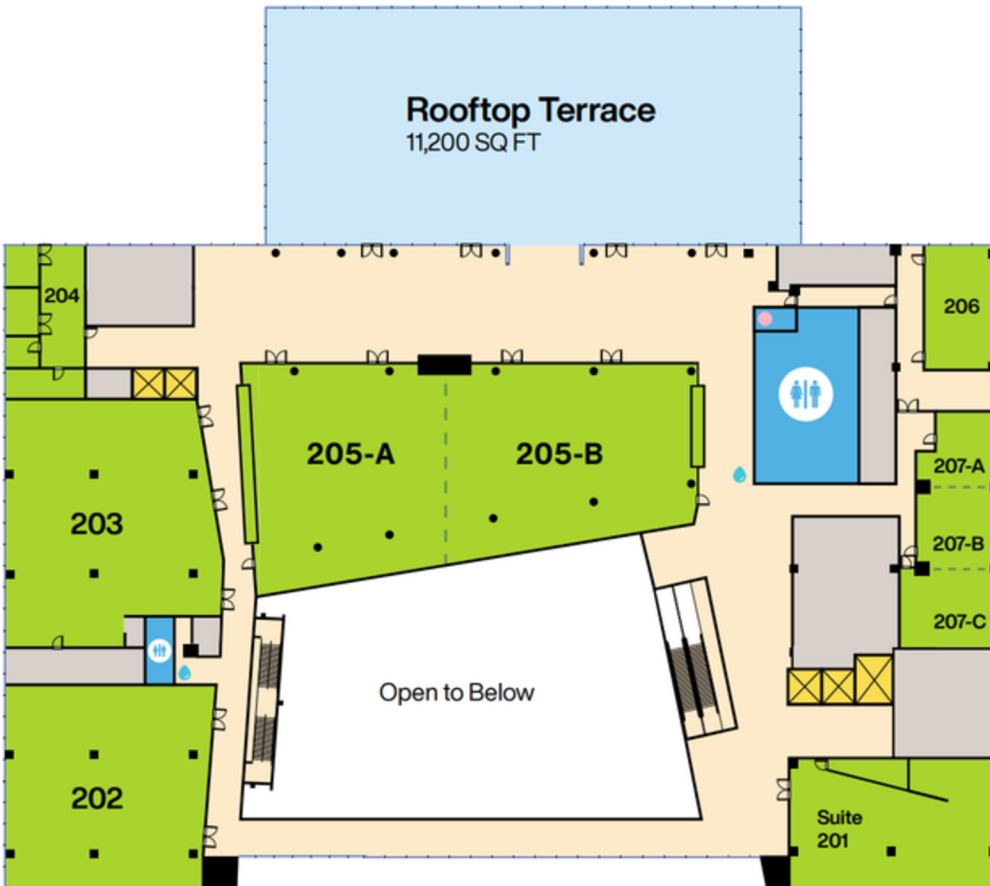

## Rooftop Terrace

- Tented
- Outdoor Seating
- View of Terminal Tower
- 11,200 sqft

## Suite 201

Networking Receptions | Private Dinners

- Built in Hot/Cold Bar
- Conference Area
- Premium Furniture
- 2,670 sqft

## Conference Room

### 207-ABC Combinations

Conf. Room 207-ABC	1,775 sqft
Conf. Room 207-AB	1,050 sqft
Conf. Room 207-BC	1,325 sqft

# Level 3

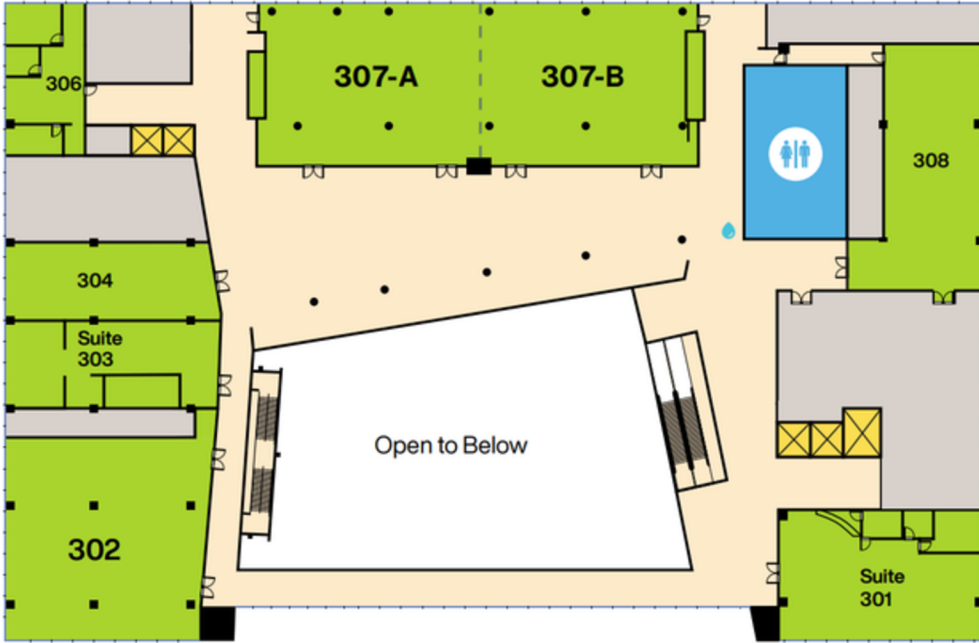

## Suite 301

Social Mixers | Team Building

- Pool Table
- Premium Furniture
- Breakout Areas
- 2,650 sqft

## Suite 303

Board Meetings | Team Workspace

- Conference Room
- Elegant Foyer
- Coat Room
- Kitchenette
- 1,600 sqft

# Level 4

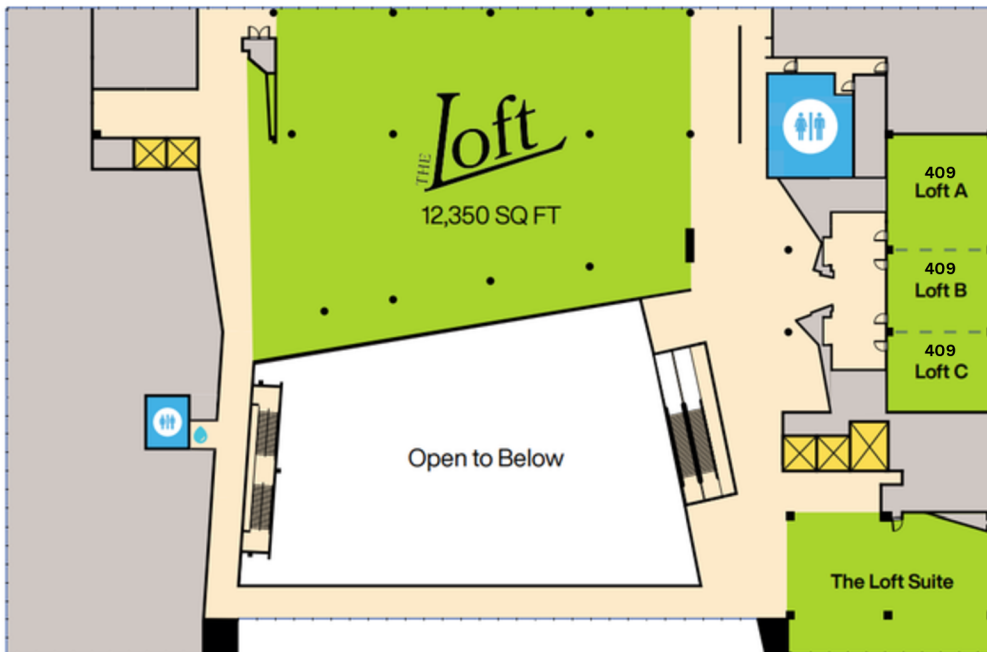

# THE Loft

## The Loft Conference

### 409-ABC Combinations

Loft Conf. 409-ABC	2,600 sqft
Loft Conf. 409-AB	1,875 sqft
Loft Conf. 409-BC	1,475 sqft

## The Loft Suite

Executive Dinners | VIP Receptions

- Open Concept
- Elevated Seating
- Lake & City Views
- 2,600 sqft

## Convention Center Meeting Space Specifications

Exhibit Halls	Location	Space Name	Square Feet	10 x 10 Booths	Floor Load	Overhead Doors	Ceiling Height	Dimensions
	Exhibit Level	Hall-ABC	225,000	1,090	350 LBS/SF	4	25' - 40'	547' x 631'
	Exhibit Level	Hall-AB	141,500	725	350 LBS/SF	2	25' - 30'	547' x 308'
	Exhibit Level	Hall-BC	172,000	885	350 LBS/SF	3	30' - 40'	318' x 631'
	Exhibit Level	Hall-A	53,000	245	350 LBS/SF	1	25'	231' x 252'
	Exhibit Level	Hall-B	88,500	470	350 LBS/SF	1	30'	317' x 308'
	Exhibit Level	Hall-C	83,500	395	350 LBS/SF	2	30' - 40'	317' x 324'
<b>Total</b>			<b>225,000</b>					

Ballrooms	Location	Space Name	Square Feet	Theater	Classroom	Banquet	Ceiling Height	Dimensions
	Ballroom Level	Grand Ballroom-ABC	32,200	3,570	2,079	2,500	24' 6"	242' x 134'
	Ballroom Level	Grand Ballroom-AB	21,475	2,220	1,452	1,480	24' 6"	161' x 132'
	Ballroom Level	Grand Ballroom-BC	21,675	2,220	1,452	1,600	24' 6"	165' x 134'
	Ballroom Level	Grand Ballroom-A	10,525	1,088	690	720	24' 6"	78' x 133'
	Ballroom Level	Grand Ballroom-B	10,950	1,080	414	720	24' 6"	81' x 133'
	Ballroom Level	Grand Ballroom-C	10,725	1,120	736	720	24' 6"	84' x 134'
<b>Total</b>			<b>32,200</b>					

Meeting Rooms	Location	Space Name	Square Feet	Theater	Classroom	Banquet	Ceiling Height	Dimensions
	Concourse Level	1	2,775	352	198	150	13' 2"	68' x 41'
	Concourse Level	2	825	74	39	60	10' 4"	38' x 23'
	Concourse Level	3	2,375	284	157	170	11'	55' x 44'
	Concourse Level	4	2,375	284	157	170	10'	55' x 44'
	Concourse Level	5	2,425	285	159	170	9' 7"	55' x 45'
	Concourse Level	6	2,275	238	134	180	11'	43' x 55'
	Concourse Level	7	2,175	260	146	160	9'	44' x 50'
	Concourse Level	8	1,200	118	60	80	9'	44' x 28'
	Exhibit Hall Level	9	1,550	165	102	120	16'	30' x 53'
	Exhibit Hall Level	10	1,450	159	90	100	15'	51' x 29'
	Exhibit Hall Level	11	1,450	159	90	100	15'	51' x 29'
	Exhibit Hall Level	12	1,325	142	91	110	15'	51' x 27'
	Exhibit Hall Level	13	1,475	150	92	110	15'	51' x 32'
	Exhibit Hall Level	14	1,375	146	82	90	15'	29' x 51'
	Exhibit Hall Level	15	1,525	170	101	100	15'	31' x 51'
	Exhibit Hall Level	16	1,600	185	104	100	15'	28' x 60'
	Exhibit Hall Level	17	800	75	39	50	16'	40' x 21'
	Exhibit Hall Level	18	800	69	35	50	16'	40' x 21'
	Exhibit Hall Level	19	1,500	164	99	90	16'	57' x 27'
	Exhibit Hall Level	20	1,500	168	99	100	16'	57' x 27'
	Exhibit Hall Level	21	1,500	168	99	100	16'	57' x 27'
	Exhibit Hall Level	22	1,500	168	99	100	16'	57' x 27'
	Exhibit Hall Level	23	1,500	159	99	100	16'	57' x 27'
	Exhibit Hall Level	24	1,450	157	99	100	16'	57' x 27'
	Ballroom Level	25-ABC	4,725	440	270	300	20'	87' x 58'
	Ballroom Level	25-AB	2,950	348	187	220	20'	54' x 57'
	Ballroom Level	25-BC	3,275	320	201	240	20'	61' x 57'
	Ballroom Level	25-A	1,450	163	101	100	20'	26' x 57'
	Ballroom Level	25-B	1,500	166	93	120	20'	28' x 57'
	Ballroom Level	25-C	1,775	204	109	120	20'	33' x 57'
	Ballroom Level	26-ABC	6,600	660	378	470	20'	119' x 57'
	Ballroom Level	26-AB	4,425	378	234	340	20'	80' x 57'
	Ballroom Level	26-BC	4,425	374	234	320	20'	80' x 57'
Ballroom Level	26-A	2,175	251	138	150	20'	40' x 57'	
Ballroom Level	26-B	2,250	264	162	150	20'	41' x 57'	
Ballroom Level	26-C	2,175	242	141	150	20'	39' x 57'	
<b>Total</b>			<b>50,050</b>					

PF Space	Location	Space Name	Square Feet	Theater	Classroom	Banquet	Ceiling Height	Dimensions	
	Lakeside Lobby	Pre-Function Space	4,170	-	-	-	-	-	-
	Lakeside Lounge	Pre-Function Space	1,140	-	-	-	11'	57' x 20'	
	Rock Hall Landing	Pre-Function Space	1,710	-	-	-	30'	57' x 30'	
	Concourse Level	Pre-Function Space	20,650	-	-	-	9' 6" - 13'	-	
	Exhibit Hall Level	Pre-Function Space	20,000	-	-	-	15' x 6"	-	
Ballroom Level	Pre-Function Space	16,200	-	-	-	24' x 5"	-		
<b>Total</b>			<b>63,870</b>						

## Atrium Meeting Space Specifications

Suites	Location	Space Name	Square Feet	Theater	Classroom	Banquet	Ceiling Height	Dimensions
	Atrium Level 2	Suite 201	2,670	Contemporary Design w/ Premium Furniture			10'3"	62' x 37'
	Atrium Level 3	Suite 301	2,650	Contemporary Design w/ Premium Furniture			9'9"	62' x 31'
	Atrium Level 3	Suite 303	1,600	Boardroom for 12 w/ Private Foyer for 20			9'9"	-
	Atrium Level 4	The Loft Suite	2,600	Contemporary Design w/ Premium Furniture			9'9"	62' x 50'
<b>Total</b>			<b>9,520</b>					

Ballrooms	Location	Space Name	Square Feet	Theater	Classroom	Banquet	Ceiling Height	Dimensions
	Atrium Level 1	Atrium Ballroom-ABCDEF	20,000	1,914	1,263	1,290	25'5"	151' x 129'
	Atrium Level 1	Atrium Ballroom-ABDE	13,000	957	648	740	25'5"	-
	Atrium Level 1	Atrium Ballroom-BCEF	10,800	870	576	550	25'5"	-
	Atrium Level 1	Atrium Ballroom-AD	9,200	694	564	460	25'5"	-
	Atrium Level 1	Atrium Ballroom-CF	7,000	522	336	330	25'5"	-
	Atrium Level 1	Atrium Ballroom-A	4,650	390	252	230	25'5"	71' x 59'
	Atrium Level 1	Atrium Ballroom-B	1,900	Corridor			25'5"	70' x 24'
	Atrium Level 1	Atrium Ballroom-C	3,450	270	180	150	25'5"	74' x 44'
	Atrium Level 1	Atrium Ballroom-D	4,550	360	252	200	25'5"	72' x 59'
	Atrium Level 1	Atrium Ballroom-E	1,900	Corridor			25'5"	72' x 24'
	Atrium Level 1	Atrium Ballroom-F	3,550	270	180	150	25'5"	72' x 44'
<b>Total</b>			<b>20,000</b>					

Meeting Rooms with Natural Light	Location	Space Name	Square Feet	Theater	Classroom	Banquet	Ceiling Height	Dimensions	
	Atrium Level 2	202	3,700	250	220	210	10'1"	60' x 59'	
	Atrium Level 2	203	4,375	300	291	300	10'1"	73' x 62'	
	Atrium Level 2	204	1,000	Office Space - 4 private offices					
	Atrium Level 2	205-AB	8,000	701	459	490	10'5"	131' x 66'	
	Atrium Level 2	205-A	3,875	301	186	270	10'5"	57' x 66'	
	Atrium Level 2	205-B	4,125	354	221	240	10'5"	74' x 57'	
	Atrium Level 2	Exec. 206	1,750	Boardroom for 48 (22 at table / 26 around perimeter)					
	Atrium Level 2	Conf. Room 207-ABC	1,775	105	56	80	10'3"	68' x 22'	
	Atrium Level 2	Conf. Room 207-AB	1,050	72	36	50	10'3"	28' x 22'	
	Atrium Level 2	Conf. Room 207-BC	1,325	85	38	60	10'3"	44' x 22'	
	Atrium Level 2	Conf. Room 207-A	450	28	16	10	10'3"	19' x 22'	
	Atrium Level 2	Conf. Room 207-B	600	32	18	20	10'3"	24' x 22'	
	Atrium Level 2	Conf. Room 207-C	725	48	22	30	10'3"	23' x 28'	
	Atrium Level 3	302	3,750	250	230	250	10'4"	60' x 60'	
	Atrium Level 3	304	1,500	154	88	100	10'1"	62' x 23'	
	Atrium Level 3	306	1,200	Office Space - 4 private offices					
	Atrium Level 3	307-AB	6,500	554	410	420	10'5"	127' x 49'	
	Atrium Level 3	307-A	3,300	292	188	240	10'5"	65' x 49'	
	Atrium Level 3	307-B	3,200	316	189	200	10'5"	62' x 49'	
	Atrium Level 3	308	1,850	150	144	120	10'	72' x 31'	
	Atrium Level 4	The Loft	12,350	1,033	837	750	9'8"	140' x 101'	
	Atrium Level 4	Loft Conf. Room 409-ABC	2,600	270	84	140	10'2"	83' x 28'	
	Atrium Level 4	Loft Conf. Room 409-AB	1,875	230	58	80	10'2"	59' x 28'	
	Atrium Level 4	Loft Conf. Room 409-BC	1,475	110	48	80	10'2"	48' x 28'	
	Atrium Level 4	Loft Conf. Room 409-A	1,125	64	30	40	10'2"	34' x 31'	
	Atrium Level 4	Loft Conf. Room 409-B	750	50	48	30	10'2"	24' x 28'	
	Atrium Level 4	Loft Conf. Room 409-C	725	48	24	30	10'2"	23' x 28'	
<b>Total</b>			<b>50,350</b>						

PF Space	Location	Space Name	Square Feet	Theater	Classroom	Banquet	Ceiling Height	Dimensions
	Atrium Level 1	Atrium Lobby	8,200	-	-	-	70'	-
	Atrium Level 1	Registration Counter	175	-	-	-	12'	25' x 7'
	Atrium Level 2	Pre-Function Space	9,100	-	-	-	10'8"	-
	Atrium Level 3	Pre-Function Space	15,750	-	-	-	10'7"	-
Atrium Level 4	Pre-Function Space	6,400	-	-	-	9'9"	-	
<b>Total</b>			<b>39,625</b>					

Outdoor	Location	Space Name	Square Feet	Theater	Classroom	Banquet	Ceiling Height	Dimensions	
	Atrium Level 2	Rooftop Terrace	11,200	-	-	-	-	-	
	Street Level	East Plaza	20,000	-	-	-	-	-	
	Street Level	Tribute Plaza	2,500	-	-	-	-	50' x 50'	
	Street Level	West Mall Drive	20,000	To Secure, Please Contact the <a href="#">City of Cleveland Special Events Department</a>					
	Street Level	Mall B	175,000	To Secure, Please Contact the <a href="#">City of Cleveland Special Events Department</a>					
Street Level	Mall C	140,000	To Secure, Please Contact the <a href="#">City of Cleveland Special Events Department</a>						
<b>Total</b>			<b>368,700</b>						



*Cleveland*<sup>®</sup>

