



Digital Signage Guide

Huntington Convention Center of Cleveland

9.13.24

Introduction

The Huntington Convention Center of Cleveland is excited to offer an advertising program to visiting shows.

Guests and attendees want to know what is happening at your event, and this is an opportunity for you to capture their attention.

Our advertising program includes opportunities for static and video signage. We are open to customizing a package just for you.



Video Walls - Specs

The Huntington Convention Center of Cleveland offers opportunities for digital advertising on our high-definition video walls and digital display boards. Our video walls and digital display boards are strategically placed in high traffic areas.

Video Walls

Throughout our Center, there are four (4) Video Walls available for advertising. These could be utilized to display a video that highlights your business.

Location	Board Name	Size
Atrium Lobby	Atrium Lobby Nanolumens	
Lakeside Entrance	Lakeside - East	55" Monitors (2x3) 66 in x 81 in
Lakeside Entrance	Lakeside - West	55" Monitors (2x3) 66 in x 81 in
Exhibit Hall Level Prefunction	C3 3x3	55" Monitors (3x3) 144 in x 81 in

Technical Specifications:

- 1920 x 1080 px
- Files must be submitted as a JPG or MP4
- RGB Color
- Minimum 300dpi

Video Walls - Photos



Lakeside Entrance - East

1920 x 1080 px



Lakeside Entrance - West

1920 x 1080 px

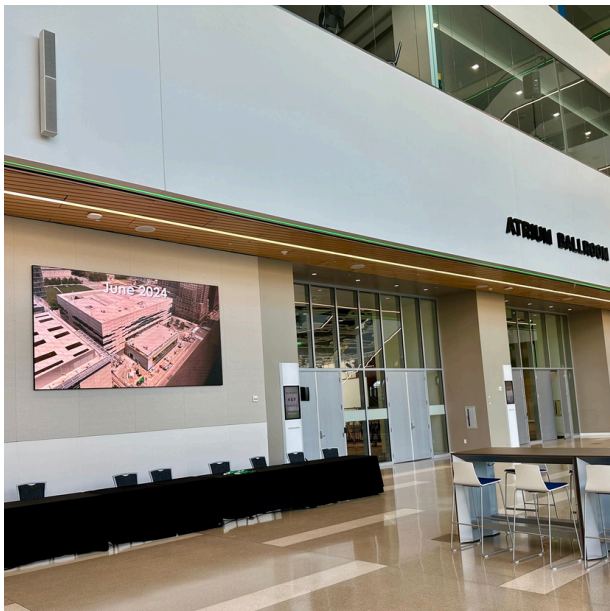

Atrium Lobby Nanolumens

1920 x 1080 px



Exhibit Hall Level C3 3x3

1920 x 1080 px

Digital Display Boards - Specs

Throughout the Center there are **ten (10)** Digital Display Boards available for advertising. These can be used to display static and video messaging, along with business information.

Level	Location
Floor 4 - The Loft	Elevators
Floor 3	Elevators
Floor 2	Elevators
Atrium Lobby	Elevators
Concourse Level	Elevators
Concourse Level	Guest Services Desk
Exhibit Hall Level	Elevators
Exhibit Hall Level	Exhibit Hall C East Entrance
Ballroom Level	Elevators

Technical Specifications:

- 1920 x 1080 px
- Files must be submitted as a JPG or MP4
- RGB Color
- Minimum 300dpi

Digital Display Boards - Photos



The Loft Elevators North

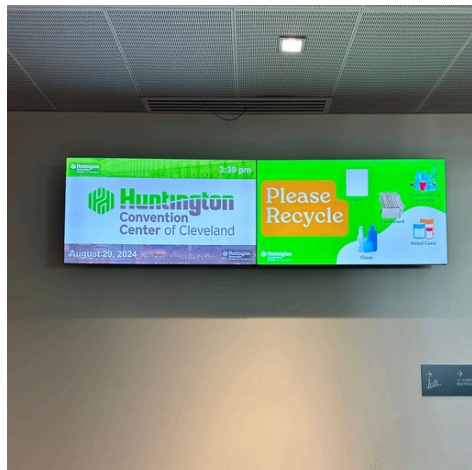

The Loft Elevators South

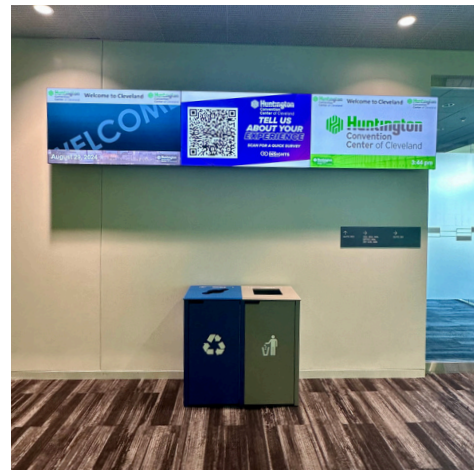

Floors 2 & 3 Elevators North

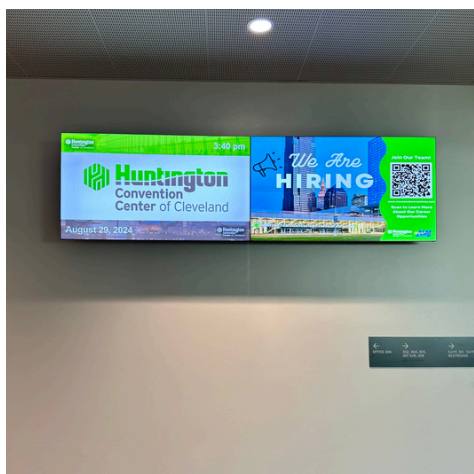

Floors 2 & 3 Elevators South

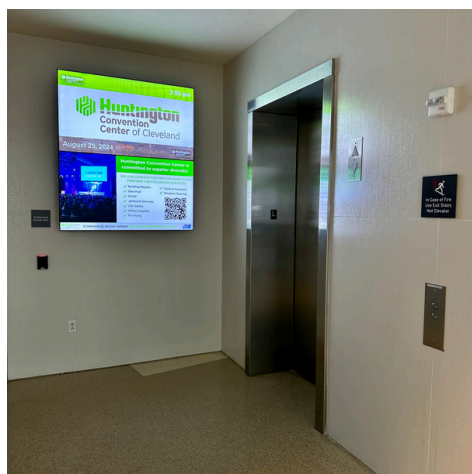

Atrium Lobby Elevators North

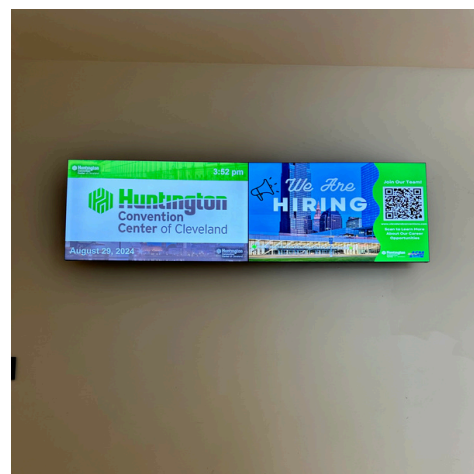

Atrium Lobby Elevators South

Technical Specifications:

- 1920 x 1080 px
- Files must be submitted as a JPG or MP4
- RGB Color
- Minimum 300dpi

Digital Display Boards - Photos Cont.

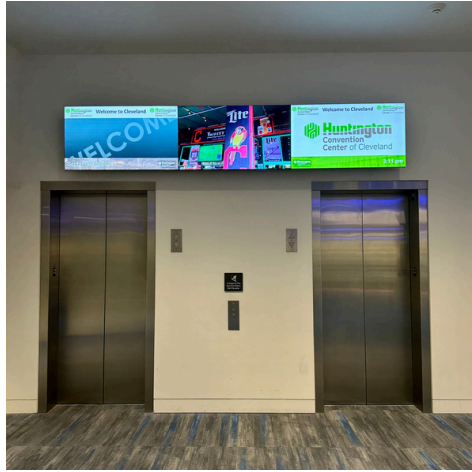

Concourse Elevators



Concourse Guests Services Desk

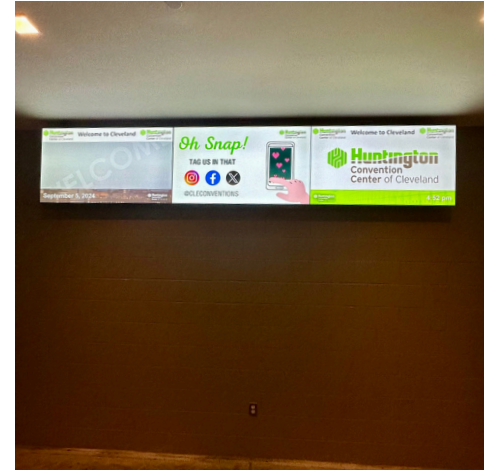

Exhibit Hall A Elevators

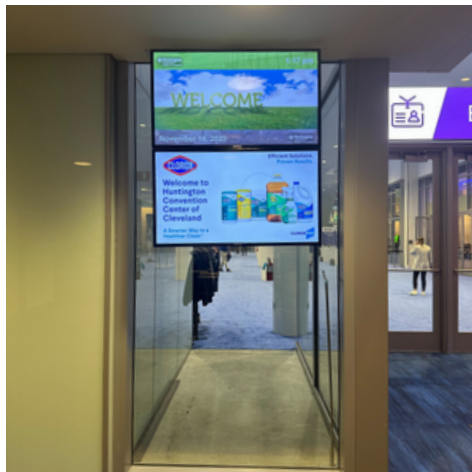

Exhibit Hall C East Entrance

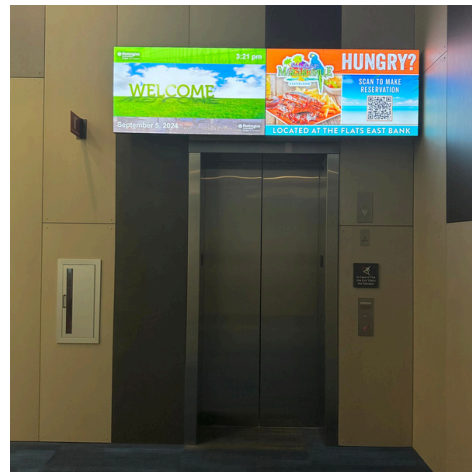
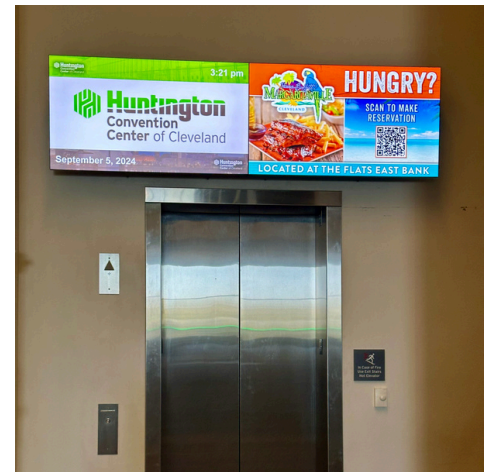

Exhibit Hall Level Elevators



Ballroom Level Elevators

Technical Specifications:

- 1920 x 1080 px
- Files must be submitted as a JPG or MP4
- RGB Color
- Minimum 300dpi

Exhibit Hall Reader Boards - Specs

Throughout the Center there are six (6) Exhibit Hall Reader Boards. These boards are available for events to advertise based on their corresponding space rental. These can be used to display static and video messaging, along with business information.

Level	Location	Size
Concourse Level	Hall A - Upstairs	1440 x 270 px
Concourse Level	Hall A - Downstairs	2400 x 270 px
Concourse Level	Hall B - Downstairs	2400 x 270 px
Exhibit Hall Level	Hall C - Front	2400 x 270 px
Exhibit Hall Level	Hall C - East	2400 x 270 px
Exhibit Hall Level	Hall C - West	2400 x 270 px

Technical Specifications:

- Files must be submitted as MP4 file

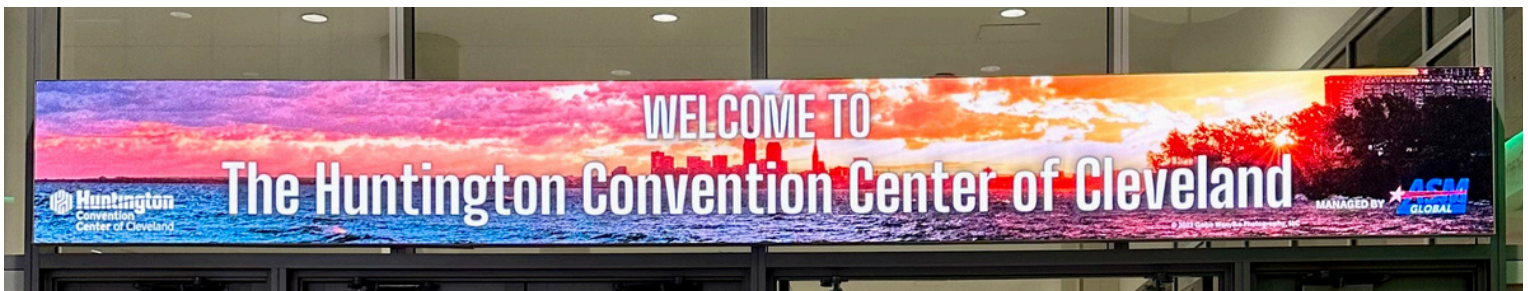

Exhibit Hall Reader Boards - Photos



Hall A - Upstairs

1 440 x 270 px



Hall A - Downstairs

2400 x 270 px

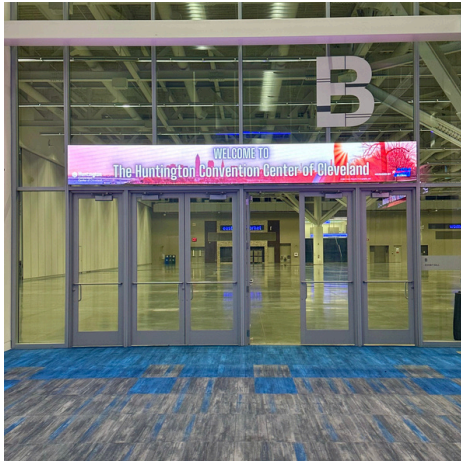

Hall B - Downstairs

2400 x 270 px

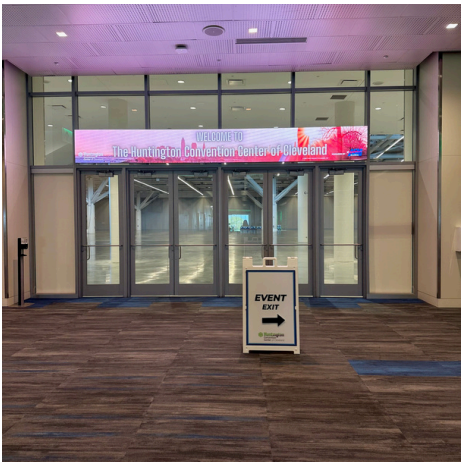

Hall C - Front

2400 x 270 px

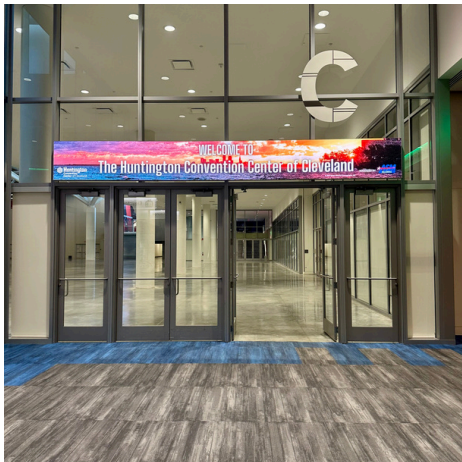

Hall C - East

2400 x 270 px



Hall C - West

2400 x 270 px

Meeting Room Displays - Specs

Throughout the Center there are digital displays outside of each meeting room. These boards are available for events to advertise based on their corresponding space rental. These can be used to display static and video messaging, along with event information.

Level	Rooms	Size
Floor 3	301, 302, 303, 304, 306, 307A, 307B	1920 x 1080 px
Floor 2	201, 202, 203, 205A, 205B	1920 x 1080 px
Atrium Level	Atrium Ballrooms A, B, and C	1080 x 1920 px
Concourse Level	1, 2, 3, 4, 5, 6, 7, 8	1920 x 1080 px
Exhibit Hall Level	9, 10, 11, 12, 13, 14, 15, 16, 17, 18, 19, 20, 21, 22, 23, 24	1920 x 1080 px
Ballroom Level	25A, 25B, 25C, 26A, 26B, 26C, Grand Ballroom A, B, and C	1920 x 1080 px

Technical Specifications:

- Files must be submitted as a JPG or MP4
- RGB Color
- Minimum 300dpi

Meeting Room Displays - Photos



Level 3

1920 x 1080 px

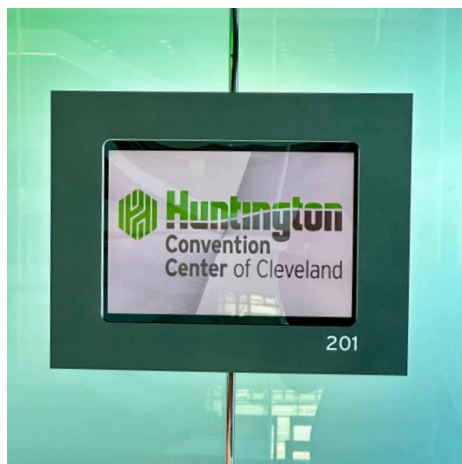

Level 2

1920 x 1080 px



Atrium Ballrooms

1080 x 1920 px



Concourse

1920 x 1080 px



Exhibit Hall Level

1920 x 1080 px

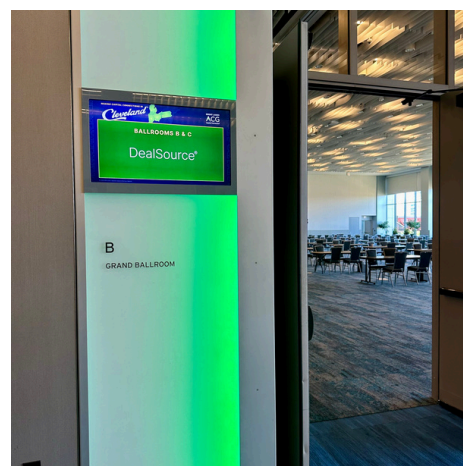

Grand Ballrooms

1920 x 1080 px

Map Overview

ATRIUM

CONVENTION CENTER

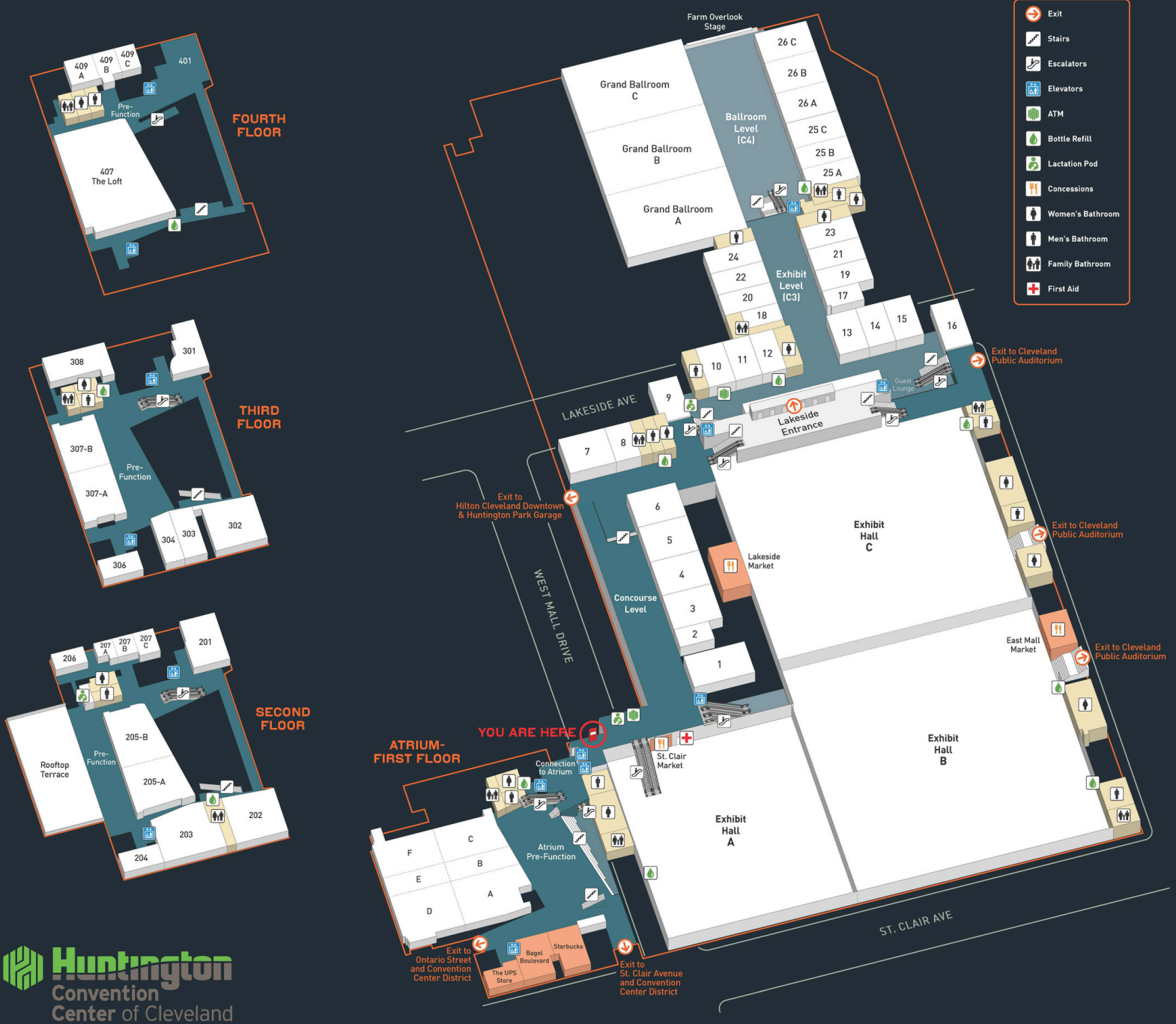

Splash Page - Licensed Areas

There is an opportunity to sponsor Wi-Fi in all licensed areas of the Center. The Center will create a custom splash page using event branding.

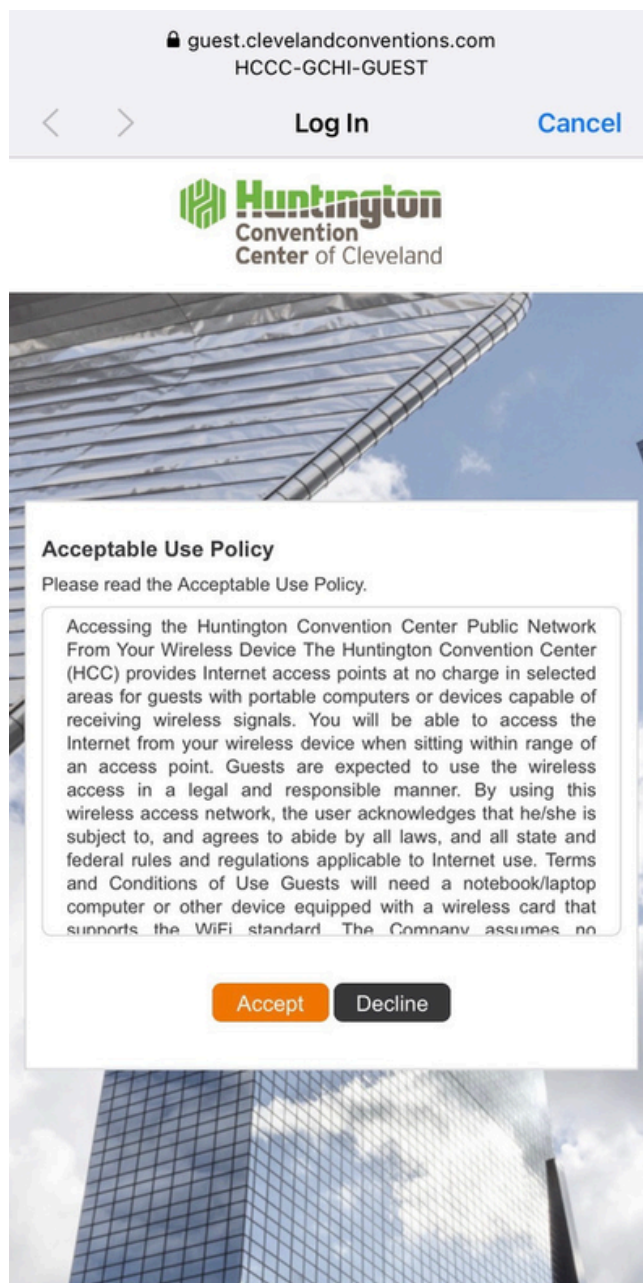

For questions and pricing regarding Splash Pages, please reach out to our IT Assistant Manager, **Mike Yeager**, at 216.920.1447 or myeager@clevelandconventions

Contact Us

For questions and pricing regarding Digital Signage, please reach out to our Marketing Coordinator, **Jordan Gura**, at 216.920.1435 or jgura@clevelandconventions.com

