

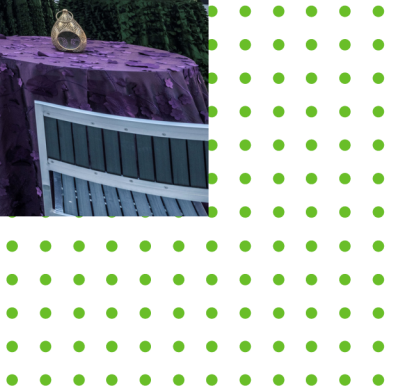

**Huntington**  
Convention  
Center of Cleveland

The logo for the Huntington Convention Center of Cleveland is displayed on a green background. The logo consists of a stylized, geometric icon on the left, followed by the name "Huntington Convention Center of Cleveland" in a clean, sans-serif font.

# FLOOR 1

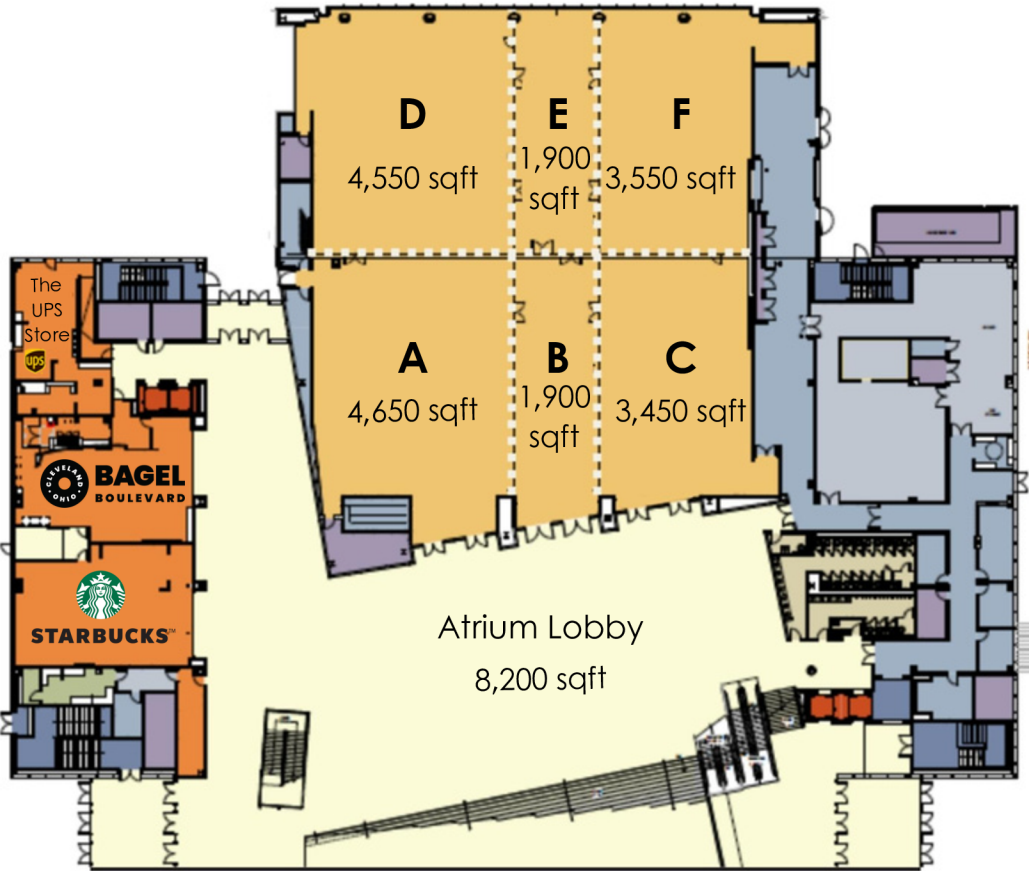

**Atrium Ballroom**  
Total 20,000 sqft

**Common Space**  
8,200 sqft



# FLOOR 2

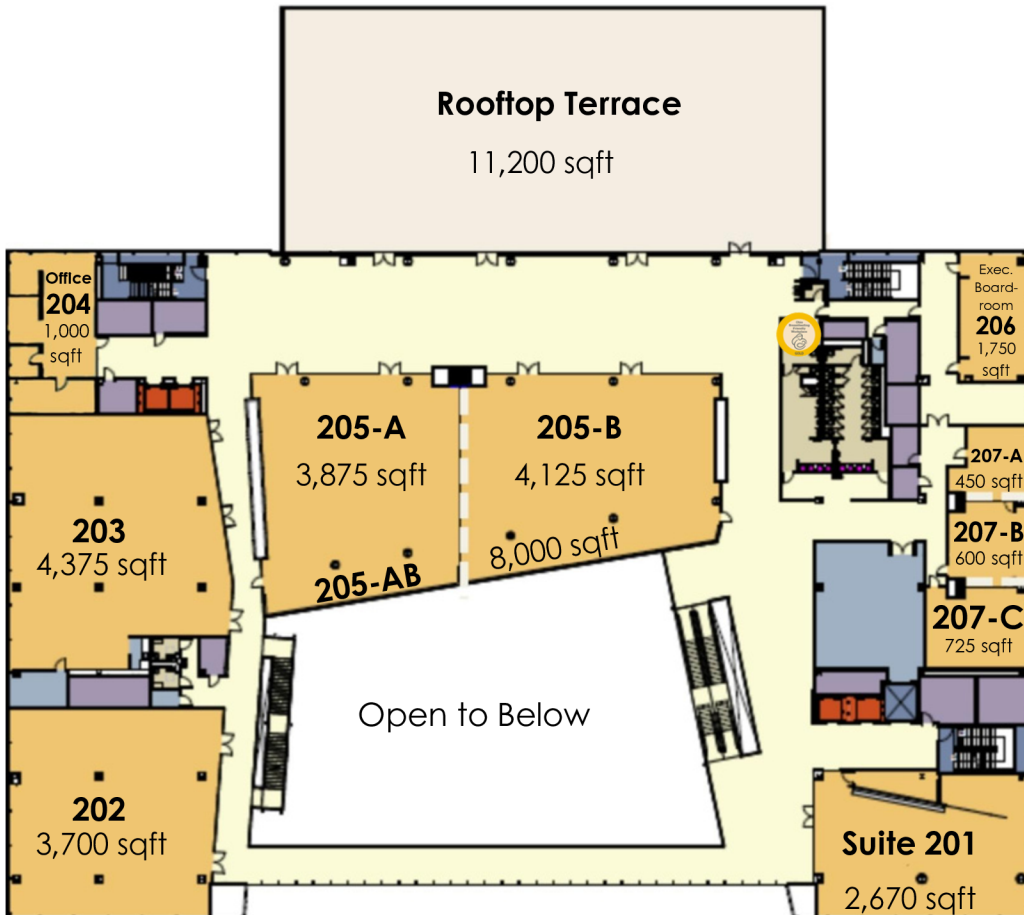

**Lactation Station**

**Common Space**  
9,700 sqft

**207 Combinations**

207-ABC	1,775 sqft
207-AB	1,050 sqft
207-BC	1,325 sqft

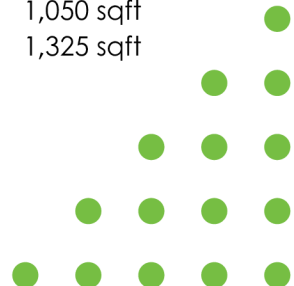

# FLOOR 3

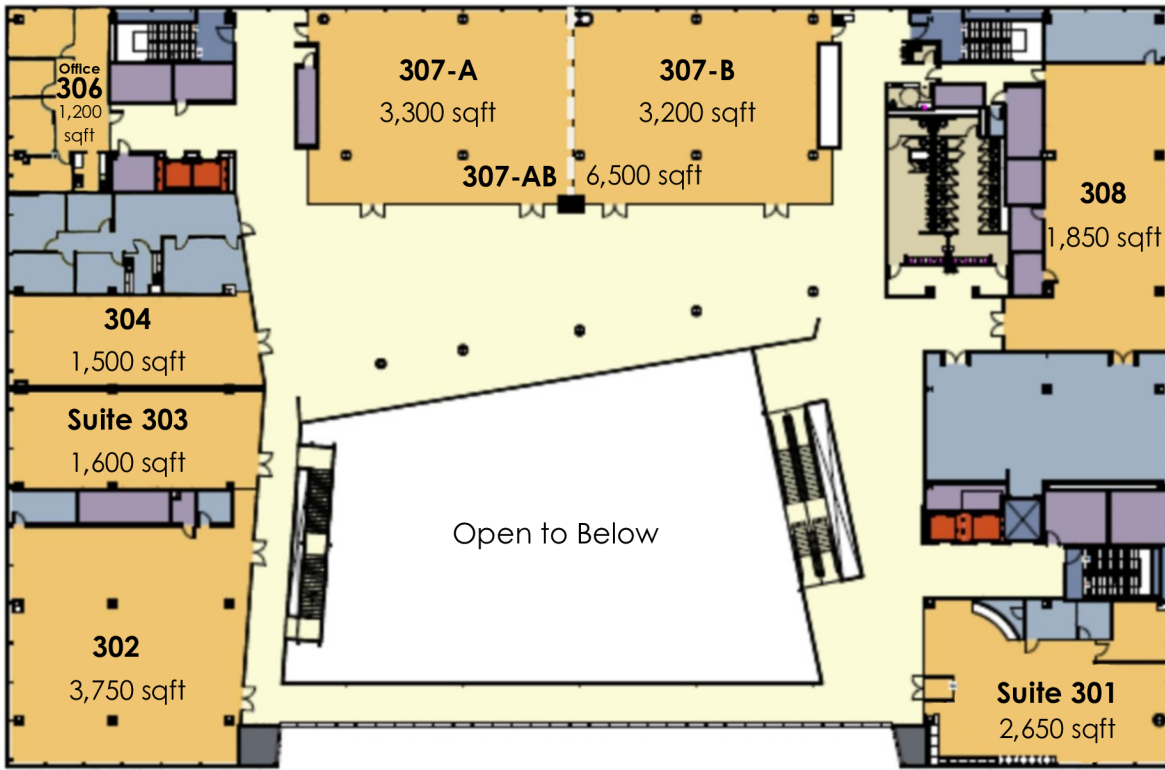

# FLOOR 4

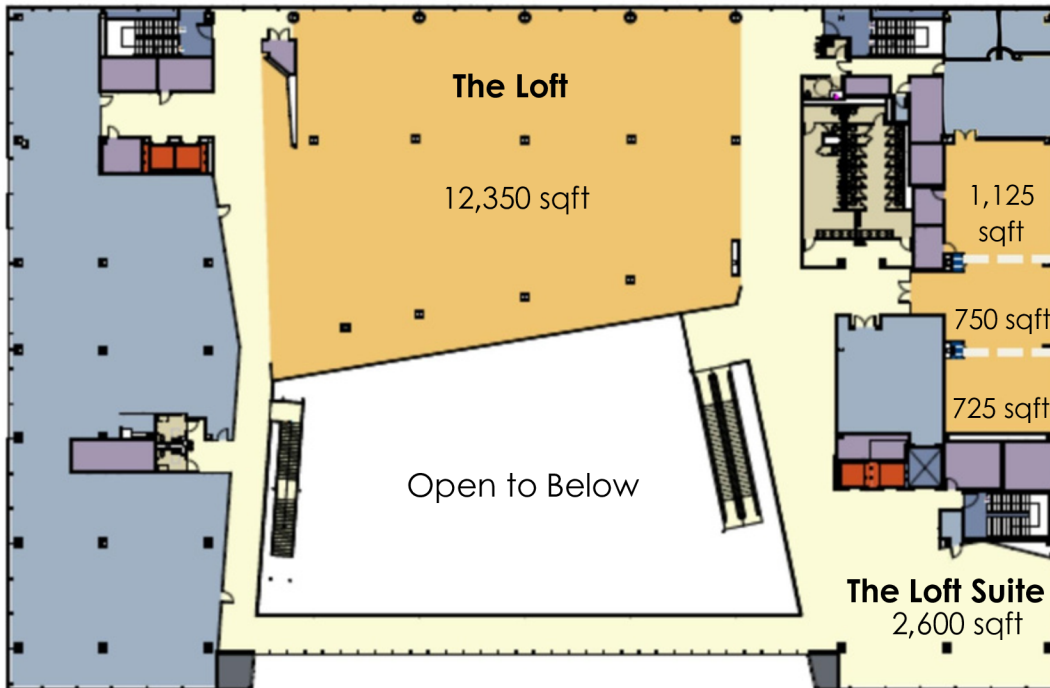

**THE Loft**

## The Loft Conference ABC Combinations

- The Loft- ABC 2,600 sqft
- The Loft - AB 1,875 sqft
- The Loft - BC 1,475 sqft

Common Space 2,600 sqft

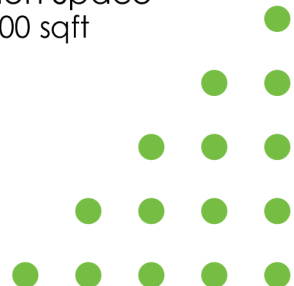

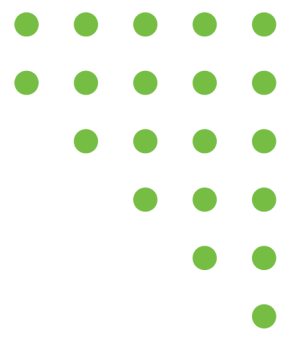

*Cleveland*<sup>®</sup>



# Map and Center Overview



Huntington Convention Center of Cleveland

- Exhibit Halls
- Ballrooms
- Meeting Rooms
- Exhibit Hall Concessions
- Show Offices
- Starbucks
- The UPS Store
- Public Restrooms
- Back of House
- Elevators
- Campus Connections to Hilton and Public Auditorium
- P Huntington Park Garage Tunnel
- 💧 Water Bottle Refill Stations
- 👤 Lactation Station



Cleveland Public Auditorium and Conference Center

# Convention Center Meeting Space Specifications

Exhibit Halls	Location	Space Name	Square Feet	10 x 10 Booths	Floor Load	Overhead Doors	Ceiling Height	Dimensions
	Exhibit Level	Hall ABC	225,000	1,090	350 LBS/SF	4	25' - 40'	547' x 631'
	Exhibit Level	Hall AB	141,500	725	350 LBS/SF	2	25' - 30'	547' x 308'
	Exhibit Level	Hall BC	172,000	885	350 LBS/SF	3	30' - 40'	318' x 631'
	Exhibit Level	Hall A	53,000	245	350 LBS/SF	1	25'	231' x 252'
	Exhibit Level	Hall B	88,500	470	350 LBS/SF	1	30'	317' x 308'
	Exhibit Level	Hall C	83,500	395	350 LBS/SF	2	30' - 40'	317' x 324'
	Loading Dock	Overhead Hall A	-	-	-	-	-	20' x 13'6"
	Loading Dock	Overhead Hall B	-	-	-	-	-	20' x 13'6"
	Loading Dock	Overhead Hall C	-	-	-	-	-	19' x 10'6"
Loading Dock	Overhead Hall C	-	-	-	-	-	19' x 9'6"	
<b>Total</b>			<b>225,000</b>					

Ballrooms	Location	Space Name	Square Feet	Theater	Classroom	Banquet	Ceiling Height	Dimensions
	Ballroom Level	Grand Ballroom ABC	32,200	3,540	2,079	2,520	24' 6"	242' x 134'
	Ballroom Level	Grand Ballroom AB	21,475	2,220	1,452	1,480	24' 6"	161' x 132'
	Ballroom Level	Grand Ballroom BC	21,675	2,220	1,452	1,600	24' 6"	165' x 134'
	Ballroom Level	Grand Ballroom A	10,525	1,088	690	720	24' 6"	78' x 133'
	Ballroom Level	Grand Ballroom B	10,950	1,080	704	720	24' 6"	81' x 133'
	Ballroom Level	Grand Ballroom C	10,725	1,120	736	720	24' 6"	84' x 134'
	Atrium Floor 1	Atrium Ballroom ABCDEF	20,000	1,920	900	1,080	-	-
	Atrium Floor 1	Atrium Ballroom A	4,650	418	288	230	-	-
	Atrium Floor 1	Atrium Ballroom B	1,900	-	-	-	-	-
	Atrium Floor 1	Atrium Ballroom C	3,450	340	209	180	-	-
	Atrium Floor 1	Atrium Ballroom D	4,550	450	288	250	-	-
	Atrium Floor 1	Atrium Ballroom E	1,900	-	-	-	-	-
	Atrium Floor 1	Atrium Ballroom F	3,550	340	228	180	-	-
<b>Total</b>			<b>52,200</b>					

Meeting Rooms	Location	Space Name	Square Feet	Theater	Classroom	Banquet	Ceiling Height	Dimensions
	Concourse Level	1	2,775	352	198	150	13' 2"	68' x 41'
	Concourse Level	2	825	74	39	60	10' 4"	38' x 23'
	Concourse Level	3	2,375	284	157	170	11'	55' x 44'
	Concourse Level	4	2,375	284	157	170	10'	55' x 44'
	Concourse Level	5	2,425	285	159	170	9' 7"	55' x 45'
	Concourse Level	6	2,275	238	134	180	11'	43' x 55'
	Concourse Level	7	2,175	260	146	160	9'	44' x 50'
	Concourse Level	8	1,200	118	60	80	9'	44' x 28'
	Exhibit Hall Level	9	1,550	165	102	120	16'	30' x 53'
	Exhibit Hall Level	10	1,450	159	90	100	15'	51' x 29'
	Exhibit Hall Level	11	1,450	159	90	100	15'	51' x 29'
	Exhibit Hall Level	12	1,325	142	91	110	15'	51' x 27'
	Exhibit Hall Level	13	1,475	150	92	110	15'	51' x 32'
	Exhibit Hall Level	14	1,375	146	82	90	15'	29' x 51'
	Exhibit Hall Level	15	1,525	170	101	100	15'	31' x 51'
	Exhibit Hall Level	16	1,600	185	104	100	15'	28' x 60'
	Exhibit Hall Level	17	800	75	39	40	16'	40' x 21'
	Exhibit Hall Level	18	800	69	35	50	16'	40' x 21'
	Exhibit Hall Level	19	1,500	164	99	90	16'	57' x 27'
	Exhibit Hall Level	20	1,500	168	99	100	16'	57' x 27'
	Exhibit Hall Level	21	1,500	168	99	100	16'	57' x 27'
	Exhibit Hall Level	22	1,500	168	99	100	16'	57' x 27'
	Exhibit Hall Level	23	1,500	159	99	100	16'	57' x 27'
	Exhibit Hall Level	24	1,450	157	99	100	16'	57' x 27'
	Ballroom Level	25 ABC	4,725	440	270	300	20'	87' x 58'
	Ballroom Level	25 AB	2,950	288	187	220	20'	54' x 57'
	Ballroom Level	25 BC	3,275	320	201	240	20'	61' x 57'
	Ballroom Level	25 A	1,450	163	101	100	20'	26' x 57'
	Ballroom Level	25 B	1,500	166	93	120	20'	28' x 57'
	Ballroom Level	25 C	1,775	204	109	130	20'	33' x 57'
	Ballroom Level	26 ABC	6,600	660	378	470	20'	119' x 57'
	Ballroom Level	26 AB	4,425	378	234	340	20'	80' x 57'
	Ballroom Level	26 BC	4,425	374	234	320	20'	80' x 57'
	Ballroom Level	26 A	2,175	251	138	150	20'	40' x 57'
Ballroom Level	26 B	2,250	264	162	160	20'	41' x 57'	
Ballroom Level	26 C	2,175	242	141	150	20'	39' x 57'	

# Convention Center Meeting Space Specifications

Meeting Rooms	Location	Space Name	Square Feet	Theater	Classroom	Banquet	Ceiling Height	Dimensions
	Atrium Floor 2	202	3,700	264	192	170	10'1"	-
	Atrium Floor 2	203	4,375	405	216	250	10'1"	-
	Atrium Floor 2	204	1,000	Office	Office	Office	Office	Office
	Atrium Floor 2	205-AB	8,000	593	312	380	10'5"	-
	Atrium Floor 2	205-A	3,875	375	316	190	10'5"	-
	Atrium Floor 2	205-B	4,125	418	240	240	10'5"	-
	Atrium Floor 2	Exec. 206	1,750	Boardroom	Boardroom	Boardroom	Boardroom	Boardroom
	Atrium Floor 2	207-ABC	1,775	126	90	70	10'3"	-
	Atrium Floor 2	207-AB	1,050	-	-	-	10'3"	-
	Atrium Floor 2	207-BC	1,325	-	-	-	10'3"	-
	Atrium Floor 2	207-A	450	35	24	10	10'3"	-
	Atrium Floor 2	207-B	600	45	24	20	10'3"	-
	Atrium Floor 2	207-C	725	63	40	30	10'3"	-
	Atrium Floor 3	302	3,750	324	210	160	10'4"	-
	Atrium Floor 3	St. Clair 303	1,600	Boardroom	Boardroom	Boardroom	Boardroom	Boardroom
	Atrium Floor 3	304	1,500	143	99	100	10'1"	-
	Atrium Floor 3	306	1,200	Office	Office	Office	Office	Office
	Atrium Floor 3	307-AB	6,500	480	288	270	10'5"	-
	Atrium Floor 3	307-A	3,300	344	222	190	10'5"	-
Atrium Floor 3	307-B	3,200	342	207	170	10'5"	-	
Atrium Floor 3	308	1,850	70	36	60	10'	-	
The Loft	The Loft	12,350	-	-	500	9'8"	-	
The Loft	Conference-ABC	2,600	190	153	140	10'2"	-	
The Loft	Conference-AB	1,875	140	108	100	10'2"	-	
The Loft	Conference-BC	1,475	120	81	80	10'2"	-	
The Loft	Conference-A	1,125	80	72	60	10'2"	-	
The Loft	Conference-B	750	60	36	40	10'2"	-	
The Loft	Conference-C	125	60	36	40	10'2"	-	
<b>Total</b>			<b>102,000</b>					

Suites	Location	Space Name	Square Feet	Theater	Classroom	Banquet	Ceiling Height	Dimensions
	Atrium Floor 2	Suite 201	2,670	-	-	-	10'3"	-
	Atrium Floor 3	Suite 301	2,650	-	-	-	9'9"	-
	The Loft	The Loft Suite	2,600	-	-	-	9'9"	-
<b>Total</b>			<b>7,920</b>					

Common Space	Location	Space Name	Square Feet	Theater	Classroom	Banquet	Ceiling Height	Dimensions
	Atrium Floor 1	Atrium Lobby	8,200	-	-	-	70'	-
	Atrium Floor 2	Common Space	9,100	-	-	-	10'8"	-
	Atrium Floor 3	Common Space	15,750	-	-	-	10'7"	-
	The Loft	Common Space	6,400	-	-	-	9'9"	-
	Concourse Level	Common Space	20,650	-	-	-	9' 6" - 13'	-
	Exhibit Hall Level	Common Space	20,000	-	-	-	15' x 6"	-
	Lakeside Lobby	Common Space	4,170	-	-	-	-	-
	Ballroom Level	Common Space	16,200	-	-	-	24' x 5"	-
<b>Total</b>			<b>100,470</b>					

Outdoor Space	Location	Space Name	Square Feet	Theater	Classroom	Banquet	Ceiling Height	Dimensions
	East Terrace	East Terrace	20,000	-	-	-	-	-
	West Terrace	West Terrace	11,200	-	-	-	-	-
<b>Total</b>			<b>31,200</b>					