

# BRING YOUR EVENTS TO LIFE

Host your event, conference or meeting with us at Vaillant Live!



# WELCOME TO VAILLANT LIVE

**Welcome to Vaillant Live, the ultimate destination for exceptional live events, conferences, and celebrations.**

Located at the heart of the city, we offer a versatile and dynamic space that adapts for every need. Whether you're hosting a 2,000 plus conference, an intimate gathering, or an exhibition, all are available to hire for an evening, a day, a weekend or even longer!

**It's our venue, your vision.**

There's no need to worry about technical set-ups. All our rooms come fully equipped with the latest audiovisual technology, which is included in your hire cost.

From microphones and projectors, to lighting and sound, we've got you covered.



**DAY TO NIGHT AND BEYOND,  
COME SEE OUR SPACES!**

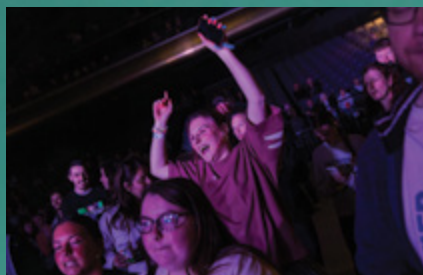

# THE AUDITORIUM

**This is a stunning, spacious auditorium, perfect for large conferences, keynote speakers, product launches, and performances.**

With state-of-the-art audiovisual technology, the auditorium can accommodate up to 2,247 attendees, ensuring your event is executed flawlessly. With a load-in access bays door, and two self-levelling arctic loading bays, you can drive straight into the auditorium and bring your event to life.

## CAPACITY CHART

Floor space	1,600 sqm
-------------	-----------

## THEATRE CAPACITY

Flat Stalls	612
Lower Tier Seats	608
Level 2 Balcony (Premium)	245
Upper Tier Seats	782

**Stage size:** Standard size 18m x 11m (60ft x 36ft) at heights ranging from 1.24m - 1.8m (4ft - 6ft)

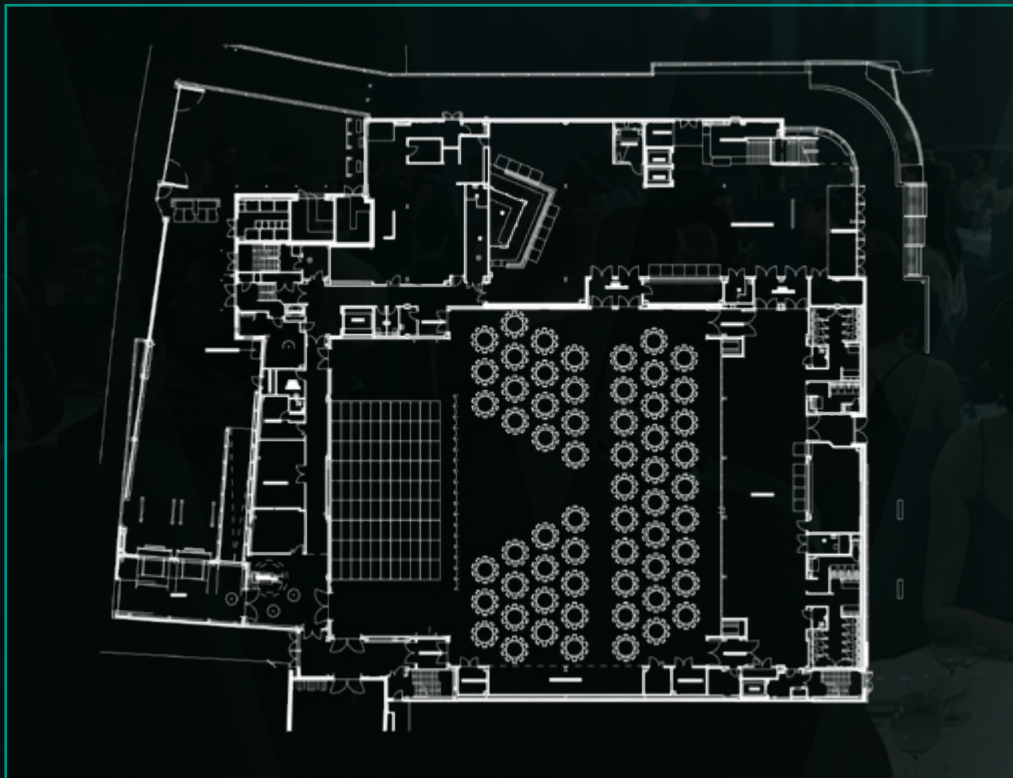

# THE AUDITORIUM

The main auditorium is an extremely flexible space with various staging and seating configurations, complete with an in-house flown speaker array and full high end audio system package.

The sound system is a state-of-the-art JBL professional system designed, tuned and tested by the leading live events PA manufacturer JBL themselves.

The space has been designed with the most effective acoustic treatment to ensure every word and beat is heard clearly and the room remains as acoustically flat as possible, to limit unwanted audio reflections in the space. Various in-house microphone packages can be offered from wireless handheld microphones, lectures, clip-on wireless belt packs and drum mic kits.

The space is complete with modern in-house lighting fixtures for full stage coverage and a multi-colour LED wash. This also includes two follow spots and follow spot positions.

The main space has a 100,000 lumens projector capable of 4K definition to ensure every detail of video can be seen on the big screen. The auditorium is equipped with an overhead gantry with lots of positions for hanging and rigging.

There's no short supply of power with lots of heavy main connections around the auditorium floor and gantry. The in-house technical department can provide power to suit small and large events. Show relay cameras can be fed to the dressing rooms, side of stage and even FOH areas. This is possible because of our two UHD show feed cameras that can also adjust to infrared vision during blackouts.

The design of the building ensures a smooth load in straight through one of our 4 loading bays directly connected to the main auditorium.

There is also easy access to dressing rooms, production/promotor offices, a dedicated crew catering kitchen, and crew eating areas. These are all accessible via a large goods elevator. The auditorium floor is fitted with dip traps for cable runs.



# THE VAILLANT LIVE LOWER FOYER

**Imagine a space that sets the stage for your event, right from the start. The Foyer at Vaillant Live offers high ceilings and abundant natural daylight, creating an inviting, open atmosphere that will leave a lasting impression on your guests.**

With 8,000 square feet of flexible space, this area is designed to enhance the flow of your event, making it as seamless as possible.

Whether you're hosting a networking event, showcasing exhibitors, or providing a comfortable catering area, the Foyer and Concourse give you the ability to zone the space to suit your needs.

The versatility of this venue ensures that every aspect of your event is catered to without compromise. What's more, exclusive use means just that. You'll have complete control over the layout and flow of the space, allowing you to create a tailored experience that enhances your guests' journey from start to finish.

# THE LOWER CONCOURSE

**The Lower Concourse at Vaillant Live offers the perfect blend of functionality and flexibility for your event.**

With its dedicated food and beverage unit, it's an ideal meet and eat space. Whether you're hosting a plenary session in our auditorium and need a seamless catering area, or you're looking for a versatile space for an additional breakout session, the Lower Concourse has you covered.

The flexibility of the Lower Concourse means you can transform it to suit any aspect of your event, whether it's a catered lunch, a networking hub, or a quiet area for focused sessions.



# VAILLANT LIVE LOUNGE

**Our premium Live Lounge is a hub of excitement and luxury during live shows, but it also offers a versatile space that can be easily adapted to suit your event.**

With the power to split into four distinct areas, it's perfect for hosting workshops, networking events, or smaller meetings, ensuring a dynamic and engaging environment for every occasion.

We can keep the relaxed soft furniture for a more collaborative and innovative meeting, or it can be a blank space to mould into the perfect space for your dinner dance or seminar.

## CAPACITY CHART

Floor space	366 sqm
-------------	---------

## THEATRE CAPACITY

Theatre	400
---------	-----

Dinner	196
--------	-----

Dividers can split the room into 4

GALA DINNER FLOOR PLAN



THEATRE FLOOR PLAN



# TRANSFORM YOUR EVENT WITH THE LIVE LOUNGE

**The Vaillant Live Lounge is the perfect space for those looking to create a dynamic, flexible environment for their event.**

Whether you're looking to host a theatre-style session for up to 400 guests, or need a more intimate setting, this versatile space can be adapted to your exact needs. Don't be intimidated by the size of our auditorium; the Live Lounge is designed to work seamlessly as its own standalone venue, offering the perfect balance of size and intimacy.

This space is perfect for breakout sessions and can easily be split into 3 or 4 separate sections, each with its own built-in AV system, ensuring top-tier sound and visual quality.

What's more, with sound-lock walls, you can host simultaneous sessions without worrying about sound bleed, making it ideal for multi-session events that require total focus and concentration.

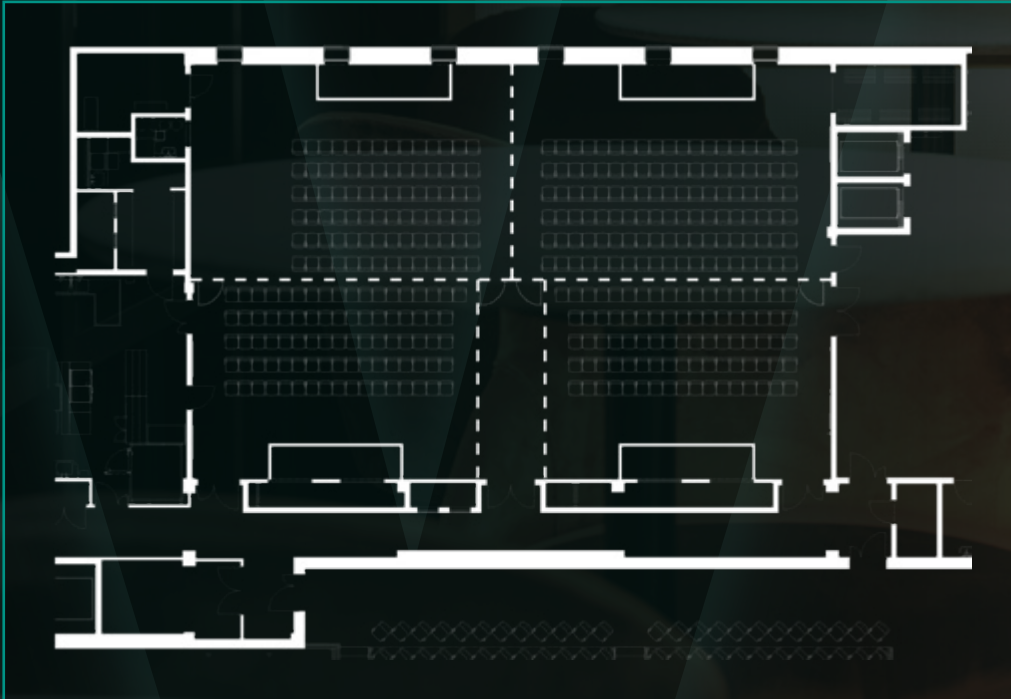

# LEVEL 2 CONCOURSE & FOYER

**This stunning space offers high ceilings and an abundance of natural daylight with floor to ceiling windows, creating a bright, airy, and inviting atmosphere for any occasion.**

With plug sockets running across the length of the space, you can tailor this area to suit your event's unique needs - whether it's a networking hub, catering area, informal seating, or exhibition stands.

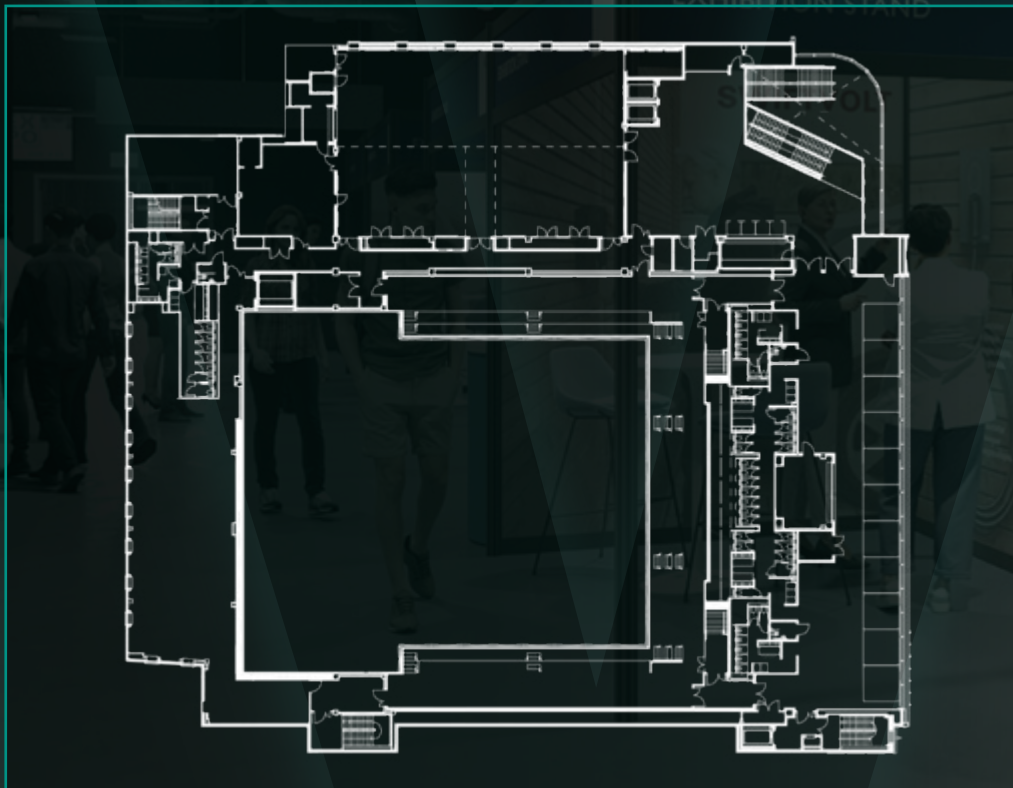

# MEETING ROOMS

**Perfect for intimate gatherings and focused discussions, our four small meeting rooms offer flexible spaces tailored to your needs.**

Ranging in size from 19 to 52 theatre-style seats, these rooms are ideal for workshops, team meetings, training sessions, or strategy briefings.

Each room is designed to foster collaboration and productivity, with modern amenities and a comfortable environment that ensures your team can focus and engage without distraction. Whether you're hosting a small board meeting or an in-depth presentation, our meeting rooms provide the privacy and flexibility you need.

Book one of these spaces today for a seamless, professional experience that's perfectly suited to your event's scale.

Meeting Room 1	40 sqm	52
Meeting Room 2	21 sqm	19
Meeting Room 3	38 sqm	48
Meeting Room 4	32 sqm	43



# OFFICE SPACES

**With the convenience of being close to the main event spaces, you can easily access everything you need while maintaining a productive and organised workspace.**

Whether you're overseeing operations, managing talent, or handling technical set-ups, our production offices offer the privacy and functionality you require.

Within this, we also have a crew catering room and kitchen for any additional production team you may need. We have it all in our backstage area!

## CAPACITY CHART

Space	Level	Capacity in Theatre	Cabaret	Dinner	Classroom	Standing Reception	Boardroom	U-Shape
Auditorium	N/A	2,247	450	600	N/A	N/A	N/A	N/A
Lower Concourse	Ground	250	N/A	N/A	100	400	N/A	N/A
Entrance Foyer	Ground	N/A	N/A	N/A	N/A	500	N/A	N/A
Meeting Room 1	Level 1	52	18	N/A	28	N/A	18	12
Meeting Room 2	Level 1	14	6	N/A	8	N/A	8	4
Meeting Room 3	Level 1	48	18	N/A	24	N/A	15	10
Meeting Room 4	Level 1	43	18	N/A	20	N/A	15	10
Green Room	Level 1	20	12	12	12	12	12	8
Live Lounge	Level 2	400	126	196	124	400	N/A	75
Live Lounge Section A	Level 2	86	35	40	30	80	30	30
Live Lounge Section B	Level 2	114	42	60	48	100	40	40
Live Lounge Section C	Level 2	84	35	50	28	100	30	30
Live Lounge Section D	Level 2	86	35	50	30	100	30	35
Level 2 Foyer	Level 2	N/A	N/A	N/A	N/A	80	N/A	N/A
Level 2 Concourse	Level 2	100	N/A	N/A	155*Relaxed furniture	400	N/A	N/A

# CULINARY EXPERTISE

**We understand that food and beverages play a crucial role in the success of any conference, event, or private event. That's why our Head Chef and his expert on-site team are dedicated to delivering exceptional culinary experiences that perfectly complement your occasion.**

We offer a diverse range of menus, thoughtfully tailored to suit a variety of tastes, dietary needs, and budgets. From energising breakfasts and working lunches to elegant sit-down banquets, we ensure that every aspect of your event is catered for with care and attention to detail.

We take great pride in sourcing the finest local ingredients, and we celebrate the best of regional produce to create mouthwatering dishes that will delight your guests.

To ensure your experience is nothing short of perfect, we encourage you to refine the menu and ensure it meets your expectations. We'll also make sure your menu is supported by elegant cutlery, crockery, and glassware, enhancing the overall dining experience.

Let us handle the food and beverage so you can focus on what matters most; making your event unforgettable.

# FOOD FOR THOUGHT

**Our in-house team of passionate chefs have created a fantastic selection of menus for a range of event styles.**

We offer three banquet packages; Silver, Gold and Platinum, and would also be delighted to develop bespoke food and beverage menus.

Here is one of our exciting new menus. We take pride in our menus and test them regularly with consumers and event goers.

It's important to note that although this is an example, we would be delighted to develop bespoke food and beverage menus for your special event.

## GOLD PACKAGE

◇◇◇◇◇◇◇◇

### STARTER

*Platters of house baked bread with butter*

Ham hock and pickled carrot terrine,  
celeriac remoulade, piccalilli (mwog, mwod)

### MAIN COURSE

*Presented with seasonal vegetables*

18 hour slow cooked short rib beef,  
braised ox cheek croquette, dripping  
braised carrot, fondant potato,  
red wine jus (mwod)

**Vegetarian | Vegan** (by pre-order only)

Cauliflower steak, sage infused fondant  
potato, butternut squash puree, lemon  
and caper dressing (v, vgn, mwod, mwog)

### DESSERT

Sticky toffee pudding, crème  
anglaise, gingerbread cream (mwog)

Freshly filtered coffee or Yorkshire  
tea served with milk, and dinner mints,  
served to the table

# VENUE SPECS

## AUDITORIUM LIGHTING SYSTEM

- 2x Element 2 Control Desk with 6 144 Outputs.
- House lighting rig consists of ColorSource spots and pars.

### (Permanent) LX1 Main front lighting

- » 10x ColorSource Spot (With 14° lens tube and Smooth Wash Diffuser).

### (Permanent) LX2

- » 4x ColorSource Spot (with 19° lens tube and Smooth Wash Diffuser).
- » 6x ColorSource Spot (with 36° lens tube and Smooth Wash Diffuser).
- » 12x ColorSource PAR (with 040 & CSPar 35° Narrow Round Diffuser).

### (Temporary, requires pre-rig)

#### LX3 Back lighting

- » 6x ColorSource PAR Deep Blue (With 040 & CSPar 45° Medium Round Diffuser).
- » 6x ColorSource PAR Deep Blue (with 040 & CSPar 35° Narrow Round Diffuser).

### Roaming fixtures for up lights and second space

- » 12x ColorSource Cyc.
- » 12x ColorSource PAR (with 040 & CSPar 25° Very Narrow Round Diffuser).

### Follow spots

- » 2x 1015M Cyrano 2500W HR HMI Follow spot with Mechanical Dimmer and Electronic Ballast.

- Lighting plot available upon request.
- House lights can be manual or desk controlled.
- DMX or sACN connections for control.

## AUDITORIUM VIDEO SYSTEM

- Panasonic PT-RZ970 10,000 lumen projector HDMI input.
- Tab-tensioned electric screen, 700cm x 437cm (16:10).
- 2x PTZ Show relay video cameras (HD and IR).
- 4x portable 43" Digital video displays.
- 2x portable 86" 4K UHO Large Format Displays.

## MICROPHONES

- 6x Sennheiser wireless EW 300 64-865-5-G BW handhelds.
- 2x Sennheiser wireless EW 300 G4-ME2-RC-GBW Lapel microphones.
- Custom mic rack with 2x Sennheiser A1031U Remote Antenna and Stand and EW-0-ASA (Q-R-S) active Antenna Splitters.
- 8x Shure SMS8LCE.
- 8x Shure SMS7LCE.
- 1x Shure DMK57-52 Orum Kit Mic System.

# LIVE LOUNGE AV INCLUSIONS

**This space has been designed to be a great multi-purpose area, with configurable audio-visual technology that enables more capabilities for conferences and live events.**

As the space can be split into quarters, each quarter consists of an Ultra High-Definition projector and large fold away projection screens. Video can be connected via common standard computer video output cables or wirelessly connected with our Clickshare system.

Each space has its own Clickshare dongles for wirelessly connecting videos. This includes video and audio from phones, tablets and laptops. The system also has the functionality to split screen multiple video sources and Clickshare dongles.

Each space is also covered with super-fast public Wi-Fi and public network ports capable of live streaming and video calling. The sound system in each space has been designed for high quality audio, also including clear and accessible hearing induction loops. Portable lecterns and podiums are fitted with gooseneck presenter microphones, and our portable handheld microphone packages ensure that speech is clear and intelligible.

These spaces undivided make one whole area that now opens up great versatility for a big space. All projectors and audio systems can be used as one or customised to more specific event configurations.

The space is also installed with lighting hanging positions and one tone rigging points. Stage lighting for specific events can be provided in this space along with a professional live events PA system and small stage area. The house lighting can also be controlled, and further additional screens are also available.

Other conference and event rooms include large format display screens, which also have Click Share systems, tables and chairs. We can also offer a total of six portable display screens, to ensure that you have everything you need in your desired space.



# EXTRA FUNCTIONALITY

**Audio and video can be routed between both the main space and the second space, including show relay feeds and comms packs. Backstage calling to the dressing rooms can be done from either space and also any backstage room.**

Digital FOH signage can also display show feeds, such as stage relay cameras or other show video inputs. This means any static or video content that you wish to present and share can be displayed on the big auditorium screens and also around the foyer screens.

We have a tour bus power facility, 2x self-levelling unloading docking bays and a forklift on-site. We also have exterior building lighting that includes the VIP entrance festoon lighting. Furthermore, this can be configured with colours and effects to suit.

Our dedicated in-house technical department are on hand to answer any technical queries and to guarantee the smooth running of technical requirements.

All front of house kiosks, merchandise and customer service desks have a hearing induction loop. Plus Vaillant Live has a 'changing places' facility and 7 A/C toilets.

# WELL CONNECTED

**By road, rail or air, and car - we're easy and convenient to get to.**

Located on the south-western fringe of Derby city centre, the venue is a very short walk away from a major bus stop hub and taxi ranks on Victoria Street.

**Road:** 20 minutes from the M1, connecting Edinburgh and London.

**Rail:** A short walk from Derby station - 36 direct London trains every day, taking less than 90 minutes.

**Air:** Less than 30 minutes from East Midlands Airport, with destinations worldwide.



**Vaillant**

**LIVE**



**Derby  
Bus Station**



**Derby  
Train Station**



**To East Midlands  
Airport 15 miles away**

# GET IN TOUCH

We would love to find out more about your event, conference, party or celebration. To tell us more and to find out more, please get in touch with our sales team on any of the contact details shown.

Central email address for the venue:  
**[conferenceevents@vaillantlive.co.uk](mailto:conferenceevents@vaillantlive.co.uk)**

## **Faye Nixon**

Head of Sales, Marketing & Guest Experience

 07774 690 554

 [faye.nixon@eu.asmglobal.com](mailto:faye.nixon@eu.asmglobal.com)

## **Felicity Kemp**

Premium Sales, Conferencing & Events Manager

 07741 893 769

 [felicity.kemp@eu.asmglobal.com](mailto:felicity.kemp@eu.asmglobal.com)