



HUNTINGTON  
PLACE

MEET YOU IN  
DETROIT



HUNTINGTON  
PLACE



ITS THE  
PEOPLE THAT  
MAKE THE  
PLACE

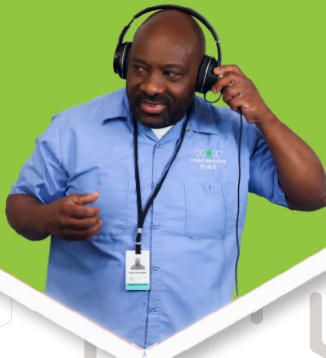



# WELCOME TO HUNTINGTON PLACE DETROIT



Perfectly positioned along the Detroit Riverfront, Huntington Place offers a one-of-a-kind setting where the energy of the city meets the serenity of the water. Step outside our doors and you'll find yourself surrounded by newly developed parks, attractions, and scenic pathways that invite your guests to explore and connect in a truly inspiring environment.

Located in the heart of downtown Detroit, Huntington Place is just steps away from vibrant restaurants, local shops, world-class hotels, and the spirit of a city that's always on the move. Whether you're hosting a major convention, a gala, or an intimate meeting, you'll find everything—and everyone—you need right here.



HUNTINGTON  
PLACE

# HUNTINGTON PLACE DETROIT'S MOST INSPIRING VENUE.

Step inside Huntington Place and be greeted by our three-story glass atrium, a breathtaking architectural centerpiece that floods the space with natural light and frames spectacular views of the Detroit Riverfront. This awe-inspiring setting is more than just an entrance—it's a canvas for creativity, elegance, and unforgettable moments. Whether hosting a grand reception, a high-profile gala, or an intimate networking event, the atrium's open design and striking transparency create an atmosphere that instantly captivates.



## UNPARALLELED AMENITIES

Huntington Place captures the spirit of Detroit with stunning spaces and unmatched versatility—an ideal destination for moments that matter.

With 723,000 square feet of exhibit space, 200,000 square feet of flexible meeting rooms, and a 40,000-square-foot Grand Riverview Ballroom featuring a fully customizable lighting system, Huntington Place offers an unparalleled setting for tradeshows, public shows, and exhibitions, as well as galas, conferences, and intimate gatherings.

Complemented by the glass-enclosed pre-function area, open-air terrace, and Huntington Place Square — a 45,000-square-foot outdoor space perfect for receptions, live entertainment, or food truck events.

Every corner of Huntington Place is designed to inspire, delight, and create unforgettable memories in the heart of Detroit.





# LOOKING AHEAD THE FUTURE OF HUNTINGTON PLACE

Huntington Place is not just a premier destination today but a vision actively taking shape for the future — continually evolving to elevate experiences for guests, exhibitors, and partners.

Rising alongside the convention center, the new JW Marriott hotel is currently under construction and set to **open in January 2027**. Directly connected to Huntington Place via an enclosed skybridge, the 600-room luxury property will feature a full-service spa, sophisticated meeting spaces, and the acclaimed Andiamo Italian Chophouse. Once complete, the JW Marriott and Huntington Place will create a seamless event ecosystem — combining world-class facilities, breathtaking spaces, cutting-edge technology, exceptional dining, and effortless connectivity to deliver an unforgettable Detroit experience.

# CULINARY EXCELLENCE CUTTING EDGE CONVENIENCE

At Huntington Place, dining is a crafted experience led by Sodexo Live! emphasizing creativity, local sourcing, and sustainable practices to showcase the very best of Detroit and Michigan.

From lavish gala dinners and receptions to quick bites in our expansive food court or premium offerings at Cork & Grind, guests enjoy memorable flavors and impeccable service.

Adding to this innovation, the Motor City Mart — a 24/7, fully automated, Just Walk Out store — redefines convenience, allowing visitors to shop effortlessly between sessions.

Every detail, from gourmet meals to cutting-edge guest experiences, reflects the forward-thinking spirit of Detroit and enhances every event.

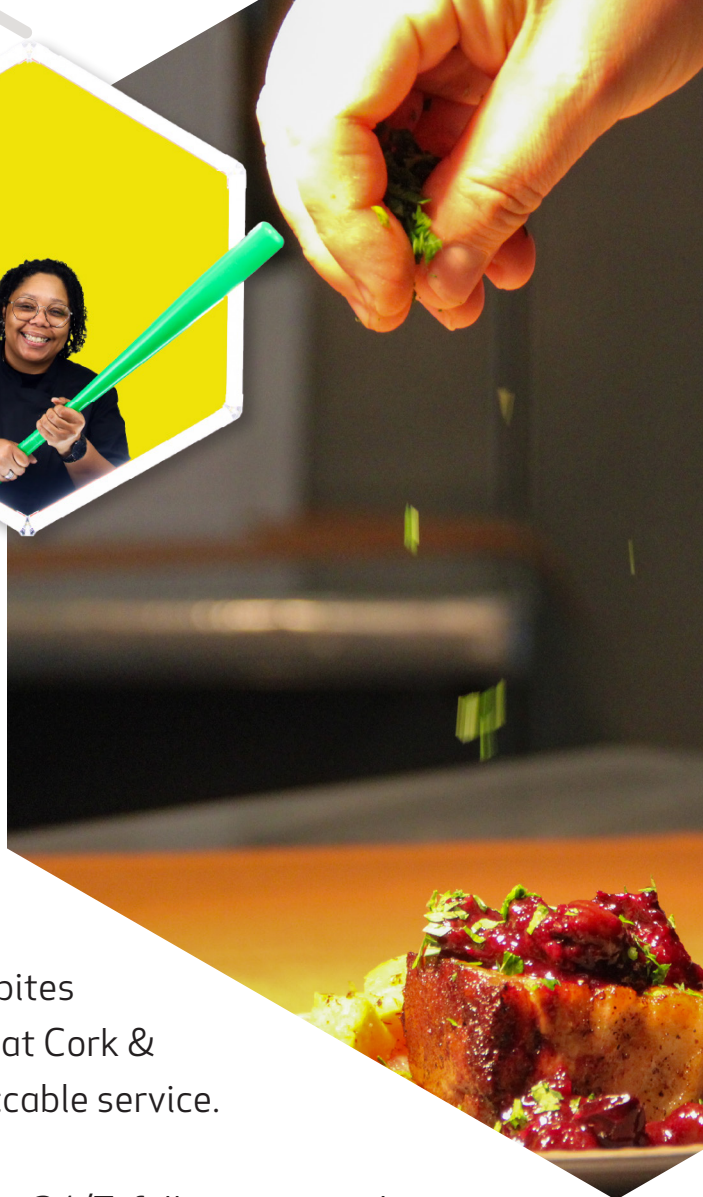

# SUSTAINABILITY AT THE HEART OF HUNTINGTON PLACE

Sustainability is central to Huntington Place, a LEED-certified venue committed to greener, responsible event experiences.

Our rooftop garden and honeybee hives reduce energy consumption and support local ecosystems, while comprehensive composting, recycling, and strong partnerships divert tons of waste from landfills annually.

Through our Green Events Program, clients can host eco-conscious gatherings, and our passionate Green Team Committee ensures that environmental responsibility is integrated into daily operations and large-scale conventions alike.

At Huntington Place, every event is designed not only to make memories but also to make a positive impact on the planet.





# THE HEART OF HUNTINGTON PLACE OUR PEOPLE

At the core of Huntington Place is our team — the heart and soul behind every successful event.

From event coordinators and culinary artists to operations and guest services, our staff goes beyond logistics to craft memorable experiences, anticipate needs, and ensure every guest feels valued.

Their dedication, hospitality, and care reflect the energy and resilience of Detroit itself, making Huntington Place not just a world-class venue but a place where people, community, and experiences come together to create unforgettable moments.



# CUSTOMER REVIEWS

"I truly appreciate everyone's **flexibility and responsiveness**. Thanks to your efforts, everything came together smoothly, and **on-site support was exceptional.**"

- MEMA

"I'm grateful for the collaboration and **hope we get to do it again soon!**"

- Sacred Heart Major Seminary

**"The food was also absolutely delicious** - we were all very happy!"

- Sense Media

**"I kept joking all week saying that something was going to go wrong because nothing went wrong!** You and your teams played a huge role in that and I just cannot thank you enough for everything."

- Welcoming America

"From start to finish, Huntington Place and Sodexo Live! absolutely blew Las Vegas out of the water... **You didn't just meet expectations — You exceeded them at every turn.**"

- Siemens Digital Industries Software





4.5 STAR  
RATING

7,386 google reviews



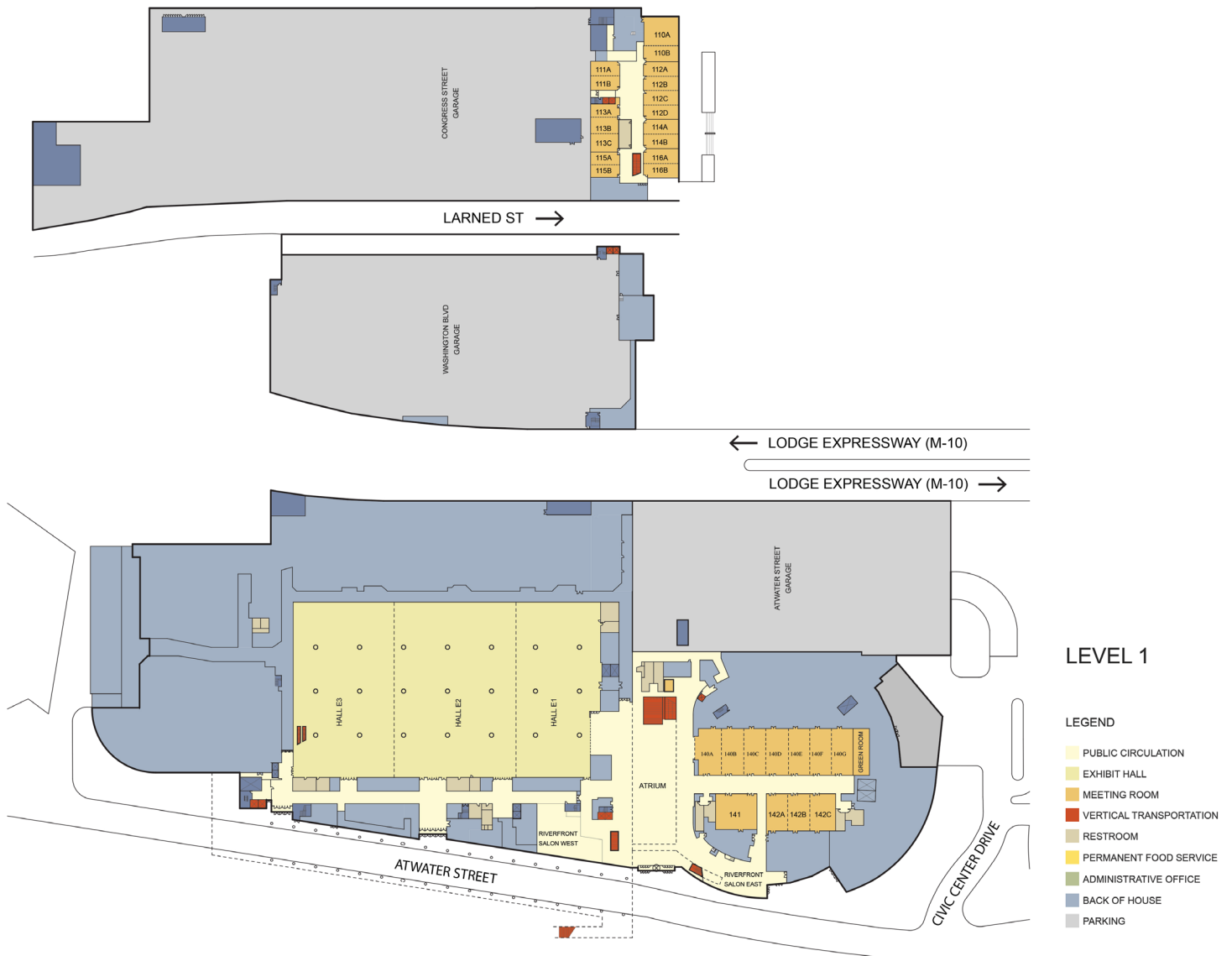

# FLOOR PLAN LEVEL 1

Meeting rooms, exhibit hall E, and over 30,000 square feet of flex space.

# CAPACITY LEVEL 1

ROOM NUMBER	SQUARE FEET	THEATER	BANQUET 10 per 6'	CLASSROOM 4 per 8' x 18"	DIMENSIONS (W x D)	HEIGHT
HALL E1	27,000					18'8"
HALL E2	40,000					18'8"
HALL E3	32,000					18'8"
HALL E (COMBINED)	99,465	Max Capacity 6750			235 x 419	18'8"
110 A	1,835	140	80	80	39 x 47	10'
110 B	903	72	30	44	21 x 43	10'
110 A/B	2,738	252	150	128		10'
111 A	665	50	20	16	18 x 33	12'
111 B	589	40	20	16	19 x 31	12'
111 A/B	1,254	80	60	60		12'
112 A - C	817	54	30	24	19 x 43	10'
112 D	893	54	30	24	19 x 43	10'
112 A/B/C/D	3,344	306	180	160	76 x 43	10'
113 A	510	28	20	20	14 x 35	12'
113 B	950	77	40	36	25 x 36	12'
113 C	816	60	40	32	24 x 34	12'
113 A/B/C	2,276	180	100	96		12'
114 A	774	63	30	24	18 x 43	12'
114 B	893	63	30	24	19 x 46	12'
114 A/B	1,667	144	90	72		12'
115 A	608	35	20	16	15 x 37	12'
115 B	646	49	20	16	19 x 34	12'
115 A/B	1,254	98	60	48		12'
116 A	817	60	30	48	19 x 43	12'
116 B	893	63	40	28	18 x 43	12'
116 A/B	1,710	144	90	92		12'
140 A	2,114	196	80	108	36 x 59	16'9"
140 B - G	1,740	168	80	108	30 x 59	16'9"
140 A-G	12,554	1,495	760	672	216 x 59	15'10"
141	2,536	280	120	120	56 x 45	16'11"
142 A	1,281	120	60	72	28 x 46	16'11"
142 B	1,350	120	60	72	30 x 45	16'11"
142 C	1,567	140	60	72	34 x 46	16'11"
142 A/B/C	4,198	440	240	240	92 x 46	16'11"/15'11"
Atwater Lounge (West)	4,200		230		Irregular	7'11"
Atwater Lounge (East)	4000				Irregular	17'11"
River Atrium (marble floor)	11,500 (approx.)	1,080	600	500	63 x 186	80' (marble floor to glass ceiling)

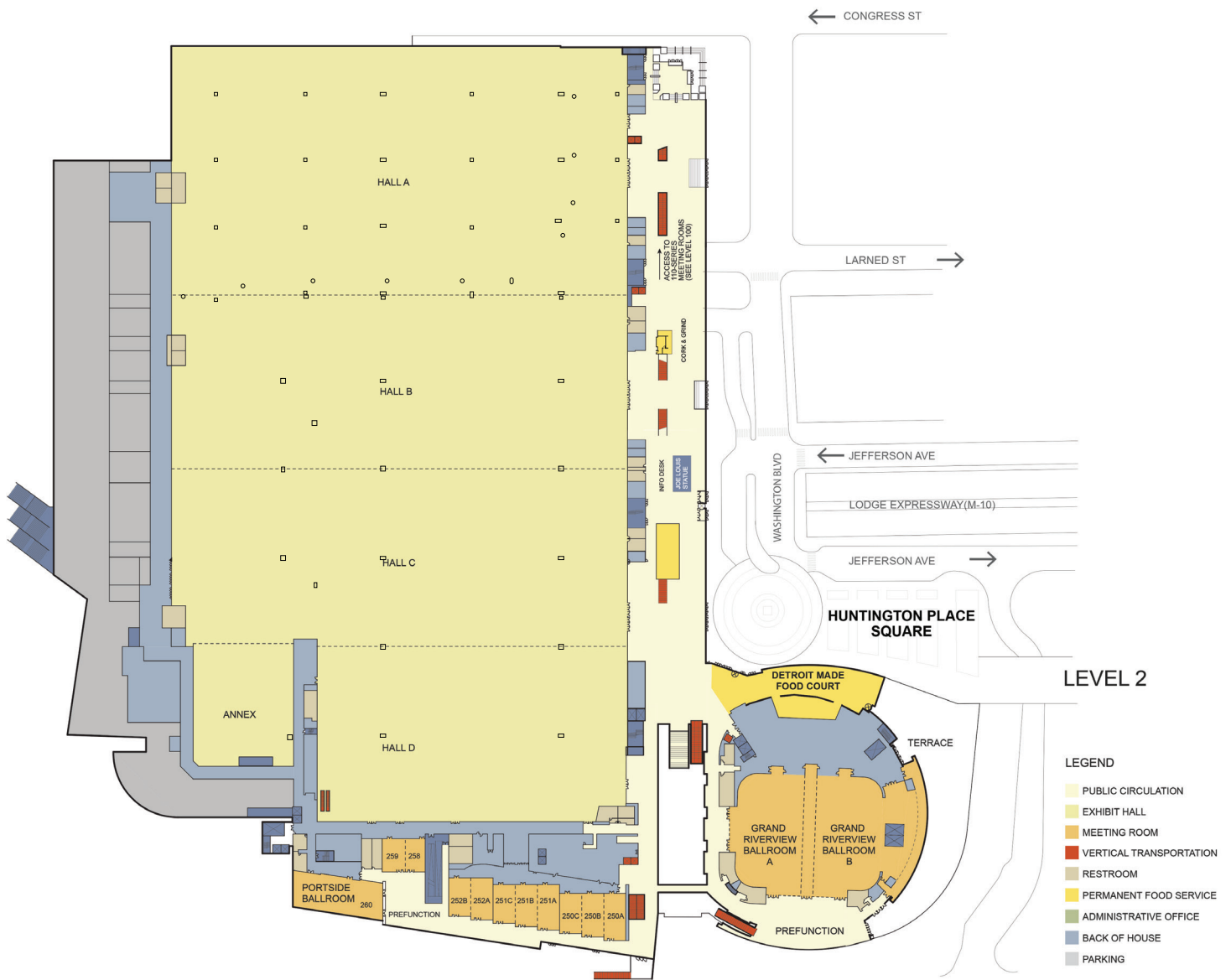

# FLOOR PLAN LEVEL 2

623,000 plus square feet of contiguous exhibit hall space, concourse, ballroom and more.

# CAPACITY LEVEL 2

ROOM NUMBER	SQUARE FEET	THEATER	BANQUET 10 per 6'	CLASSROOM 4 per 8' x 18"	DIMENSIONS (W x D)	HEIGHT
HALL A	208,845	exhibit space only			339 x 615	30'
HALL B	142,065	3,150	3,150	3,150	231 x 615	30'
HALL C	147,600	4,050	4,050	4,050	240 x 615	30'
HALL C ANNEX	25,972	exhibit space only			172 x 151	30'
HALL D	99,540	4,350	4,350	4,350	237 x 420	30'
250 A	1,891	168	80	108	31 x 61	15'
250 B	1,653	144	80	96	29 x 57	15'
250 C	1,508	132	60	84	29 x 52	15'
250 A/B/C	5,052	470	280	264		14'6"
251 A	1,829	156	80	104	31 x 59	15'
251 B	1,635	132	60	92	30 x 54	15'
251 C	1,400	120	60	72	28 x 50	15'
251 A/B/C	4,864	440	240	264		14'6"
252 A	1,674	132	60	92	31 x 54	15'
252 B	1,450	120	60	80	29 x 50	15'
252 A/B	3,124	276	150	168		14'6"
258	1,242	120	60	72	27 x 46	14' 5"
259	1,392	120	88	60	29 x 48	14' 5"
258/259	2,634	234	120	128		13'11"
260 Portside Ballroom	5,600	500	300	288	47 x 120	11'8"
Grand Ballroom A	14,000	1,523	840	800	154 x 91	38'
Grand Ballroom B	22,000	1,626	1,000	880	154 x 130	38'
Grand Ballroom A/B	40,000	3,769	2,170	2,400		38'
Detroit Made Food Court	10,415					
Huntington Place Square [exterior]	24,000 (approx.)					
Ballroom Terrace	20,000 (approx.)		0			

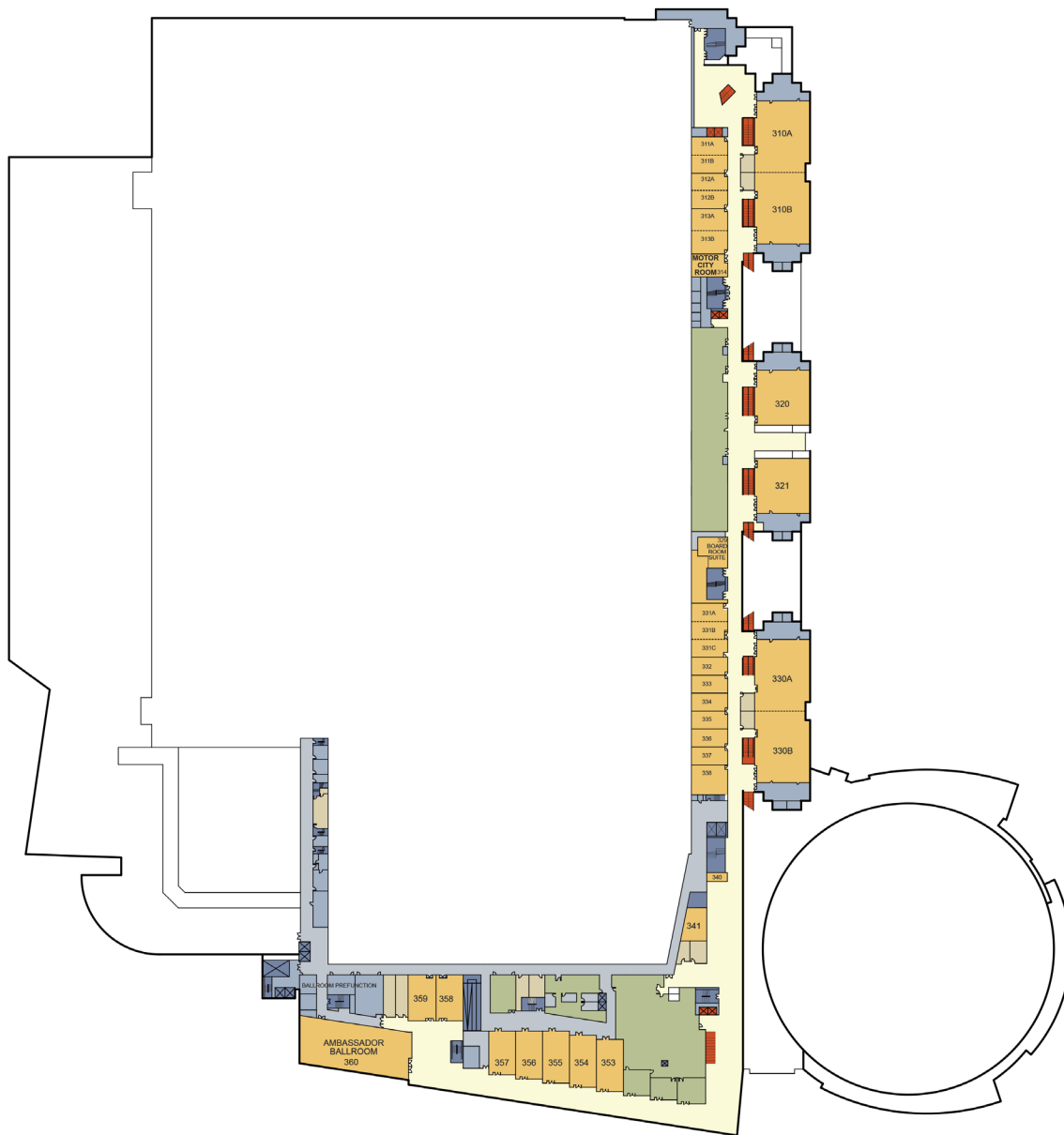

**LEVEL 3**

**LEGEND**

- PUBLIC CIRCULATION
- EXHIBIT HALL
- MEETING ROOM
- VERTICAL TRANSPORTATION
- RESTROOM
- PERMANENT FOOD SERVICE
- ADMINISTRATIVE OFFICE
- SERVICE AREA
- PARKING

# FLOOR PLAN LEVEL 3

Meeting rooms, and suites.

# CAPACITY LEVEL 3

ROOM NUMBER	SQUARE FEET	THEATER	BANQUET 10 per 6'	CLASSROOM 4 per 8' x 18"	DIMENSIONS (W x D)	HEIGHT
310 A - B	4,450	408	240	240	80 x 56	15'
310 A/B	8,900	800	480	448		
311 A	725	52	30	32	20 x 37	12'
311 B	700	48	30	32	19 x 37	12'
311 A/B	1,425	96	60	64		
312 A - B	700	56	30	32	19 x 37	12'
312 A/B	1,400	108	60	64		
313 A - B	890	70	40	32	24 x 37	12'
313 A/B	1,780	140	80	64		
314 Motor City Room	750 (approx.)	conference table for 12			21 x 34	
320 - 321	3,400	312	200	192	60 x 56	15'
320/321 Alcove	1,100 (approx.)	—		—	21 x 53	15'
329 Boardroom	600 (approx.)	conference table for 12			17 x 33	
329 Boardroom Office	1,100 (approx.)				18 x 61	
329 Boardroom & Office	1,700 (approx.)	—	—	—	—	
330 A - B	4,450	408	240	240	80 x 56	15'
330 A/B	8,900	800	480	448		
331 A (can access Boardroom Office)	627	42	20	36	19 x 33	10'9"
331 B	660	48	20	36	20 x 33	10'9"
331 C	720	56	20	32	19 x 38	10'9"
331 A/B/C	2,007	182	100	96		10'9"
332	760	56	20	32	19 x 39	10'9"
333	760	50	20	28	19 x 39	
334	760	56	20	32	19 x 39	
335	760	56	20	32	19 x 39	
336	720	56	20	28	18 x 39	10'9"
337	750	56	20	32	20 x 37	10'9"
338	1,290	98	60	60	33 x 39	10'9"
341 (best used as storage)	818					10'
353	1,463	120	60	64	27 x 55	15'4"
354	1,463	120	60	64	27 x 55	11'4"
355	1,463	120	60	64	27 x 55	15'3"
356	1,338	100	60	56	27 x 51	11'4"
357	1,213	90	60	48	27 x 46	14'9"
358	1,100	72	60	48	27 x 44	11'3"
359	1,188	90	60	48	27 x 44	11'3"

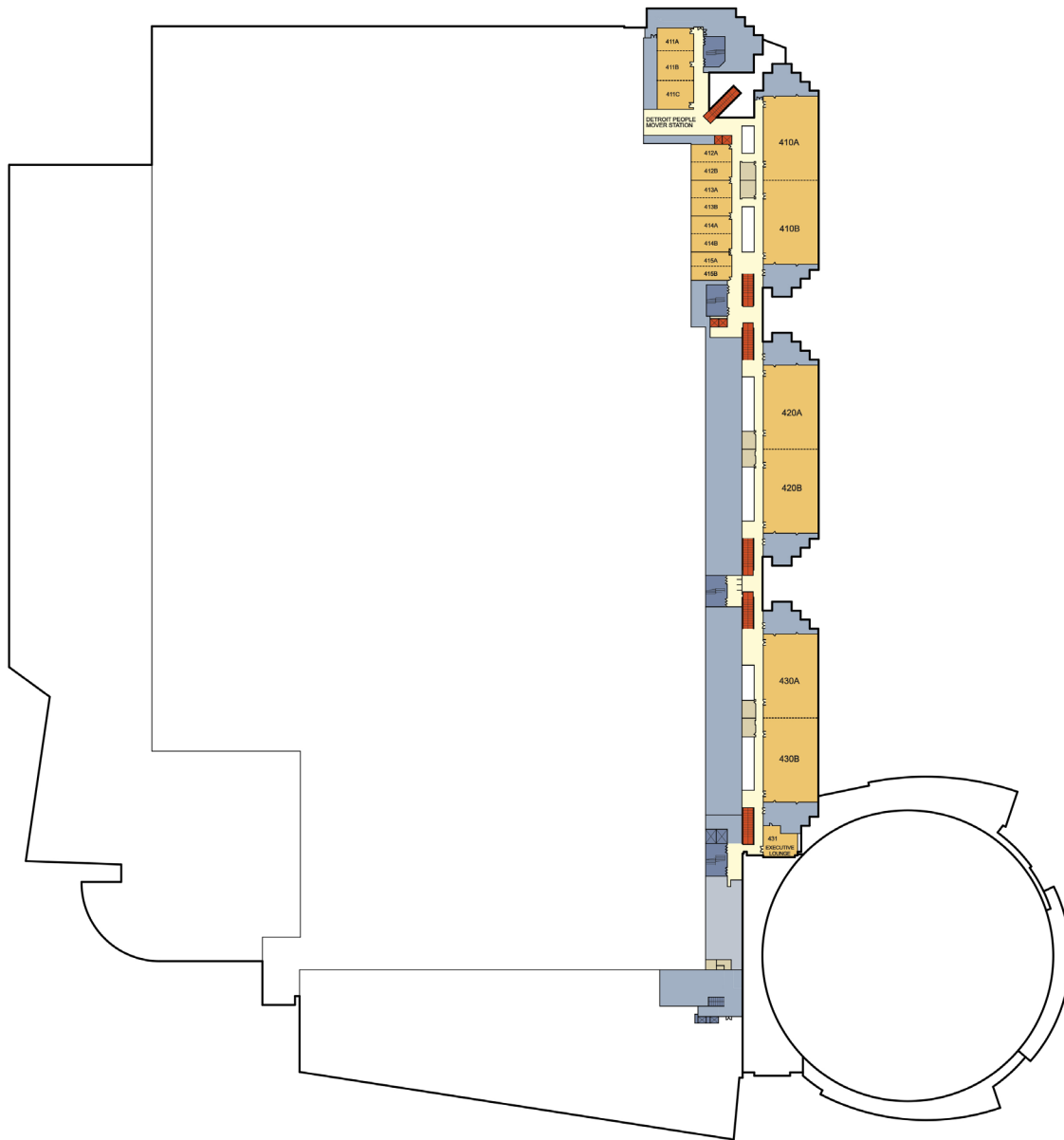

## LEVEL 400

### LEGEND

- PUBLIC CIRCULATION
- EXHIBIT HALL
- MEETING ROOM
- VERTICAL TRANSPORTATION
- RESTROOM
- PERMANENT FOOD SERVICE
- ADMINISTRATIVE OFFICE
- BACK OF HOUSE
- PARKING

# FLOOR PLAN LEVEL 4

Meeting rooms, executive lounge and The Detroit People Mover station.

# CAPACITY LEVEL 4

ROOM NUMBER	SQUARE FEET	THEATER	BANQUET 10 per 6'	CLASSROOM 4 per 8' x 18"	DIMENSIONS (W x D)	HEIGHT
410 A	5,500	480	280	300	94 x 59	14'
410 B	5,500	480	280	300	94 x 59	14'
410 A/B	11,000	960	600	560	188 x 59	
411 A	800	60	60	32	25 x 32	10'5"
411 B - C	1,024	80	60	48	32 x 32	10'5"
411 A/B/C	2,848	240	140	144	89 x 32	
412 A	760	56	30	32	19 x 40	10'11"
412 B	684	56	30	32	19 x 36	10'11"
412 A/B	1,444	112	60	64		
413 A	760	56	30	32	19 x 40	10'11"
413 B	684	56	30	32	19 x 36	10'11"
413 A/B	1,444	112	60	64		
414 A	760	56	30	32	19 x 40	10'11"
414 B	612	56	30	32	17 x 36	10'11"
414 A/B	1,444	128	60	64		
415 A	680	35	30	16	17 x 40	10'11"
415 B	612	42	30	16	17 x 36	10'11"
415 A/B	1,292	98	40	60		
420 A - B	5,500	480	280	300	94 x 59	14'
420 A/B	11,000	990	600	560	188 x 59	
430 A - B	5,500	480	280	300	94 x 59	14'
430 A/B	11,000	990	600	560	188 x 59	14'
431 Executive Lounge	1,100		20 (wall) 20		irregular, half wall splits room	



HUNTINGTON  
PLACE

SUBMIT YOUR **RFP**



HUNTINGTONPLACEDETROIT.COM | (313) 877 8777

PROUDLY MANAGED BY **LEGENDS GLOBAL**