

## Ballroom / Meeting Space

---

The Ballroom is located on the 4<sup>th</sup> level of the Peoria Civic Center. This high finish room seats up to 1,260 for a banquet or breaks into nine separate meeting rooms. The ceiling height varies from 23 feet to 25 feet and is easily accessible by stairs, escalator and elevators. The pre-function space features a coat check, green room, and an outdoor balcony offering a panoramic view of downtown Peoria.



### Great Hall

Featuring 15,200 sq. ft. of pre-function space, it is attached to the Arena and leads to the Ballroom. It has a ceiling height of 64 ft. and is enclosed by a glass arcade. Access is available to the Peoria Rivermen Hockey Team offices and store, and Toyota Box Office.

### Pre-Function Space

This area features 12,000 sq. ft. of high finished carpeted space with access to the outdoor balcony and Great Hall, plus two coat check areas and a green room.

### Outdoor Balcony

Enjoy a chance to go outdoors from the 4<sup>th</sup> level to the patio area, which is 8 x 130 ft. and located just off the pre-function space.

### Access

Accessible off the Great Hall, by escalator or elevators. All Peoria Civic Center facilities are ADA approved.

# Ballroom / Meeting Space

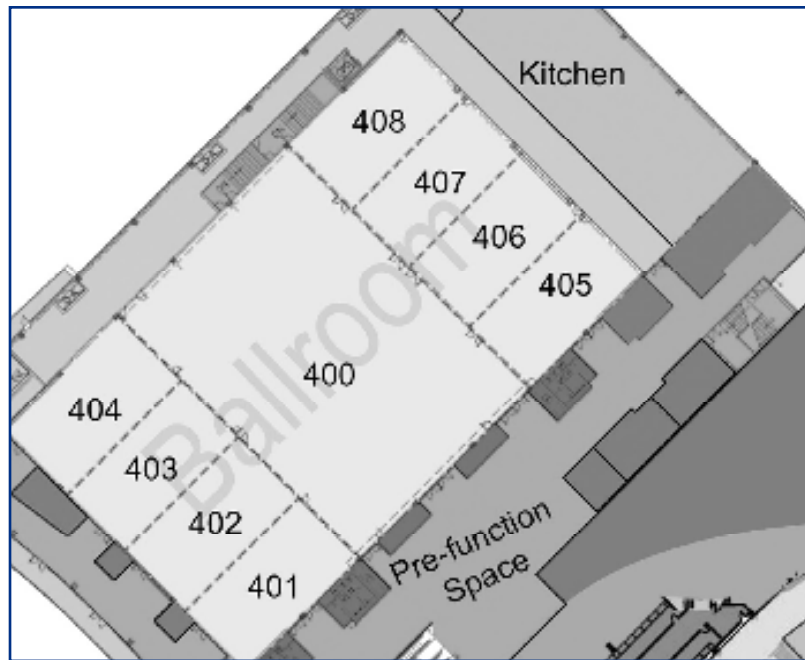

Room	Floor Space	Room Dimensions	Theater Capacity	Banquet Capacity	Classroom Capacity
Ballroom	26,550 sq. ft.	127' 6" x 208'	2,200 people	1,260 people	1,038 - 1,054 people
400	11,230 sq. ft.	127' 6" x 88'	1,215 people	560 people	766 people
401- 404	7,656 sq. ft.	127' 6" x 60'	728 people	400 people	272 - 288 people
405 - 408	7,656 sq. ft.	127' 6" x 60'	728 people	400 people	272 - 288 people
3 sections of 401 - 408	5,580 sq. ft.	93' x 60'	546 - 720 people	320 people	204 - 216 people
2 sections of 401 - 408	3,720 sq. ft.	62' x 60'	364 - 480 people	160 people	136 - 144 people
1 section of 401 - 408	1,800 sq. ft.	31' x 60'	182 - 240 people	80 people	68 - 72 people
400 - 404	18,900 sq. ft.	127' 6" x 148'	1,943 people	960 people	1,038 people
400, 405 - 408	18,900 sq. ft.	127' 6" x 148'	1,943 people	960 people	1,038 people

## Ballroom / Meeting Space

### Ballroom Rental

Included with your room rental are tables, chairs, initial room setup, energy, house sound, and wired microphone. Basic white linens are provided when the room is used for banquets or food functions.

### Versatile Space

The Ballroom may be used for a banquet, reception, wedding, meeting(s) or convention. The 27,000 sq. ft. can be divided into nine separate meeting rooms. Please see the chart above for seating details.

### Catering

Exclusive catering provided by SAVOR, our in-house caterer. When renting the Ballroom for any food function, rental rates may be reduced or waived depending on the amount of food and beverage purchased through SAVOR before tax and gratuity.

### Event Services

The experienced Peoria Civic Center staff will coordinate every aspect of your event from decorators to floral services. All events can be turnkey, or you may use your preferred suppliers with Peoria Civic Center approval.

### Audio Visual

The Peoria Civic Center event staff can arrange for your complete audio visual equipment needs, and provide an AV specialist. Ask your event manager for more information.

### Security / Emergency

The Peoria Civic Center provides full-service security that is arranged through your event coordinator. A certified nurse is required with events hosting 300 people or more.

### Access

Accessible off the Great Hall by escalator or elevators. All Peoria Civic Center facilities are ADA approved.

### Internet Access

We feature high-speed wireless internet, video streaming, and video conferencing throughout the facility.



# Exhibit Halls

The Peoria Civic Center is the largest exhibition facility in downstate Illinois. The 110,000 square foot Exhibit Hall is the size of two football fields and can be divided into four halls with a ceiling height of 30 feet to the beams. In addition, there is an experienced staff capable of handling everything from technical services to catering.

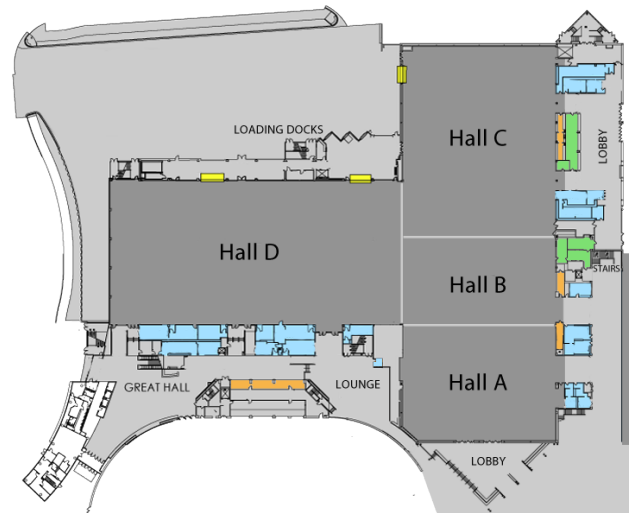

Room	Floor Space	Room Dimensions	Booth Space (10' x 10')	Theater Capacity (people)	Banquet Capacity (people)	Classroom Capacity (people)
Exhibit Hall A	18,681 sq. ft.	118' 6" x 157' 8"	107 Booths	1,875	900	900
Exhibit Hall B	13,953 sq. ft.	88' x 157' 8"	84 Booths	1,350	700	616
Exhibit Hall C	31,034 sq. ft.	196' 8" x 157' 8"	189 Booths	3,750	1,320	1,680
Exhibit Hall D	45,000 sq. ft.	300' x 150'	273 Booths	3,600	2,100	1,920
Exhibit Halls A & B	32,634 sq. ft.	207' x 157' 8"	191 Booths	3,225	1,600	1,516
Exhibit Halls B & C	44,987 sq. ft.	284' x 157' 8"	273 Booths	5,100	2,020	2,296
Exhibit Halls A - C	63,668 sq. ft.	403' x 157' 8"	380 Booths	6,975	2,920	3,196
Exhibit Halls B, C, D	89,987 sq. ft.		546 Booths	8,700	4,120	4,216
Exhibit Halls A - D	108,668 sq. ft.		653 Booths	10,575	5,020	5,116

# Meeting Rooms

The Peoria Civic Center features 17,000 sq. ft. of meeting space in addition to the Ballroom. These 16 rooms are located on the first and second levels and vary in size with seating from 10 - 1,000 people with access via stairs and elevators.



## Lobbies

Skylight	3,424 sq. ft.	117' x 30'
Triangle	2,383 sq. ft.	101' x 65'
Terrazzo	3,932 sq. ft.	42' x 100'
220's Pre-Function	1,500 sq. ft.	40' x 44'

## Event Services

The experienced Peoria Civic Center staff will coordinate every aspect of your event from decorators to floral services. All events can be turnkey. You are also allowed to bring in your preferred supplies, with Peoria Civic Center approval.

## Catering

Exclusive catering provided by SAVOR, our in-house caterer. Room rentals rates may be reduced or waived depending on the amount of food and beverage purchased through SAVOR.

## Audio Visual

Your complete audio visual equipment needs, including an AV specialist, are available. Some meeting rooms have special no glare finish, allowing images to be projected onto the wall.

## Security/Emergency

The Peoria Civic Center provides full-service security that is arranged through your event manager. A certified nurse is required with events hosting 300 people or more.

## Audio Visual

We feature high-speed wireless internet, video streaming and video conferencing throughout our facilities.

## Restrooms

Restrooms are conveniently located throughout the facilities.

# Meeting Rooms

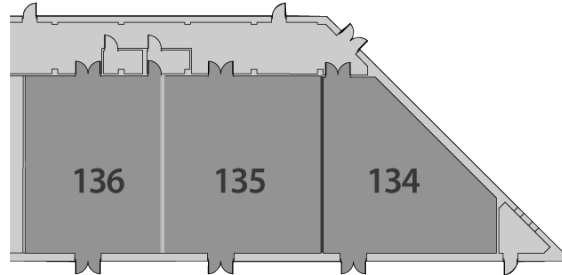

Room	Floor Space	Room Dimensions	Height	Theater Capacity (people)	Banquet Capacity (people)	Classroom Capacity (people)
134	1,200 sq. ft.	Triangular	14 ft.	100 people	50 people	39 people
135	1,500 sq. ft.	40' x 37' 6"	14 ft.	145 people	80 people	56 people
136	1,160 sq. ft.	40' x 29'	14 ft.	145 people	70 people	52 people
135/136	2,660 sq. ft.	40' x 66' 6"	14 ft.	290 people	150 people	108 people

Included with your room rental are tables, chairs, initial room setup, energy, house sound, podium, and wired microphone. When the primary purpose of the event includes food service, basic white linens are also provided.

\*Numbers reflect maximum capacity with podium in front of room. Additions will decrease capacities of staging.

# Meeting Rooms

Room	Floor Space	Room Dimensions	Height	Theater Capacity (people)	Banquet Capacity (people)	Classroom Capacity (people)
200	600 sq. ft.	25' x 24'	9 ft.	40 people	36 people	18 people
201	490 sq. ft.	25' x 19' 6"	9 ft.	36 people	24 people	18 people
202	530 sq. ft.	20' x 26' 6"	9 ft.	33 people	16 people	12 people
203	525 sq. ft.	25' x 21'	9 ft.	36 people	24 people	18 people
209	929 sq. ft.	Triangular	10 ft.	57 people	40 people	22 people
210	608 sq. ft.	32' x 19'	10 ft.	39 people	16 people	20 people
211	608 sq. ft.	32' x 19'	10 ft.	44 people	32 people	24 people
210/211	1,216 sq. ft.	32' x 38'	10 ft.	83 people	48 people	44 people
212	608 sq. ft.	32' x 19'	10 ft.	44 people	32 people	24 people
213	672 sq. ft.	32' x 21'	10 ft.	44 people	24 people	24 people
212/213	1,280 sq. ft.	32' x 40'	10 ft.	88 people	56 people	48 people
218	644 sq. ft.	Triangular	10 ft.	28 people	24 people	13 people
220	1,797 sq. ft.	39' 8" x 48' 6"	10 ft.	130 people	90 people	73 people
221	2,181 sq. ft.	40' x 56' 10"	10 ft.	145 people	90 people	84 people
222	3,303 sq. ft.	60' 7" x 56' 10"	10 ft.	170 people	150 people	126 people
220/221	3,978 sq. ft.	88' 6" x 40'	10 ft.	275 people	180 people	157 people
221/222	5,484 sq. ft.	100' 7" x 56' 10"	10 ft.	315 people	240 people	210 people
220-222	7,289 sq. ft.	149' 1" x 56' 10"	10 ft.	445 people	330 people	283 people

Included with your room rental are tables, chairs, initial room setup, energy, house sound, podium, and wired microphone. When the primary purpose of the event includes food service, basic white linens are also provided.

\*Numbers reflect maximum capacity with podium in front of room. Additions will decrease capacities of staging.

# Lexus Club

---

The Lexus Club is located on the vomitory level just above the Great Hall at the Peoria Civic Center. Renovated in 2024, this space is the ideal location for upscale receptions, social gatherings or business presentations.

The 2,717 sq ft space features a built-in presentation stage, large wall-mounted monitors with upgraded audiovisual hookups, a catering peninsula and a large bar room with private restrooms. Seating in the Lexus Club consists of 15 high top tables (4 chairs each), and 5 built-in booths (seats 4 each). Seated capacity is 80. Standing capacity is 125.

The Lexus Club is open to Suite, VIP and Club-level patrons for ticketed events in the arena. On non-event days, it is also available for private event rental.

The Lexus Club is sponsored by Lexus of Peoria, located at 7301 Allen Road, Peoria. Their passion for providing a world-class experience transitions to this upscale venue.

