

# Meeting Rooms

The Peoria Civic Center features 17,000 sq. ft. of meeting space in addition to the Ballroom. These 16 rooms are located on the first and second levels and vary in size with seating from 10 - 1,000 people with access via stairs and elevators. [Take a Virtual Tour!](#)



## Lobbies

Skylight	3,424 sq. ft.	117' x 30'
Triangle	2,383 sq. ft.	101' x 65'
Terrazzo	3,932 sq. ft.	42' x 100'
220's Pre-Function	1,500 sq. ft.	40' x 44'

## Peoria Expo

Experienced [Peoria Expo](#) staff will coordinate every aspect of your event from decorators to floral services. The professional service, creative ideas and rental selection makes Peoria Expo your first stop for all your event needs.

## Catering

Exclusive catering provided by [SAVOR](#), our in-house caterer. Room rentals rates may be reduced or waived depending on the amount of food and beverage purchased through SAVOR.

## Audio Visual

Your complete audio visual equipment needs, including an AV specialist, are available. Some meeting rooms have special no glare finish, allowing images to be projected onto the wall.

## Security/Emergency

The Peoria Civic Center provides full-service security that is arranged through your event manager. A certified nurse is required with events hosting 300 people or more.

## Internet Access

We feature high-speed wireless internet, video streaming and video conferencing throughout our facilities.

## Restrooms

Restrooms are conveniently located throughout the facilities.

## Meeting Rooms

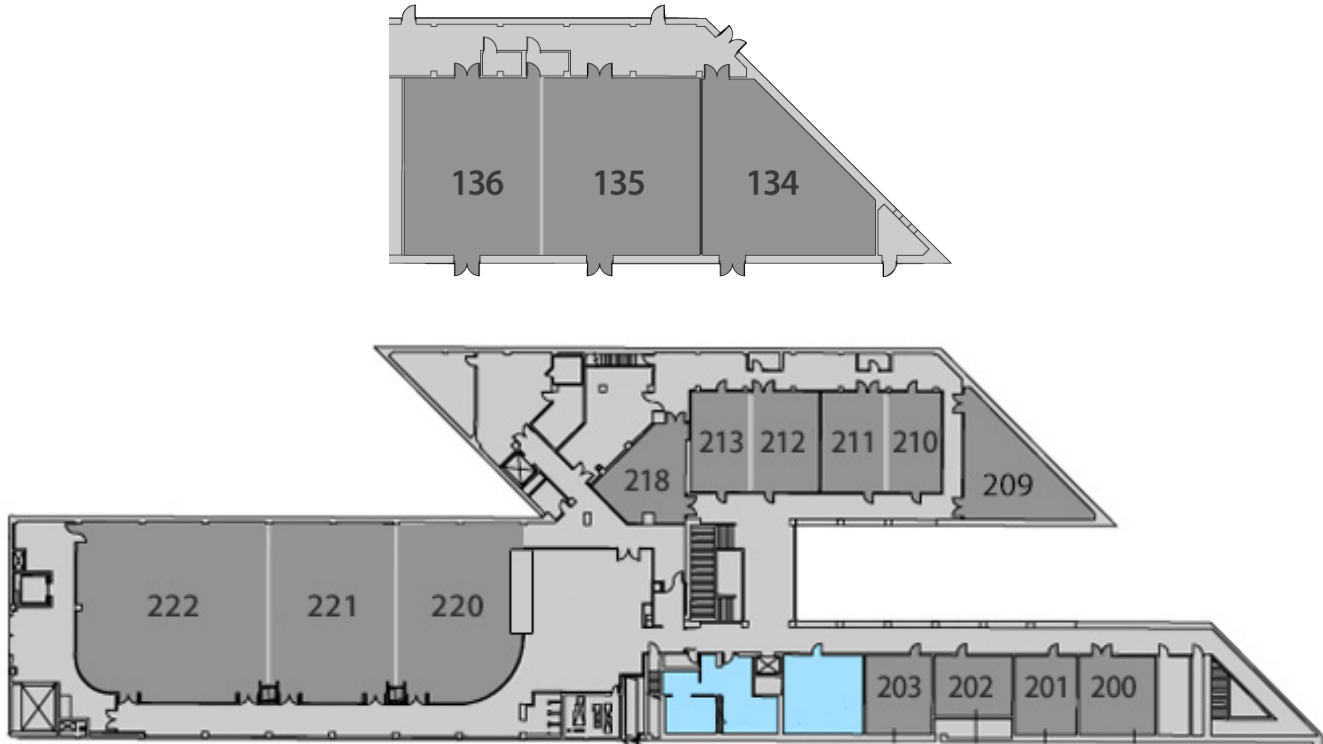

Room	Floor Space	Room Dimensions	Height	Theater Capacity (people)	Banquet Capacity (people)	Classroom Capacity (people)
134	1,200 sq. ft.	Triangular	14 ft.	100 people	50 people	39 people
135	1,500 sq. ft.	40' x 37' 6"	14 ft.	145 people	80 people	56 people
136	1,160 sq. ft.	40' x 29'	14 ft.	145 people	70 people	52 people
135/136	2,660 sq. ft.	40' x 66' 6"	14 ft.	290 people	150 people	108 people

Included with your room rental are tables, chairs, initial room setup, energy, house sound, podium, and wired microphone. When the primary purpose of the event includes food service, basic white or black linens are also provided.

\*Numbers reflect maximum capacity with podium in front of room. Additions will decrease capacities of staging.

# Meeting Rooms

Room	Floor Space	Room Dimensions	Height	Theater Capacity (people)	Banquet Capacity (people)	Classroom Capacity (people)
200	600 sq. ft.	25' x 24'	9 ft.	40 people	36 people	18 people
201	490 sq. ft.	25' x 19' 6"	9 ft.	36 people	24 people	18 people
202	530 sq. ft.	20' x 26' 6"	9 ft.	33 people	16 people	12 people
203	525 sq. ft.	25' x 21'	9 ft.	36 people	24 people	18 people
209	929 sq. ft.	Triangular	10 ft.	57 people	40 people	22 people
210	608 sq. ft.	32' x 19'	10 ft.	39 people	16 people	20 people
211	608 sq. ft.	32' x 19'	10 ft.	44 people	32 people	24 people
210/211	1,216 sq. ft.	32' x 38'	10 ft.	83 people	48 people	44 people
212	608 sq. ft.	32' x 19'	10 ft.	44 people	32 people	24 people
213	672 sq. ft.	32' x 21'	10 ft.	44 people	24 people	24 people
212/213	1,280 sq. ft.	32' x 40'	10 ft.	88 people	56 people	48 people
218	644 sq. ft.	Triangular	10 ft.	28 people	24 people	13 people
220	1,797 sq. ft.	39' 8" x 48' 6"	10 ft.	130 people	90 people	73 people
221	2,181 sq. ft.	40' x 56' 10"	10 ft.	145 people	90 people	84 people
222	3,303 sq. ft.	60' 7" x 56' 10"	10 ft.	170 people	150 people	126 people
220/221	3,978 sq. ft.	88' 6" x 40'	10 ft.	275 people	180 people	157 people
221/222	5,484 sq. ft.	100' 7" x 56' 10"	10 ft.	315 people	240 people	210 people
220-222	7,289 sq. ft.	149' 1" x 56' 10"	10 ft.	445 people	330 people	283 people

Included with your room rental are tables, chairs, initial room setup, energy, house sound, podium, and wired microphone. When the primary purpose of the event includes food service, basic white or black linens are also provided.

\*Numbers reflect maximum capacity with podium in front of room. Additions will decrease capacities of staging.