

These are the site plans of Bristol's quiet areas.

Bristol has quiet, calmer spaces where people can pause, rest and recharge. We've found them, mapped them, and want more people to know they are there.

Use the maps and information on this page to plan a quieter route, find a peaceful space, and feel more confident visiting the city centre.

The maps highlight features such as seating, shade, toilets, entrances and quieter areas to help people plan ahead.

These spaces are free to visit and open to everyone. The project was co-created with neurodivergent people and accessibility partners.

This map represents an average sensory experience, but this may vary depending on the day, time and number of people during your visit

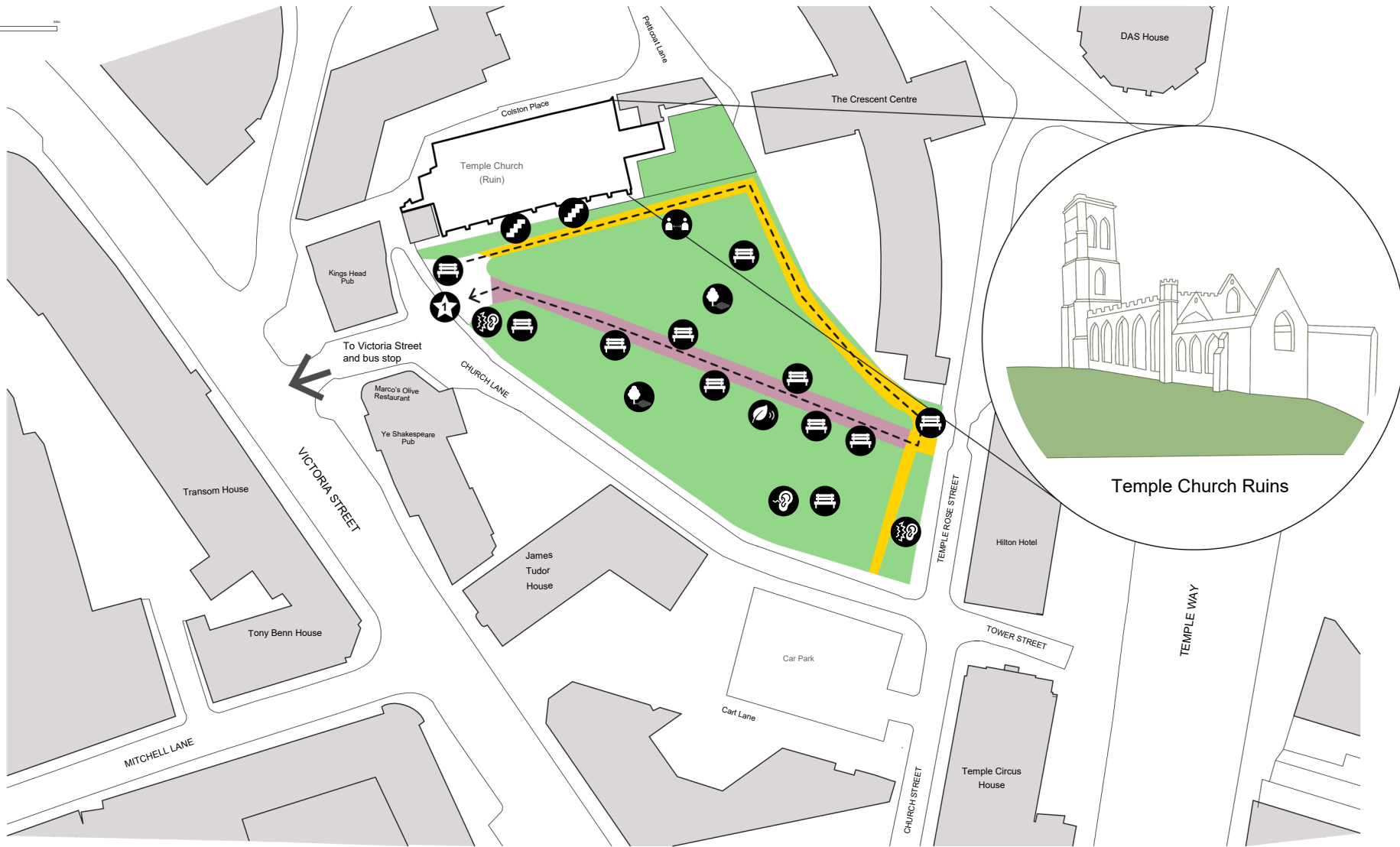

Less noisy

Leaves rustling in the summer
Birdsong



Less crowded

Seating off path
Large areas of grass



Bench



Best entrance



Narrow path



Noisier

Traffic heard at a distance
Distant people sound
Hum of ventilation



Natural sounds



Cool and shady



Steps



Uneven surface



Plants



Best route



St Stephen's Church
Gardens Entrance

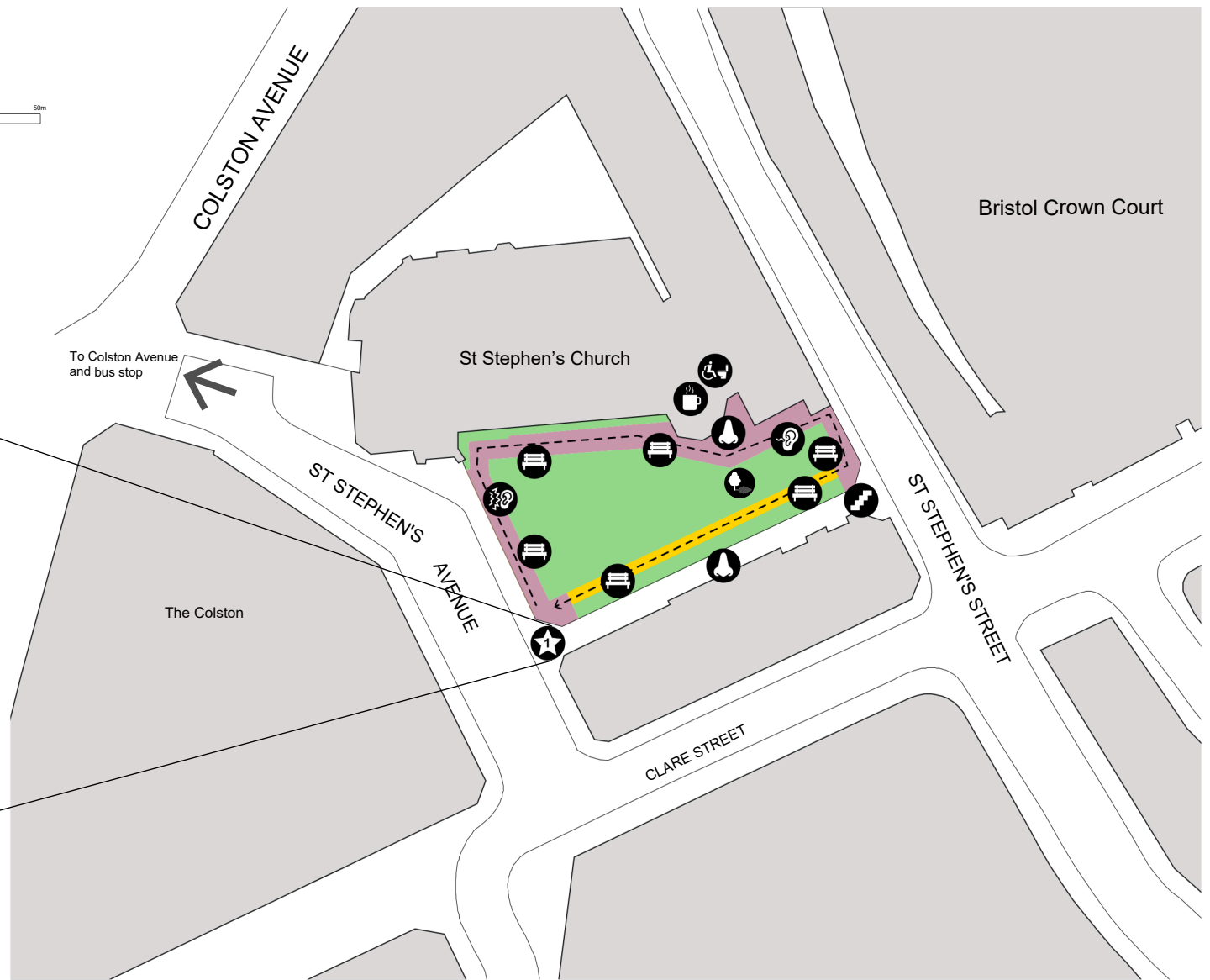

Less noisy
Leaves rustling in the summer



Strong smell



Natural sounds



Cafe



Steps



Narrow path



Noisier
Traffic heard at a distance
Distant people sound
Hum of ventilation



Cool and shady



Bench



Best entrance



Accessible toilet



Uneven surface



Plants



Best route

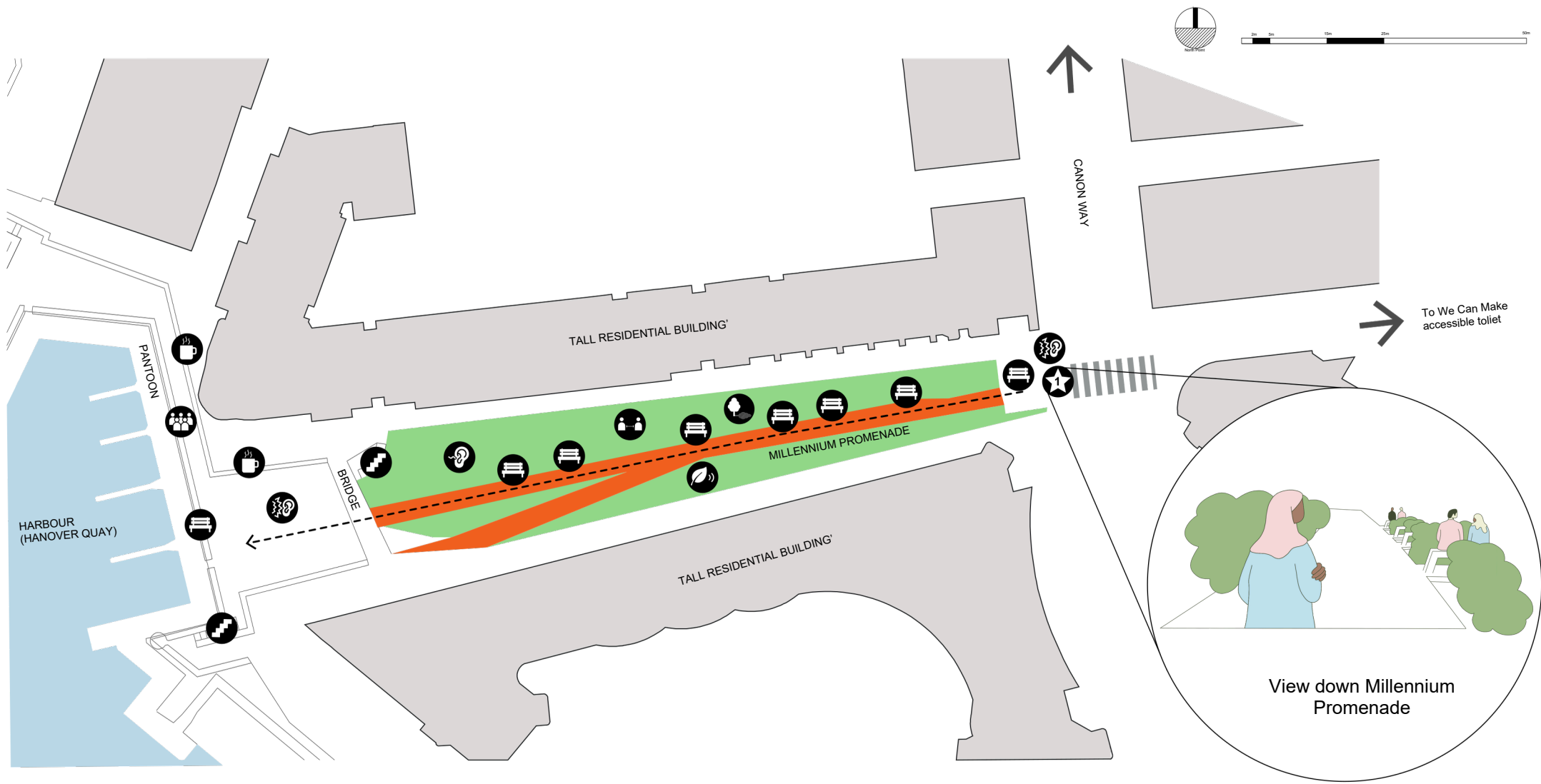

Less noisy
 Sound of grass rustling
 Water lapping in harbour

Noisier
 Traffic heard at a distance
 Distant people sounds

Less crowded
 Seating off path

More crowded
 Cafes
 Shops
 Busier at peak times

Bench

Cool and shady

Natural sounds

Best entrance

Steps

Cafe

Ramp

Water

Plants

Best route

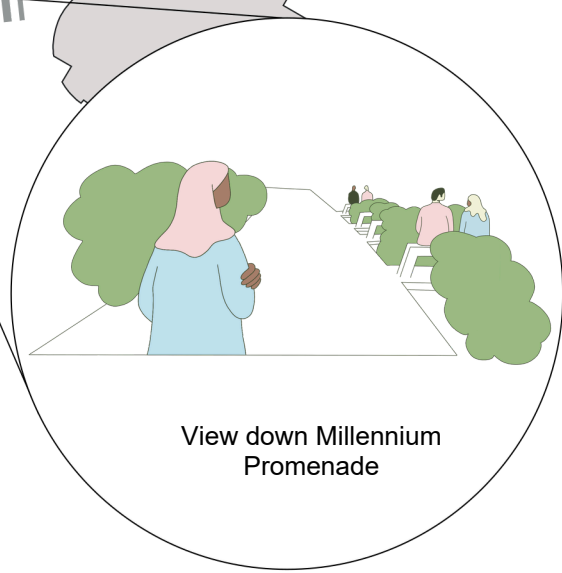

To We Can Make accessible toilet