

# Charlotte Harbor Event & Conference Center

Located in historic Downtown Punta Gorda on the banks of Charlotte Harbor, discover 44,000 square feet of flexible event space, including an 18,000-square-foot Great Lawn, and waterfront views from the Main Hall.



## Features:

- Seven flexible meeting spaces
- 1,000 person dining capacity
- 1,800 general session capacity
- Waterfront Great Lawn with paver terrace
- High-speed internet access and free Wi-Fi throughout the facility
- 11 theatrical line-sets in Hibiscus Hall
- Two star dressing rooms (220 sq.ft.) and two group dressing rooms (394 sq.ft.)
- Diverse in-house audio visual services
- ADA accessibility
- 240 complimentary parking spaces on-site

## Technical Specifications:

- Exhibit booth capacity: 112
- Lighting: Theatrical for staging
- Staging/Rigging:
  - Multi-stage configurations with max 40' x 60'
  - Main Hall rigging points are 2,000 lbs. on 10' center
- Loading Dock:
  - Two with 10' x 12' roll-up overhead doors
  - Ramp with direct hall access
- Electrical:
  - Power and data at 30' x 30' centers in floor
  - Pre-function space: Power and data connection
- Audio Visual:
  - Recessed screens and projectors in meeting rooms
  - Additional equipment available upon request



CharlotteHarborECC.com • 941.833.5444  
75 Taylor Street, Punta Gorda, FL 33950

Professionally managed by ASM Global and  
catering services by SAVOR... Charlotte Harbor





## Easily Accessible and Convenient:

- Located in a walkable Historic District with hotels, dining, shopping, and attractions just outside our doors
- Four full-service hotels, over 450 rooms adjacent to the facility
- Close proximity to I-75 and US-41 (Tamiami Trail)
- Less than a one-hour drive to three airports: Punta Gorda Airport (PGD), Southwest Florida International (RSW), and Sarasota-Bradenton International (SRQ)

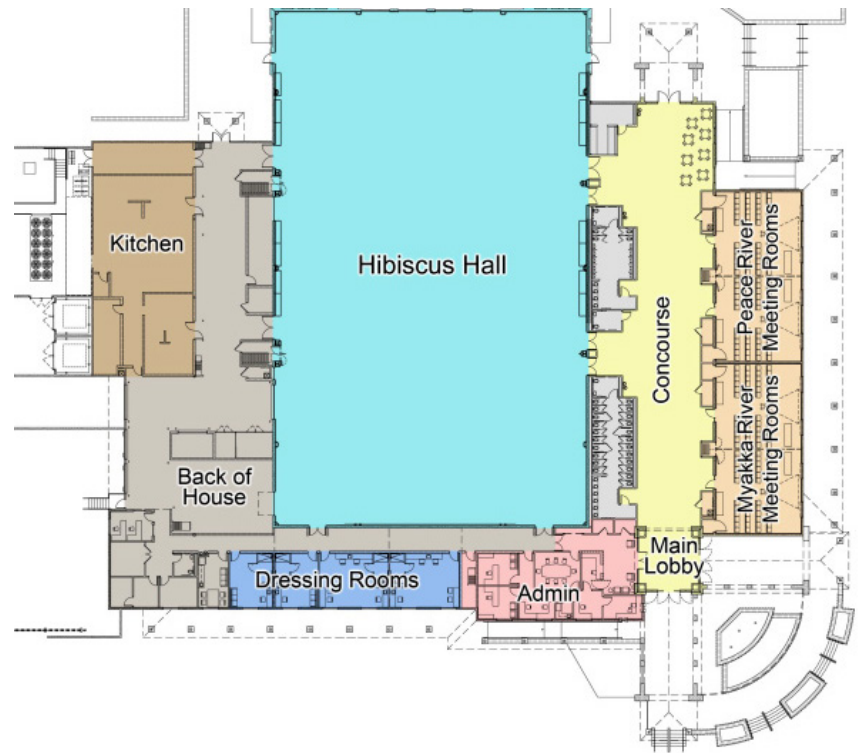

## The Perfect Setting For:

- Consumer expos and trade shows
  - Sports events/conferences
  - Regional & national conventions
  - Weddings
  - Formal gatherings
- ... and everything in between



Room	Size	Square Feet	Ceiling	Theater Seating	Banquet Seating	Classroom Seating	Exhibit Booths
<b>Main Hall</b>							
Hibiscus Hall ABC	180' x 110'	19,800	35'-46'	1,517	900	1,100	112
Hibiscus Hall A or B or C	60' x 110'	6,600	35'-46'	480	390	370	38
Hibiscus Hall AB or BC	120' x 110'	13,200	35'-46'	960	640	750	74
<b>Meeting Rooms</b>							
Myakka River Room	30' x 59'	1,770	16'	194	140	120	N/A
Myakka River Room 1 or 2	30' x 30'	900	16'	94	60	51	N/A
Peace River Room	30' x 59'	1,770	16'	194	140	120	N/A
Peace River Room 1 or 2	30' x 30'	900	16'	94	60	51	N/A
<b>Pre-Function</b>							
Concourse	22' x 145'	2,659	23'	N/A	N/A	N/A	N/A
<b>Outdoor Areas</b>							
Great Lawn	Varies	18,000	N/A	N/A	N/A	N/A	N/A