

# COLORADO CONVENTION CENTER

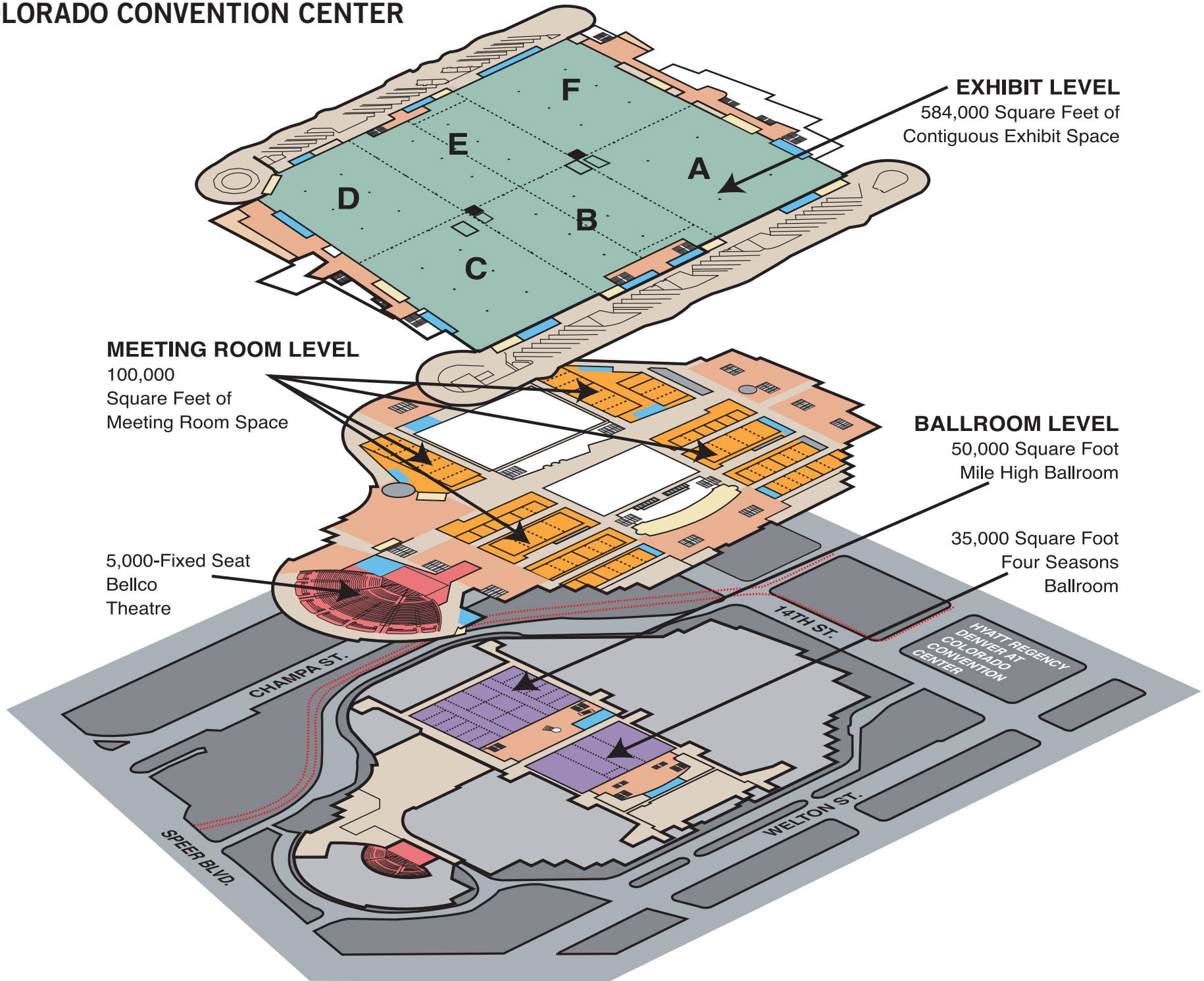

**EXHIBIT LEVEL**  
584,000 Square Feet of  
Contiguous Exhibit Space

**MEETING ROOM LEVEL**  
100,000  
Square Feet of  
Meeting Room Space

**BALLROOM LEVEL**  
50,000 Square Foot  
Mile High Ballroom

5,000-Fixed Seat  
Bellco  
Theatre

35,000 Square Foot  
Four Seasons  
Ballroom

CHAMPA ST.

14TH ST.

HYATT REGENCY  
DENVER AT  
COLORADO  
CONVENTION  
CENTER

SPEER BLVD.

WELTON ST.

# EXHIBIT LEVEL

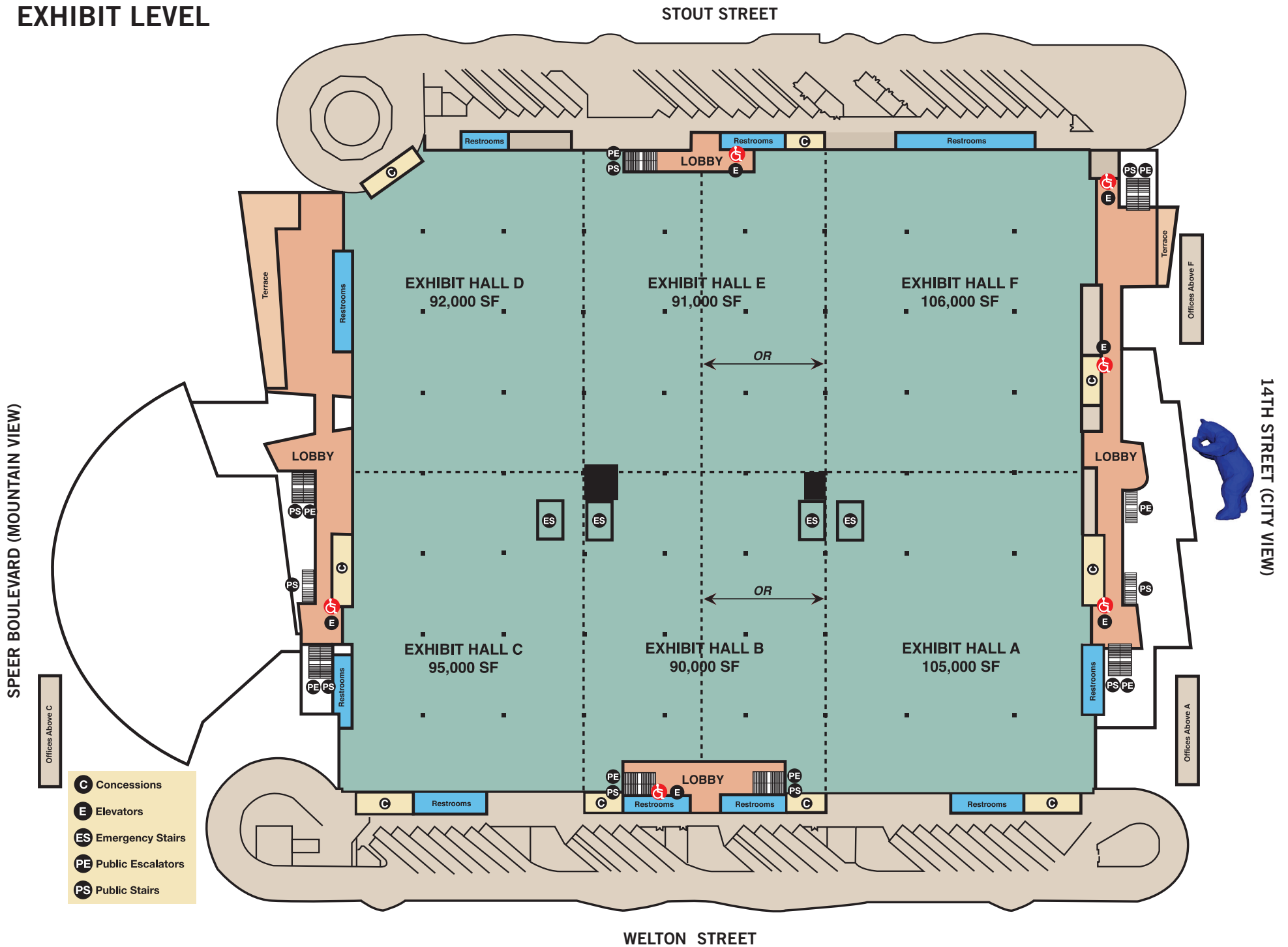

# MEETING ROOM LEVEL

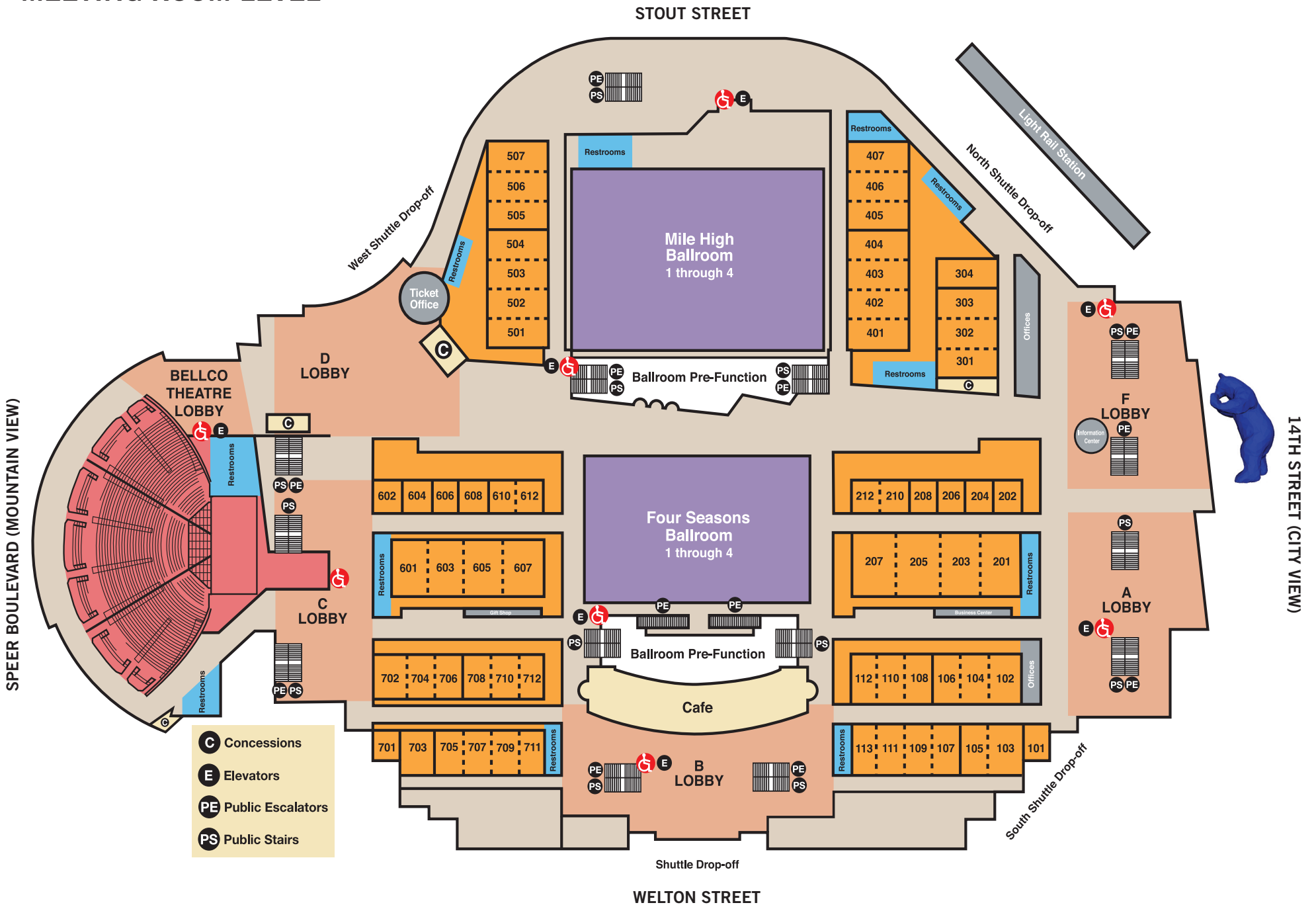

# BALLROOM LEVEL

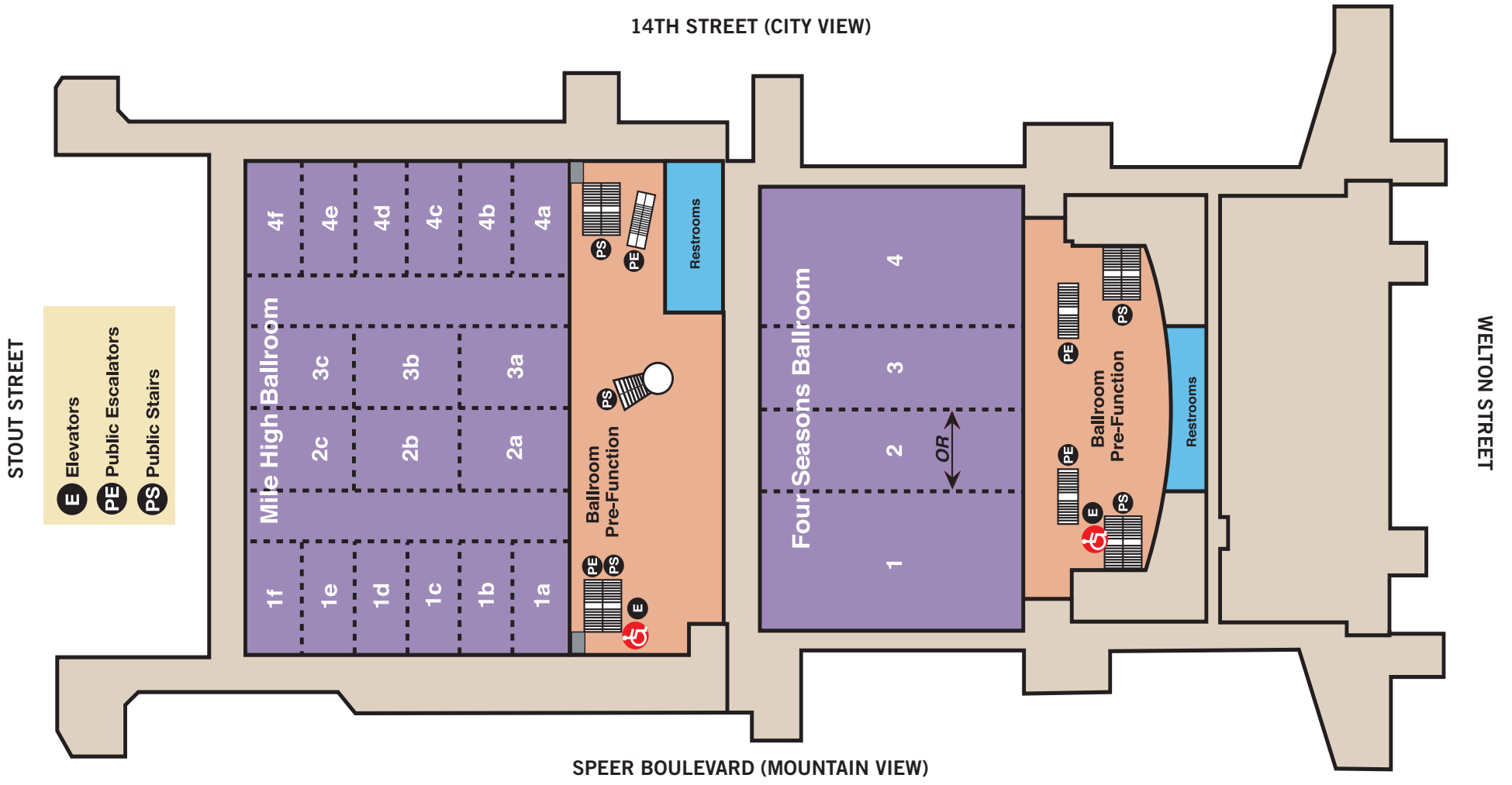

STOUT STREET

14TH STREET (CITY VIEW)

SPEER BOULEVARD (MOUNTAIN VIEW)

WELTON STREET

# BELCO THEATRE

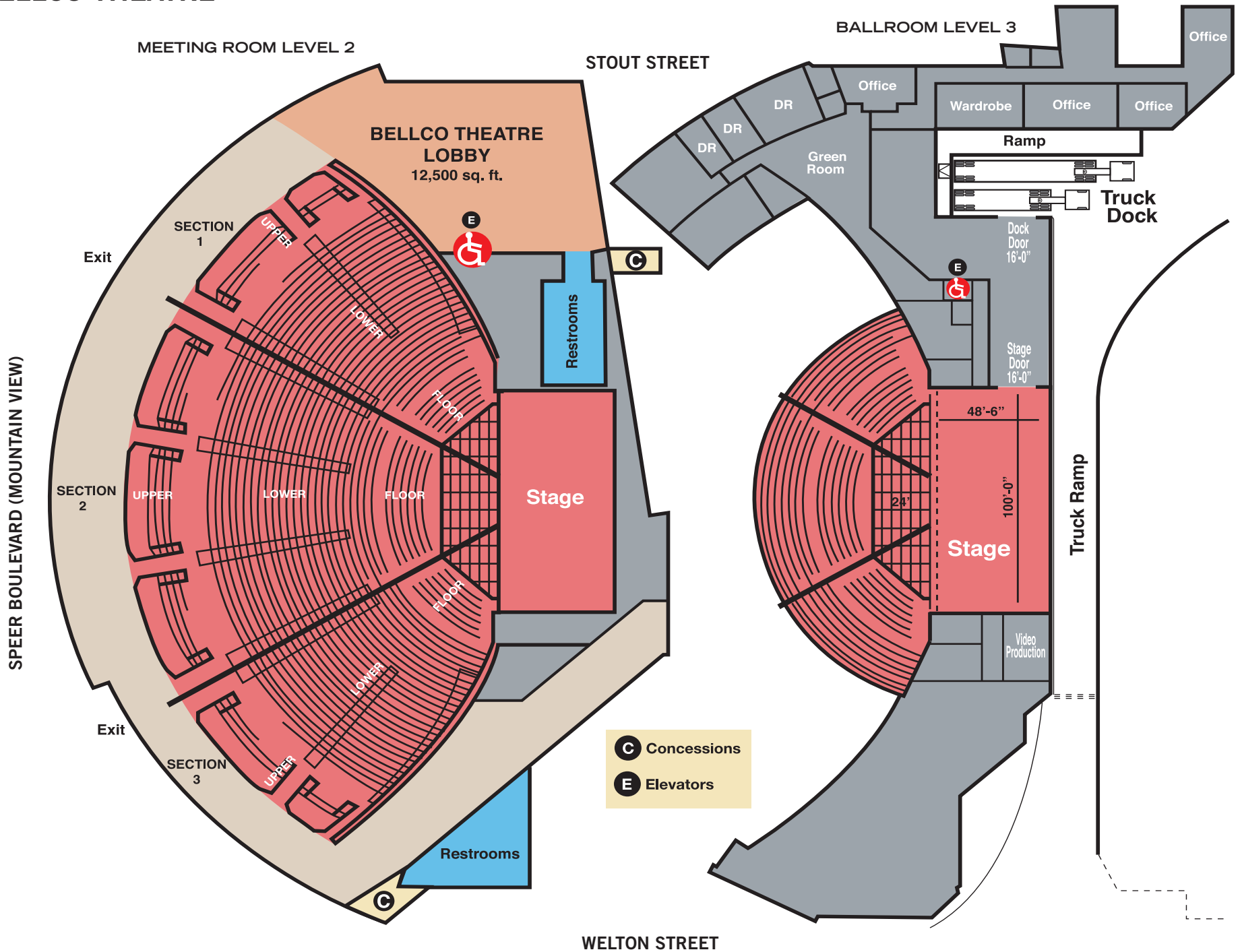

- C** Concessions
- E** Elevators