



February 26, 2020



Public Risk
Management
Association

PROPOSAL

PRIMA 2024 May 31-June 5, 2024

Function	Day(s)/Time Needed	Rental (Exclusive of tax)	Notes
Staff Office Room 207/208 (1,512 sq ft)	May 31-June 5, 2024	N/C	
AV Storage Room 209/210 (1,512 sq ft)	May 31-June 5, 2024	N/C	
Speaker Ready Room 213 (572 sq ft)	June 2-5, 2024	N/C	
Exhibit Hall Exhibit Hall A (113,448 sq ft)	June 1-4, 2024	\$46,508.00	Please note, the move in and move out rate is included in this price.
Registration Hall A Prefunction and Atrium (11,206 sq ft)	June 1-5, 2024	N/C	
General Session Floridian Ballroom (20,316 sq ft)	June 1-5, 2024	\$20,250.00	Please note, the move in and move out rate is included in this price.
Meeting 1 Room 250 A (1,644 sq ft)	June 2-5, 2024	N/C	
Meeting 2 Room 250 B (1,723 sq ft)	June 2-5, 2024	N/C	
Meeting 3 Room 250 C (1,657 sq ft)	June 2-5, 2024	N/C	
Meeting 4 Room 251 A (1,1644 sq ft)	June 2-5, 2024	N/C	

Meeting 5 Room 251 B (1,723 sq ft)	June 2-5, 2024	N/C	
Meeting 6 Room 251 C (1,657 sq ft)	June 2-5, 2024	N/C	
Meeting 7 Room 260 A (2,830 sq ft)	June 2-5, 2024	N/C	
Meeting 8 Room 260 B (2,830 sq ft)	June 2-5, 2024	N/C	
ICW 1 Room 252 A (1,659 sq ft)	June 2-5, 2024	N/C	
ICW 2 Room 252 B (1,724 sq ft)	June 2-5, 2024	N/C	
ICW 3 Room 252 C (1,647 sq ft)	June 2-5, 2024	N/C	
ICW 4 Room 253 A (1,659 sq ft)	June 2-5, 2024	N/C	
ICW 5 Room 253 B (1,724 sq ft)	June 2-5, 2024	N/C	
ICW 6 Room 253 C (1,647 sq ft)	June 2-5, 2024	N/C	

TOTAL RENTAL: \$66,758.00

***Rental cost does not include 7% sales tax.
Please note, event space square footage is subject to change.***

Questions and Concessions:

- 1. Discount or tiered pricing on meeting space wifi options (Hotel & Center)**
 - Negotiable.
- 2. Complimentary internet in public space in Convention Center.**
 - Negotiable.
- 3. Complimentary room resets and refreshes for General Session and Luncheon Room (Center)**
 - 1 complimentary room reset per day of event and complimentary refreshes throughout event for General Session and Luncheon.
- 4. There will be no charge for receiving and handling and meeting materials of non-exhibit nature.**
 - Yes.
- 5. Include meeting space floor plans highlighting the space being proposed for PRIMA.**
 - Please see attachment.
- 6. When was the internet infrastructure last updated in the building?**
 - Our building is currently undergoing expansion and updated infrastructure is part of this project. Please see attachment.
- 7. Is technology handled in-house or through a 3rd party vendor and if so will they provide a discount?**
 - Internet and Telecommunications are provided by a third party vendor and rates are negotiable.



GREATER FORT LAUDERDALE BROWARD COUNTY
CONVENTION CENTER

What to Expect Post-Expansion

Enjoy a sneak peek of everything the bigger-
and-*greater*-than-ever-before Greater Fort
Lauderdale / Broward County Convention
Center has to offer!





Bigger & Greater

South Florida's Premier Waterfront Conference Center

*The future of convention business in
Greater Fort Lauderdale*

Features



Located minutes from Fort Lauderdale's famed Blue Wave Beaches



Adjacent to Broward County's Port Everglades



Five-minute drive from the Fort Lauderdale / Hollywood International Airport



LEED for Existing Buildings Gold-certified facility

The expansion project will add an **additional 600,000 sq. ft.** of versatile, state-of-the-art space to the existing 600,000-sq.-ft. building and an upscale 800-room, four-diamond Omni Hotels & Resorts **headquarters hotel.**





Expansion Highlights

- 350,000 sq. ft. of contiguous space
- 132,000 sq. ft. in four elegant ballrooms
- 95,000 sq. ft. of total flexible meeting space
- 202,000 sq. ft. of total pre-function space
- 1,800+ parking spaces
- 7 acres of outdoor waterfront plaza
- 1.2 million sq. ft. of total Convention Center space

Expansion Highlights: Headquarters Hotel

- 29 stories
- 800 rooms
- 73,000 sq. ft. of meeting space
- 11,000-sq.-ft. spa and fitness center
- Scenic view of the Atlantic Ocean
- Direct connectivity to the Convention Center
- Multiple restaurants and bars
- Pool deck with bar
- Iconic, versatile and sustainable outdoor event space totaling 300,000 sq. ft.



Upgrades & Amenities

- State-of-the-art technology
- Outdoor plaza with waterfront view
- Innovative dining concepts
- Eco-friendly design and operation
- Improved traffic flow around the Convention Center
- Garage parking with covered skywalks to Convention Center
- Proximity to airport, seaport, local dining, shopping and beaches





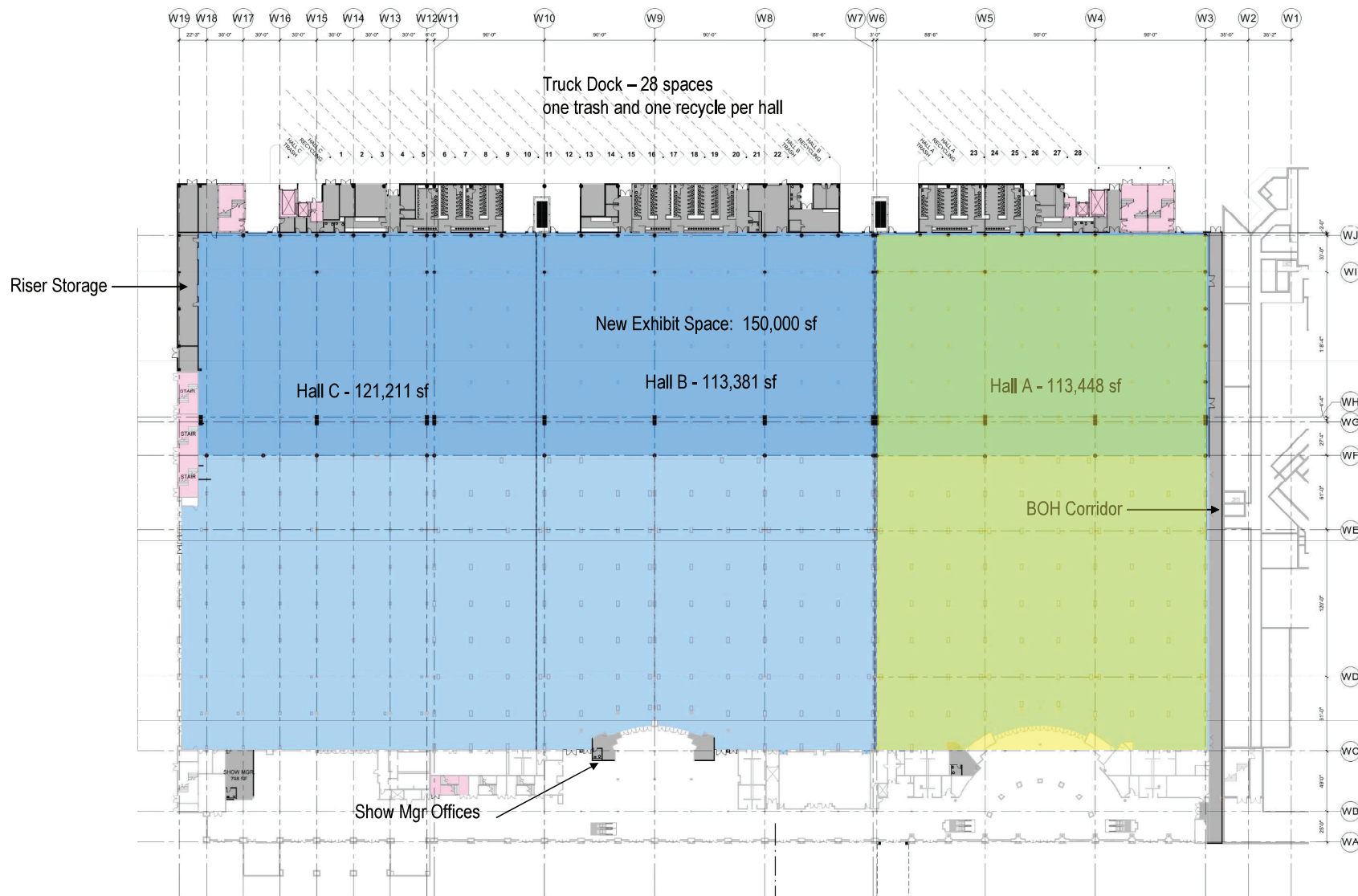

West Expansion: First Floor

BROWARD COUNTY CONVENTION CENTER EXPANSION & HEADQUARTERS HOTEL | FORT LAUDERDALE, FLORIDA
 MATTHEWS SOUTHWEST | BALFOUR BEATTY | STANTEC | FENTRESS ARCHITECTS | NUNZIO MARC DESANTIS ARCHITECTS

East Expansion: Revised Second Level Plan 20'-0"

BROWARD COUNTY CONVENTION CENTER EXPANSION & HEADQUARTERS HOTEL | FORT LAUDERDALE, FLORIDA
MATTHEWS SOUTHWEST | BALFOUR BEATTY | STANTEC | FENTRESS ARCHITECTS | NUNZIO MARC DESANTIS ARCHITECTS



3 Third floor

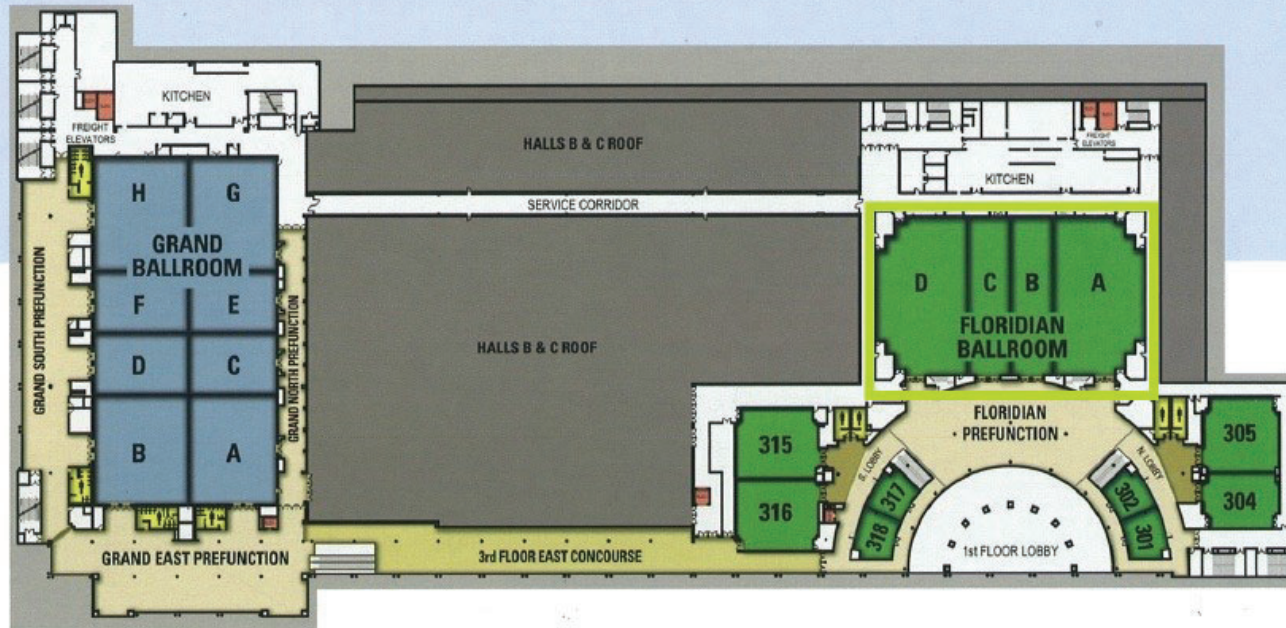

Our Facility Technology

- Extensive in-house audio visual services & equipment available.
- Cyber Café (permanent location) service and Coffee Kiosk in key locations around facility providing high-speed Internet access.
- A variety of telephone sets are available: single-line, cordless or multi-line digital sets, with caller ID.
- Wireless Internet is available for purchase in the lobby and concourse areas.
- Two carriers with interior cell sites installed: AT&T and Sprint. (Cellular service in and around the facility is very reliable.)

GRAND BALLROOM

BALLROOM	DIMENSIONS	CEILING HEIGHT	SQUARE FEET	THEATER	CLASSROOM (3 PER 6 ft.)	BANQUET	HOUSE SCREEN
A	78' x 62'	25'	4,862	532	336	300	No
B	78' x 67'	25'	5,252	532	336	300	No
C	43' x 62'	25'	2,701	280	216	150	No
D	43' x 67'	25'	2,918	280	216	150	No
E	43' x 62'	25'	2,701	280	216	150	No
F	43' x 67'	25'	2,918	280	216	150	No
G	79' x 62'	25'	4,945	532	336	300	No
H	79' x 67'	25'	5,342	532	336	300	No
Combined	245' x 130'	25'	31,639	3,566	2,208	2,000	No
North Prefunction		15'	3,562				
East Prefunction		15'	10,634				
South Prefunction		15'	9,284				
East Concourse		15'	9,845				

10' X 10' BOOTHS

Grand Blrm A	24	Grand Blrm G	27
Grand Blrm B	25	Grand Blrm H	26
Grand Blrm C/E	28	Combined	158
Grand Blrm D/F	28		

Capacity above reflects the maximum amount of seating allowed with a standing podium in each room. The addition of head tables, risers, dance floors, food service tables, or audio-visual equipment will reduce capacity.

FLORIDIAN BALLROOM

BALLROOM	DIMENSIONS	CEILING HEIGHT	SQUARE FEET	THEATER	CLASSROOM (3 PER 6 ft.)	BANQUET	HOUSE SCREEN
Ballroom A	65' x 112'	25'	6,798	700	465	560	14' x 14'
Ballroom B	30' x 112'	25'	3,360	365	225	250	No
Ballroom C	30' x 112'	25'	3,360	365	225	250	No
Ballroom D	65' x 112'	25'	6,798	700	465	560	14' x 14'
Combined	190' x 112'	25'	20,316	2,100	1,380	1,160	14' x 14'
Floridian Prefunction		20'	9,619				
North Lobby		20'	2,734				
301	33' x 30'	14'	990	72	54	60	No
302	30' x 30'	14'	900	87	54	60	No
Combined	63' x 30'	14'	1,890	144	117	120	No
304	42' x 53'	15'	2,226	210	159	140	No
305	50' x 53'	15'	2,650	240	168	180	8' x 8'
Combined	92' x 53'	15'	4,876	475	306	320	8' x 8'
South Lobby		20'	2,601				
315	49' x 59'	15'	2,891	298	174	180	No
316	50' x 59'	15'	2,950	314	192	200	8' x 8'
Combined	99' x 59'	15'	5,841	620	396	400	8' x 8'
317	30' x 30'	14'	900	87	54	60	No
318	33' x 30'	14'	990	72	54	60	No
Combined	63' x 30'	14'	1,890	144	117	120	No

10' X 10' BOOTHS

Floridian Blrm A	35
Floridian Blrm B	18
Floridian Blrm C	18
Floridian Blrm D	35
Combined	106

10' X 10' BOOTHS

Room 304/305	21
Room 315/316	25

Capacity left reflects the maximum amount of seating allowed with a standing podium in each room. The addition of head tables, risers, dance floors, food service tables, or audio-visual equipment will reduce capacity.