

GRAPEVINE TEXAS

SETTLEMENT TO CITY MUSEUMS

AT TED R. WARE PLAZA

Settlement to City Museums
206 W. Hudgins St., Grapevine, Texas 76051

Tuesday-Saturday	10 a.m.-4 p.m.
Sunday	11 a.m.-4 p.m.
Monday	Closed

GrapevineMuseums.com or 817.410.3526

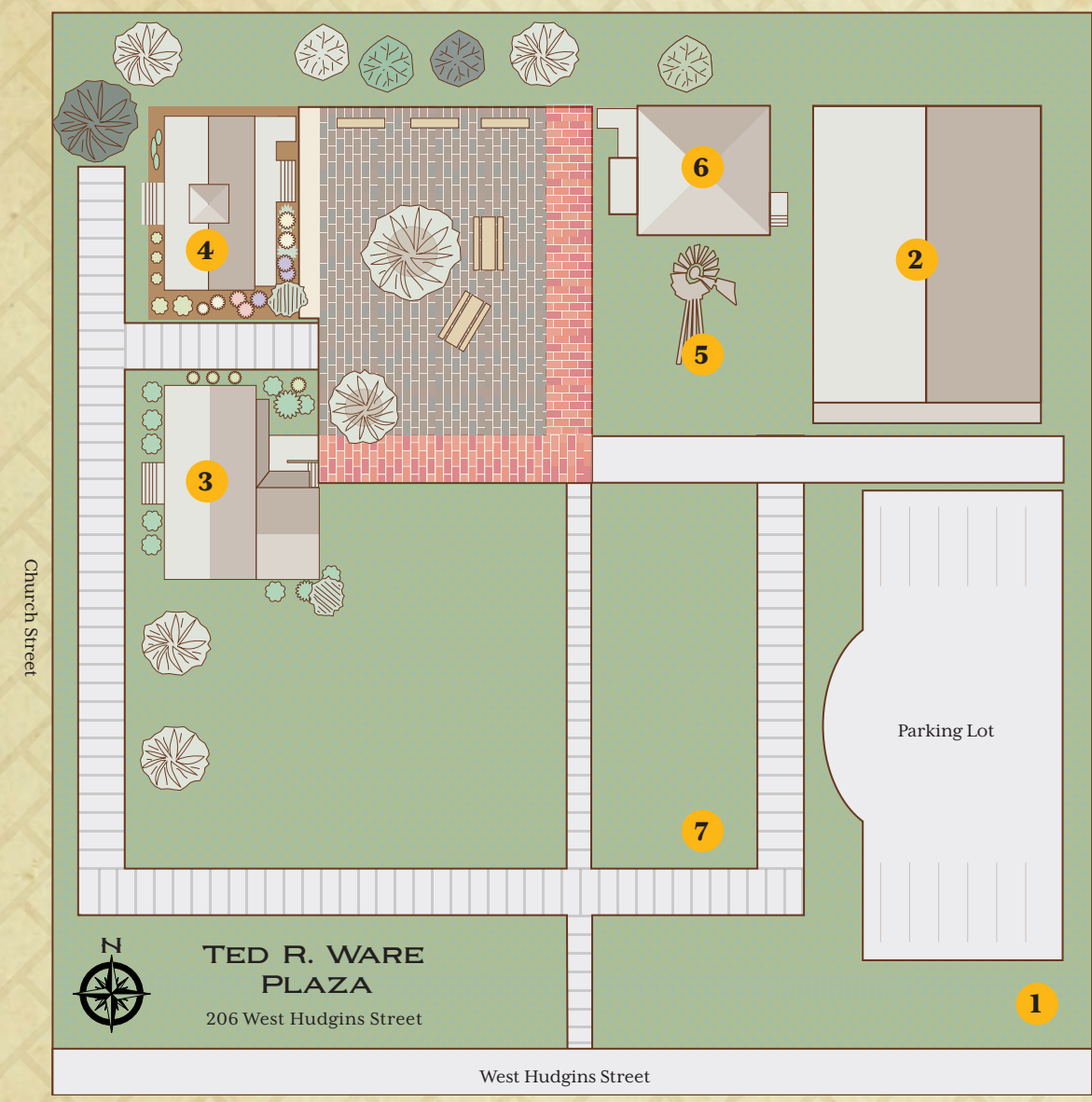

- | | |
|------------------------------------|---------------------------------------|
| 1. Settlement to City Museums Sign | 5. "Prairie Water" Public Art Feature |
| 2. Grapevine Historical Museum | 6. Cotton Ginner's Museum |
| 3. Settlement to City Museum | 7. Grapevine Fire Bell |
| 4. Donald Schoolhouse Museum | |



GRAPEVINE TEXAS

CELEBRATING 175 YEARS | 1844-2019

GrapevineMuseums.com

1. Settlement to City Museums

Sign

Refurbished Flower Shop Sign

If only each and every part of this refurbished neon sign could tell its story, it would recount tales of historic storms, decades of homecoming parades and good times on Grapevine's Historic Main Street.

Constructed during the neon sign boom after World War II, many residents remember it from its original location at the Grapevine Flower Shop, where it stood for more than 30 years.

Restored in 2014, this piece of history directs visitors to the Settlement to City Museums.



2. Grapevine Historical Museum

Replica of 1940 Grapevine Ice House

Visitors to the Grapevine Historical Museum explore the cultural and family life of early Grapevine residents in areas including agriculture, industry, childhood and more. Exhibits include a trip through Grapevine's Attic, restored vintage wedding gowns, prehistoric artifacts and much more. Each of the artifacts in the museum were received from Grapevine-area residents.



3. Settlement to City Museum

1888 J. E. and Sarah Foreman Keeling House

The Keeling House is original to the site and is home to the Settlement to City collection. This museum chronicles the timeline of Grapevine's development from a pioneer settlement into a world-class city and visitor destination.

The museum includes historic police and fire treasures, along with additional City of Grapevine artifacts. The museum is also home to a working 1881 Chandler and Price letterpress, which is the same type of press the Keeling family used to produce the "Grapevine Sun" newspaper.



4. Donald Schoolhouse Museum

ca. 1900 Donald Schoolhouse

The Donald Schoolhouse, a ca. 1900 school building, offers a lesson on education as it developed on the Grape Vine Prairie—beginning in log cabins and growing into today's modern school district. This building was used for teaching Home Economics and Agriculture classes as part of the Donald School, which was originally situated on Denton Creek.

5. "Prairie Water" Public Art Feature

1938 Aeromotor Windmill

Ted R. Ware Plaza features the unique public art installation "Prairie Water" comprised of a 1938 Aeromotor Windmill, historic water tank, windmill blade fountain and vintage trough.

The Grape Vine Prairie was blessed with a quality water supply from underground sources and nearby Denton Creek. Quality water then, as now, was key to the city's growth.



6. Grapevine Cotton Ginner's Museum

ca. 1910 Cotton Ginner's House

The Grapevine Cotton Ginner's Museum showcases the amazing attributes and byproducts of one of the world's most important plants. It tells the story of cotton production on the Grape Vine Prairie and of the cotton ginner's who were important citizens in the community. The centerpiece of the museum is a restored 1890s E. Van Winkle cotton gin.

7. Grapevine Fire Bell

Cast in 1886

This bell, which originally hung on Jenkins Street, was used during the early 1900s. In the case of a fire, the telephone operator was responsible for ringing the bell to alert the 13 members of the all-volunteer "Bucket Brigade" fire department. The brigade was established in May 1907.

