



Sheraton DFW Airport Hotel



Sheraton®

4440 W John Carpenter Frwy
Irving, Texas 75063

(972) 929-8400

(800) 345-5251

sheraton.com/dfwairport

LOCATION

Only minutes from DFW International Airport and Las Colinas. Easy highway access to Dallas and Fort Worth attractions.

ACCOMMODATIONS

Guests enjoy 303 completely redesigned guestrooms with stylish accents. But the “crown jewel” of each guestroom is the sumptuous bed – the famous Sheraton Sweet Sleeper. Two totally new Club floors of executive accommodations and nine elegant suites. Guest rooms are nonsmoking and feature wired high-speed Internet and data ports, makeup/shaving mirrors, hair dryers, USA Today newspaper and coffeemakers with complimentary coffee refreshed daily

MEETING FACILITIES

The 10,000-square-foot Grand Ballroom can accommodate 1,000 people for a banquet and 1,300 for a theater-style meeting, as well as 50 8x10 booths for tradeshow. Seven additional meeting rooms are located on the mezzanine level, with the Galleria Ballroom and two Boardrooms on the ground floor. Spacious 4,200-square-foot atrium/reception area also holds numerous events.

TRANSPORTATION

Twenty-four-hour courtesy transportation available to and from DFW International Airport.

Sheraton DFW Airport Hotel

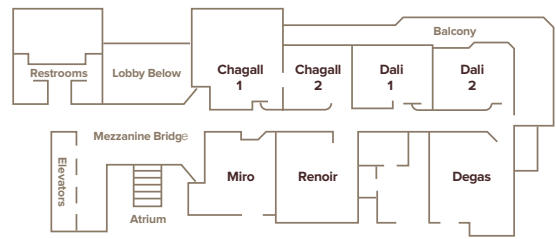
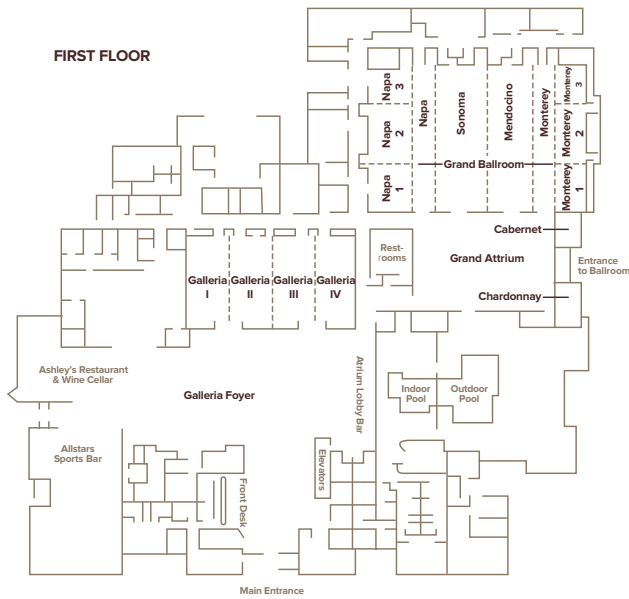

MEETING ROOM	6 x 30 TABLE TOPS	8 x 8 BOOTHS	8 x 10 BOOTHS
Grand Ballroom	-	66	50
Monterey & Mendocino	54	34	26
Monterey & Corridor	26	18	14
Mendocino	22	16	12
Sonoma	22	16	12
Napa	18	16	12
Pre-Function (Grand Atrium)	48	20	15

Meeting Room	L x W x H	Sq. Feet	Conference	Theater	Classroom	Banquet	Reception
Gallery Foyer	-	-	-	-	-	70	80
Galleria Ballroom	48 x 88 x 10	4,225	-	600	280	300	360
Galleria I	48 x 22 x 10	1,056	38	110	70	70	80
Galleria II	48 x 22 x 10	1,056	38	110	70	70	80
Galleria III	48 x 22 x 10	1,056	38	110	70	70	80
Galleria IV	48 x 22 x 10	1,056	38	110	70	70	80
Grand Atrium (Pre-Function)	76 x 54	4,180	220	-	-	260	220
Grand Ballroom	84 x 120	10,080	900	1,300	700	1,000	900
Monterey	84 x 21	2,520	150	250	168	230	150
Monterey 1	27 x 21	567	40	60	32	40	40
Monterey 2 or 3	28 x 21	588	40	60	32	40	40
Monterey 1 & 2	55 x 21	1,155	80	125	64	90	80
Mendocino	84 x 29	2,436	150	250	168	230	150
Sonoma	84 x 29	2,436	150	250	168	230	150
Napa	84 x 30	2,436	150	250	168	230	150
Napa 1	27 x 21	567	40	60	32	40	40
Napa 2 or 3	28 x 21	588	40	60	32	40	40
Napa 1 & 2	55 x 21	1,155	80	125	64	90	80
Napa & Corridor	84 x 60	2,520	150	250	168	230	150
Monterey/Mendocino or Sonoma/Napa	84 x 60	5,040	400	760	336	420	400
Sonoma & Mendocino	84 x 30	5,040	400	760	336	420	400
Cabernet	17 x 13	221	15	20	-	10	15
Chardonnay	12 x 12	144	12	15	-	10	12
Estates	25 x 18 x 8	450	-	18	14	-	18
Las Colinas	15 x 24	x 8	360	14	-	-	-
Poolside	-	-	-	-	-	90	110
Chagall (Mezzanine Level)	-	1,236	28	80	50	70	80
Chagall 1	27 x 28 x 8	756	22	50	30	30	50
Chagall 2	24 x 20 x 8	480	16	36	24	20	30
Dali (Mezzanine Level)	-	1,008	22	65	48	50	60
Dali 1	24 x 20 x 8	480	12	30	24	20	25
Dali 2	24 x 20 x 8	528	12	30	24	20	25
Miro (Mezzanine Level)	26 x 24 x 8	624	18	50	25	40	40
Renoir (Mezzanine Level)	26 x 24 x 8	624	18	50	25	40	40
Deas (Mezzanine Level)	26 x 24 x 8	624	18	50	25	40	40