



# Westin Irving Convention Center Hotel



400 West Las Colinas Blvd  
Irving, Texas 75039

(972) 505-2900

[marriott.com/hotels/travel/daliw-the-westin-irving-convention-center-at-las-colinas](https://marriott.com/hotels/travel/daliw-the-westin-irving-convention-center-at-las-colinas)

## LOCATION

The Westin Irving Convention Center is situated in between the Irving Convention Center at Las Colinas and the Toyota Music Factory in the heart of the Las Colinas Entertainment District. The adjacent Toyota Music Factory entertainment complex includes over a dozen restaurants and bars, and Alamo Drafthouse movie theater, live music at the Texas Lottery Plaza and the The Pavilion, an 8,500-seat performance venue.

## ACCOMMODATIONS

The upscale, 350 room, 14-story hotel features signature amenities including the Heavenly® Bed and Westin Sleep Well Menu, and the Heavenly® Bath with rainforest showers, plush bath towels, and robes. The property also features on-site dining in Mesa Mezcal and inventive cocktails at the Vibe Pool Bar along with a fitness center and outdoor pool.

## MEETING FACILITIES

The hotel offers 30,000 square feet of flexible indoor and outdoor event space accommodating groups up to 1,300. Immediately adjacent to the hotel is the 100,000 square-foot Irving Convention Center at Las Colinas, which can accommodate intimate gathering or groups as large as 4,800.

## TRANSPORTATION

DFW International Airport is 9 miles away and Love Field Airport is 12 miles.

# Westin Irving Convention Center Hotel

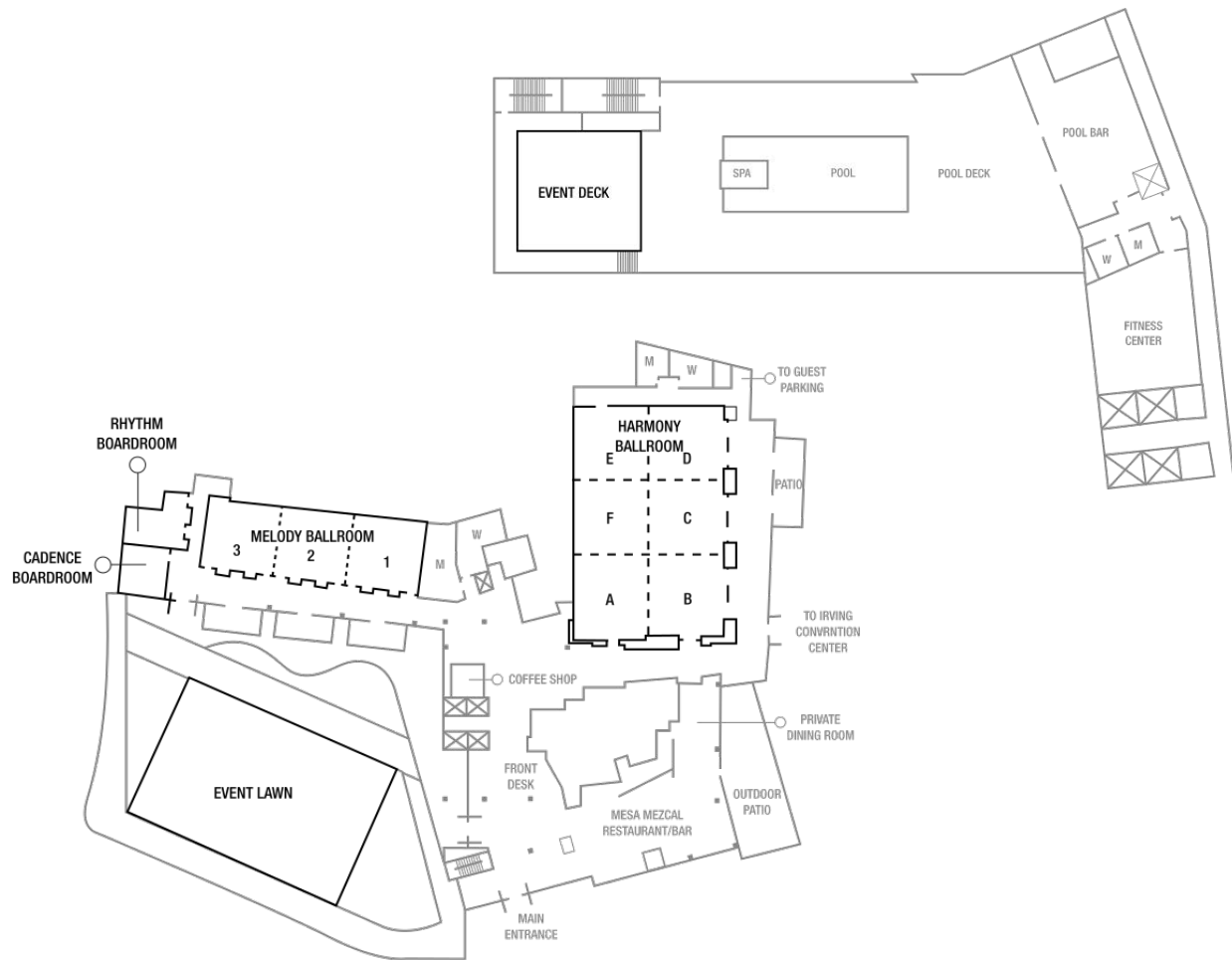

Meeting Room	L x W x H	Sq. Feet	Banquet	Theater	Conference	Reception	Classroom	U-Shape
Cadence Board Room	24 x 25 x 0	600	-	12	12	-	-	-
Rhythm Board Room	26 x 31 x 0	806	-	12	12	-	-	-
Pool Event Space	36 x 36 x 0	1,296	95	180	-	130	-	-
Melody 1	38 x 37 x 10.9	1,406	118	157	-	141	72	40
Melody 2	38 x 37 x 10.9	1,406	118	157	-	141	72	40
Melody 3	38 x 37 x 10.9	1,406	118	157	-	141	72	40
Harmony A	43 x 41 x 16	1,763	147	286	-	176	98	42
Harmony B	43 x 41 x 16	1,763	147	286	-	176	98	42
Harmony C	40 x 41 x 16	1,640	136	182	-	164	72	47
Harmony D	40 x 41 x 16	1,640	136	182	-	164	72	47
Harmony E	40 x 41 x 16	1,640	136	182	-	164	72	47
Harmony F	40 x 41 x 16	1,640	136	182	-	164	72	47
Harmony Prefunction Space	228 x 14.5 x 14	3,306	-	-	-	-	-	-
Melody 1 & 2	76 x 38 x 10.9	2,888	236	314	26	282	144	80
Melody 2 & 3	76 x 38 x 10.9	2,888	236	314	26	282	144	80
Melody Prefunction Space	14 x 170 x 12	2,380	-	-	-	-	-	-
Melody Junior Ballroom	114 x 37 x 10.9	4,218	354	471	-	423	216	120
Festival Lawn	120 x 79 x 0	9,480	648	1,260	-	1,450	585	176
Harmony Grand Ballroom	123 x 82 x 16	10,086	838	1,300	-	1,008	484	272