

BBC Radio 1 Big Weekend
Business and Residents Information Pack



<https://www.bbc.com/backstage/bigweekend/>

BBC Radio 1's Big Weekend is coming to Sefton Park, Liverpool, from Friday 23 May to Sunday 25 May 2025, bringing a massive weekend of incredible live music from a stellar line-up of UK and international artists.



Contents

Introduction	3
Key Messages for Businesses	4
Key Messages for Residents	5
Road Closure Information	6
Road Closure Map during Event Days	8
Road Closure Map during Site Build / Derig	9
List of Road Closure Maps Appendices	10
Contact Information	11
Frequently Asked Questions	12
Appendix 1	14
Appendix 2	15
Appendix 3	16
Appendix 4	17
Appendix 5	18
Appendix 6	19
Appendix 7	20

BBC Radio 1 Big Weekend 23-25 May

Introduction

Dear Resident / Business owner,

The aim of this information pack is to give you or your business as much information as possible ahead of the Radio 1 Big Weekend, so you are aware of any expected impacts and can prepare and plan accordingly.

Within this pack, you will find a map of the event site, details of road closures, travel advice, handy FAQ's and contact details should you have further queries.

There will be a 'Drop-in Session' taking place before the actual event; in this Drop-in Session, residents and local business owners will have the opportunity to talk directly to representatives from Liverpool City Council, the BBC and other key stakeholders involved in the organisation of the Radio 1 Big Weekend event.

For an event of this scale, plans can change for several reasons so please scan the QR code below, which will be kept updated and so will provide you with the most up to date Resident and Business information at any given time.



With best regards

All at Culture Liverpool



BBC Radio 1 Big Weekend 23-25 May

Key Messages for Businesses

Travel Messages

- Public transport will be much busier over the event weekend, which could have an impact on any employees you have scheduled to work.
- Please be sure to share the potential impacts with all your staff so they can plan their journey in advance and allow extra time for travelling.
- We encourage the use of public transport, and active travel such as walking and cycling.
- Visit www.merseytravel.gov.uk to check the latest travel information and arrangements.

Vehicle Movements

- Due to the number of road closures that will be in place in the areas surrounding Sefton park, vehicle movements will be **significantly restricted**.
- We strongly advise against driving any vehicles to Sefton Park and the surrounding areas, where avoidable.
- If vehicle access is unavoidable, you should allow plenty of time and **expect severe delays** in being able to access or egress Sefton Park and the surrounding area.
- Vehicle access/ egress is expected to be particularly difficult between 21.45 and 22.45 each evening as this is when the show ends, and large crowds will be disseminating. It would be prudent to plan any journeys outside of this time wherever feasible.

Hospitality venues

- Whenever major events take place in the city, food and drink outlets prove to be incredibly popular; as a local business, make sure you have enough stock to meet demand and enough staff on hand to deal with the increased footfall.
- If you are hosting a private event or function during Radio 1 Big Weekend, please ensure invited guests and attendees are aware of the potential disruption and make sure they know to allow for more travel time.

Deliveries

- Please arrange for all deliveries to take place before 9.30am each day. If this is not feasible, please let us know via Bigweekend@liverpool.gov.uk

Noise Management and Soundchecks

- The BBC are working closely with Liverpool City Council to minimise disturbances to local residents; a resolute noise management team will be in place, and a helpline will be available for residents to report any issues.
- There will be scheduled soundchecks taking place ahead of the Radio 1 Big Weekend 2025. Whilst the timings are yet to be confirmed, they typically take place during daylight hours, in the days immediately leading up to the event.
- You can find the latest information regarding sound checks by scanning the QR code provided in this Information Pack.

BBC Radio 1 Big Weekend 23-25 May

Key Messages for Residents

Liverpool has developed a strong record of delivering major outdoor events over the past 20 years both in Sefton Park and across the city, including high-profile occasions such as Giant Spectacular, Cream and most recently the Eurovision Song Contest.

We strive to minimise disruption to residents and businesses, as far as is reasonably practicable and are confident that by working collegiately with all our partners, the event will be delivered successfully.

We've provided some key information below, and you'll find some Frequently Asked Questions towards the end of this Information Pack – these FAQ's will continue to evolve so please scan the QR code provided to check the latest information.

Restricted Areas

The BBC aim to minimise disruption as much as possible for regular users of Sefton Park and will therefore be deploying a phased occupation approach during the event build phase.

The park is an extensive 200-acre space, and the event will use approximately 25% of the park. Whilst areas of the park will be temporarily restricted during event set-up, event delivery and event de-rig, 75% of the park will remain accessible for public use in the usual way.

Cleansing Plan

A comprehensive cleansing plan will be in place in Sefton Park before, during, and after Radio 1's Big Weekend.

Daily maintenance teams will manage litter, waste, and recycling, helping preserve the park's beauty throughout the festival period and to ensure the park remains clean, safe, and enjoyable for everyone visiting.

The cleansing plan may take place at night and may continue in the early hours of the morning; this phased approach ensures the park is clean and tidy for park users during core daylight hours, without disturbing local residents too much at unsociable hours.

Road closure information

Parking

There will be **no parking** in and around Sefton Park for event ticketholders or visitors.

Visitors are encouraged to use public transport and the event shuttle buses.

Enforcement teams will be on duty throughout the weekend to discourage any nuisance parking.

Road closures

There will be several road closures around the northern end of the park, near the entrance point known locally as the 'Obelisk' (Needle). The road closure will span from Aigburth Drive, at the junction of Livingston Drive South, clockwise to Greenbank Lane (Green Gate).

There will be a signed diversion to assist non-event traffic from: Ullet Road, Parkfield Road, Aigburth Road to Aigburth Drive and in the opposite direction: Ullet Road, Smithdown Road to Greenbank Road.

For people wishing to access Lark Lane, a diversion route will be in place from Aigburth Drive, Livingston Drive South and Hargreaves Road.

Access to Sefton Park for general public will be from Queens Drive, Elmswood Road and Aigburth Road, close to the boating lake.

Date	Summary of General Closures
8 th May (am) to 2 nd June (pm)	Closure of Croxteth Drive from Aigburth Drive (Obelisk/Needle to Croxteth gate Roundabout and Car Park)

19 th May (am)	Closure of Greenbank Car Park, Livingston Drive North Car Park
22 nd May (pm) to 26 th May (pm)	Closure of Mossley Hill Drive from Croxteth Drive (St Hilda's) to Greenbank Drive/Greenbank Lane
23 rd May to 25 th May (Live Event Days)	Closure of car parks at boating lake and Queens Drive / Iron Bridge to provide Blue Badge parking for regular park users
23 rd May to 25 th May (Live Event Days)	Restricted access/road closure Ullet Road/Sefton Park Road/Aigburth Drive (into the park)
23 rd May to 25 th May (Live Event Days)	Restricted access / road closure Ullet Road/Croxteth Gate (into the park)
23 rd May to 25 th May (Live Event Days)	Restricted access/road closure Greenbank Drive/Croxteth Drive
23 rd May to 25 th May (Live Event Days)	Restricted access/road closure Greenbank Road/Greenbank Lane
23 rd May to 25 th May (Live Event Days)	At approx. 22.00hrs each day, there will be a brief closure of Lark Lane, from Lark Way/ Hargreaves Road towards and including Linnet Lane and Livingston Avenue. This may also be implemented at any time, should the Event Safety Officer deem it necessary, if the volume of pedestrians is considered too high to be mixing with vehicles.

Road Closure Map during Event Days - restrictions and diversions around the park from Friday 23 - Sunday 25 May 2025

The amber highlighted area will be closed to general traffic and is for resident access only. Some access points are from one end only - please see appendices below to check your specific road. The blue highlighted area is the outer diversion around the park. This will be signed to assist non-event traffic from: Ullet Road, Parkfield Road, Aigburth Road to Aigburth Drive and in the opposite direction: Ullet Road, Smithdown Road to Greenbank Road.

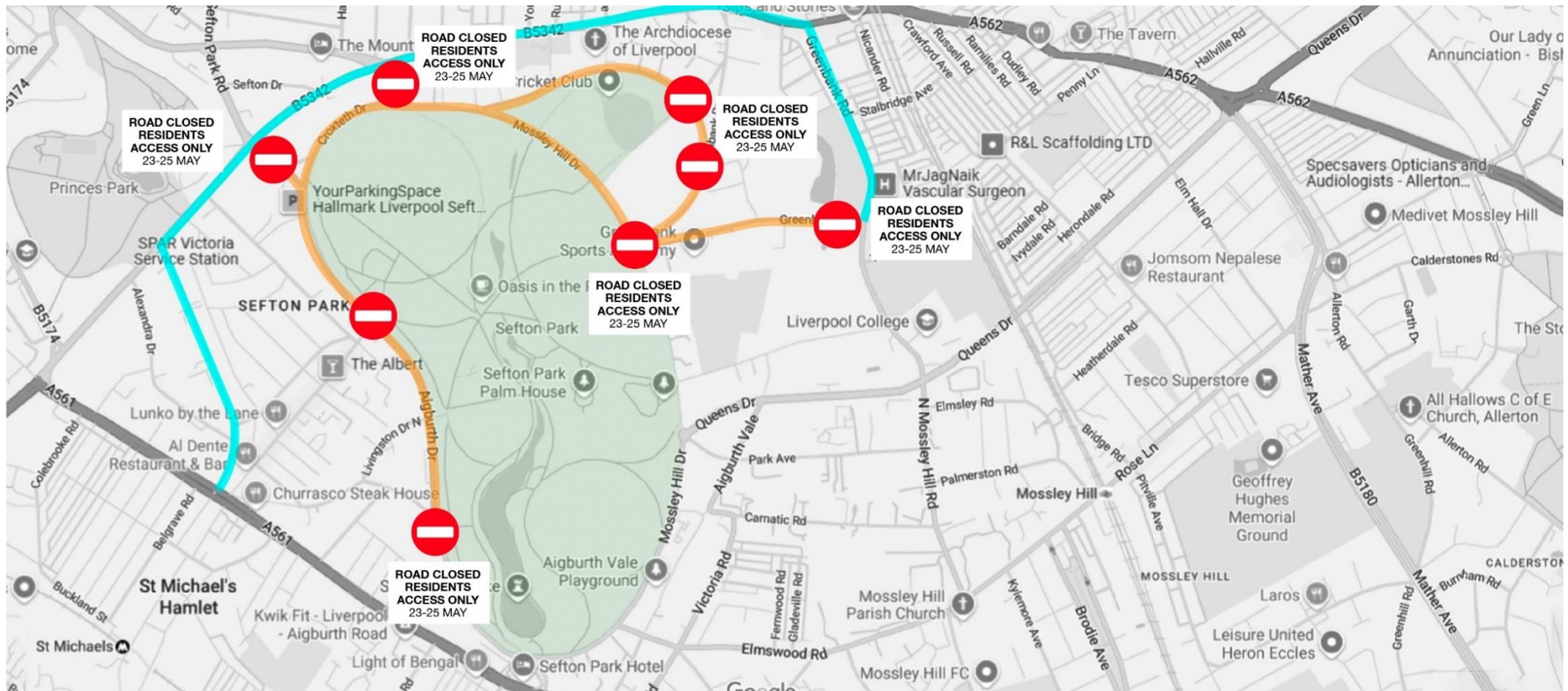

— Road Closed - Resident Access Only — Outer Diversion

Road closure map during Site build and De-rig – in place from the 8 May to 2 June 2025

Croxteth Drive will be closed from Aigburth Drive to Croxteth Gate including Croxteth Gate Car Park.



— Road Closed - No Access

Vehicle Access for Residents and Business Owners

Please refer to the relevant appendices for your specific area, shown at the end of this information pack.

Resident access will be maintained in the areas listed below; Traffic Management Stewards will be located at each road closure point.

Vehicle Passes

Residents affected by the road closures in Appendix 1-7 will require a Vehicle Pass - these can be collected from the Traffic Stewards located at the junction of Aigburth Drive/Croxteth Drive, close to the Obelisk/Needle.

Vehicle Passes will be available for collection from Monday 12th May- Thursday 22nd May, between 08.00-20.00

Appendix	Details
Appendix 1	Lark Lane business and residents access Friday 23 May – Sunday 25 May 2025.
Appendix 2	Appendix 2 - Aigburth Drive from Ullet Road to Lark Lane business and residents access Friday 23 May – Sunday 25 May 2025.
Appendix 3	Residents of number 4 Croxteth Drive (Sefton Park Studios) Thursday 8 May – Monday 2 June 2025.
Appendix 4	Residents of Aigburth Drive Numbers 14 to 18 between Lark Lane and Livingston Drive North - additionally the properties from 19 Aigburth Drive to 23 Aigburth Drive - Friday 23 May – Sunday 25 May 2025.
Appendix 5	All businesses and residents on Greenbank Lane, residents of number 1-7 Mossley Hill Drive and all residents in Ibbotson's Lane. Also access to allotments on Greenbank Drive Friday 23 May – Sunday 25 May 2025.
Appendix 6	Croxteth Drive From St Hilda's to Greenbank Drive including residents in Buckingham House, York House, Rutland House, Sherry Court, and Sefton Park Cricket Club Friday 23 May – Sunday 25 May 2025.
Appendix 7	Brompton House and Sydenham House access. Friday 23 May – Sunday 25 May 2025.

BBC Radio 1 Big Weekend 23-25 May

Contact Information

Should you have any specific queries that are not addressed within this Information Pack, you can contact the Culture Liverpool events team at:

E-mail	bigweekend@liverpool.gov.uk
Postal address	Liverpool City Council, 3rd floor, Cunard Building, Water Street, Liverpool L3 1AH
Hotline (live event days only)	<p>There will be an event hotline available.</p> <p>During the event build and event de-rig phase, the hotline will be available from: 08.00 – 20.00</p> <p>During the Live Event days on Friday 23 May, Saturday 24 May and Sunday 25 May , this hotline will be available from: 08.00 to 23.00</p> <p style="text-align: center;">The Hotline number is: 0203 475 0716</p>

BBC Radio 1 Big Weekend 23-25 May

Frequently Asked Questions

Question	Answer
Who is organising this event?	Radio 1's Big Weekend is organised by the BBC, in partnership with Liverpool City Council.
What are the dates of the event?	Friday 23 May Saturday 24 May Sunday 25 May 2025.
What time does the event start and finish?	Friday 23 May 14.00 – 22.00 Saturday 24 May 11:00 – 22.00 Sunday 25 May 11:00 – 22.00
What is the capacity at the event?	General Admission capacity will be 34,500 per day plus guests, performers and working crew working to the Premises Licence capacity of 39,999
Why Liverpool?	Liverpool is the perfect choice to host Radio 1 Big Weekend – it's a city renowned for its music, its heritage, one of the best audiences around and has a global reputation for staging incredible outdoor events. The event also forms part of Liverpool's United Nations Accelerator City year.
What is UN Accelerator City?	As of November 2024, Liverpool was declared the first ever UN Accelerator City for Climate Action. This means the city has one year to pilot a series of exciting, boundary-pushing initiatives to look at how to make music events and TV/film productions as sustainable as possible. BBC and Liverpool City Council will work together to try and make Radio 1 Big Weekend, the most sustainable outdoor live music event ever produced in the city. This supports the BBC's existing Sustainability Programme and Liverpool City Council's climate action objective.
What will you do to manage nuisance	Parking Enforcement officers will be in attendance to discourage nuisance parking

<p>parking around Sefton Park</p>	<p>As part of our commitment to make this event as sustainable as possible, we are actively encouraging festival goers to use public transport and make the most of active travel i.e. walking and cycling.</p> <p>We are working with Merseytravel to provide electric shuttle buses to and from the event.</p> <p>Our traffic management plan is designed to prioritise residents, and it discourages people from bringing vehicles to the park.</p>
<p>Are you providing shuttle buses to and from the event?</p>	<p>We are working with Merseytravel who will provide electric shuttle buses to and from the event.</p> <p>Shuttle buses will run from Great Charlotte Street/ Elliot Street (near to Lime Street Station) to and from the park prior to the event.</p> <p>This shuttle bus service will be strengthened at the end of the event to facilitate the egress of ticket holders to the city centre, until the park is empty.</p>
<p>Will there be parking for ticketholders?</p>	<p>There will be no parking in and around Sefton Park, and robust parking enforcement will be in place across the three event days.</p> <p>People are advised to travel by public transport to the event. If car travel is essential, use city centre car parks and use the excellent train and bus links to the park.</p>
<p>What about noise / disturbance from the event?</p>	<p>The event will operate under the existing Premises Licence for Sefton Park and will adhere to the conditions of the licence.</p> <p>The event will operate within the licensed noise parameters and a resolute noise management plan will be in place; however, the dedicated Hot line is available should residents wish to raise concerns during the event.</p>
<p>How do I contact the organisers?</p>	<p>Full event information for ticket holders can be found here: www.bbc.co.uk/bigweekend.</p> <p>For any queries from local residents or businesses, please contact: bigweekend@liverpool.gov.uk</p>

Appendix 1

Lark Lane business and residents access Friday 23 May – Sunday 25 May 2025

Access to Lark Lane from Aigburth Road, Parkfield Road and Lark Way open as usual but can only exit via Linnet Lane throughout the event days. At the end of the event each evening, there will be a short closure of Lark Lane to vehicles to allow the safe egress of pedestrians from the event.

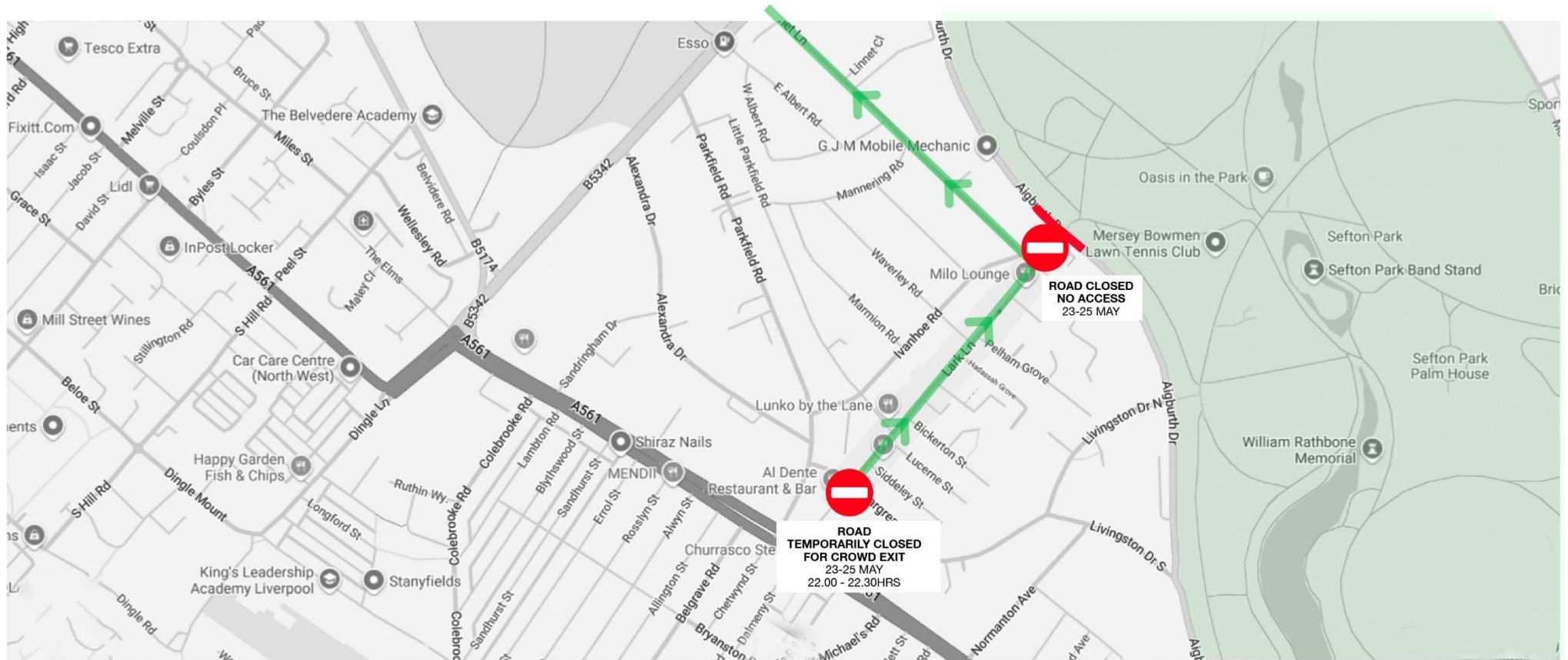

— Road Closed - No Access

— Road Open for Access

Appendix 2

Aigburth Drive from Ullet Road to Lark Lane Business and Residents access Friday 23 May – Sunday 25 May 2025.

To include residents of Belem Tower and properties along Aigburth Drive from Ullet Road to Lark Lane (numbers 3-8) and access to Bellerive 6th Form College.

Access will only be available from the junction of Ullet Road to number 8 Aigburth Drive, which is prior to the junction of Lark Lane. There is no vehicle access to Lark Lane beyond this point.

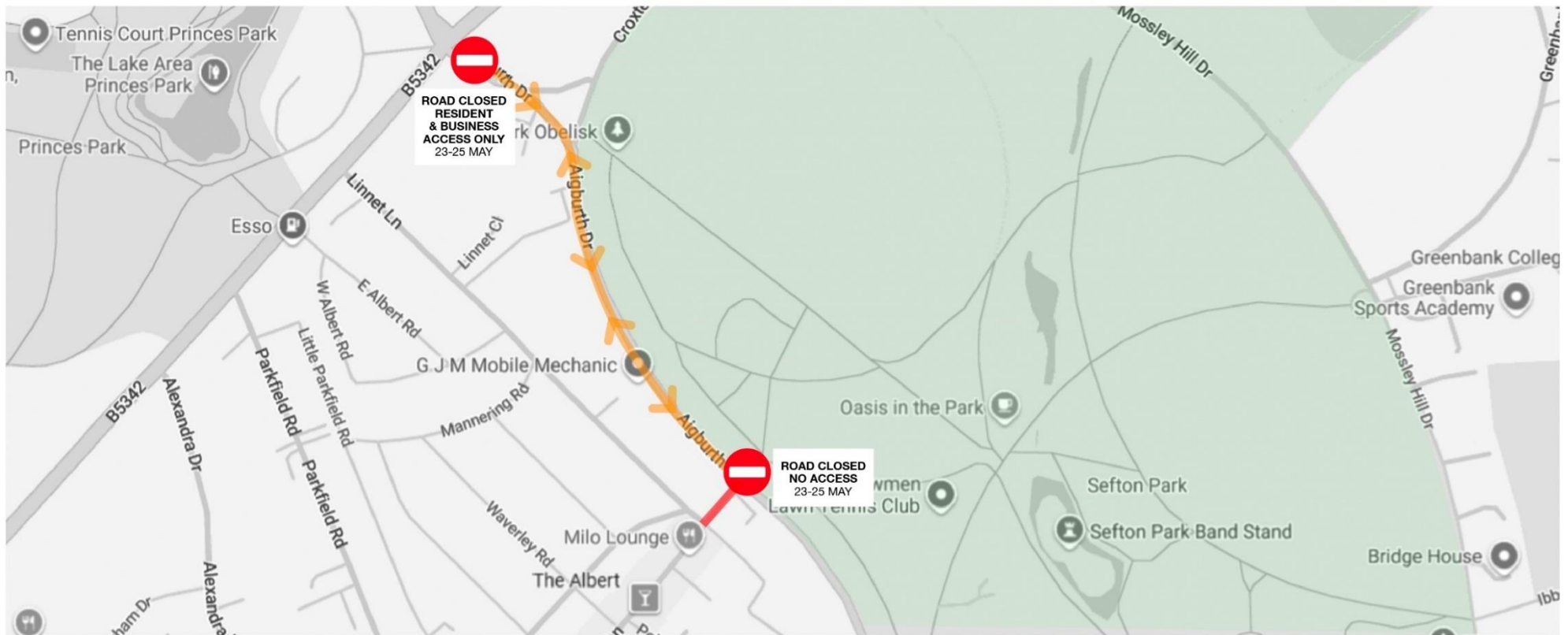

— Road Closed - No Access — Road Closed - Resident & Business Access Only

Appendix 3

Residents of number 4 Croxteth Drive (Sefton Park Studios) 8 May – 2 June 2025.

Access and exit via Croxteth Gate only.



— Road Closed - No Access

— Road Closed - Resident & Business Access Only

Appendix 4

Residents of Aigburth Drive Numbers 14 to 18 between Lark Lane and Livingston Drive North - additionally the properties from 19 Aigburth Drive to 23 Aigburth Drive. Friday 23 May – Sunday 25 May 2025.

Access will only be from Livingston Drive South.

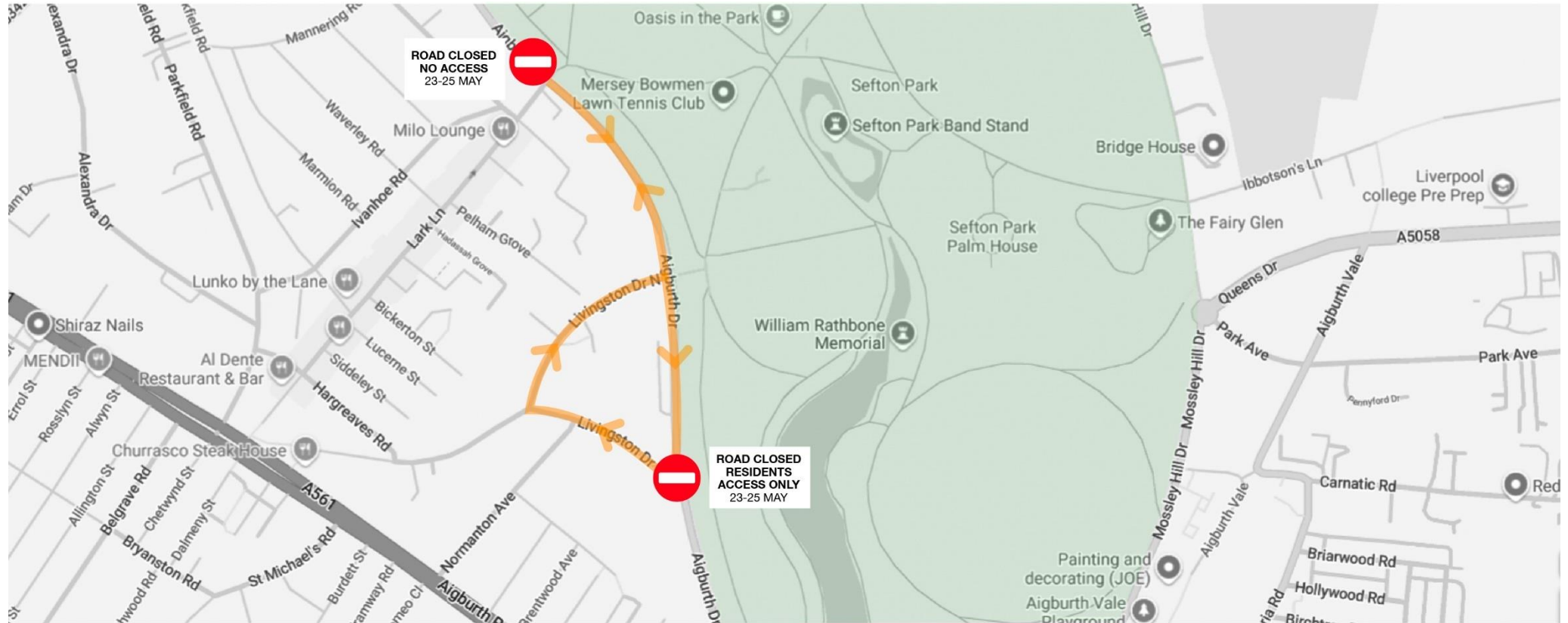

— Road Closed - No Access

— Road Closed - Resident & Business Access Only

Appendix 5

Residents and businesses in Greenbank Lane and residents of number 1-7 Mossley Hill Drive and all residents in Ibbotson's Lane. Access will only be via Greenbank Drive or Greenbank Lane. Allotments access as usual via Greenbank Drive

Friday 23 May – Sunday 25 May 2025.

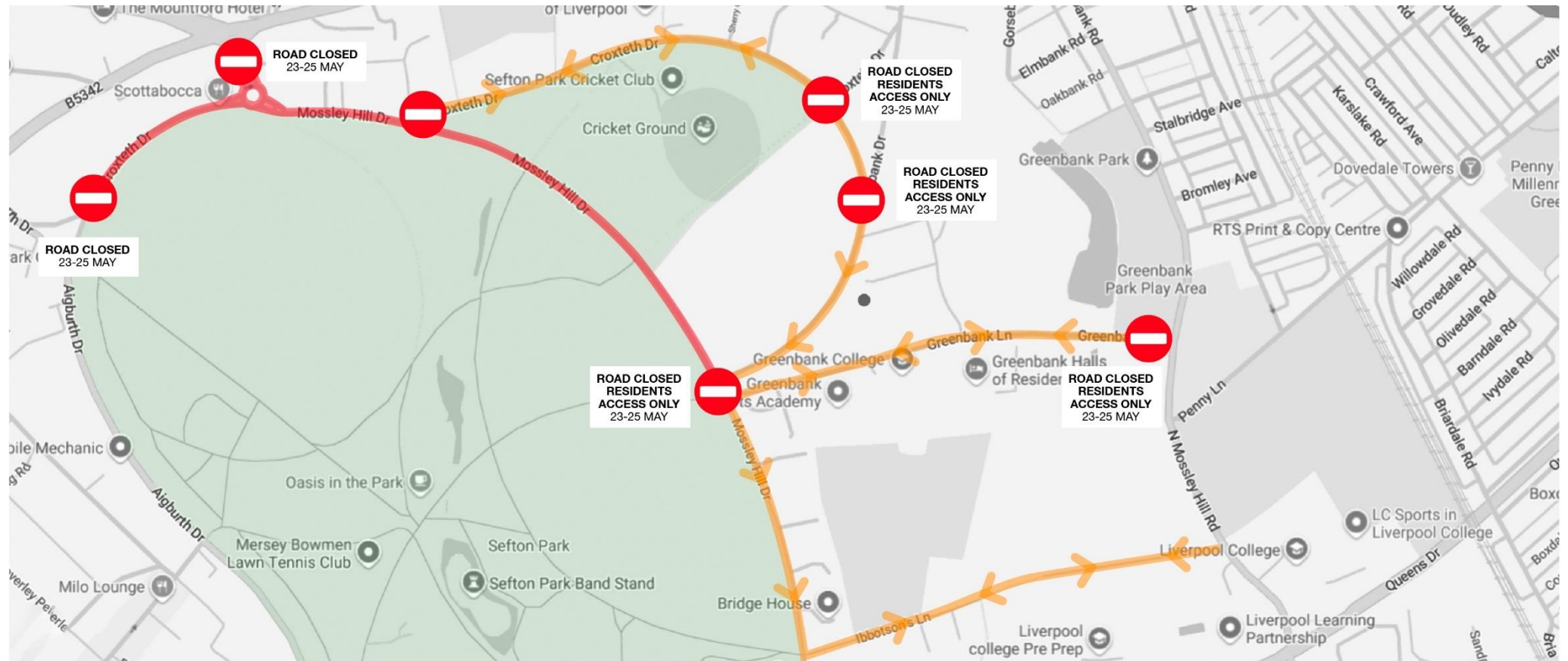

— Road Closed - No Access

— Road Closed - Resident & Business Access Only

Appendix 6

Croxteth Drive from St Hildas to Greenbank Drive including residents in Buckingham House, York House, Rutland House, Sherry Court, and Sefton Park Cricket Club.

Access and exit from Greenbank Drive/Croxteth Drive only. Friday 23 May – Sunday 25 May 2025.

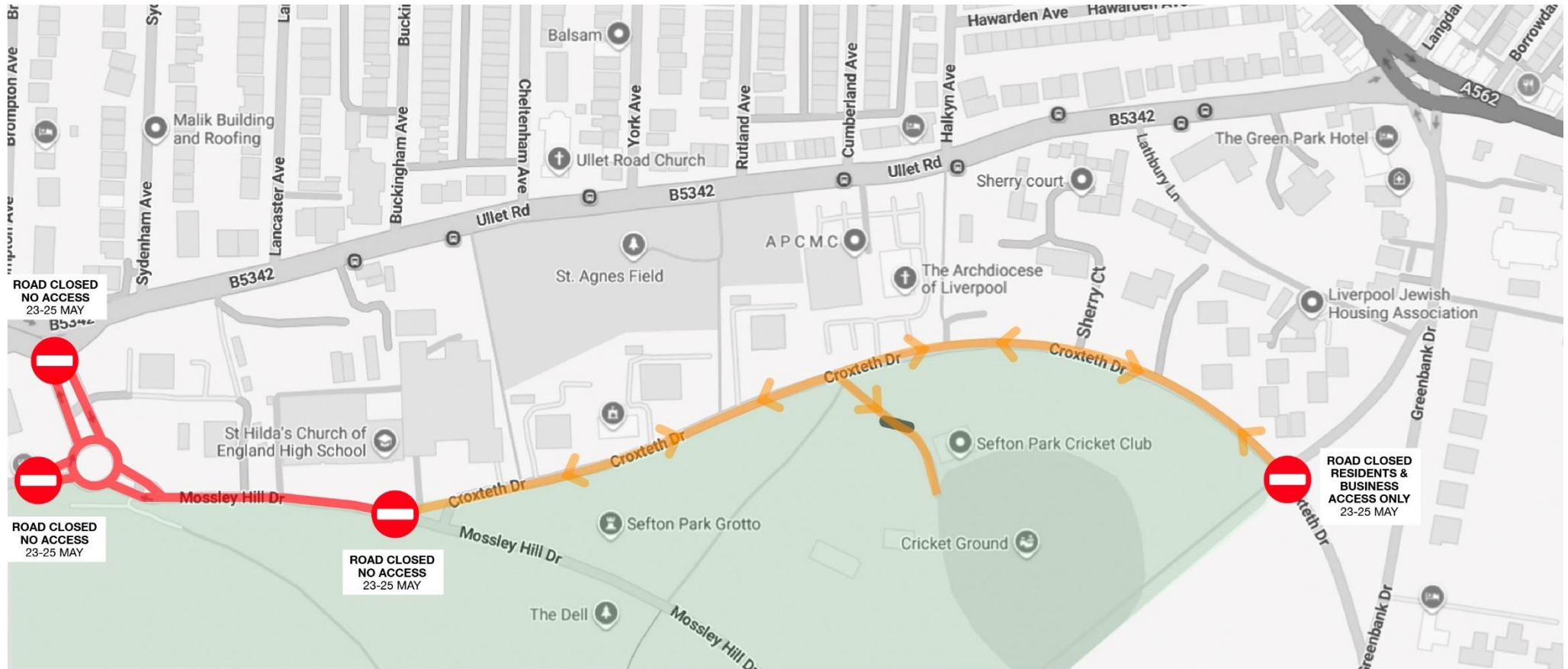

— Road Closed - No Access

— Road Closed - Resident & Business Access Only

Appendix 7

Brompton House access via Ullet Road at Croxteth Gate and exit same way Croxteth Gate Ullet Road.

Sydenham House access via Ullet Road at Croxteth Gate exit via Croxteth Drive /Greenbank Drive.

Friday 23 May – Sunday 25 May 2025.

