



MEET IN
Manhattan ^{KS}



TABLE OF CONTENTS

We're close to everything.....	3
Hilton Garden Inn	4
Four Points by Sheraton	6
Holiday Inn at the Campus	8
Bluemont Hotel	10
Comfort Suites	12
Fairfield Inn	12
Holiday Inn Express & Suites	13
Courtyard by Marriott	13
Parkwood Inn & Suites	14
Super 8 Motel	14
Best Western	15
Quality Inn	15

Candlewood Suites	15
Flint Hills Discovery Center	16
Sunset Zoo	18
Wareham Opera House	19
K-State Alumni Center	20
K-State Student Union	22
McCain Auditorium	24
Midwest Dream Car Collection	25
10 Reasons to Meet in Manhattan	26
FlyMHK	27

For a complete list of meeting venues and hotels
visit our website VisitManhattanKS.org.



WE'RE CLOSE TO **EVERYTHING**



DRIVING DISTANCES TO MANHATTAN

Topeka, KS	50 minutes
Kansas City, KS	2 hours
Wichita, KS	2 hours
Lincoln, NE	2.5 hours
Omaha, NE	3 hours
Oklahoma City, OK	4 hours, 40 minutes
St. Louis, MO	6 hours
Denver, CO	7 hours

Hilton Garden Inn & Manhattan Conference Center

410 South 3rd Street
Manhattan, KS 66502

785-532-9116

www.manhattanconferencecenter.com

www.manhattanks.hgi.com



The Hilton Garden Inn and Manhattan Conference Center welcome the opportunity to host your next meeting. Our 32,000 sq.ft. Conference Center provides the opportunity to design the meeting layout that works best for you. Customize your conference meals and audio visual with our onsite event planning team. Complimentary parking garage is attached to the Conference Center along with courtesy Wi-Fi throughout plus a 24-hour business center. Guests can also take advantage of our fitness center, Jacuzzi and indoor pool. Our restaurant serves breakfast, dinner, evening room service and cocktail service. We are steps away from the Flint Hills Discovery Center and downtown Manhattan, ideal for your attendees to enjoy.



Hilton Garden Inn Manhattan Conference Center

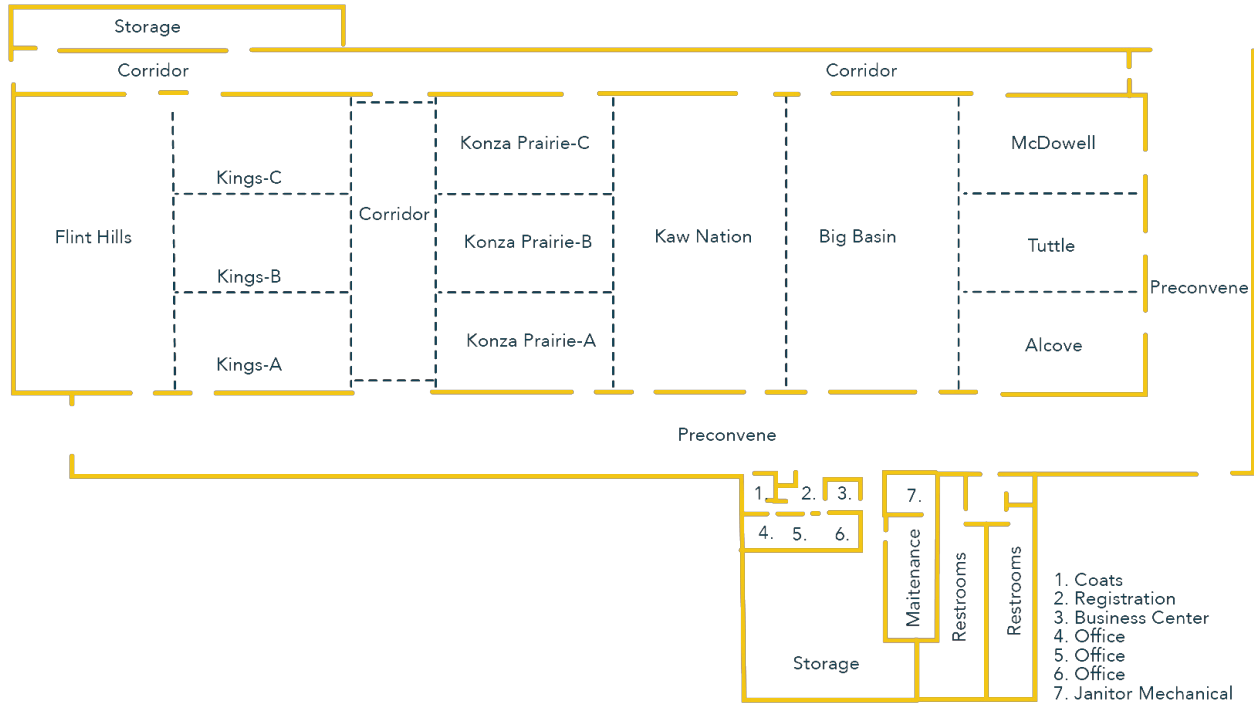

Rooms	Sq.Ft.	Ceiling	Rounds	Theatre	Conference	Reception	Classroom	U-Shape
Hotel								
Little Apple	459	11	-	-	12	-	-	-
Big Blue River & Fort Riley	1,530	11	64	110	36	150	54	42
Big Blue River	750	11	32	50	18	75	24	24
Fort Riley	750	11	32	50	18	75	24	24
Conference Center								
Manhattan Grand Ballroom	24,406	23	1,152	1,914	-	2,270	1,122	-
Manhattan Grand Ballroom Foyer	7,800	23	-	-	-	-	-	-
McDowell	1,225	23	60	100	36	125	48	36
Tuttle	1,325	23	60	100	36	130	48	36
Alcove	1,325	23	60	100	36	130	48	36
Big Basin	3,736	23	240	272	-	375	156	69
Kaw Nation	3,736	23	240	272	-	375	156	69
Konza Prairie A	1,272	23	60	100	36	130	48	36
Konza Prairie B	1,296	23	60	100	36	130	48	36
Konza Prairie C	1,272	23	60	100	36	130	48	36
Kings A	1,272	23	60	100	36	130	48	36
Kings B	1,296	23	60	100	36	130	48	36
Kings C	1,272	23	60	100	36	130	48	36
Flint Hills	3,378	23	192	272	-	375	156	69
Ballroom 2	7,234	23	384	624	-	745	429	-

Four Points by Sheraton

530 Richards Drive
Manhattan, KS 66502
785-539-5311
www.fourpoints.com/manhattan



Surrounded by the Scenic Flint Hills of KS, the Four Points by Sheraton Manhattan has the largest number of hotel rooms featuring 197 guestrooms and over 20,000 sq.ft. of flexible meeting space. Our professional staff is dedicated to make your stay enjoyable. We accommodate groups of all sizes, offer exclusive group rates, provide in-house catering and AV rental making it a breeze to plan your next event. Enjoy dining at our on-site restaurant which serves fresh favorites for breakfast and dinner as well as great drinks from our local breweries. Stay active at our 24 hour fitness center and relax in our indoor swimming pool and hot tub. We welcome your furry family as well and look forward to making your stay memorable.



Four Points by Sheraton Conference Center

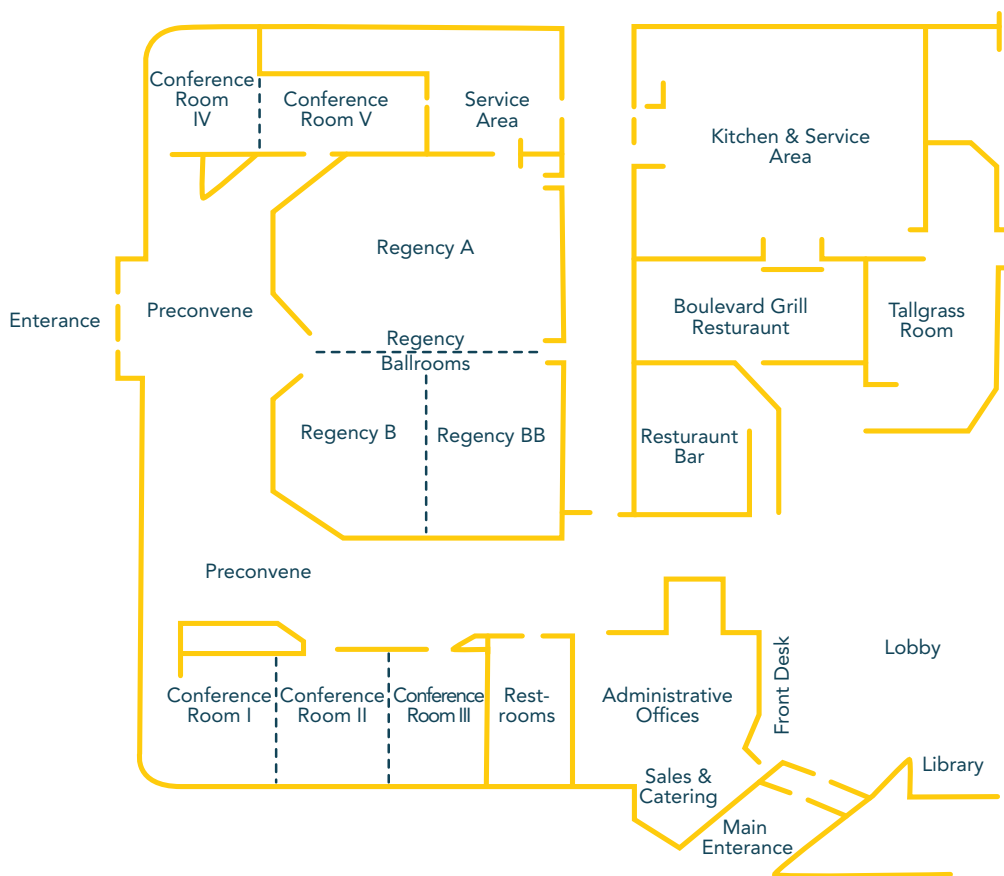

Rooms	Sq.Ft.	Ceiling	Rounds	Theatre	Conference	Reception	Classroom	U-Shape
Regency Ballroom	6,800	12'	550	850	-	700	400	40
*Regency A	3,401	12'	250	300	20	350	180	20
*Regency B	3,401	12'	250	300	20	350	180	20
**Regency BI	1700	12'	80	150	20	100	80	20
**Regency BII	1700	12'	80	150	20	100	80	20
Conference I	660	9'	30	35	20	40	24	12
Conference II, III, each	660	9'	30	40	20	45	28	12
Conference IV	551	9'	30	40	20	35	28	12
Conference V	1160	9'	60	70	30	65	50	15
Conference I & II	1320	9'	60	70	20	80	50	-
Conference IV & V	1711	9'	100	120	30	120	70	30

Holiday Inn at the Campus

1641 Anderson Avenue
Manhattan, KS 66502
785-539-7531
800-962-0014
www.holidayinn.com



Holiday Inn®

All 113 spacious guest rooms include free wireless high speed internet, 42" flat panel TV's, ample work space, plush triple sheeted pillow top beds, access to outdoor pool and 24-hour fitness and business centers. Whether you are having a 500 person reception or a meeting for 10, we have the space and staff to accommodate you. With seven meeting rooms and over 9,000 sq.ft. of meeting space, our professional sales and banquet teams will customize and execute your memorable event. Enjoy a "made-from-scratch" meal in Houlihan's, our on-site restaurant.



Holiday Inn at the Campus Meeting Space

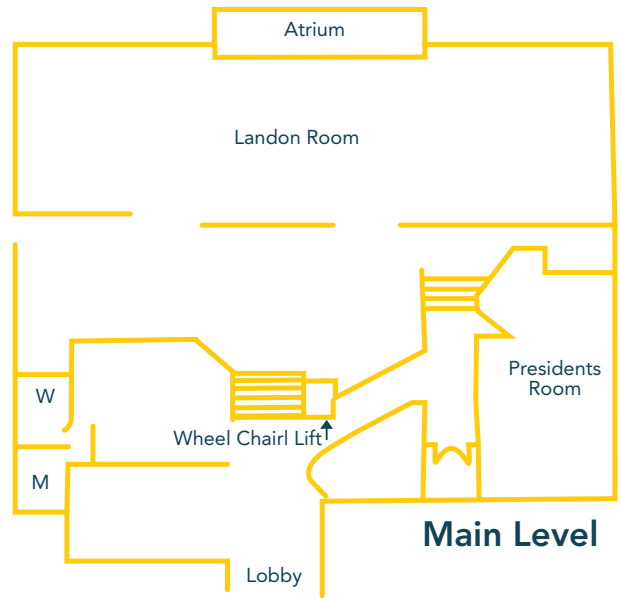
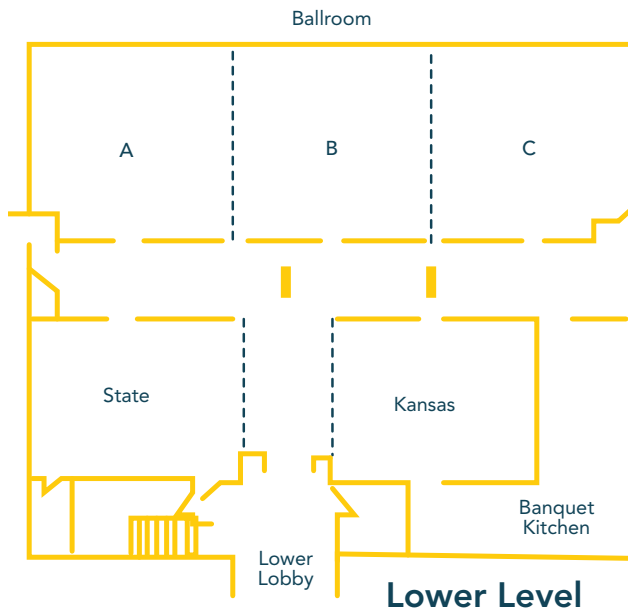

Rooms	Sq.Ft.	Ceiling	Rounds	Theatre	Conference	Reception	Classroom	U-Shape
Ballroom	5727	10-12'	350	400	-	500	200	-
*Ballroom A	750	12'	60	80	22	100	45	33
*Ballroom B	750	12'	60	80	22	100	45	33
*Ballroom C	750	12'	60	80	22	100	45	33
*State	702	10'	80	80	22	75	45	33
*Kansas	702	10'	80	80	22	75	45	33
Landon	2490	10'	200	275	-	300	200	-
Presidents	1104	10'	56	60	22	50	38	20

Bluemont Hotel

1212 Bluemont
Manhattan, KS 66502
785-473-7091
www.bluemonthotel.com

BLUEMONT
EST. HOTEL 2014

The Bluemont Hotel offers 112 luxurious guest rooms with over 7,000 square feet of event space, centrally located in the heart of Manhattan. This property features 50 suite-style rooms, free WiFi and complimentary breakfast. The main floor includes a lobby bar, business center, indoor pool and fitness center. All event space is located on the 5th floor and serviced with food through local caterers, and bar service through the hotel staff. At the corner of Bluemont and Manhattan Avenue, guests have easy access to historic Aggieville and Kansas State University.



Bluemont Hotel Meeting Space

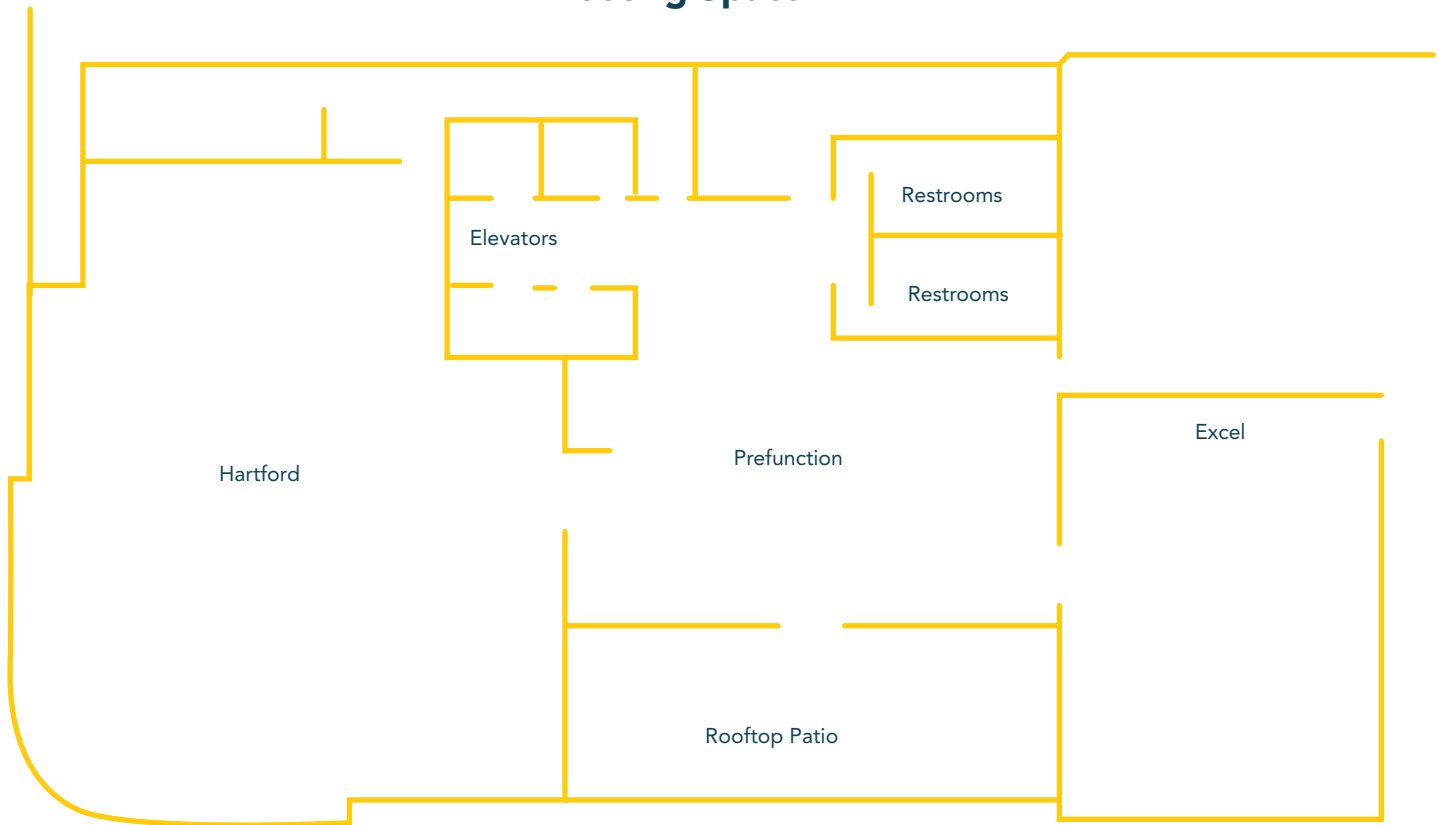

Rooms	Sq.Ft.	Ceiling	Rounds	Theatre	Conference	Reception	Classroom	U-Shape
Hartford	3456	11'	200	300	60	300	150	-
Excel	1344	11'	80	120	40	120	60	30
Prefunction	1344	-	-	-	120	-	-	
Rooftop Patio	768	-	-	-	-	-	-	
Boardroom	273	8.5'	-	10	-	-	-	

Comfort Suites

1020 Hostetler Drive
Manhattan, KS 66502
785-539-9449
www.comfortsuites.com/hotel/ks142



Whether traveling for business or pleasure, Comfort Suites provides numerous amenities, inviting accommodations and great service. This all-suite hotel is close to area attractions like Kansas State University, the Flint Hills Discovery Center, and Fort Riley.

Comfort Suites offers a state of the art projection setup in their meeting room. Connection points are available, as well as wireless internet connections.

Meeting Room	Room Size	Square Feet	Ceiling Height	Reception	Seating Capacity		
					Rounds	Theater	Classroom
Meeting Room		1,625			32	40	30

Fairfield Inn by Marriott

300 Colorado Street
Manhattan, KS 66502
785-539-2400
www.fairfieldinn.com



Treat yourself to the perfect blend of comfort and convenience at Fairfield Inn Manhattan. Whether on business or leisure, you'll love retreating to relaxation in our spacious guest rooms featuring, mini-refrigerators, microwaves and luxurious bedding. Rooms also feature an ergonomic workspace, free Wi-Fi, and 50" TV with streaming services that include Netflix, Pandora and more. Each morning fuel up on a variety of hearty and healthy favorites from our free hot breakfast, kick-start your day with a workout in our modern fitness center. Our hotel also features an indoor pool and 24 hour business center. At Fairfield Inn Manhattan, you're our #1 priority.

Holiday Inn Express & Suites

115 Blue Earth Place
 Manhattan, KS 66502
 800-465-4329
www.holidayinnexpress.com



The newest Holiday Inn addition to Manhattan and the Flint Hills is the Holiday Inn Express and Suites. HI Express offers a small board room with seating for up to 10-12, and access to the business center. The Express and Suites offers 78 guest rooms, indoor pool and workout room. The adjacent Blue Earth Plaza is a great draw for lunches or outdoor exercise. Locally-owned Radina’s Bakehouse is right around the corner and offers a healthy menu of selections. Holiday Inn Express is located within walking distance of the Manhattan Conference Center.

Meeting Room	Room Size	Square Feet	Ceiling Height	Reception	Seating Capacity	Seating Capacity	Classroom
Board Room					Banquet	Theater	30

Courtyard by Marriott

Bluemont & N. 12th St.
 Manhattan, KS 66502
 785-587-1972
www.marriott.com



Manhattan’s newest hotel is located in the heart of Aggieville, offering 121 guest rooms, each room equipped with a micro/fridge unit. The Courtyard features a Bistro restaurant with a full bar, serving breakfast and dinner. The hotel offers roof top seating. The hotel has a 1,000 sq. ft. meeting room, perfect size for groups 40 and under. Our location means guests are right in the middle of town and close to everything – Aggieville, Kansas State University. Enjoy our comfortable parking garage.

Meeting Room	Room Size	Square Feet	Ceiling Height	Reception	Seating Banquet	Capacity Theater	Classroom
Meeting Room	44'x25'	940	10'	40	40	40	25

Parkwood Inn & Suites

505 South 17th
Manhattan, KS 66502
785-320-5440



Parkwood Inn & Suites is a local, independent boutique style hotel featuring 75 guest rooms, all with a Serta Memory Foam mattress, refrigerators, microwaves and Keurig coffee makers. Our Longview Conference Room, featuring state of the art AV equipment is available through our sales department for up to 60 persons. Our complimentary hot breakfast buffet includes continental selections and borders our fireplace for cold mornings and or our patio for enjoyable outdoor days. Visit Trip Advisor and our Facebook page for additional information. We look forward to sharing our Midwestern hospitality with you and serving your hotel needs while in Manhattan.

Meeting Room	Room Size	Square Feet	Ceiling Height	Reception	Seating Capacity		Classroom
					Banquet	Theater	
Meeting Room		940			40	60	

Super 8 Motel

200 Tuttle Creek Boulevard
Manhattan, KS 66502
785-537-8468, 800-800-8000
www.super8.com



The Manhattan Super 8 features 85 clean, comfortable guest rooms at affordable prices. For small meetings and special events, the Blue River Meeting Room is the perfect place to accommodate meetings from 5 to 100 people. Whether visiting for business or pleasure, Super 8 staff will ensure the success of your event and the comfort of your guests. Other business services include meeting breaks with coffee, tea or water, informal snacks and treats, free local phone calls, fax/copy service and several out-of-house catering options.

Meeting Room	Room Size	Square Feet	Ceiling Height	Reception	Seating Capacity		Classroom
					Rounds	Theater	
Blue River Meeting Room	49' x 28'	1625	8'	118	100	125	100

Best Western

601 E. Poyntz Avenue
Manhattan, KS 66502
785-537-8300
www.bestwestern.com

Offers 45 guest rooms, complimentary breakfast.
Ideal for your overflow needs.



Quality Inn

150 E. Poyntz Avenue
Manhattan, KS 66502
785-770-8000
www.qualityinn.com

Offers 66 guest rooms, complimentary breakfast.
Ideal for your overflow needs.



Candlewood Suites Manhattan

115 Blue Earth Plaza
Manhattan, KS 66502
785-320-7454
www.candlewoodsuites.com

Offers 93 extended stay guest rooms. Located just a short walk from downtown, the Manhattan Conference Center and right next door to the Flint Hills Discovery Center.



Flint Hills Discovery Center

315 S. 3rd Street
Manhattan, KS 66502
785-587-2726
www.flinthillsdiscovery.org



Host your next event at the Flint Hills Discovery Center, a unique event venue offering indoor and outdoor rental spaces nestled in downtown Manhattan, KS. With several hotels within walking distance and free parking, our venue ensures the ultimate convenience for your guests. Enjoy breathtaking views from our rooftop terrace, explore ever-changing exhibits, and experience the grandeur of the glass atrium. No matter your event, you will find the Flint Hills Discovery Center the ideal venue. Perfect for weddings, receptions, military events, birthdays, anniversary parties, business meetings, retirement receptions, bridal and baby showers, graduation parties and more.



Full Building

(both floors of exhibits and
Prairie Garden Terrace)
240 seated (throughout building)
500 standing

Exhibit Space

(first and second floors)
200 seated (on both floors)
500 standing

Flint Hills Discovery Center

Classroom

40 classroom

64 seated

75 – 100 standing

(depends upon time of rental)



**Flint Hills Discovery Center
2nd Floor**

Blue Earth Room

48 seated

55 standing

Flint Hills Room

40 seated

45 standing

Prairie Garden Terrace & Trail

150 seated

200 standing

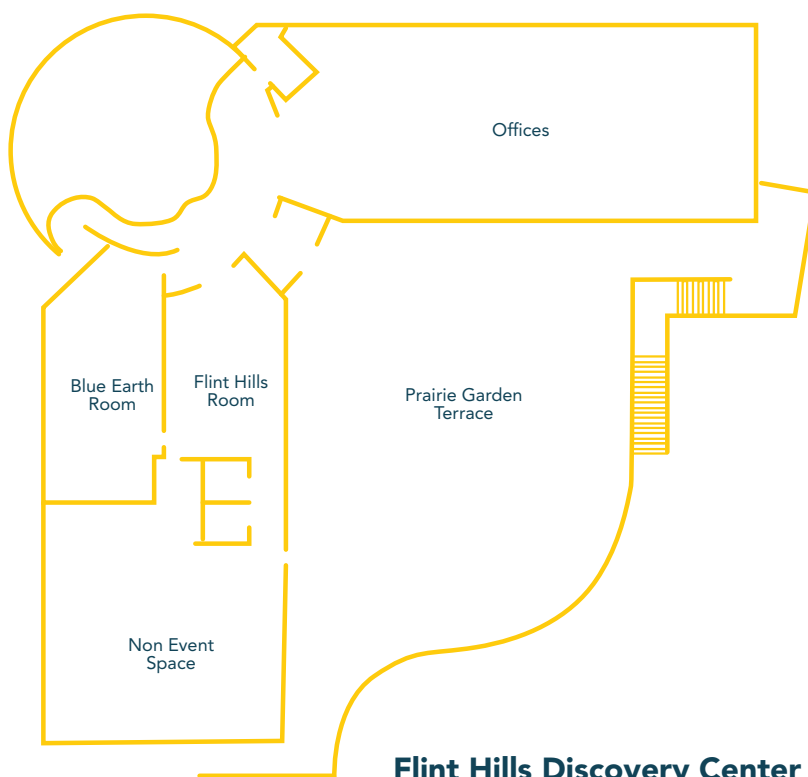

**Flint Hills Discovery Center
3rd Floor**

Sunset Zoo Nature Exploration Center

2333 Oak Street
785-587-2737
www.sunsetzoo.com



Manhattan's wildest destination is more than just a park. Sunset Zoo is brimming with creative educational offerings from early childhood programs to youth summer camps, and is the perfect place to host your next celebration or business meeting. The Zoo's Nature Exploration Center and brilliantly-landscaped grounds guarantee a unique celebration.

Home to over 250 animals – from anteater to zebu – Sunset Zoo offers up-close views of flamingos, sloth bears and an array of primates. A visit to Sunset Zoo's gibbon exhibit is sure to wow!

Situated on 26-acres and only a few minutes from K-State, this AZA-accredited Zoo hosts a variety of special events including family favorites like Earth Day, Water Safari and SPOOKtacular, as well as after-hours celebrations such as Wine in the Wild and Brew at the Zoo.

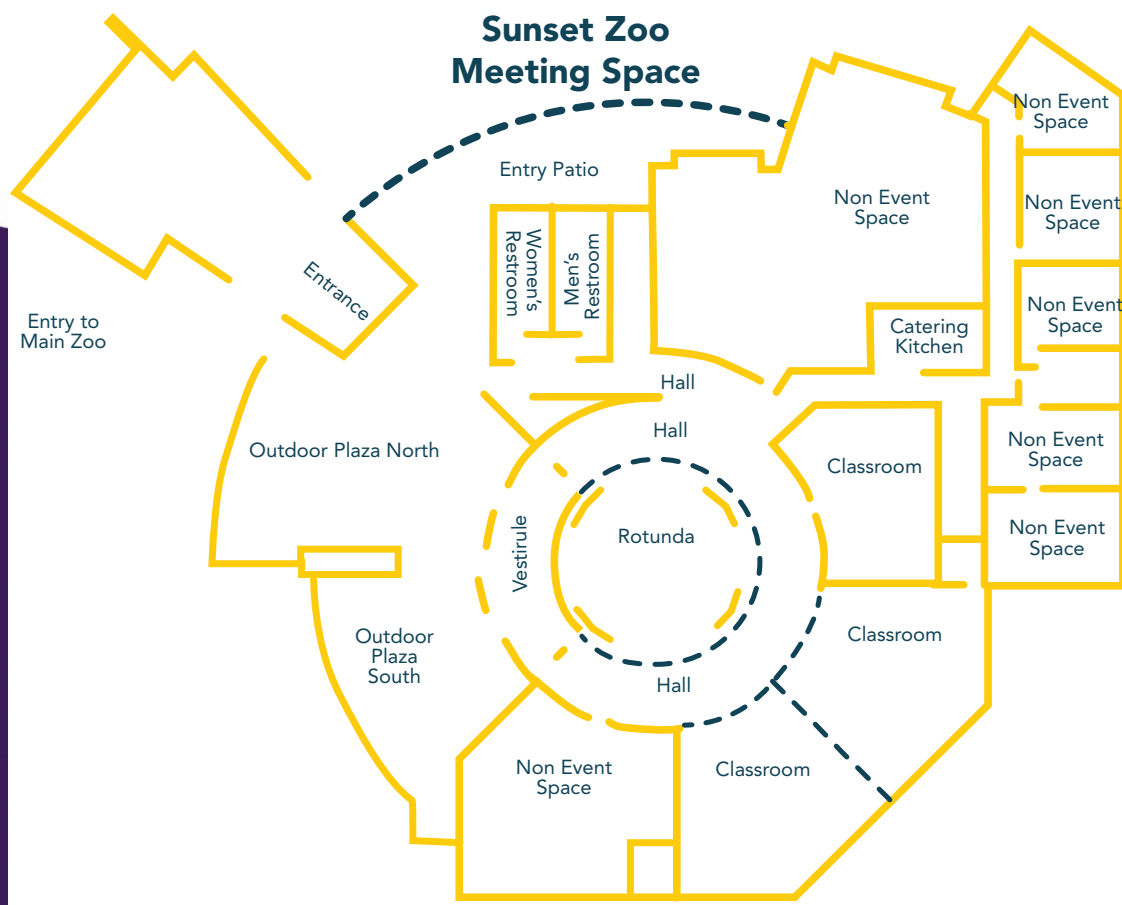

Wareham Opera House

410 Poyntz Avenue
Manhattan, KS 66502
For reservations, call 785-320-7989
info@supplyevents.com
www.thewareham.com



Built in 1884, The Wareham Opera House was built to entertain. In 1911 electricity and a screen was added making the Opera house the second movie theatre in Kansas. Serving Manhattan with movies until 1986, today this beautiful building represents Manhattan and showcases Poyntz Avenue as an event center. The Opera House has a seating capacity of 550, including a stage and balcony.

Meeting Room	Room Size	Square Feet	Ceiling Height	Reception	Seating Capacity		Classroom
Wareham Opera House	93' x 48'	4400	–	550	Banquet 250	Theater 300	200

Wareham Meeting Space

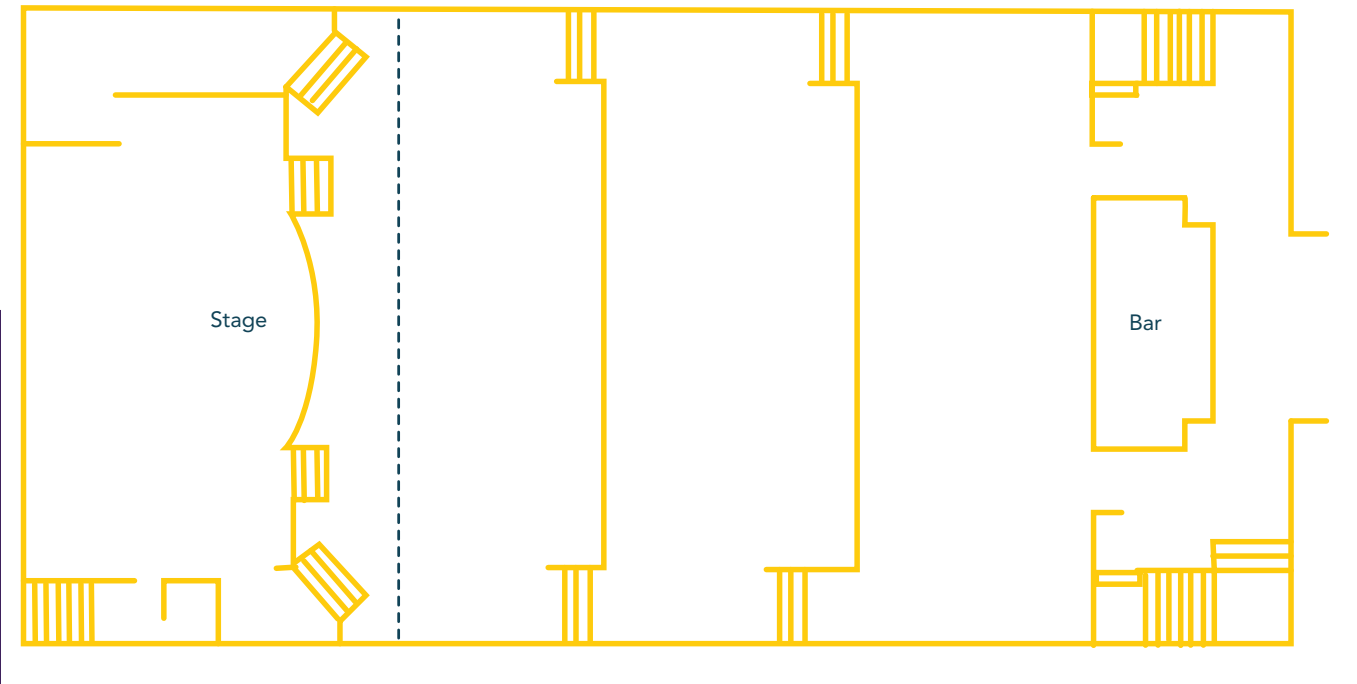

K-State Alumni Center

17th Street & Anderson Avenue
Manhattan, KS 66506
785-532-6260, 1-800-600-ALUM (2586)
www.k-state.com



The K-State Alumni Center houses the Alumni Association offices and offers meeting and banquet facilities for the University and Manhattan community. Built of native Kansas limestone, the building has a large banquet room capable of seating 400 people at rounds with an large, adjacent catering kitchen. This room can be divided into four smaller rooms. Twelve additional conference rooms are ideal for meetings ranging from 4 to 100 people. The Tadtman Boardroom is the marquee room on the 2nd floor and offers breathtaking views of historic Memorial Stadium.

Conveniently located on the K-State campus, the Alumni Center is across the street from the Holiday Inn at the Campus. Some other lodging facilities are within a few short miles of the facility. The Alumni Center offers quick access to the K-State Student Union, The Beach Museum of Art, Aggieville and other local attractions.

Meeting Room	Room Size	Square Feet	Floor	Reception	Seating Capacity Banquet	Seating Capacity Theatre	Round Table
Banquet Room	92 x 56	5152	Ground	750	480	550	400
Banquet Rooms A, B, C, D	46 x 28	1325	Ground	180	96	120	80
Great Room	40 x 37	1234	Ground	100	N/A	N/A	N/A
Wildcat Den	34 x 33	740	Ground	75	48	78	48
South Terrace	140 x 25	3,500	Ground	300	N/A	N/A	125
Johnson Terrace (north)	200 x 25	5,000	Ground	200	N/A	N/A	75
Tointon Great Room	45 x 38	1,710	Ground	100	N/A	N/A	N/A
Barett Wildcat Den	25 x 33	825	Ground	75	48	78	48
Tadtman Board Room	46 x 34	1552	2nd Floor	N/A	60	N/A	N/A
Hewson Board Room	11 x 10	110	2nd Floor	N/A	N/A	N/A	4
Jordan Conference Room	23 x 15	345	2nd Floor	30	16	20	16
Katlin Conference Room	16 x 14	225	2nd Floor	N/A	N/A	N/A	8
Bird Conference Room	11 x 10	110	2nd Floor	N/A	N/A	N/A	4
Kansas State Bank Conference Room	11 x 10	110	3rd Floor	N/A	N/A	N/A	4
Purple Pride Conference Room	32 x 23	736	3rd Floor	75	48	60	40
Lecture Room	34 x 23	782	3rd Floor	N/A	N/A	30	N/A
Truitt Conference Room	23 x 16	368	3rd Floor	30	16	20	16
PowerCat Conference Room	22 x 17	391	3rd Floor	30	16	20	16
* Round tables are based on seating eight people per table							

K-State Alumni Center

K-State Alumni Center First Floor

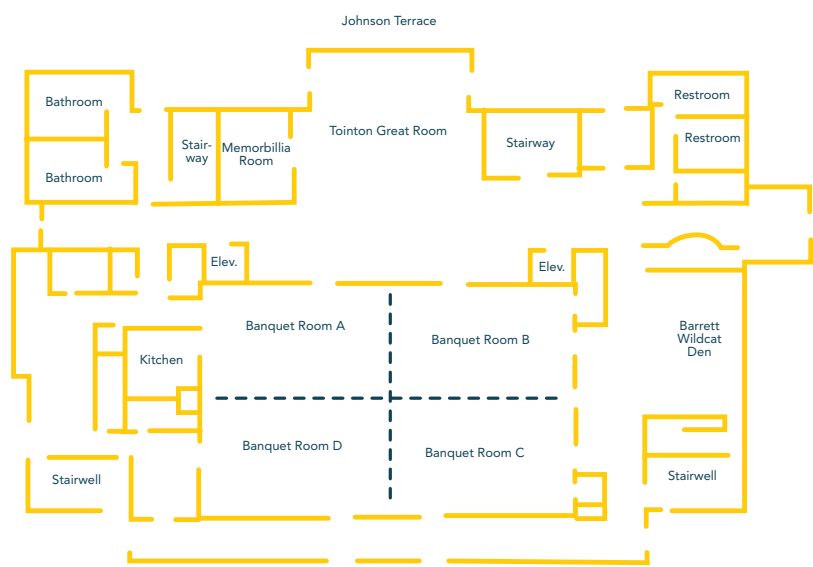

K-State Alumni Center Second Floor

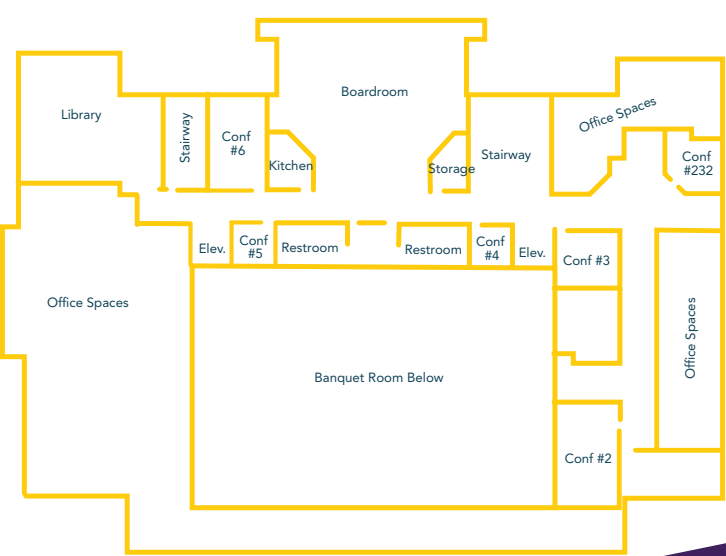

K-State Alumni Center Third Floor

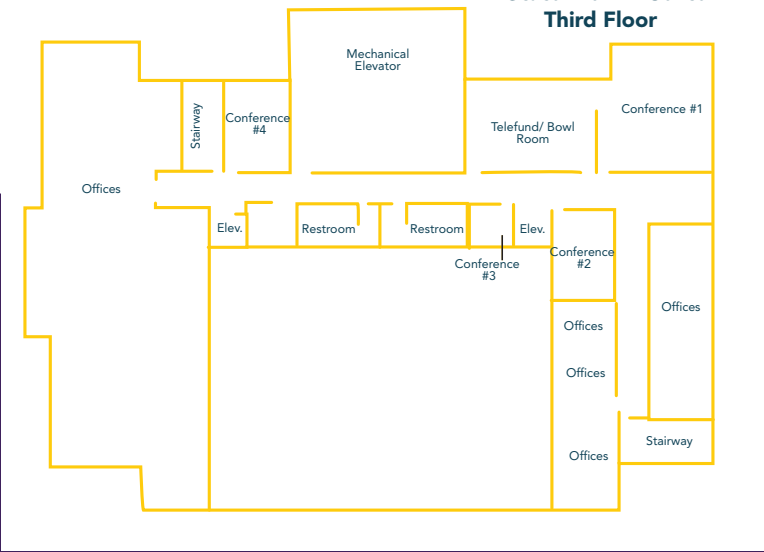

K-State Student Union

17th Street & Anderson Avenue
Manhattan, KS 66506
785-532-6591
Fax: 785-532-6565
www.union.ksu.edu



This 250,000 square foot multipurpose facility is comprised of five levels, three of which provide main meeting, conference, planning and catering services, as well as state-of-the-art audio/visual technology and downlink/teleconferencing and videoconferencing capabilities. The K-State Student Union has 32 meeting rooms and a 90,000 square foot outdoor plaza. All spaces are available for meeting and catering services. Rooms include dining, two auditoriums, a spacious ballroom with seating for up to 1,000 people for a catered event, a courtyard for more intimate gatherings and several lounges to accommodate your conference needs. Wireless internet is available throughout the building, while Audio/visual equipment is available by reservation. Most meeting rooms are equipped with 10baseT Ethernet jacks that provide computer connections to the campus Ethernet network and the Internet.

For a complete listing of services, go to www.union.ksu.edu.

Map #	Room	Number of People				Room Size		
		Meeting (Lecture/Chairs)	Banquet	Reception (Empty Room)	Classroom	Width X Depth (in feet)	Height	Square Feet
1	202	14	14	N/A	N/A	17x21	10	357
2	203	12	12	N/A	N/A	17x21	10	357
3	204	14	14	N/A	N/A	17x21	10	357
4	205	14	14	N/A	N/A	17x21	10	357
5	206	50	40	80	42	34x21	10	714
6	207	50	40	80	42	34x21	10	714
7	208	12	12	N/A	N/A	17x21	10	357
8	209	50	32	60	30	17x21	10	357
9	212	120	96	120	48	37x39	9	1443
10	213	90	40	75	50	24x48	9	1152
11	BIG 12 Room	N/A	N/A	N/A	110	47x49	varies	2303
12	Bluemont Room	150	100	150	48	34x60	11'5"	2040
13	Cats' Pause	N/A	N/A	50	N/A	30x59	9	1770
14	Cottonwood Room	125	96	150	48	29x48	9	1392
15	Council Chambers	22	N/A	N/A	N/A	22x47	9	1034
16	Director's Conf. Rm	15	15	N/A	N/A	24x24	10	576
17	Flint Hills Room	180	120	200	60	36x49	9	1764
20&23	Grand Ballroom	850	1000	1200	N/A	N/A	N/A	9306
18	K-Ballroom	125	72	150	36	36x40	14'5"	1440
18&21	K&S Ballroom	250	144	375	72	36x80	14'5"	2880
19	Konza Room	N/A	22	50	N/A	14x22	10	308
20	Main Ballroom	450	220	600	180	54x71	14'5"	3834
21	S-Ballroom	125	72	150	36	36x40	14'5"	1440
22	Sunflower Room	80	48	50	24	21x32	9'	672
23	West Ballroom	150	100	200	48	54x36	14'5"	1944
24	Art Gallery	50	32	60	N/A	29x37	10	1073
25	Center Stateroom 2	30	18	40	12	12x20	9	240
26	East Stateroom 1	36	18	40	12	14x20	9	280
27	Little Theatre	200	48	100	50	49x56	varies	2744
28	North Dining	140	96	120	36	29x34	9	986
29	West Stateroom 3	30	18	40	12	12x20	9	240
30	Courtyard	240	120	250	100	42x24	36	1008
31	Forum Hall	585	N/A	N/A	N/A	70x82	varies	5740
32	Union Station	200	120	200	100	46x83	9	3818

(1) Most meeting rooms have extra chairs along the wall.

(2) The banquet column is calculated using round tables for 8. May increase number by using 8' tables.

(3) s = standard/table too large to move

(4) The number beside the room name above corresponds to the number on the building map location.

K-State Student Union

Kansas State University Union
Ground Floor

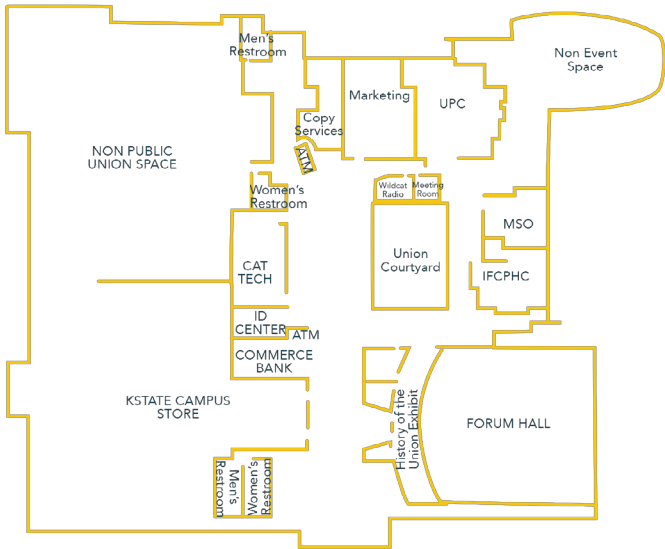

Kansas State University Union
First Floor

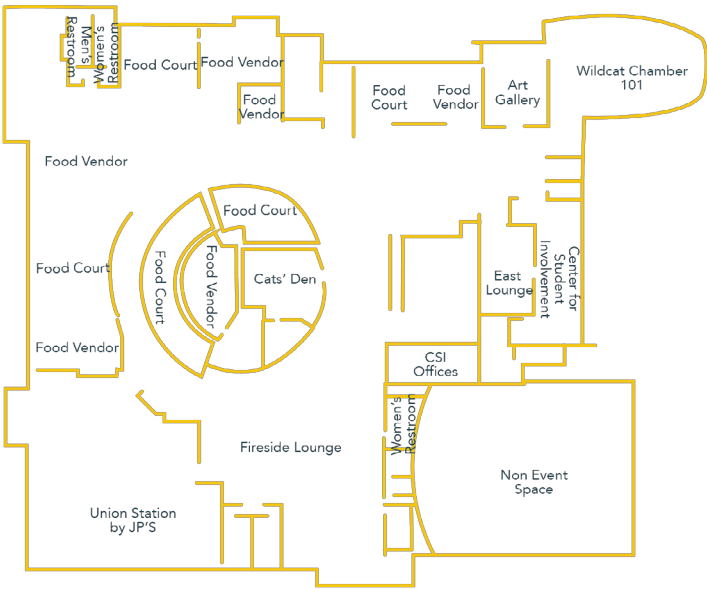

Kansas State University Union
Second Floor

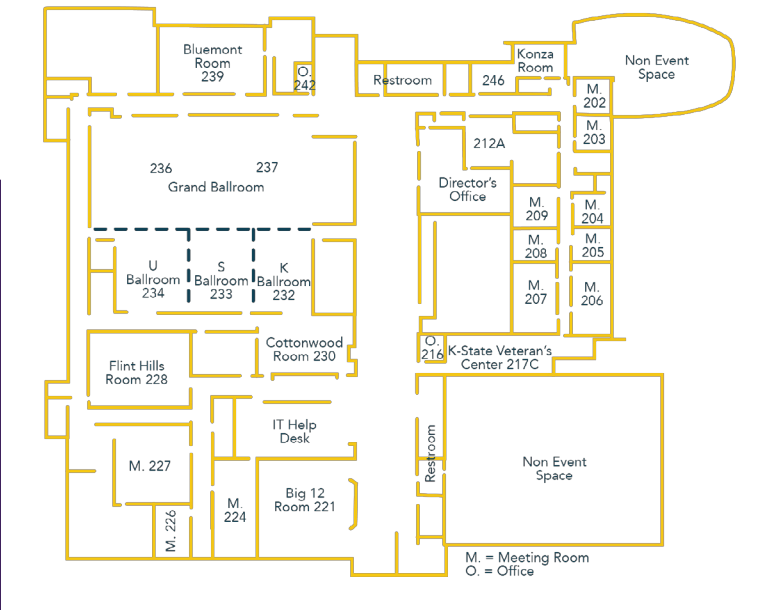

McCain Auditorium

207 McCain Auditorium
Kansas State University
Manhattan, KS 66506-4711
785-532-6425
www.ksu.edu/mccain



McCain Auditorium is the cultural center for the live performing arts and a host for numerous campus and community entertainment activities and special events. McCain has a total seating capacity of 1,751. The orchestra level contains 943 fixed seats in continuous rows. The balcony has 796 seats arranged in more traditional fashion with aisles. There is space for six wheelchairs and companion seating within the orchestra area. Enjoy our expanded lobby, a large multipurpose room, and two conference areas offering breakout space. On-site staff is available for light, sound and media needs. This facility has been used for performances, conferences, lectures, exhibitions/trade shows, summer camps, and other large events.

McCain Auditorium

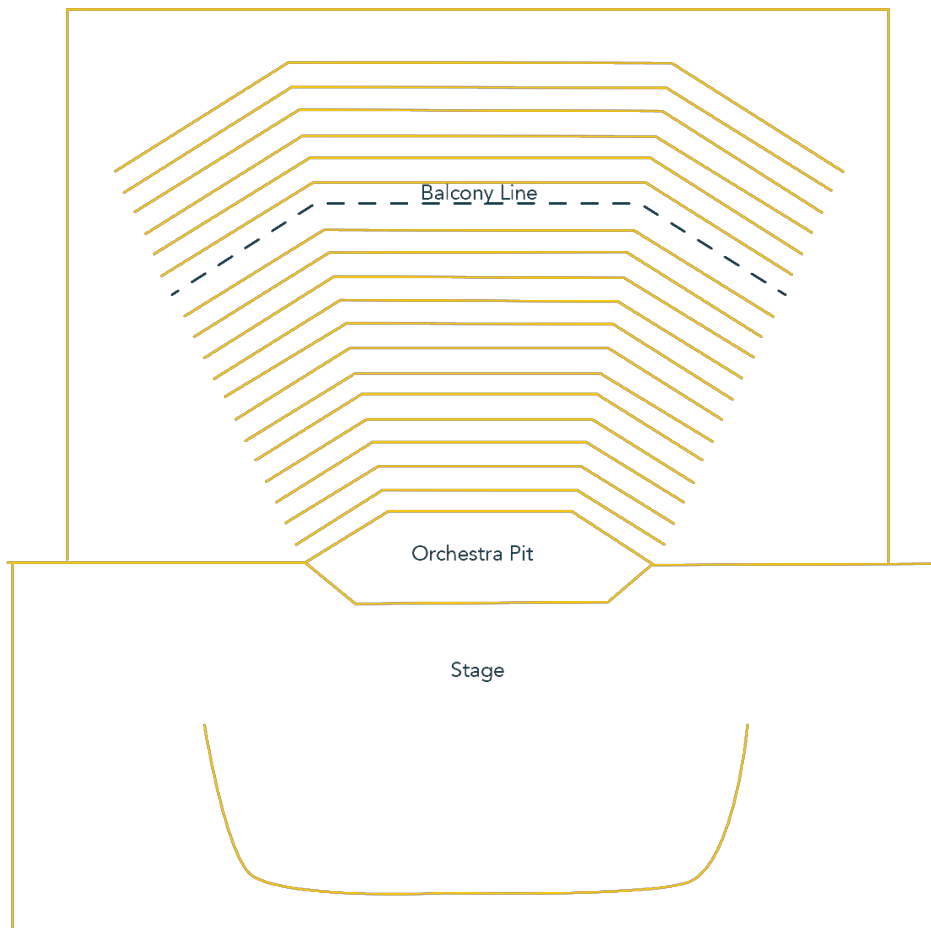

Midwest Dream Car Collection

3007 Anderson Ave.
Manhattan, KS 66502
785-236-5501 ext. 302
events@mdccks.org
www.midwestdreamcarcollection.org



Rent the lounge, boardroom, meeting room or the entire venue. Views of the stunning and versatile collection provide a striking backdrop for your event no matter the occasion. Pour your own beer or setup a pro to facilitate. Over 15 beers available on-site at the self-serve wall with seasonal rotation of imports, domestic and craft beers. Premium wine is also available on tap. Custom setup (theater, classroom, reception, rounds available). Admission to all exhibits included. Professional event coordinator & museum docents on-site. State-of-the-art audio visual system available.

Meeting Room	Room Size	Square Feet	Ceiling Height	Reception	Seating Capacity		
					Banquet	Theater	Classroom
Entire venue	–	55,000	–	850	160	200	75
Laguna/Monaco	–	2,866	–	–	80	100	48
Lamborghini Lounge	–	–	–	100	–	–	–
Le Mans Boardroom	–	–	–	–	–	–	10

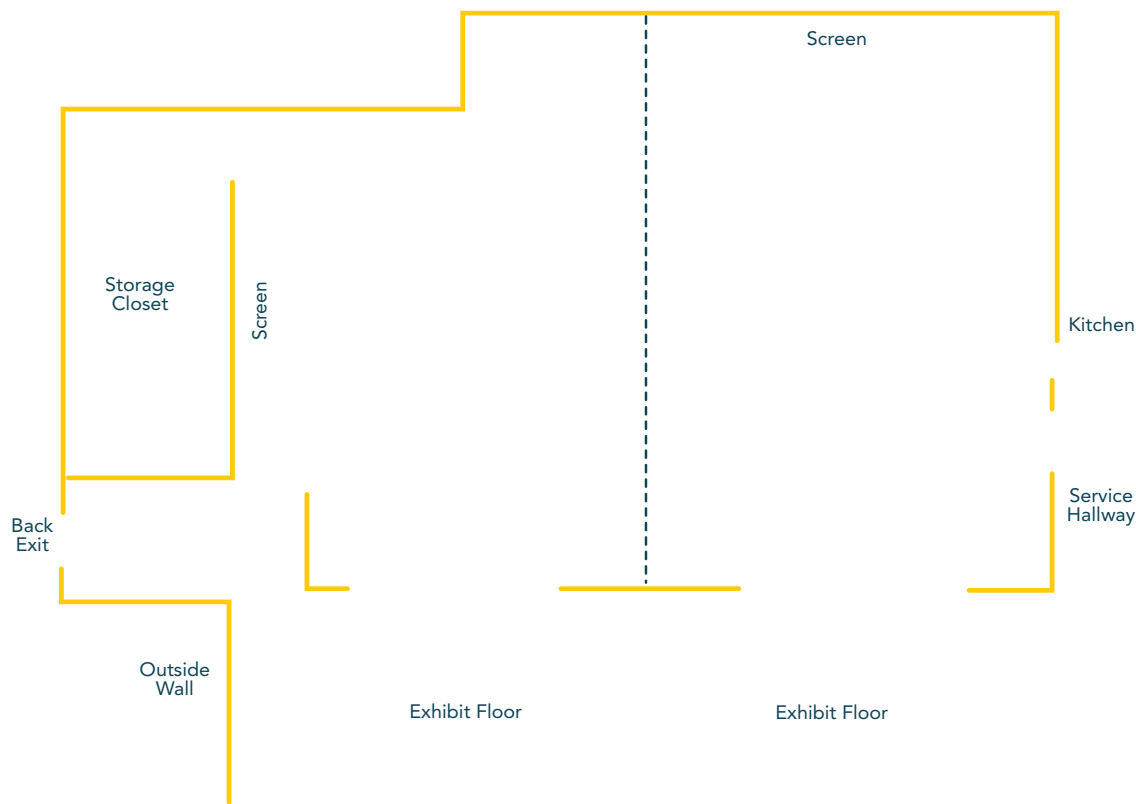



10 REASONS TO MEET IN **MANHATTAN**

- #1 Walkable meeting destination in Kansas
 - Exceptional meeting venues
 - Over 1,300 sleeping rooms
 - 50+ unique dining offerings
- Home to Kansas State University
 - Gateway to the Flint Hills
 - Great attractions
- Unique team building opportunities
- Complimentary conference services
 - Fly Manhattan Regional Airport



FLYMHK

MANHATTAN REGIONAL AIRPORT

Manhattan Regional Airport is located 5 miles west of the central hotel district on Kansas Highway 18. Fly MHK! is serviced by American Airlines/American Eagle, with direct jet service to Dallas-Fort Worth and Chicago O'Hare. Our terminal building has tripled to 42,000 square feet at the fastest-growing airport in Kansas.

Oh
Man!

MEET IN
Manhattan ^{KS}

Manhattan Convention & Visitors Bureau
501 Poyntz Ave. • Manhattan, KS 66502
785.776.8829 • VISITMANHATTANKS.ORG