

INTRODUCING MELBOURNE'S NEWEST **MEETING AND EVENT DESTINATION**

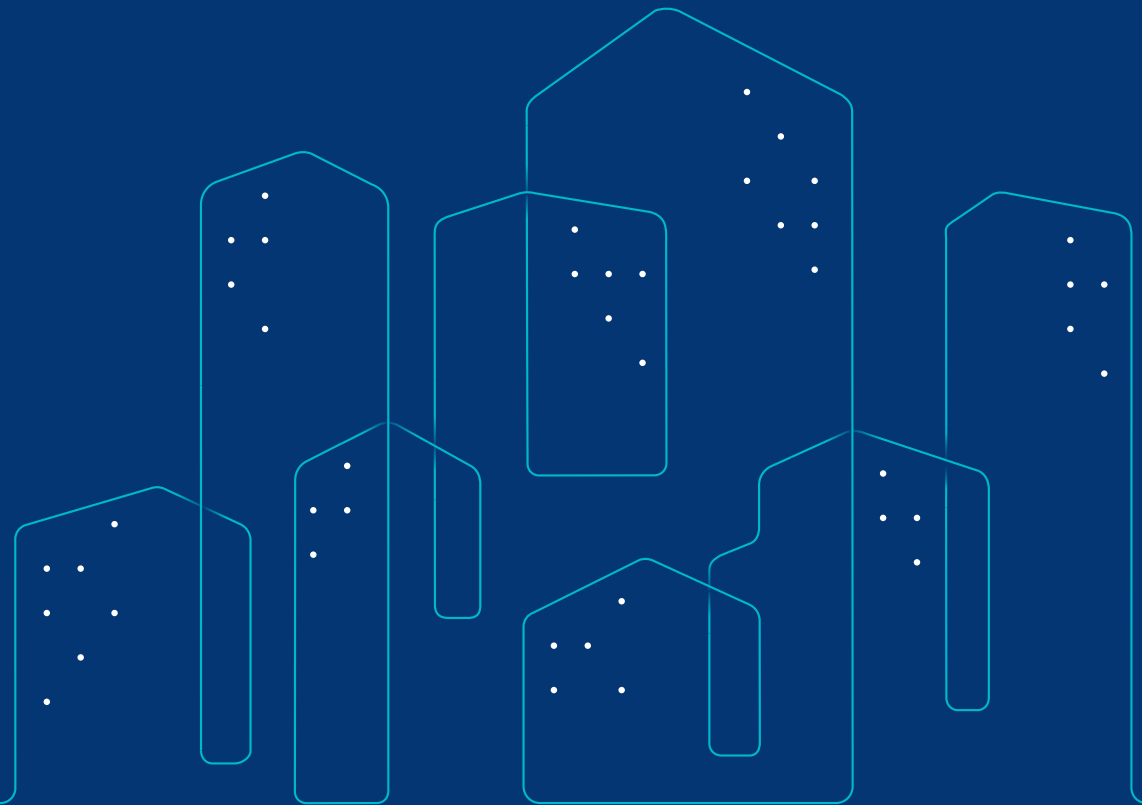

AN IHG® HOTEL
MELBOURNE
SOUTHBANK



Holiday Inn Express Melbourne Southbank
Opening December 2019



MORE OF WHAT **YOU NEED**

ROOMS

- 345 rooms over 15 floors**
- Free in-room Wi-Fi**
- Ensuite bathroom with power shower and quality towels**
- Personally controlled air conditioning**
- High quality bedding with soft or firm pillows**
- Iron, ironing board, hairdryer**
- Staycast technology TV's in every room (King rooms 55", Standard rooms 49")**
- Tea and coffee making facilities**
- In-room safe**
- Minibar fridge (unstocked)**
- Inbuilt black-out blinds**

FACILITIES

- Outdoor Winter Garden Terrace**
- Four flexible meeting spaces (up to 84 pax)**
- Great Room with free Wi-Fi and flexible work spaces**
- Fitness room with 24-hour access**
- Self-service laundry**
- Guest dry-cleaning available**
- On-site car parking facilities**
- 24 hour reception**
- Spacious driveway, accessible to large coaches**
- Free business centre and iPad use**



MEETING EVERY **EXPECTATION**

Centrally located in Melbourne Southbank and within easy reach of the vibrant arts and sporting precinct, picturesque Yarra River, Melbourne Convention and Exhibition Centre and Flinders Street station, our contemporary hotel is the smart choice for accommodation, meetings and events with four multi-function spaces and group accommodation packages available.

Whether it's a small boardroom meeting, to events in our brand new, light-filled, industrial style meeting spaces, which can be hired as a whole or in part, or a larger cocktail event in our vibrant and expansive The Great Room, we're ready to meet your every expectation.

And for the savvy business traveller, enjoy a great night's sleep with your choice of soft or firm pillows, fast and free Wi-Fi and free Express start buffet breakfast.



OUR EVENT SPACES

All event spaces are designed with a warm and urban nod to the local Southbank arts and sporting precinct. Each room boasts natural light, inclusive AV and are fully flexible in set up and configuration.

QUEENSBRIDGE ROOM

A light filled space with floor to ceiling glass at the Southern end of the room and a modern, urban style design, the Queensbridge room is perfect for boardroom set up, however is an entirely flexible space designed with versatility in mind.

SANDRIDGE ROOM

Similarly, light and bright and running along the City road aspect of the 7th floor, Sandridge room can be opened up to join both Walker room and the Great Room with increased combined capacity, flexibility in set up options and versatility in event styles.

WALKER ROOM

Adjoining Sandridge room, Walker room is equally as light filled and flexible. Combine Walker room with Sandridge room for larger capacities and a variety of room sets.

PRINCES ROOM

On the South-West corner of the 7th floor, Princes room offers natural light and a smaller configuration, perfect as a break-out space, team massage room or an intimate meeting space.

FESTIVAL SPACE

Combine both Walker, Sandridge and the Great Room to create a light filled versatile event space. Perfect for larger style theatre or classroom set ups, this space can also be used to host vibrant, private cocktail functions or even a dinner!

WINTER GARDEN

Overlooking City Road with views to the Yarra River, the Winter Garden is located off the southern end of the 7th floor Great Room. A fantastic space for a smaller cocktail function, or to hold your BBQ lunch event. The Winter Garden is the perfect spot to sip on a summer cocktail or cuddle up near the heaters in winter!

FLOORPLAN

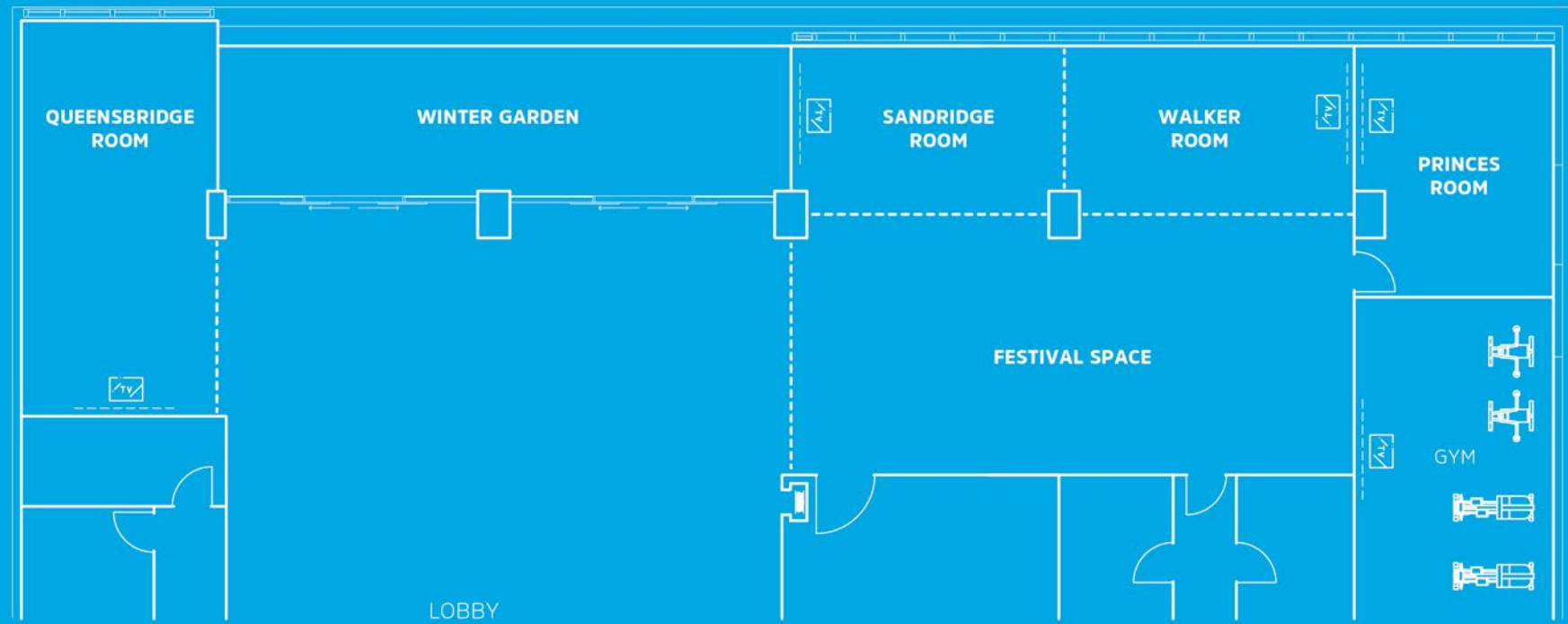

EVENTS WITH **BENEFITS**



Free Wi-Fi



Sweets



Coffee and tea



Flip chart



White board



Conferencing facilities



Buffet breakfast



Access to happy hour



AV facilities - TV, laptop connectivity & projector



Accommodation packages

CAPACITY SNAPSHOT

ROOM AND ARRANGEMENT	Sqm	U - Shape 2/3 pax	Boardroom style	Banquet style	Cabaret style	Theatre style	Classroom style 2/3 pax per table
Queensbridge Room	42	18 or 26	18	24	18	33	14 or 21
Sandridge Room	22	10 or 14	12	8	6	16	8 or 12
Walker Room	27	10 or 16	14	8	6	19	10 or 15
Sandridge and Walker combined	49	22 or 35	28	24	18	38	18 or 27
Princes Room	27	8 or 10	8	-	-	16	N/A
Festival Space	75	26 or 39	28	72	56	84	40 or 60



DAY DELEGATES PACKAGES

PACKAGE

DURATION

INCLUSIONS

COST

Full Day Delegates Package

(Minimum 10 delegates)

Full day (8 hours)

Arrival tea and coffee, morning tea break, working lunch, afternoon tea break, fully integrated and wall mounted smart TV with cast capability and HDMI connectivity, pads and pens, water and mints, white board and flip chart.

\$70

Half Day Delegates Package

(Minimum 10 delegates)

Half day (4 hours)

Arrival tea and coffee, morning or afternoon tea break, light working lunch, fully integrated and wall mounted smart TV with cast capability and HDMI connectivity, pads and pens, water and mints, white board and flip chart.

\$55



WHAT YOU NEED TO KNOW

AIRPORT

Melbourne Tullamarine Airport 26kms

PUBLIC TRANSPORT

5 minute walk to Flinders Street Station

4 minute walk to major tram stops

NEARBY ATTRACTIONS

1 minute walk to Southbank Promenade and offices

3 minute walk to Arts Centre Precinct

4 minute walk to National Gallery of Victoria

5 minute walk to Crown Casino Complex

12 minute walk to Melbourne Convention and Exhibition Centre

17 minute walk to Melbourne Cricket Ground, Rod Laver Arena and AAMI Park

NEARBY RESTAURANT PRECINCTS

Directly opposite Southgate Restaurant and Shopping Centre and Southbank Promenade

5 minute walk to Crown Casino Complex

NEARBY SHOPS

5 minute walk to Melbourne's iconic laneways

10 minute walk to Bourke St Mall



AN IHG® HOTEL
MELBOURNE
SOUTHBANK

Holiday Inn Express
Melbourne Southbank

35-47 City Road, Southbank Melbourne VIC 3006
sales.melms@proinvesthotels.com