

# MELBOURNE KNOWLEDGE PRECINCTS

Melbourne is home to three knowledge precincts bringing together academic institutions, research and medical centres and industry to foster world-leading innovation.

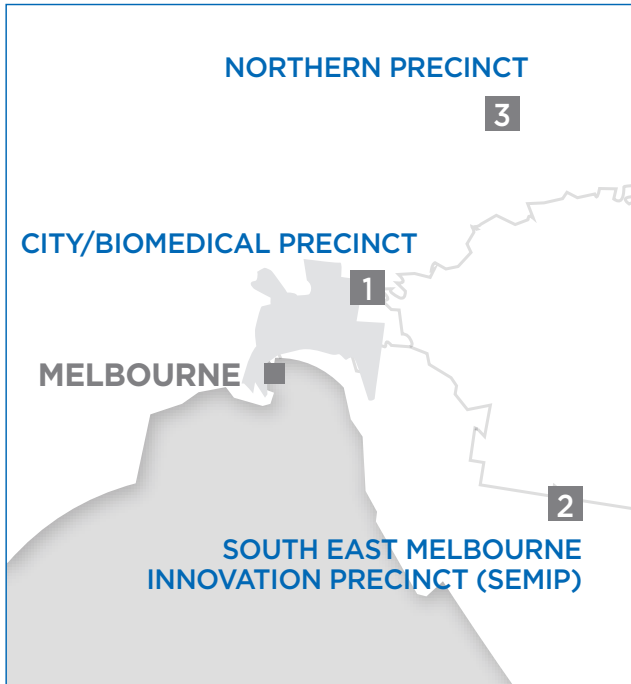

## 1 CITY/BIOMEDICAL PRECINCT

- > Aikenhead Centre for Medical Discovery
- > Bio21 Institute
- > Bionics Institute
- > Centre for Eye Research Australia (CERA)
- > Commonwealth Serum Laboratories (CSL)
- > CSIRO Materials Science and Engineering Parkville
- > IBM Research Collaboratory for Life Sciences
- > Institute for a Broadband Enabled Society (IBES)
- > Ludwig Institute for Cancer Research
- > Melbourne Brain Centre
- > Mental Health Research Institute
- > National Ageing Research Institute (NARI)
- > National ICT Australia: Victorian Research Laboratory
- > O'Brien Institute of Microsurgery
- > Orygen Youth Health Centre
- > Peter Doherty Institute for Infection and Immunity
- > Peter MacCallum Cancer Centre
- > Royal Melbourne Institute of Technology (RMIT)
- > St Vincent's Institute of Medical Research and St Vincent's Health
- > Super Computer Initiative
- > The Royal Children's Hospital
- > The Royal Melbourne Hospital
- > The Royal Women's Hospital
- > University of Melbourne
- > Victorian Comprehensive Cancer Centre (VCCC) - Opens in 2015
- > Victorian Life Sciences Computation Initiative (VLSCI)
- > Walter and Eliza Hall Institute of Medical Research (WEHI)

## 2 SOUTH EAST MELBOURNE INNOVATION PRECINCT (SEMIP)

- > Australian Synchrotron
- > Commonwealth Scientific and Industrial Research Organisation (CSIRO)
- > Melbourne Centre for Nanofabrication
- > Monash University
- > Small Technologies Cluster

## 3 NORTHERN PRECINCT

- > Alfred Medical Research and Education Precinct (AMREP)
- > Centre for AgriBioscience (AgriBio)
- > Centre for Technology Infusion
- > Health Innovations Research Institute - RMIT
- > La Trobe Institute for Molecular Science (LIMS)
- > La Trobe University
- > Rio Tinto's Research and Technology Centre
- > Walter and Eliza Hall Institute (WEHI) Biotechnology Centre

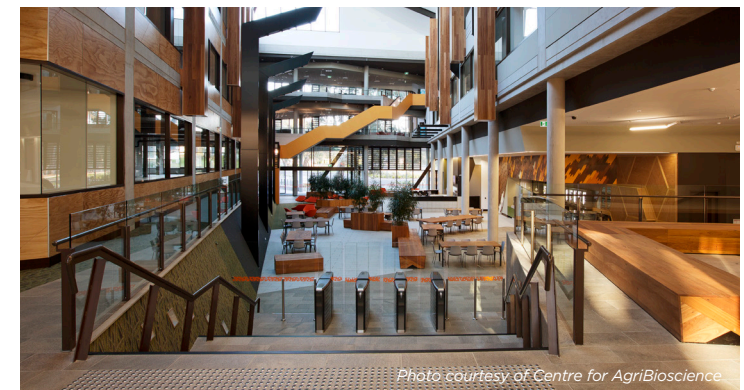

Photo courtesy of Centre for AgriBioscience