

# WHERE INNOVATION AND INSPIRATION MEET™



MONTEREY  
CONFERENCE  
CENTER



Imagine a state-of-the-art meetings facility famous for innovative events in the heart of a destination world-renowned for inspiration. That reality is here with the newly renovated Monterey Conference Center. The \$60 million expanded facility now brims with more than 40,000 square feet of flexible meeting space.

## GETTING HERE

Whether your attendees prefer planes, trains or automobiles, it's easy to get to Monterey County for your next meeting and event.

Monterey County is situated on California's central coast 100 miles south of San Francisco, and 300 miles north of Los Angeles.

Monterey Regional Airport (MRY) is convenient and easier to get to than you think! With daily service from San Francisco, Los Angeles, San Diego, Las Vegas, Denver and Phoenix, MRY has reach to over 95 domestic and international destinations with just one connection.

### Direct Flights to Monterey from Seven Cities

McCarran International Airport, Las Vegas (LAS)  
Los Angeles International Airport (LAX)  
Phoenix Sky Harbor International Airport (PHX)  
San Francisco International Airport (SFO)  
San Diego International Airport (SAN)  
Denver International Airport (DEN)  
Dallas/Fort Worth International Airport (DFW)

### Drive Times

Monterey from MRY: 10 min.  
San Jose to Monterey: 1 hr.  
San Francisco to Monterey: 2 hrs.  
Sacramento to Monterey: 3 hrs.  
Los Angeles to Monterey: 5 hrs.

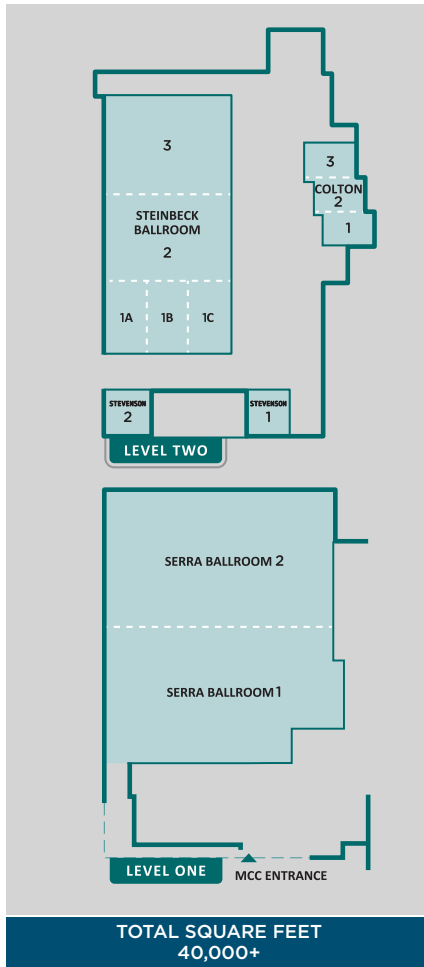
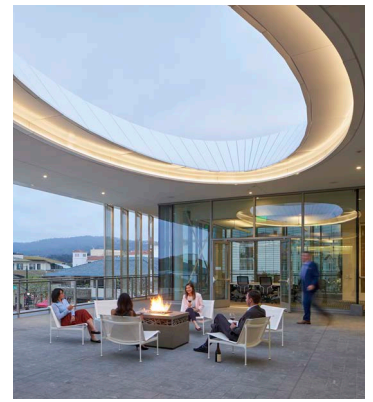
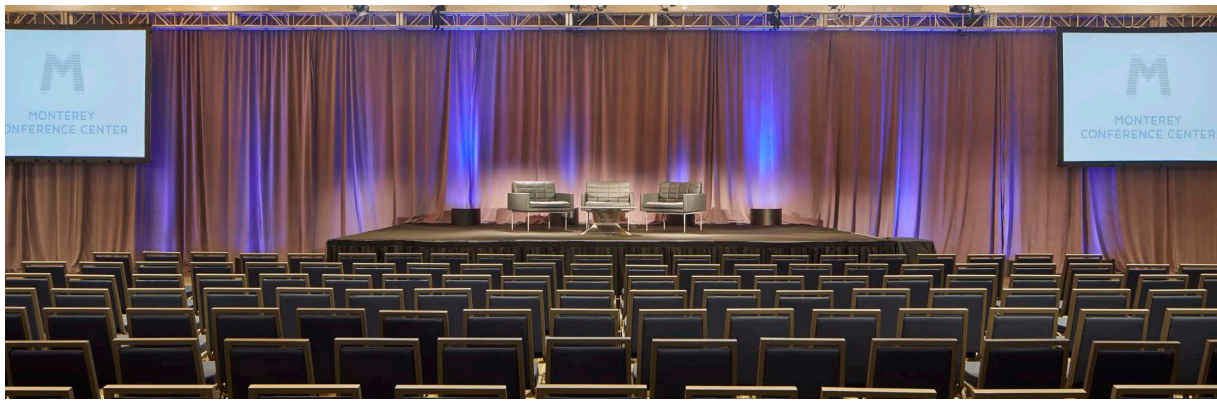

MCC	Size	Square Feet	Ceiling Height	8x10 Exhibits	Theater	School	Rounds
SERRA BALLROOM	135'x140'	19,150	15'	125	2,000	1,260	1,140
SERRA 1	78'x135'	10,500	15'	60	750	700	460
SERRA 2	64'x135'	8,650	15'	48	725	550	450
STEINBECK BALLROOM	70'x139'	9,730	18'	55	984	600	600
STEINBECK 1	48'x70'	3,430	18'	20	360	220	240
STEINBECK 1A	22'x40'	880	18'		90	56	60
STEINBECK 1B	24'x40'	960	18'		96	56	60
STEINBECK 1C	22'x40'	880	18'		90	56	60
STEINBECK 2	39'x70'	2,730	18'	15	320	167	180
STEINBECK 3	48'x70'	3,430	18'	20	350	260	230
COLTON	29'x57'	1,653	12'		160	90	110
COLTON 1	19'x29'	551	12'		50	37	40
COLTON 2	19'x29'	551	12'		50	37	40
COLTON 3	19'x29'	551	12'		50	37	40
STEVENSON 1	23'x22'	506	12'			24	32
STEVENSON 2	27'x22'	594	12'			29	32
<b>TOTAL SQUARE FEET</b>	<b>TOTAL CAPACITY</b>	<b>THEATER CAPACITY</b>	<b>SCHOOLROOM CAPACITY</b>				
<b>40,000+</b>	<b>3,200</b>	<b>2,000</b>	<b>1,260</b>				

THE CONFERENCE CENTER HAS A PREFERRED A/V & SIGNAGE PROVIDER, AS WELL AS AN EXCLUSIVE CATERER AND TRADESHOW ELECTRICAL PROVIDER. To view a list of these vendors, please visit: [MontereyConferenceCenter.com/Facility/On-Site-Services](http://MontereyConferenceCenter.com/Facility/On-Site-Services)



MONTEREY CONFERENCE CENTER

One Portola Plaza,  
Monterey, CA 93940

[MontereyConferenceCenter.com](http://MontereyConferenceCenter.com)

Sales and Events:  
Toll Free: (800) 742-8091  
Phone: (831) 646-3388  
Fax: (831) 646-3777  
[grpsales@monterey.org](mailto:grpsales@monterey.org)