

	Portola Hotel & Spa	Size	Square Feet	Celling Height	8 x 10 Exhibits	Theater	School	Rounds
	De Anza Ballroom	128' x 83'	10,655	13' 5"	59	1000	520	750
	De Anza 1 or 2	39' x 84'	3,275	13' 5"	20	350	150	170
	De Anza 3	49' x 84'	4,115	13' 5"	27	425	220	220
	Bonsai Ballroom	67' x 38'	2,546	10'	10	200	130	150
	Bonsai 1 or 2	26' x 38'	988	10'		70	55	50
	Bonsai 3	15' x 38'	570	10'		30	18	24
	Portola Room	51' x 38'	2,529	7' 9"	15	125	60	120
	Driftwood 1	42' x 15'	712	8' 10"		50	42	56
	Driftwood 2	23' x 20'	460	8' 10"		36	21	32
	Cottonwood Room	25' x 60'	1,500	8'		80	70	80
	Cottonwood 1 or 2	25' x 30'	750	8'		40	30	40
	Ironwood Room	25' x 56'	1,400	8'		80	70	80
	Ironwood 1 or 2	25' x 28'	700	8'		40	30	40
	Redwood Room	25' x 56'	1,400	8'		80	70	80
	Redwood 1 or 2	25' x 28'	700	8'		40	30	40
	Executive Boardroom		760	8' 6"				
	The Club Room		4,593	9' 11"		120		200

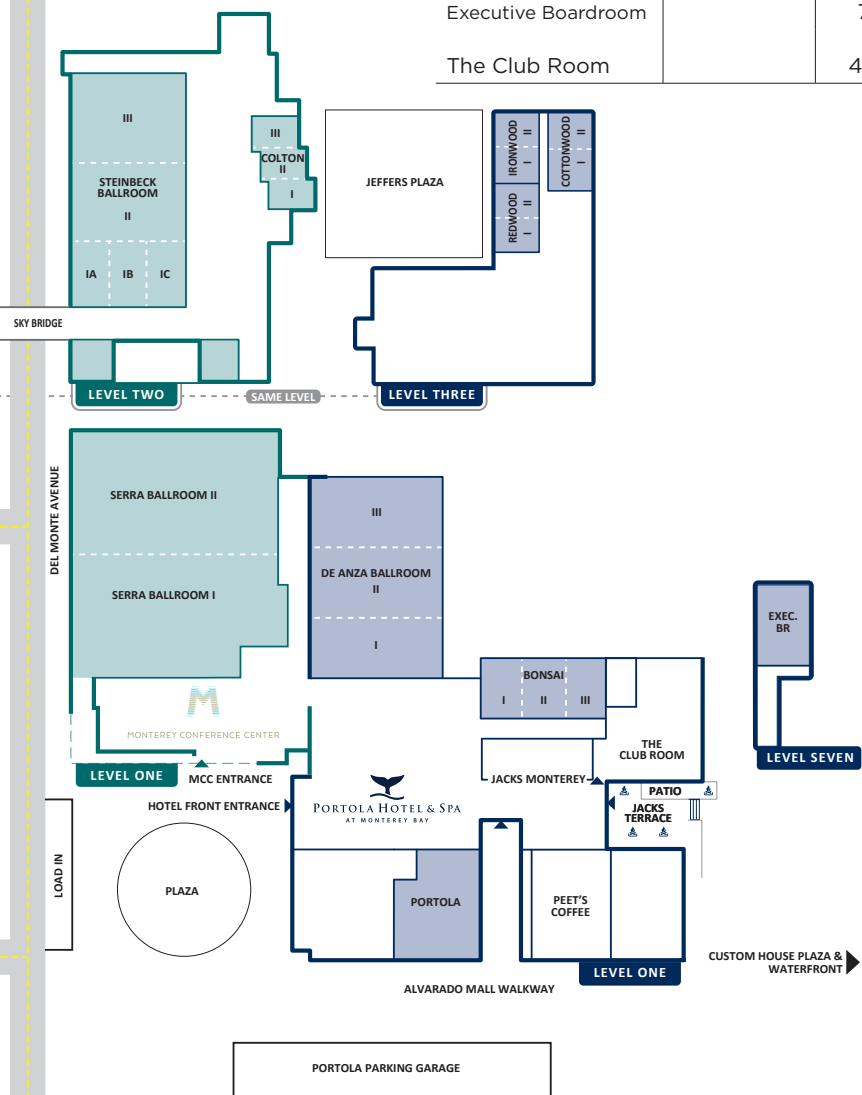

Getting Here

Flying to Monterey County

is easy with over 500 direct and one-stop flights from most major U.S. and international cities. The convenient Monterey Regional Airport (MRY), has short and hassle-free security lines and is located just 10 minutes door-to-door from downtown Monterey. Charter and private flights are also available.

Other nearby airports include Norman Y. Mineta San Jose International Airport (SJC), located 80 minutes from downtown Monterey and San Francisco International Airport (SFO), located 120 minutes from downtown Monterey. Shuttle services are available.



Driving to Monterey County

There are two routes to Monterey by car:

- Iconic Highway 1 offers breathtaking views of the Pacific coastline and is known as a top road trip in America.
- Scenic Highway 101 traverses the Central Valley corridor and affords motorists a view of the Salinas Valley, known as the "Salad Bowl of the World."



Lodging Properties with Meeting Space in Monterey:

- 1 Portola Hotel & Spa: Connected
- 2 Monterey Marriott: Connected
- 3 Hotel Pacific: Adjacent
- 4 Casa Munras Garden Hotel & Spa: .5 Miles
- 5 Hotel Abrego: .6 Miles
- 6 Monterey Plaza Hotel and Spa: 1 Mile
- 7 InterContinental The Clement Monterey: 1.3 Miles
- 8 Hilton Garden Inn: 1.3 Miles
- 9 Hyatt Regency Monterey Hotel and Spa: 1.6 Miles
- 10 Monterey Tides: 3 Miles



Monterey Conference Center	Size	Square Feet	Celling Height	8 x 10 Exhibits	Theater	School	Rounds
Serra Ballroom	135' x 140'	19,150	15'	125	2,000	1,260	1,140
Serra 1	78' x 135'	10,500	15'	60	750	700	460
Serra 2	64' x 135'	8,650	15'	48	725	550	450
Steinbeck Ballroom	70' x 139'	9,730	18'	55	984	600	600
Steinbeck 1	48' x 70'	3,430	18'	20	360	220	240
Steinbeck 1A	22' x 40'	880	18'		90	56	60
Steinbeck 1B	24' x 40'	960	18'		96	56	60
Stienbeck 1C	22' x 40'	880	18'		90	56	60
Steinbeck 2	39' x 70'	2,730	18'	15	320	167	180
Steinbeck 3	48' x 70'	3,430	18'	20	350	260	230
Colton	29' x 57'	1,653	12'		160	90	110
Colton 1	19' x 29'	551	12'		50	37	40
Colton 2	19' x 29'	551	12'		50	37	40
Colton 3	19' x 29'	551	12'		50	37	40
Stevenson 1	23' x 22'	506	12'			24	32
Stevenson 2	27' x 22'	594	12'			29	32

Monterey Marriott	Size	Square Feet	Celling Height	8 x 10 Exhibits	Theater	School	Rounds
San Carlos Ballroom	159' x 58'	8,100	11' 6"	55	820	350	500
San Carlos 1	28' x 58'	1,215	11' 6"		110	70	60
San Carlos 2	28' x 58'	1,215	11' 6"		110	70	60
San Carlos 3	55' x 63'	2,430	11' 6"		235	140	180
San Carlos 4	48' x 58'	2,025	11' 6"		180	100	120
Ferrantes Bayview	55' x 64'	3,520	10'		180	120	200
Los Angeles	41' x 20'	684	12'		48	36	50
Santa Barbara	28' x 21'	486	12'		30	24	30
San Francisco	27' x 18'	384	12'		30	20	30
Santa Monica	27' x 21'	432	12'		36	24	30
San Diego	28' x 23'	428	12'		36	24	30
Salon 201	26' x 18'	465	8'		21	10	30
Salon 205	26' x 18'	465	8'		21	10	30
Salon 207	39' x 18'	702	8'		35	24	40
Salon 209	39' x 18'	702	8'		35	24	40
Franklin Boardroom	35' x 24'	840	8'				
Characters	47' x 29'	1950	10'		90	51	60

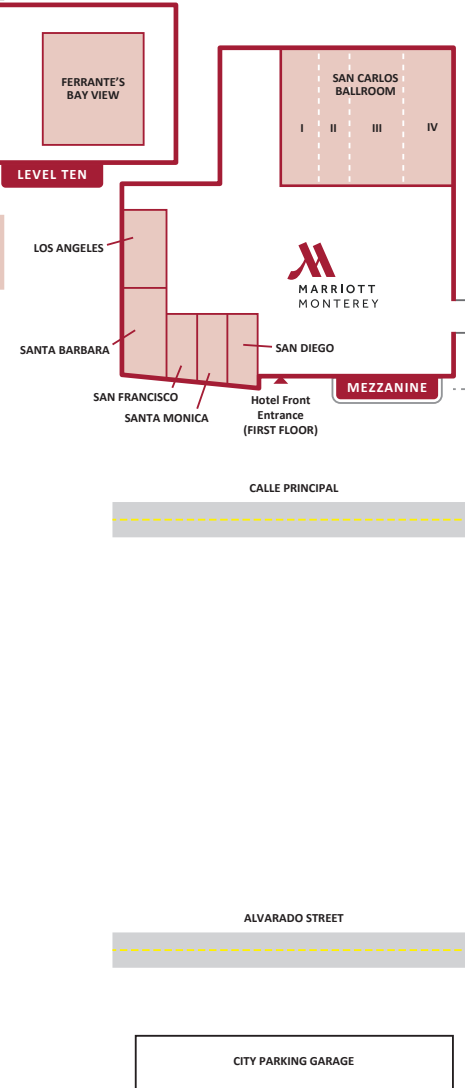

For conference attendees who travel brilliantly, seeking the ideal location, the Monterey Conference Connection and the Monterey Marriott is the perfect destination. The hotel's ideal location, in historic downtown, directly connected to the Monterey Conference Center, affords our guests easy access to the many inspiring experiences afforded each season on the Monterey Peninsula.

The 341 room Monterey Marriott welcomes the guest insisting on a balanced stay that facilitates work through high bandwidth wireless internet access; flexible function space and exceptional event planning and execution. The hotel's "great room" creates the ultimate atmosphere for networking and social engagement. Our Monterey Marriott boasts the only 10th floor ballroom with scenic views of the Monterey Bay.

The hotel is focused on extending exceptional service, which affords a rich, fun and productive visit to the central California coast. The Monterey Marriott is positioned as the optimal launch pad for the sophisticated multi-tasking guest, seeking local flavors and experiences melded with personal achievement.

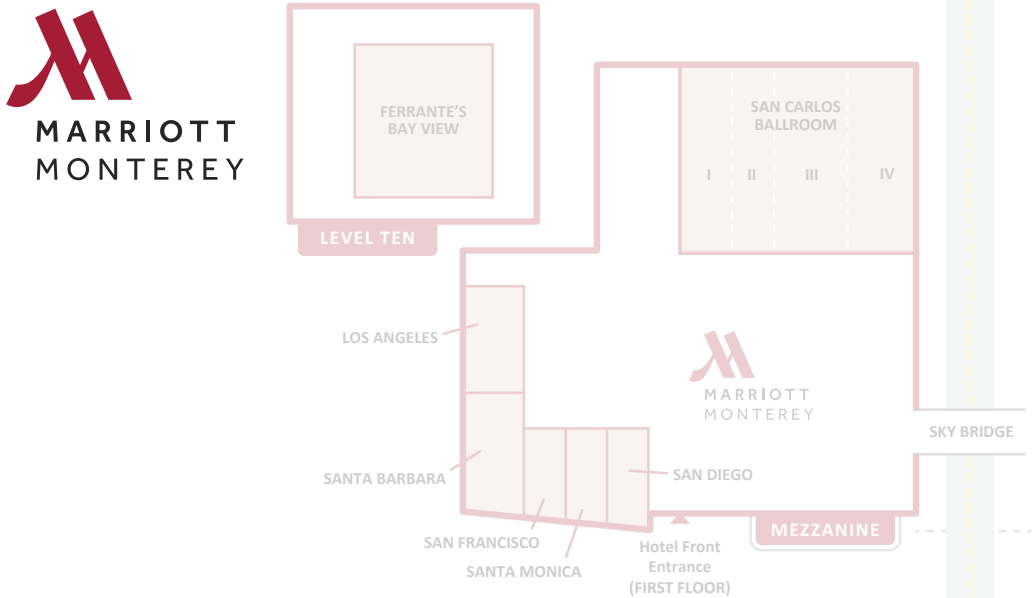

Marriott.com/hotels/travel/mryca-monterey-marriott

MONTEREY CONFERENCE CONNECTION

For conference attendees who seek the ideal location, Monterey is the perfect destination. Our area offers ample lodging properties that range from large hotels with conference spaces to quaint bed & breakfast establishments to high-end retreats.

The Monterey Conference Connection brings together the Monterey Marriott, the Portola Hotel & Spa and the Monterey Conference Center to deliver unparalleled conferences and events on the Central Coast of California. Together these properties offer 85,000+ square feet of flexible meeting space and 800+ hotel rooms, catering services and much more, all in a spectacular setting.

Monterey Conference Center *Where Inspiration and Innovation Meet™*

Discover the newly transformed Monterey Conference Center, a state-of-the-art meetings facility famous for innovative events in the heart of a destination world-renowned for inspiration. After undergoing an amazing \$60+ million renovation the facility will soon be LEED®-EB certified with 40,000+ square feet of flexible meeting space.

The Monterey Conference Center is known as a hub of innovation within Monterey County, a destination replete with awe-inspiring scenic beauty and a vast array of unique places and extraordinary spaces to create life and business enriching moments. For a destination and venue that will inspire and invigorate your meeting attendees, look no further than Monterey.

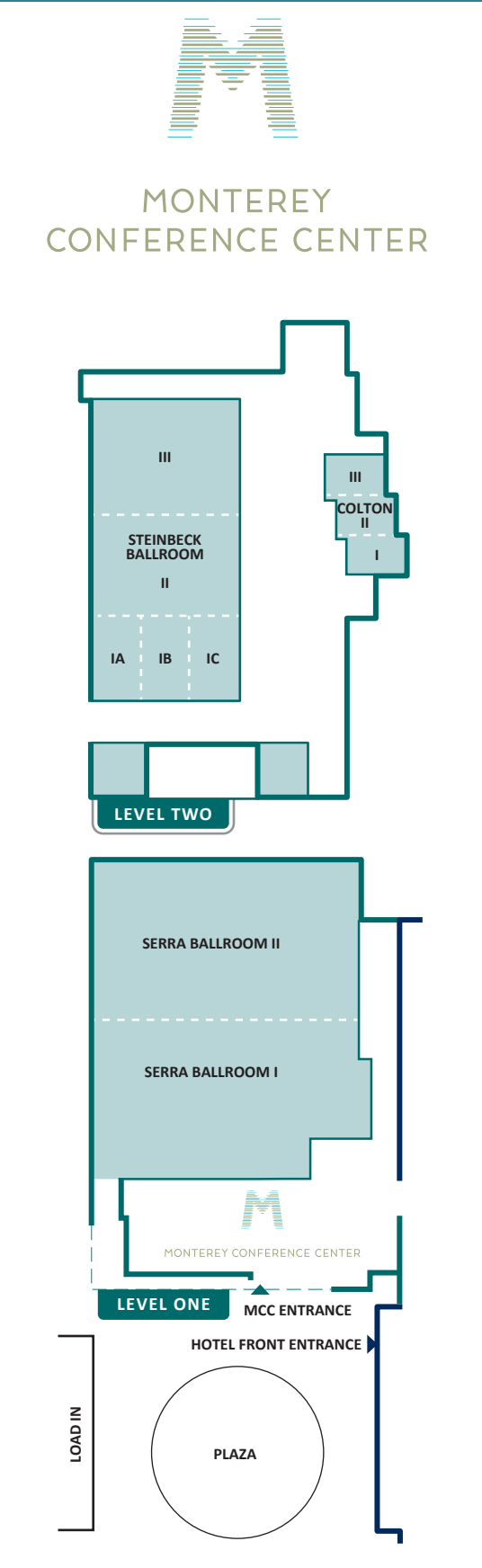

Where Inspiration and Innovation Meet™



Award-winning Portola Hotel & Spa at Monterey Bay captures the essence of picturesque Monterey Peninsula's historic location. Our Four Diamond, LEED® Certified Hotel overlooks the harbor and one of the largest Marine Sanctuaries in the United States. Area attractions such as Fisherman's Wharf, Del Monte Beach, Cannery Row and Monterey Bay Aquarium are easily accessible along the paved recreational trail, just steps outside our doors. Our expansive meeting space boasts 1 Gbps of powerful connectivity and a professional conference services team to ensure inspired Monterey moments in meetings and interactive team building experiences.

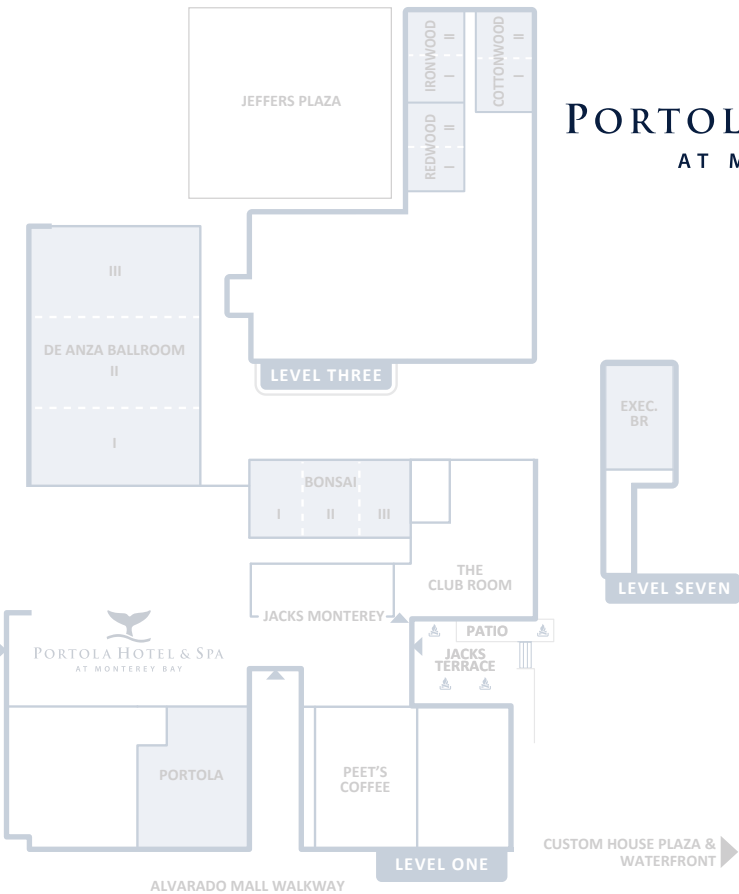

PORTOLA HOTEL & SPA
AT MONTEREY BAY

Find out more about the Monterey Conference Connection: MontereyConferenceCenter.com

PortolaHotel.com