



MONDAY: Closed (Except Holidays)
TUESDAY-SATURDAY: 9am–5pm
SUNDAY: 11am–5pm
MEMBER-ONLY HOURS: Sundays 10–11am



MONDAY: Closed (Except Holidays)
WEDNESDAY-SUNDAY: Please check
rmsc.org/planetariumschedule
for programming.
WEDNESDAY-FRIDAY: 1:30–5pm



MONDAY & TUESDAY: Closed
WEDNESDAY-FRIDAY: 9am–4pm
SATURDAY & SUNDAY: 9am–5pm
Check rmsc.org/cnc
for special programming.

1 1st Floor

- WONDER what's up with water? Find out in *Wonders of Water*.
- MAKE the Earth shake with the Earthquake Simulator!
- MARVEL at Murray the Mastodon in *Expedition Earth*!
- OPERATE a crane in *Under Construction*!

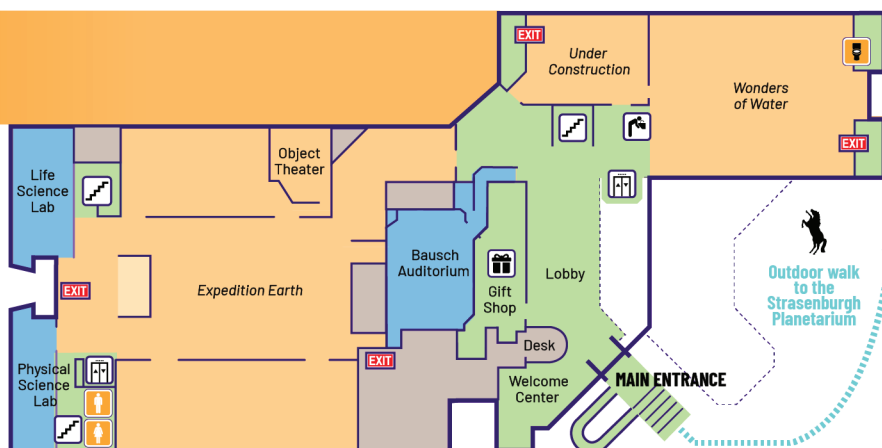

2 2nd Floor

- PLAY with air and sound to create music in our *Sound Bites* gallery!
- JOIN in the conversation on individual, institutional, and structural racism in *Take it Down*!
- IMMERSE yourself in real-time satellite data from NASA & NOAA in *Science on a Sphere*!

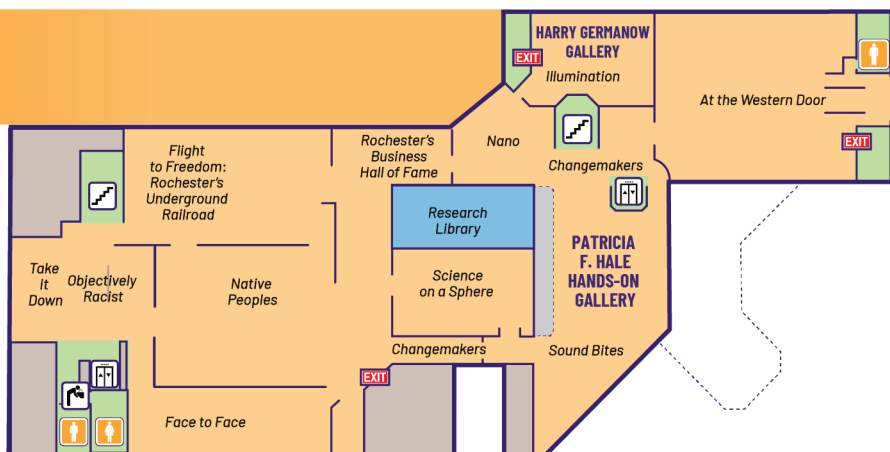

3 3rd Floor

- TRANSPORT yourself through time to Rochester in 1838, and watch it grow before your eyes with our AR experience!
- TEST your speed & power-up in *Energy Trail*!
- WATCH an electrifying show in the *Electricity Theater*!

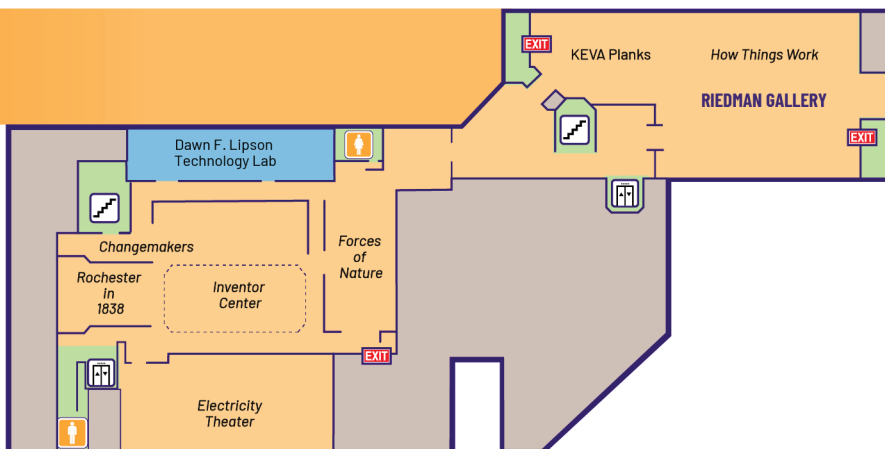

M Mezzanine

FOR RESERVED PROGRAMMING ONLY:

- Mezzanine Gallery
- Carlson Inquiry Room
- Bernard B. Brody Learning Lab (BBLL)

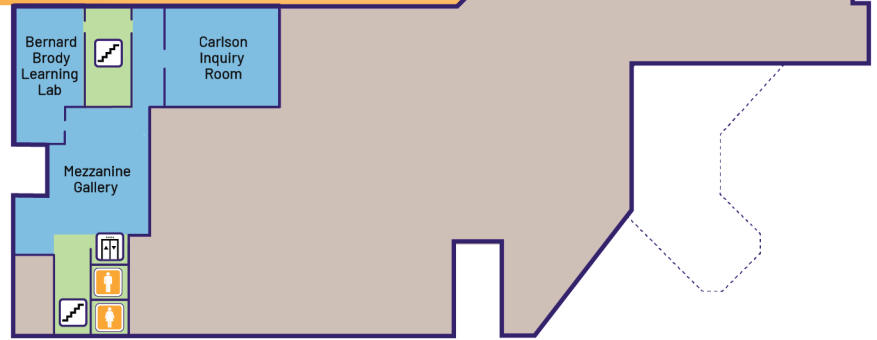

B Basement

- RMSC Galaxy Café
- Vending Machines
- Outdoor Patio

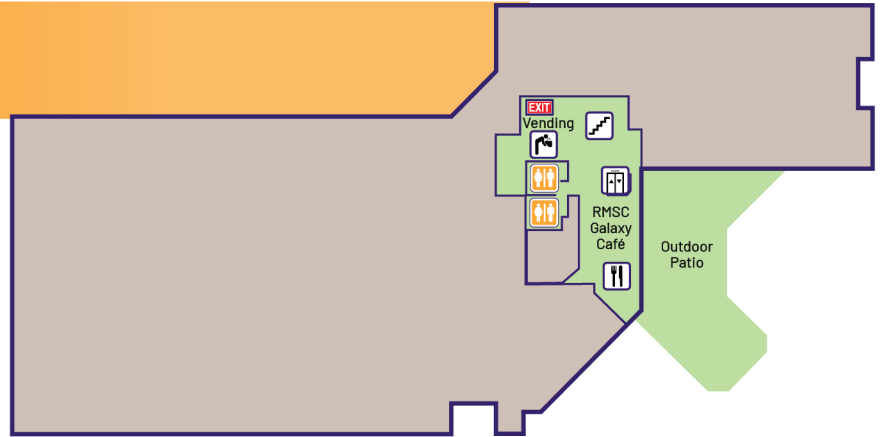

RMSC ROCHESTER CAMPUS MAP



MUSEUM & SCIENCE CENTER

- Exhibits
- Bausch Auditorium
- Gift Shop
- Galaxy Café

EISENHART AUDITORIUM

- USS Rochester



STRASENBURGH PLANETARIUM

- Star Theater
- Space Tunnel
- Rochester's Eyes in Space
- Same Sky

...and don't forget about...



CUMMING NATURE CENTER

- Located an hour south of Rochester
- 6472 Gulick Road
- Naples, NY 14512
- 15 miles of trails for hiking, skiing, and showshoeing. Rentals available.
- Visitor Center
- Exhibits
- Programs

