

FLOOR PLANS

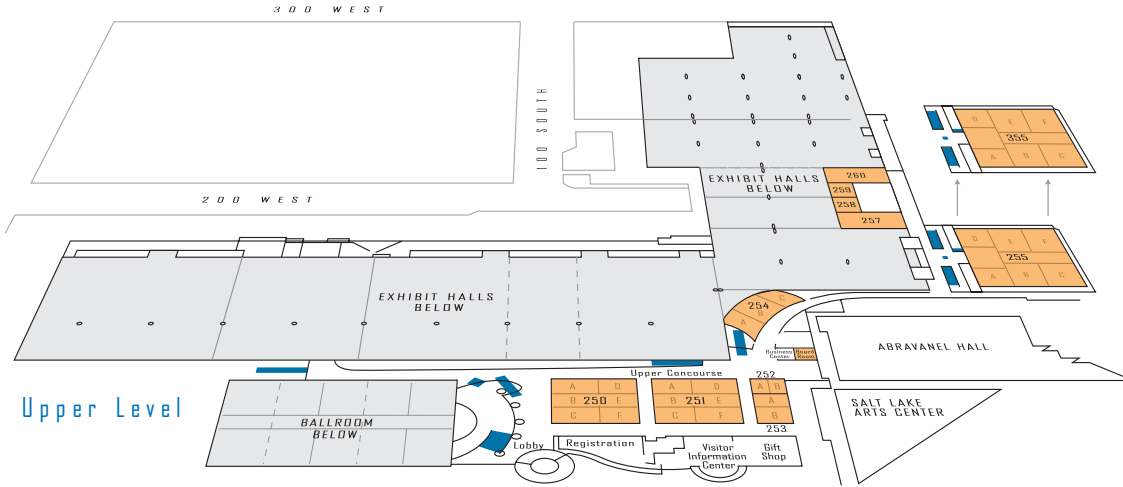

Upper Level

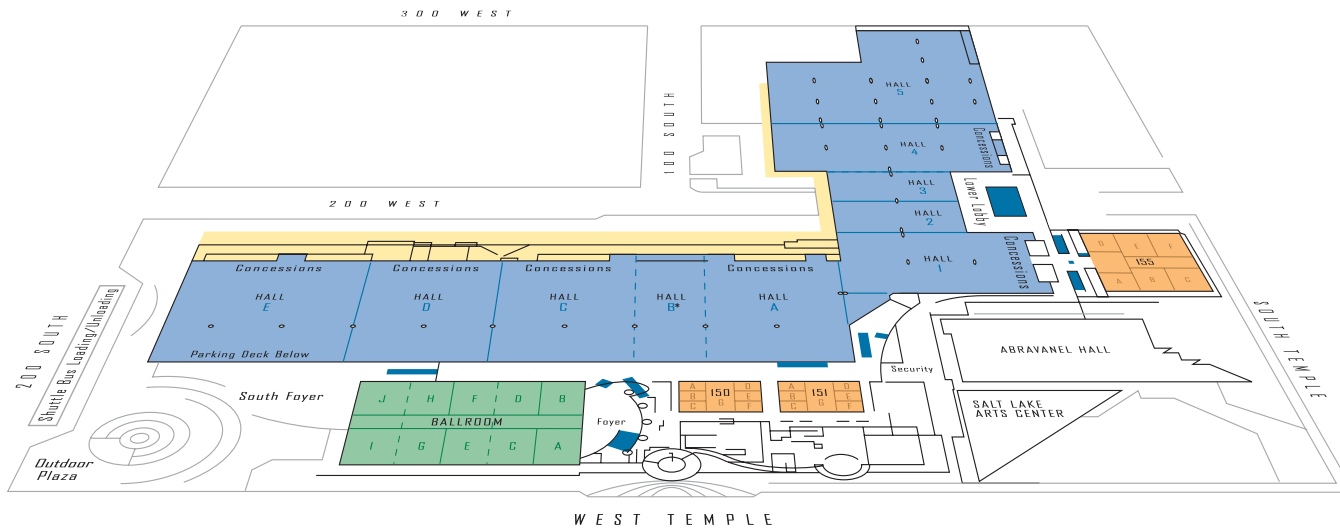

Lower Level

EXHIBIT HALLS

ROOM	SQ. FT.	Theatre	Banquet	Classroom	Ceiling
Exhibit Hall A	48,600	5,300	2,700	2,700	30'
Exhibit Hall B*	24,300	2,600	1,350	1,300	30'
Exhibit Hall C	48,600	5,300	2,700	2,700	30'
Exhibit Hall D	48,600	5,300	2,700	2,700	30'
Exhibit Hall E	64,800	7,100	3,600	3,400	30'
Exhibit Hall I	48,600	5,300	2,700	2,700	30'
Exhibit Hall 2	16,200	1,700	900	700	30'
Exhibit Hall 3	16,200	1,700	900	700	30'
Exhibit Hall 4**	64,400	6,500	3,000	3,000	30'
Exhibit Hall 5**	130,300	12,000	6,000	6,000	30'

* Hall B is not a stand-alone hall; must be used in conjunction with A or C.

** Halls 4 and 5 show projected numbers—convention center expansion will be complete in August 2006.

BALLROOM

ROOM	SQ. FT.	Theatre	Banquet	Classroom	Ceiling
Ballroom	45,000	4,900	2,730	2,500	30'
Room A	3,820	400	200	190	30'
Room B	3,820	400	200	190	30'
Room C	3,820	400	200	190	30'
Room D	3,820	400	200	190	30'
Room E	3,820	400	200	190	30'
Room F	3,820	400	200	190	30'
Room G	3,820	400	200	190	30'
Room H	3,820	400	200	190	30'
Room I	3,820	400	200	190	30'
Room J	3,820	380	200	190	30'

MEETING ROOMS

ROOM	SQ. FT.	Theatre	Banquet	Classroom	Ceiling
Room 150 A-G	6,080	700	350	340	15'
Room 150A	600	50	20	20	15'
Room 150B	590	60	20	20	15'
Room 150C	660	60	20	20	15'
Room 150D	600	50	20	20	15'
Room 150E	590	60	20	20	15'
Room 150F	660	60	20	20	15'
Room 150G	2,380	250	140	120	15'
Room 151 A-C	6,500	700	350	330	15'
Room 151A	625	50	20	20	15'
Room 151B	600	60	20	20	15'
Room 151C	670	60	20	20	15'
Room 151D	625	50	20	20	15'
Room 151E	600	60	20	20	15'
Room 151F	670	60	20	20	15'
Room 151G	2,710	270	140	120	15'

- Escalators/Elevators/Stairs
- Exhibit Halls
- Meeting Rooms
- Ballroom
- Loading Docks

MEETING ROOMS (cont.)

ROOM	SQ. FT.	Theatre	Banquet	Classroom	Ceiling
Room 155 A-F	24,000	2,400	1,000	1,100	15'
Room 155A	2,530	260	120	120	15'
Room 155B	3,240	300	150	160	15'
Room 155C	3,240	300	150	160	15'
Room 155D	2,530	260	120	120	15'
Room 155E	3,240	300	150	160	15'
Room 155F	3,240	300	150	160	15'
Room 250 A-F	8,300	850	500	430	20'
Room 250A	1,450	120	80	80	20'
Room 250B	1,470	120	80	80	20'
Room 250C	1,480	120	80	80	20'
Room 250D	1,300	110	60	60	20'
Room 250E	1,300	110	60	60	20'
Room 250F	1,300	110	60	60	20'
Room 251 A-F	8,800	900	550	450	20'
Room 251A	1,300	110	60	60	20'
Room 251B	1,300	120	60	70	20'
Room 251C	1,300	120	80	80	20'
Room 251D	1,600	150	80	80	20'
Room 251E	1,600	150	80	80	20'
Room 251F	1,700	150	80	80	20'
Room 252 A-B	980	80	50	40	12'
Room 252A	490	40	20	15	12'
Room 252B	490	40	20	15	12'
Room 253 A-B	2,000	200	100	90	12'
Room 253A	990	100	40	40	12'
Room 253B	1,010	100	40	40	12'
Room 254 A-C	4,500	450	240	220	20'
Room 254A	1,000	100	60	40	20'
Room 254B	2,500	250	120	140	20'
Room 254C	1,000	100	60	40	20'
Room 255 A-F	24,000	2,400	1,000	1,100	15'
Room 255A	2,530	260	120	120	15'
Room 255B	3,240	300	150	160	15'
Room 255C	3,240	300	150	160	15'
Room 255D	2,530	260	120	120	15'
Room 255E	3,240	300	150	160	15'
Room 255F	3,240	300	150	160	15'
Room 257	1,790	170	100	100	13'
Room 258	1,420	140	60	90	13'
Room 259	1,420	140	60	90	13'
Room 260	1,790	170	100	100	13'
Room 355 A-F	24,000	2,400	1,000	1,100	18'
Room 355A	2,530	260	120	120	18'
Room 355B	3,240	300	150	160	18'
Room 355C	3,240	300	150	160	18'
Room 355D	2,530	260	120	120	18'
Room 355E	3,240	300	150	160	18'
Room 355F	3,240	300	150	160	18'
Kenneth Knight Boardroom	permanent boardroom table for 20				10'

For more information visit www.saltpalace.com