

FRANK W.  
**MAYBORN**  
CIVIC & CONVENTION CENTER



**AMENITIES**

FULL SERVICE IN-HOUSE CATERING

RECEPTION AREA

ROOM OPTIONS: MAIN HALL,  
HALLS A-C, NORTH ROOMS AND  
SOUTH ROOMS

FLEXIBLE EVENT SPACE

FULL BAR AVAILABLE

OUTDOOR SPACE

WIRELESS INTERNET/WI-FI

MAXIMUM CAPACITY OF 3,795  
INDIVIDUALS

Conveniently located off I-35, the Frank W. Mayborn Civic and Convention Center is the place to be for events large and small. The facility has separate halls and rooms for rent enabling our guests the opportunity to rent as much of the center as needed for their special events. With a maximum capacity of 3,795 individuals and approximately 30,000 sq. ft. of meeting space, this venue has all the necessities needed to make your event a success.

Don't settle on your event expectations. Whether your event is a convention, corporate meeting, or private event, the staff at the Frank W. Mayborn Civic and Convention Center are ready to give you extraordinary service without exception by designing the perfect layout to bring your vision to life.

**Rental Details**

For information on rates and availability call (254) 298-5720.



3303 N 3RD ST, TEMPLE, TX 76501 ★ 254.298.5720

**DISCOVERTEMPLE.COM** @ f

#discovertemple #visittemple #experiencetemple #TPLTX

## PLEASE NOTE

- Rental Rates for side rooms include tables and chairs
- Rental minimums apply to weekends and holidays
- \$200 set-up fee for halls includes: tables, chairs, wired mic, podium and 8x16 stage
- Kitchen \$300.00 (Kitchen rental is not included in the entire building pricing and can only be rented by approved caterers)
- Special military pricing available

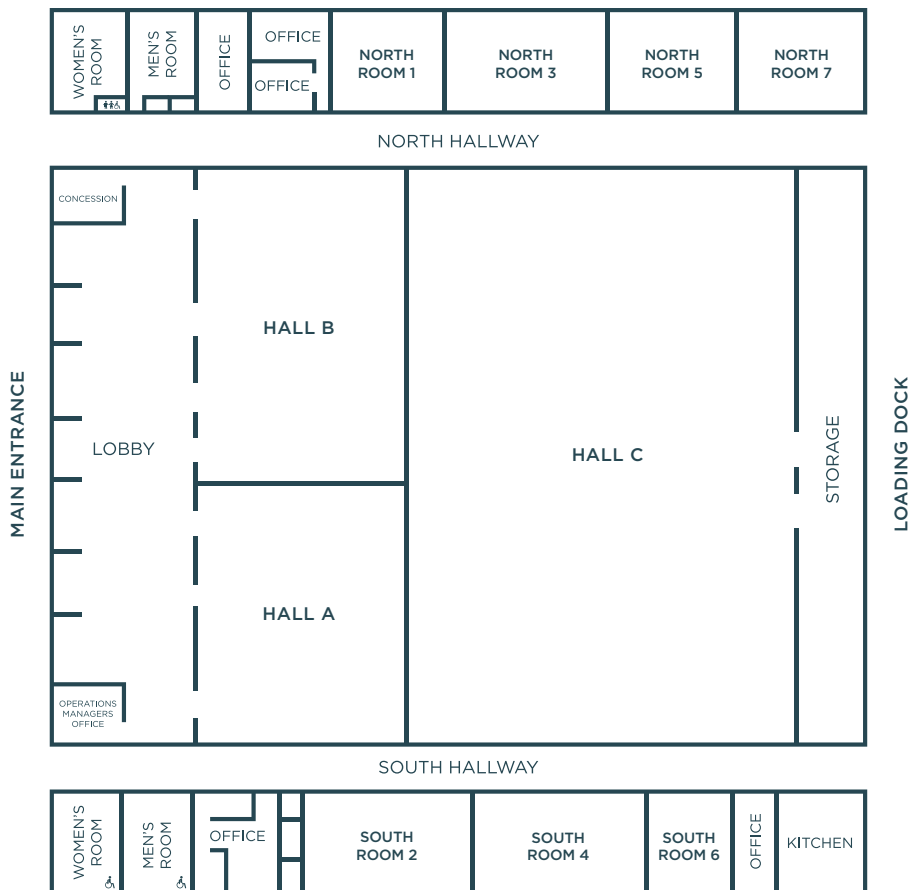

## PRICING

	WEEKDAY 6 HOUR	WEEKDAY FULL DAY	WEEKEND 6 HOUR	WEEKEND FULL DAY
MAIN HALL (A, B & C)	\$880	\$990	\$990	\$1100
HALL A	\$275	\$330	\$330	\$385
HALL B	\$330	\$385	\$385	\$440
HALL C	\$550	\$660	\$660	\$770
NORTH ROOMS	\$220	\$330	\$330	\$390
SOUTH ROOMS	\$170	\$280	\$280	\$330
ENTIRE BUILDING	\$990	\$1100	\$1100	\$1200

## CAPACITY

	LxWxH	FT <sup>2</sup>	AUDITORIUM	BANQUET	CLASSROOM	10x10 BOOTHS
MAIN HALL (A, B & C)	133x140x22'	18,620	1926	880	1002	88
HALL A	59x50x22'	2,929	278	128	105	13
HALL B	74x50x22'	3,737	378	160	141	19
HALL C	133x90x22'	11,970	1236	528	630	60
NORTH ROOM 1	30x25x12'	645	50	32	24	N/A
NORTH ROOM 3	43x25x12'	925	95	48	39	N/A
NORTH ROOMS 5-7	34x25x12'	366	60	24	18	N/A
SOUTH ROOMS 2-4	53x23x12'	432	25	24	16	N/A
SOUTH ROOM 6	22x23x12'	1,070	116	64	55	N/A