

FRANK W.
MAYBORN
CIVIC & CONVENTION CENTER



AMENITIES

FULL SERVICE IN-HOUSE CATERING

RECEPTION AREA

ROOM OPTIONS: MAIN HALL,
HALLS A-C, NORTH ROOMS AND
SOUTH ROOMS

FLEXIBLE EVENT SPACE

FULL BAR AVAILABLE

OUTDOOR SPACE

WIRELESS INTERNET/WI-FI

MAXIMUM CAPACITY OF 3,795
INDIVIDUALS

Conveniently located off I-35, the Frank W. Mayborn Civic and Convention Center is the place to be for events large and small. The facility has separate halls and rooms for rent enabling our guests the opportunity to rent as much of the center as needed for their special events. With a maximum capacity of 3,795 individuals and approximately 30,000 sq. ft. of meeting space, this venue has all the necessities needed to make your event a success.

Don't settle on your event expectations. Whether your event is a convention, corporate meeting, or private event, the staff at the Frank W. Mayborn Civic and Convention Center are ready to give you extraordinary service without exception by designing the perfect layout to bring your vision to life.

Rental Details

For information on rates and availability call (254) 298-5720.



3303 N 3RD ST, TEMPLE, TX 76501 ★ 254.298.5720

DISCOVERTEMPLE.COM @ f

#discovertemple #visittemple #experiencetemple #TPLTX

PLEASE NOTE

- Rental Rates for side rooms include tables and chairs
- Rental minimums apply to weekends and holidays
- \$200 set-up fee for halls includes tables and chairs.
- Kitchen \$350.00 (Kitchen rental is not included in the entire building pricing and can only be rented by approved caterers)
- Special military pricing available

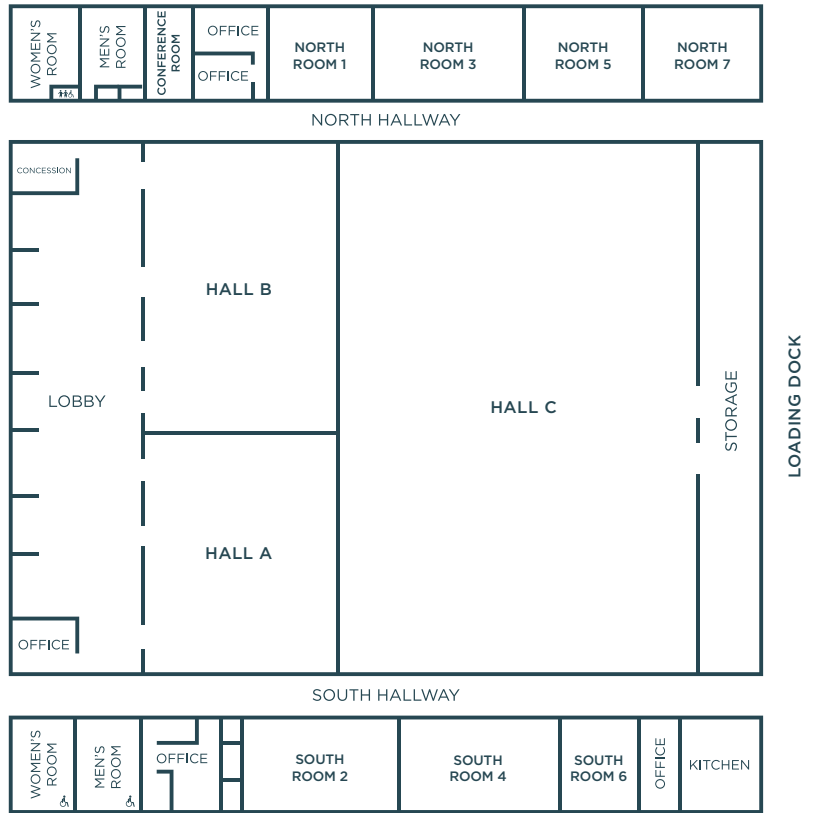

PRICING

| | WEEKDAY 6 HOUR | WEEKDAY FULL DAY | WEEKEND 6 HOUR | WEEKEND FULL DAY |
|----------------------|-------------------------------|------------------|----------------|------------------|
| MAIN HALL (A, B & C) | \$880 | \$990 | \$990 | \$1100 |
| HALL A | \$275 | \$330 | \$330 | \$385 |
| HALL B | \$330 | \$385 | \$385 | \$440 |
| HALL C | \$550 | \$660 | \$660 | \$770 |
| NORTH ROOMS | \$220 | \$330 | \$330 | \$390 |
| SOUTH ROOMS | \$170 | \$280 | \$280 | \$330 |
| ENTIRE BUILDING | \$990 | \$1100 | \$1100 | \$1200 |
| CONFERENCE ROOM | \$20/HR SPECIAL RULES APPLY | | | |

CAPACITY

| | LxWxH | FT ² | AUDITORIUM | BANQUET | CLASSROOM | 10x10 BOOTHS |
|----------------------|-------------|-----------------|--------------------------|---------|-----------|--------------|
| MAIN HALL (A, B & C) | 133x140x22' | 18,620 | 1926 | 880 | 1002 | 88 |
| HALL A | 59x50x22' | 2,929 | 278 | 128 | 105 | 13 |
| HALL B | 74x50x22' | 3,737 | 378 | 160 | 141 | 19 |
| HALL C | 133x90x22' | 11,970 | 1236 | 528 | 630 | 60 |
| NORTH ROOM 1 | 30x25x12' | 645 | 50 | 32 | 24 | N/A |
| NORTH ROOM 3 | 43x25x12' | 925 | 95 | 48 | 39 | N/A |
| NORTH ROOMS 5-7 | 34x25x12' | 366 | 60 | 24 | 18 | N/A |
| SOUTH ROOMS 2-4 | 53x23x12' | 1,070 | 116 | 64 | 55 | N/A |
| SOUTH ROOM 6 | 22x23x12' | 432 | 25 | 24 | 16 | N/A |
| CONFERENCE ROOM | 15x25x12' | 375 | *CONFERENCE ROOM SEATS 8 | | | |