

# MARS MUSIC HALL

The industrial inspired **Mars Music Hall** is a performing venue with a 1,350-person capacity. The intimate character of the venue's broad, not-a-bad-seat-in-the-house design with its wrapping balcony overlooking a 50 foot wide stage offers great acoustics for a variety of events ranging from concerts to comedy acts and everything in between. The Hall has a sound and lighting system.

- **RENTAL:** \$6,000 including sound & lights.
- **RENTAL RATES** includes lighting, heating and/or air conditioning. All labor, supplies and equipment are considered additional expenses and will be charged at rates as outlined in Equipment, services & staffing and AUDIOVISUAL sheets.
- **MOVE-IN/MOVE-OUT** dates are calculated at sixty percent (60%) of the normal daily rental rates.
- **INSURANCE** required for events in the Mars Music Hall cannot be obtained by the VBC and it is therefore the sole responsibility of the Lessee to procure sufficient insurance.

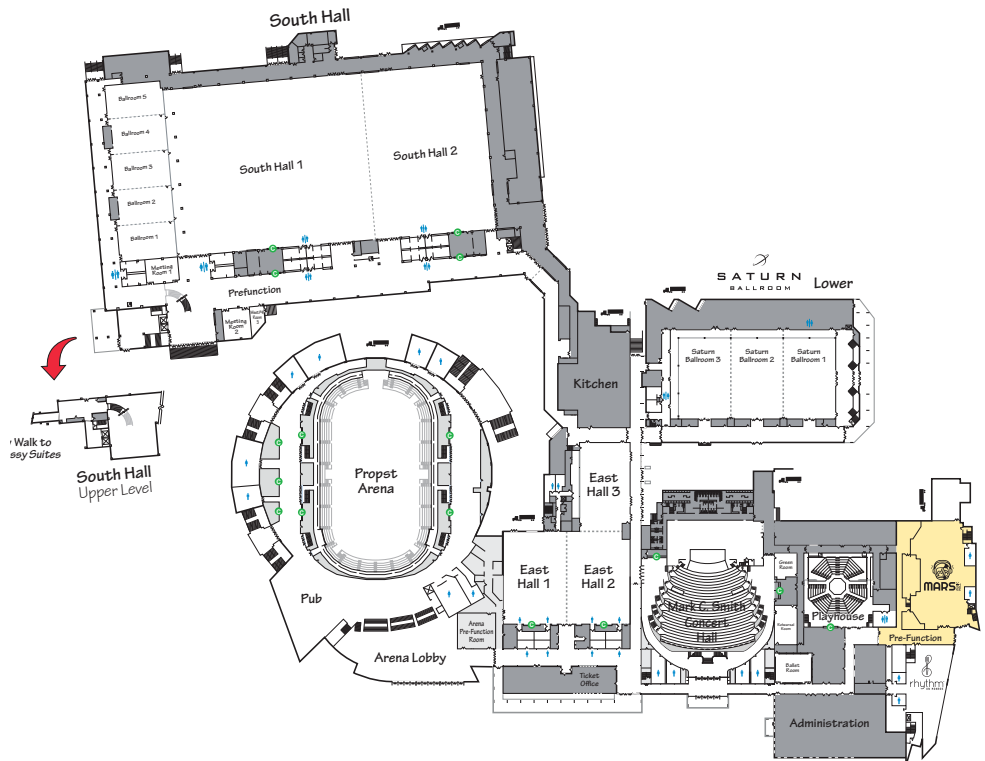

# Mars Music Hall Floor Plan

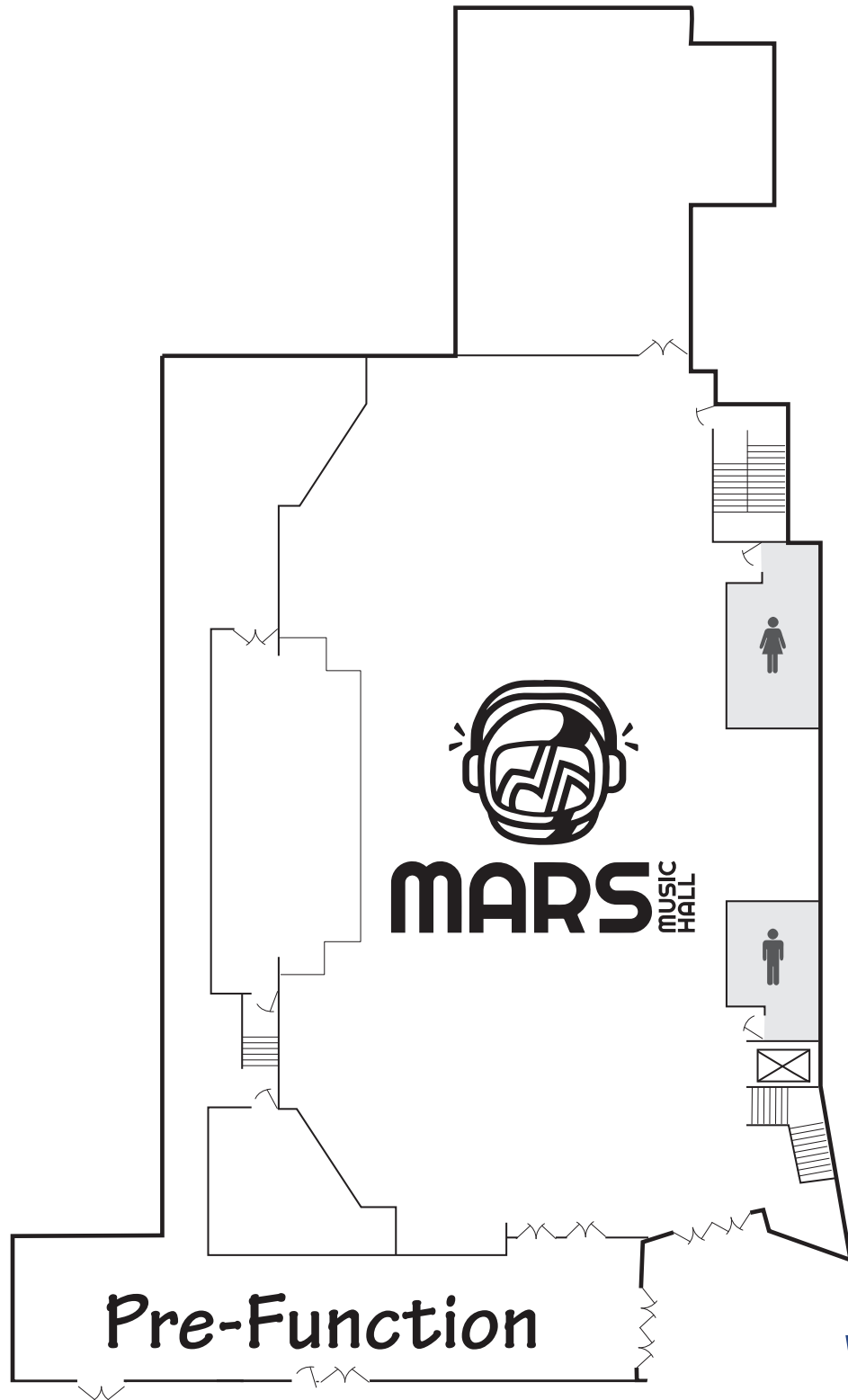

**VBC**  
VON BRAUN  
CENTER

700 Monroe Street  
Huntsville, Alabama 35801  
256-533-1953  
fax 256-551-2203  
[www.vonbrauncenter.com](http://www.vonbrauncenter.com)  
[marketing@vonbrauncenter.com](mailto:marketing@vonbrauncenter.com)