

# SOUTH HALL

The **South Exhibit Hall** has 35' ceilings and a 350 pound per square foot load capacity making it the perfect location for large trade and consumer shows, conventions and banquets.

The South Ballroom overlooking Big Spring International Park is complete with beautiful chandeliers and carpet providing an elegant setting for banquet and social functions.

- **RENTAL RATES** include lighting, heating and/or air conditioning and water as installed. All labor, supplies and equipment are considered additional expenses and will be charged at rates as outlined in the EQUIPMENT, SERVICES & STAFFING, and AUDIOVISUAL sheets.

- **MOVE-IN / MOVE-OUT** and rehearsal dates are calculated at sixty percent (60%) of the normal daily rental rates.
- **INSURANCE** can be obtained by the VBC at the applicable rate.

	EXHIBIT SPACE						
	DIMENSIONS	SQ. FT.	THEATER	BANQUET	CLASSROOM	BOOTHS 10' X 10'	DAILY RATE
Total South Hall (includes all space)	210' x 480'	100,800	10,080	6,700	5,040	600	\$8,820
South Exhibit Hall Ceiling 35'	210' x 390'	81,900	8,000	5,000	4,000	500	\$7,170
South Hall 1	210' x 240'	50,400	5,000	3,360	2,520	300	\$4,675
South Hall 2	210' x 150'	31,500	3,150	2,100	1,575	200	\$2,920
South Ballroom Ceiling 18'-22'	220' x 74'	16,280	1,500	1,000	750	75	\$2,785
Ballroom 1	45' x 74'	3,330	315	205	150	15	\$630
Ballroom 2	45' x 74'	3,330	315	205	150	15	\$630
Ballroom 3	45' x 74'	3,330	315	205	150	15	\$630
Ballroom 4	45' x 74'	3,330	315	205	150	15	\$630
Ballroom 5	40' x 74'	3,330	280	185	140	15	\$630
Meeting Room 1	30' x 40'	1,200	120	80	60		\$260
Meeting Room 2	34' x 40'	1,360	135	90	65		\$260
Meeting Room 3	20' x 18'	360	30				\$170
Lobby		4,200					\$350
Ballroom Pre-function		6,432					\$580
Exhibit Pre-function		10,400					\$1,155

\*Utilities available - Power; water; air, phone, cable & internet

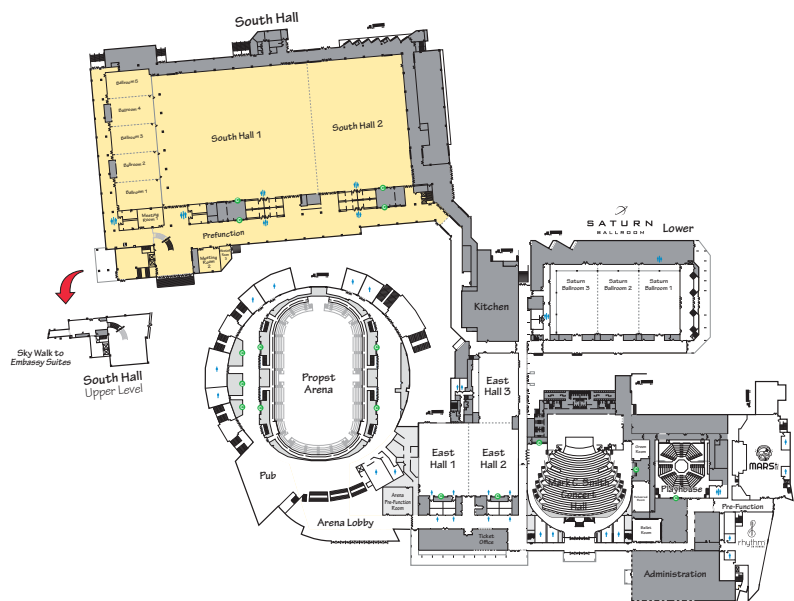

# South Hall Floor Plan

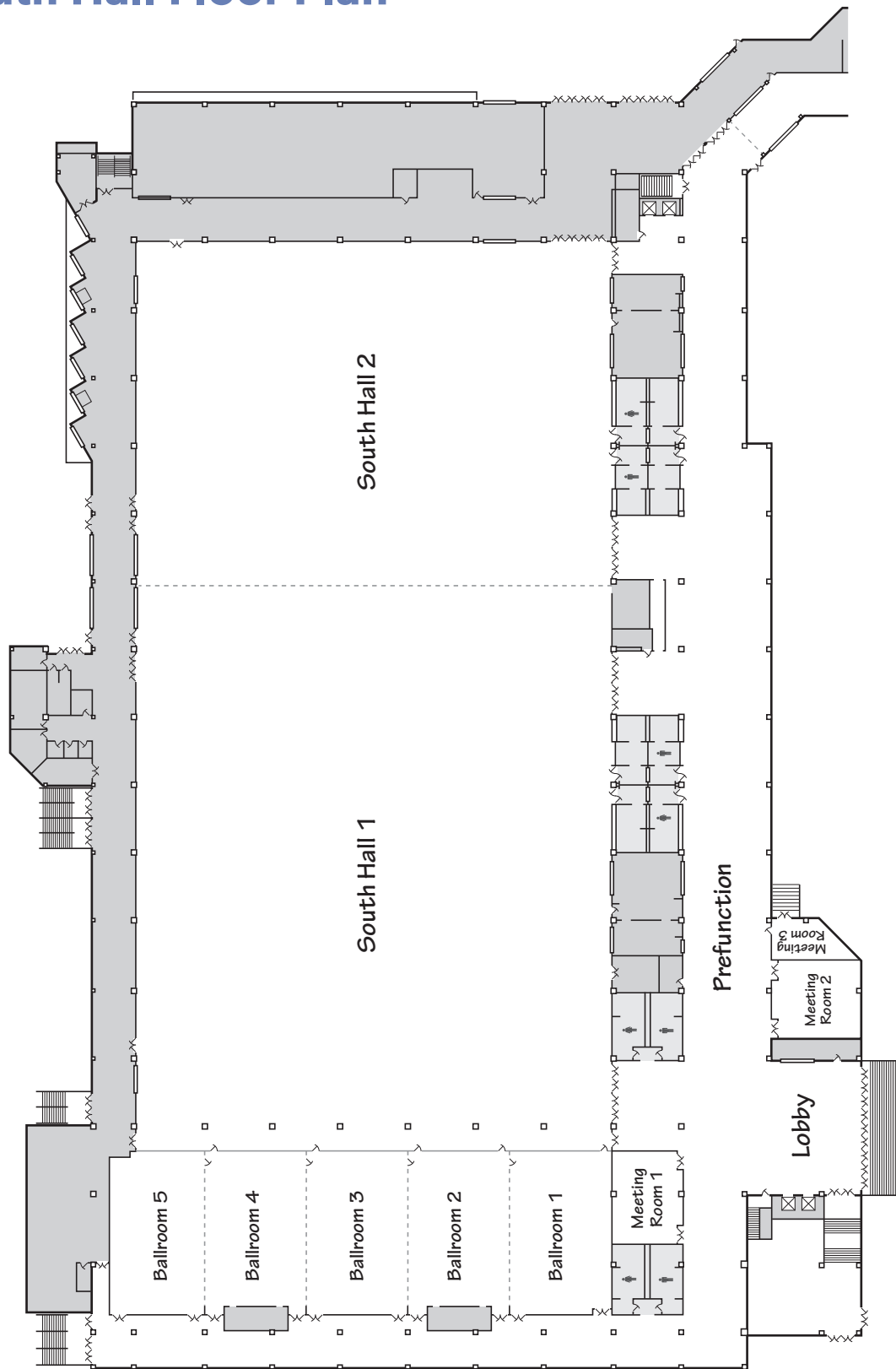

700 Monroe Street  
Huntsville, Alabama 35801  
256-533-1953  
fax 256-551-2203  
[www.vonbrauncenter.com](http://www.vonbrauncenter.com)  
[marketing@vonbrauncenter.com](mailto:marketing@vonbrauncenter.com)