

MARK C. SMITH CONCERT HALL

The luxurious **Mark C. Smith Concert Hall**, seating 1,955 continental style, is a performing venue for everything from Broadway to ballet and symphonies to concerts. The theatre is also used as a meeting area for conferences and seminars.

The Concert Hall has dressing room accommodations for sixty performers and a double-bay loading dock accessible at stage level through a 12' x 18' service door. The stage has a 54' x 48' performing area, a hydraulic orchestra pit, a 54 line counterweight system, a full orchestra acoustical shell and complete sound and lighting systems. A Green Room reception area is located adjacent to the Concert Hall.

- **COMMERCIAL RENTAL:** \$4,500 per day or 12% of gross ticket receipts after taxes, whichever is greater.
- **NON-COMMERCIAL RENTAL:** \$4,000 per day or 10% of gross ticket receipts after taxes, whichever is greater.
- **NON-COMMERCIAL RENTAL:** Applies to qualified religious, charitable or educational organizations where no admission is charged, no fee is taken, no collection is made or no revenue is derived. Local non-profit organizations that charge admission, take fees, collections or derive revenue may qualify for the non-commercial rental.
- **RENTAL RATES** include basic lighting, heating and/or air conditioning and water as installed. With the exception of basic lighting equipment, all labor, supplies and equipment are considered additional expenses and will be charged at rates as outlined in the Equipment, services & staffing, and AUDIOVISUAL sheets.
- **BALLET ROOM** Rental: \$325 per day
- **MOVE-IN / MOVE-OUT** and rehearsal dates are calculated at sixty percent (60%) of the normal daily rental rates.
- **INSURANCE** can be obtained by the VBC at the applicable rate.

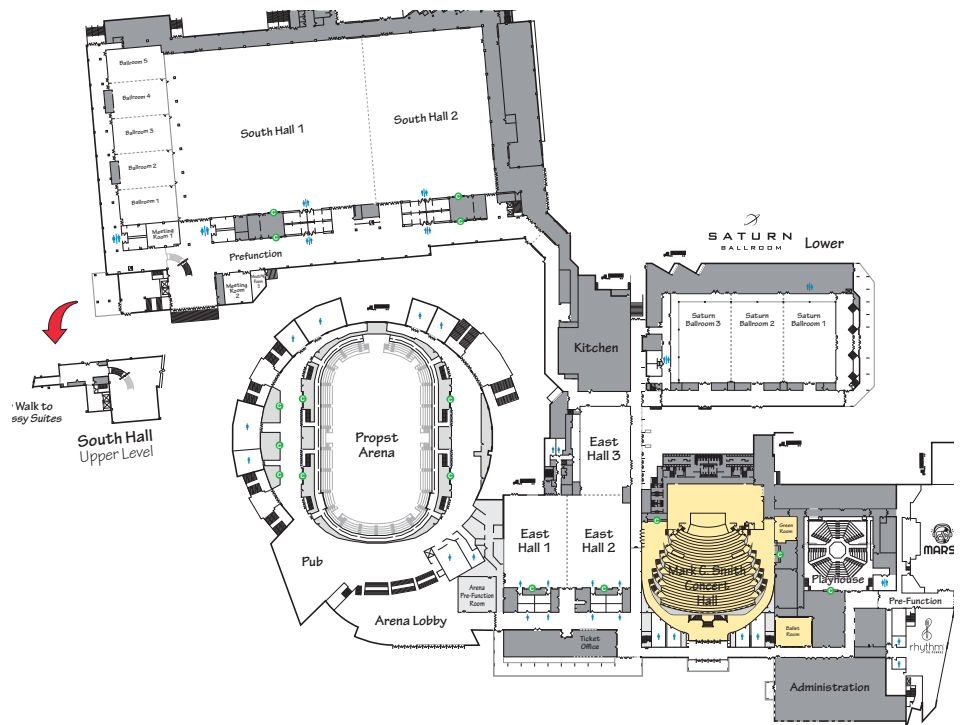
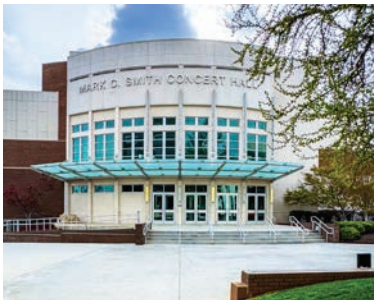

Mark C. Smith Concert Hall Floor Plan

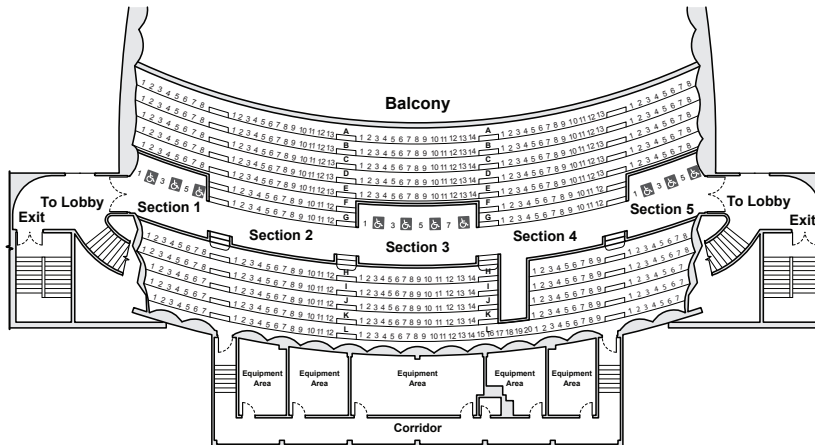
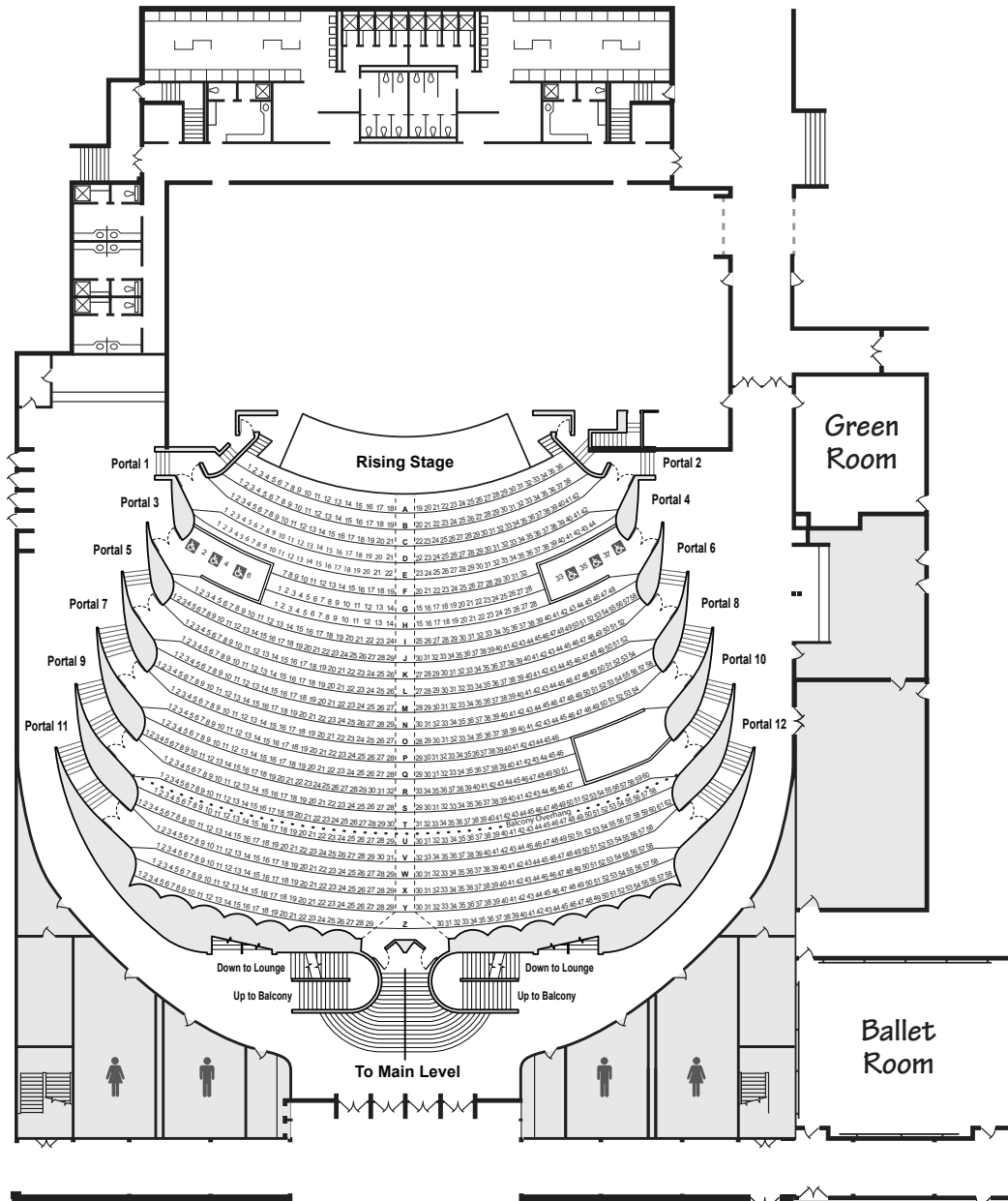

VBC
VON BRAUN
CENTER

700 Monroe Street
 Huntsville, Alabama 35801
 256-533-1953
 fax 256-551-2203
www.vonbrauncenter.com
marketing@vonbrauncenter.com