

PROPST ARENA

The **Propst Arena** is equipped to accommodate major concerts, trade and consumer shows, and family shows, as well as a full range of indoor sporting events, including basketball, ice hockey, football and rodeos. The Arena floor measures 110' x 212' and has a 400 pound per square foot load capacity. The Propst Arena also features two high definition LED video boards measuring 22' by 12' each along with two LED fascia boards measuring 4' by 99', concourse monitors and pan, tilt and zoom cameras. The state-of-the-art digital sound system is a delayed distributed array plus hub subs and distribution to concourse, lobby, bar, dressing and green rooms.

The VBC has an in-house Exhibitor Services Department for all exhibitor needs and an exclusive in-house Catering Department for food and beverage functions.

- **COMMERCIAL RENTAL:** \$9,000 or 12% of gross ticket receipts after taxes, whichever is greater.
- **NON-COMMERCIAL RENTAL:** \$7,500 or 10% of gross ticket receipts after taxes, whichever is greater.
- **NON-COMMERCIAL RENTAL:** Applies to qualified religious, charitable or educational organizations where no admission is charged, no fee is taken, no collection is made or no revenue is derived. Local non-profit organizations that charge admission, take fees, collections or derive revenue may qualify for the non-commercial rental.
- **CONFERENCE RENTAL:** \$12,000 daily rate.
- **RENTAL RATES** include lighting, heating and/or air conditioning and water as installed. All labor, supplies and equipment are considered additional expenses and will be charged at rates as outlined in the Equipment, services & staffing, and AUDIOVISUAL sheets.
- **MOVE-IN / MOVE-OUT** dates are calculated at sixty percent (60%) of the normal daily rental rates.
- **INSURANCE** required for events in the Arena cannot be obtained by the VBC and it is therefore the sole responsibility of the Lessee to procure sufficient insurance.



	CAPACITIES						
	FESTIVAL	END STAGE	HOCKEY	BASKETBALL	FLOOR SQ. FEET	BOOTHS 10'X8'	UTILITIES
Arena	9,000	8,300	6,602	7,198	21,624	144	100 Volt 208 Volt 480 Volt Power

*Special risers or staging needs may alter capacities.

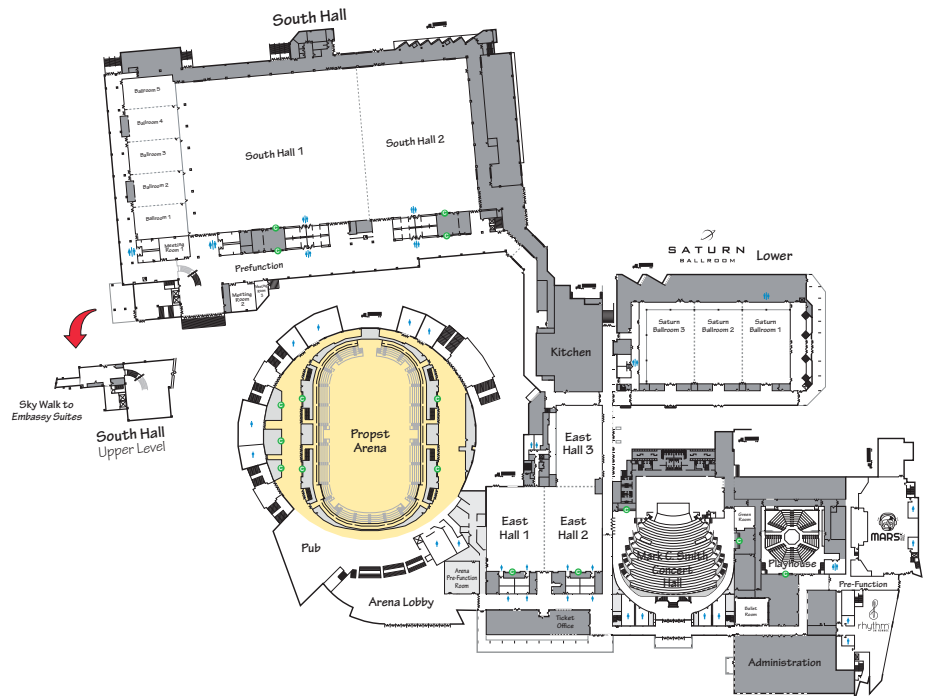

Propst Arena Floor Plan

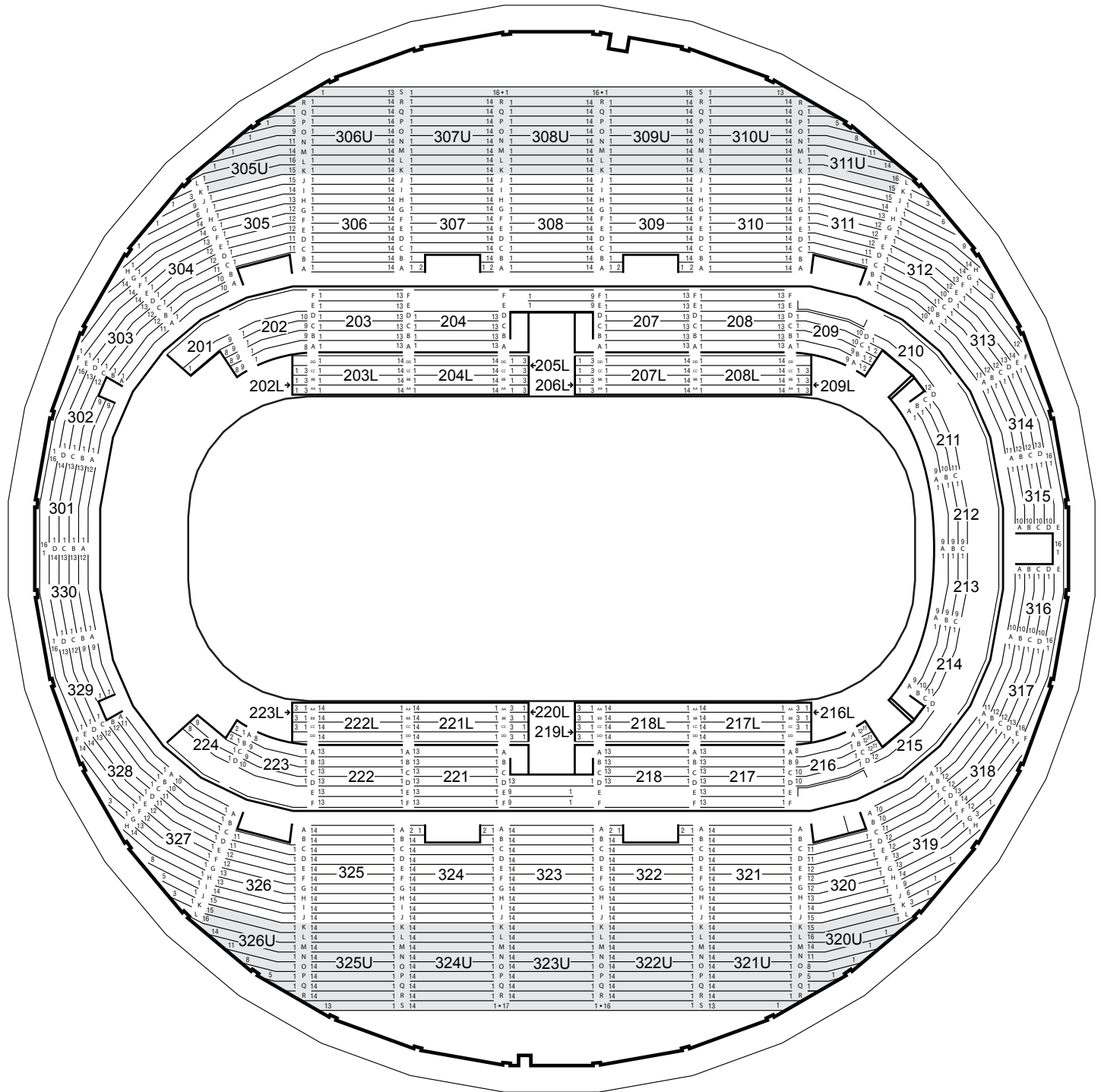

700 Monroe Street
Huntsville, Alabama 35801
256-533-1953
fax 256-551-2203
www.vonbrauncenter.com
marketing@vonbrauncenter.com