

# SOUTH HALL

The **South Exhibit Hall** has 35' ceilings and a 350 pound per square foot load capacity making it the perfect location for large trade and consumer shows, conventions and banquets.

The South Ballroom overlooking Big Spring International Park is complete with beautiful chandeliers and carpet providing an elegant setting for banquet and social functions.

- **RENTAL RATES** include lighting, heating and/or air conditioning and water as installed. All labor, supplies and equipment are considered additional expenses and will be charged at rates as outlined in the EQUIPMENT, SERVICES & STAFFING, and AUDIOVISUAL sheets.

- **MOVE-IN / MOVE-OUT** and rehearsal dates are calculated at sixty percent (60%) of the normal daily rental rates.
- **INSURANCE** can be obtained by the VBC at the applicable rate.

|  | EXHIBIT SPACE |         |         |         |           |                     |               |
|--|---------------|---------|---------|---------|-----------|---------------------|---------------|
|  | DIMENSIONS    | SQ. FT. | THEATER | BANQUET | CLASSROOM | BOOTHS<br>10' X 10' | DAILY<br>RATE |
| Total South Hall<br>(includes all space) | 210' x 480'   | 100,800 | 10,080  | 6,700   | 5,040     | 600                 | \$8,820       |
| South Exhibit Hall<br>Ceiling 35'        | 210' x 390'   | 81,900  | 8,000   | 5,000   | 4,000     | 500                 | \$7,170       |
| South Hall 1                             | 210' x 240'   | 50,400  | 5,000   | 3,360   | 2,520     | 300                 | \$4,675       |
| South Hall 2                             | 210' x 150'   | 31,500  | 3,150   | 2,100   | 1,575     | 200                 | \$2,920       |
| South Ballroom<br>Ceiling 18'-22'        | 220' x 74'    | 16,280  | 1,500   | 1,000   | 750       | 75                  | \$2,785       |
| Ballroom 1                               | 45' x 74'     | 3,330   | 315     | 205     | 150       | 15                  | \$630         |
| Ballroom 2                               | 45' x 74'     | 3,330   | 315     | 205     | 150       | 15                  | \$630         |
| Ballroom 3                               | 45' x 74'     | 3,330   | 315     | 205     | 150       | 15                  | \$630         |
| Ballroom 4                               | 45' x 74'     | 3,330   | 315     | 205     | 150       | 15                  | \$630         |
| Ballroom 5                               | 40' x 74'     | 3,330   | 280     | 185     | 140       | 15                  | \$630         |
| Meeting Room 1                           | 30' x 40'     | 1,200   | 120     | 80      | 60        |                     | \$260         |
| Meeting Room 2                           | 34' x 40'     | 1,360   | 135     | 90      | 65        |                     | \$260         |
| Meeting Room 3                           | 20' x 18'     | 360     | 30      |         |           |                     | \$170         |
| Lobby                                    |               | 4,200   |         |         |           |                     | \$350         |
| Ballroom Pre-function                    |               | 6,432   |         |         |           |                     | \$580         |
| Exhibit Pre-function                     |               | 10,400  |         |         |           |                     | \$1,155       |

\*Utilities available - Power; water; air, phone, cable & internet

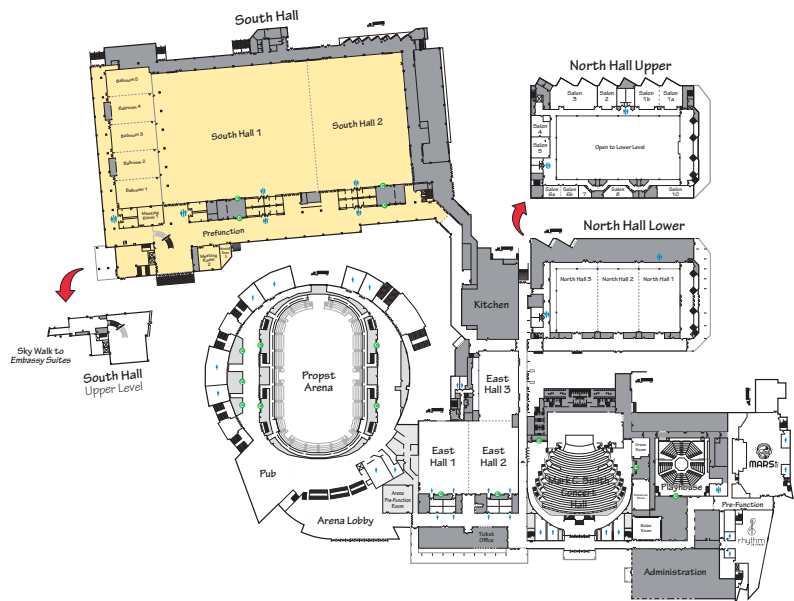

# South Hall Floor Plan

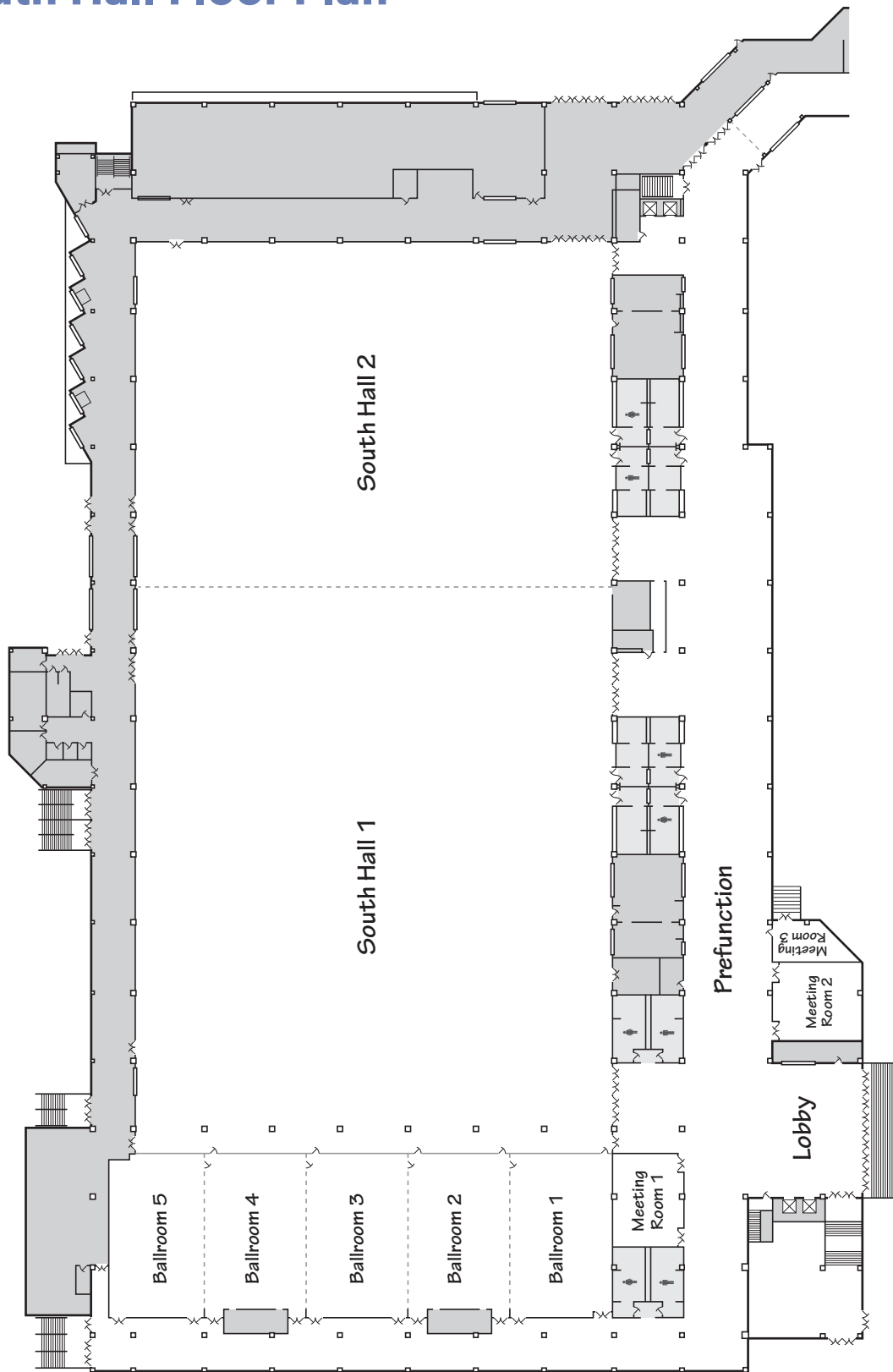

700 Monroe Street  
Huntsville, Alabama 35801  
256-533-1953  
fax 256-551-2203  
[www.vonbrauncenter.com](http://www.vonbrauncenter.com)  
[marketing@vonbrauncenter.com](mailto:marketing@vonbrauncenter.com)