

GENERAL INFORMATION



Located in the heart of historic downtown and just a short drive from the Huntsville International Airport, the Von Braun Center is convenient to area hotels, restaurants and attractions.

With over 170,000 square feet of multi-purpose meeting space, the VBC features a team of experienced professionals and many in-house services including Food & Beverage, Exhibitor Services, and Audio Visual making this a "one-stop shop" for all your event needs.

In order to help with your planning and budgeting, please note the following:

- Once your event is contracted, an Event Manager is assigned to your event and will help with catering, room/set-up, and technical requirements.
- The Von Braun Center requires a Certificate of Liability Insurance naming the Von Braun Center as additionally insured for \$1,000,000 two weeks prior to your event.

Insurance may be obtained through the VBC at the applicable rate for most events.

- The minimum requirement for security is one officer throughout the course of your event. Based upon the type of event, additional security may be required and will be determined by your Event Manager.
- A technician is required when utilizing VBC audio visual equipment. Your Event Manager can assist in providing a cost estimate based upon the requirements of your event.
- Rental rates include lighting, heating and/or air conditioning and water as installed. All labor, supplies and equipment are considered additional expenses and will be charged at rates as outlined in the Equipment, Services & Audio Visual price sheets.
- Theatre capacity is based on 10 square feet per person. Banquet capacity is based on 15 square feet per person with 5' round

tables. Rectangular tables will figure 12 square feet per person. Classroom capacity is based on 20 square feet per person. Special risers or staging needs may alter capacities.

- Room rental rates for rehearsals and move-in/ move-out dates are calculated at 60% of normal rental rates.
- All prices are subject to change without notice.
- Please refer to the current VBC Catering Guide for rules & regulations of all catered events.

All current rental rates are posted to the website including meeting room rental, equipment, services, audio visual and catering at www.vonbrauncenter.com



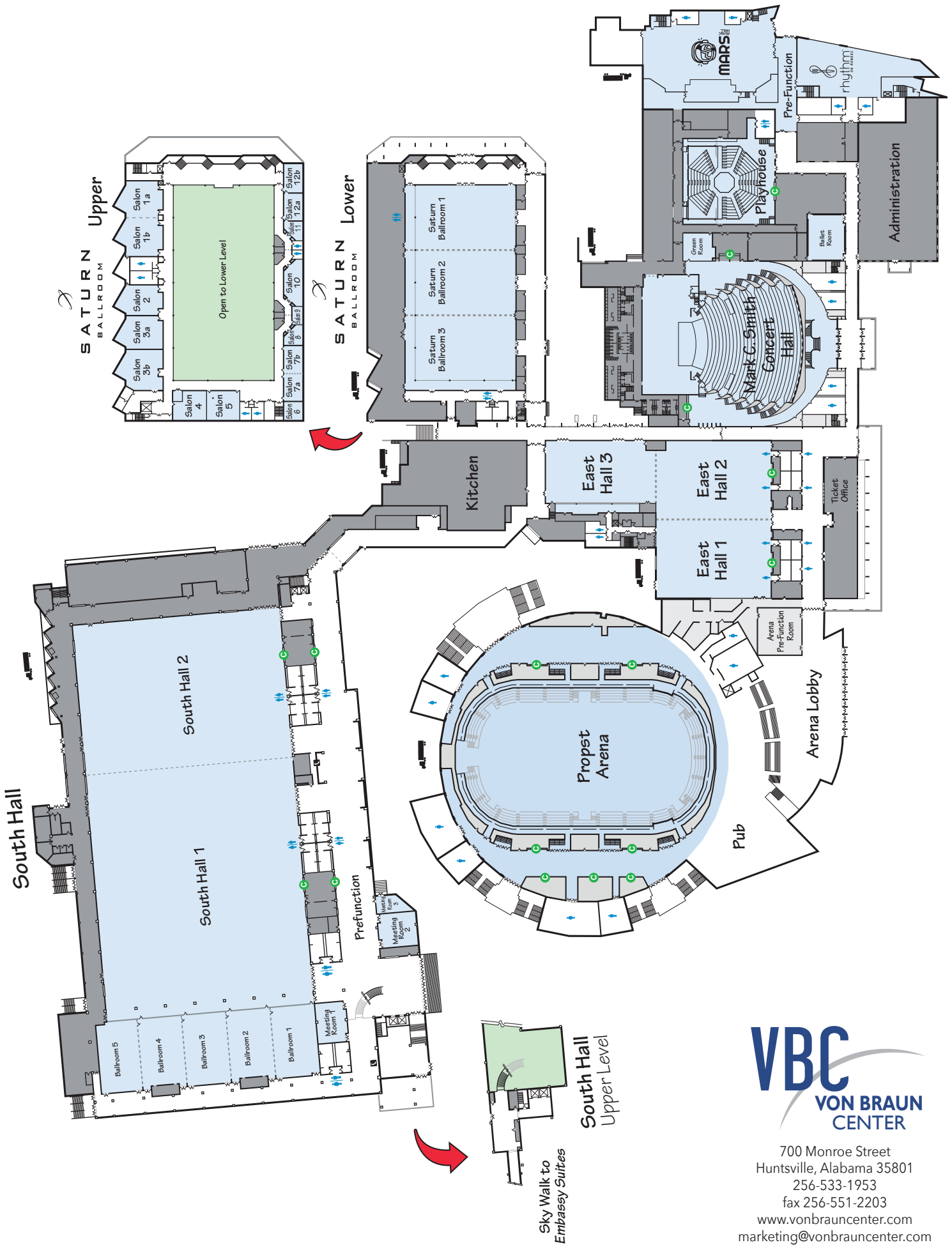

Sky Walk to Embassy Suites

South Hall Upper Level

VBC
 VON BRAUN CENTER

700 Monroe Street
 Huntsville, Alabama 35801
 256-533-1953
 fax 256-551-2203
 www.vonbrauncenter.com
 marketing@vonbrauncenter.com

PROPST ARENA

The **Propst Arena** is equipped to accommodate major concerts, trade and consumer shows, and family shows, as well as a full range of indoor sporting events, including basketball, ice hockey, football and rodeos. The Arena floor measures 110' x 212' and has a 400 pound per square foot load capacity. The Propst Arena also features two high definition LED video boards measuring 22' by 12' each along with two LED fascia boards measuring 4' by 99', concourse monitors and pan, tilt and zoom cameras. The state-of-the-art digital sound system is a delayed distributed array plus hub subs and distribution to concourse, lobby, bar, dressing and green rooms.

The VBC has an in-house Exhibitor Services Department for all exhibitor needs and an exclusive in-house Catering Department for food and beverage functions.

- **COMMERCIAL RENTAL:** \$9,000 or 12% of gross ticket receipts after taxes, whichever is greater.
- **NON-COMMERCIAL RENTAL:** \$7,500 or 10% of gross ticket receipts after taxes, whichever is greater.
- **NON-COMMERCIAL RENTAL:** Applies to qualified religious, charitable or educational organizations where no admission is charged, no fee is taken, no collection is made or no revenue is derived. Local non-profit organizations that charge admission, take fees, collections or derive revenue may qualify for the non-commercial rental.
- **CONFERENCE RENTAL:** \$12,000 daily rate.
- **RENTAL RATES** include lighting, heating and/or air conditioning and water as installed. All labor, supplies and equipment are considered additional expenses and will be charged at rates as outlined in the Equipment, services & staffing, and AUDIOVISUAL sheets.
- **MOVE-IN / MOVE-OUT** dates are calculated at sixty percent (60%) of the normal daily rental rates.
- **INSURANCE** required for events in the Arena cannot be obtained by the VBC and it is therefore the sole responsibility of the Lessee to procure sufficient insurance.



| | CAPACITIES | | | | | | |
|-------|------------|-----------|--------|------------|----------------|---------------|---|
| | FESTIVAL | END STAGE | HOCKEY | BASKETBALL | FLOOR SQ. FEET | BOOTHS 10'X8' | UTILITIES |
| Arena | 9,000 | 8,300 | 6,602 | 7,198 | 21,624 | 144 | 100 Volt 208 Volt 480 Volt Power |

*Special risers or staging needs may alter capacities.

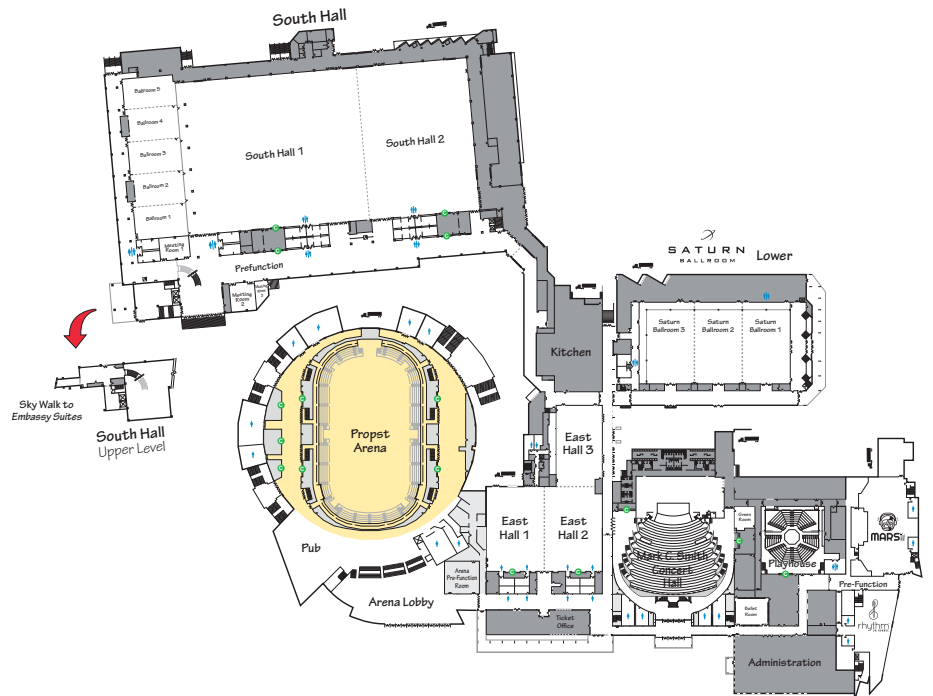

Propst Arena Floor Plan

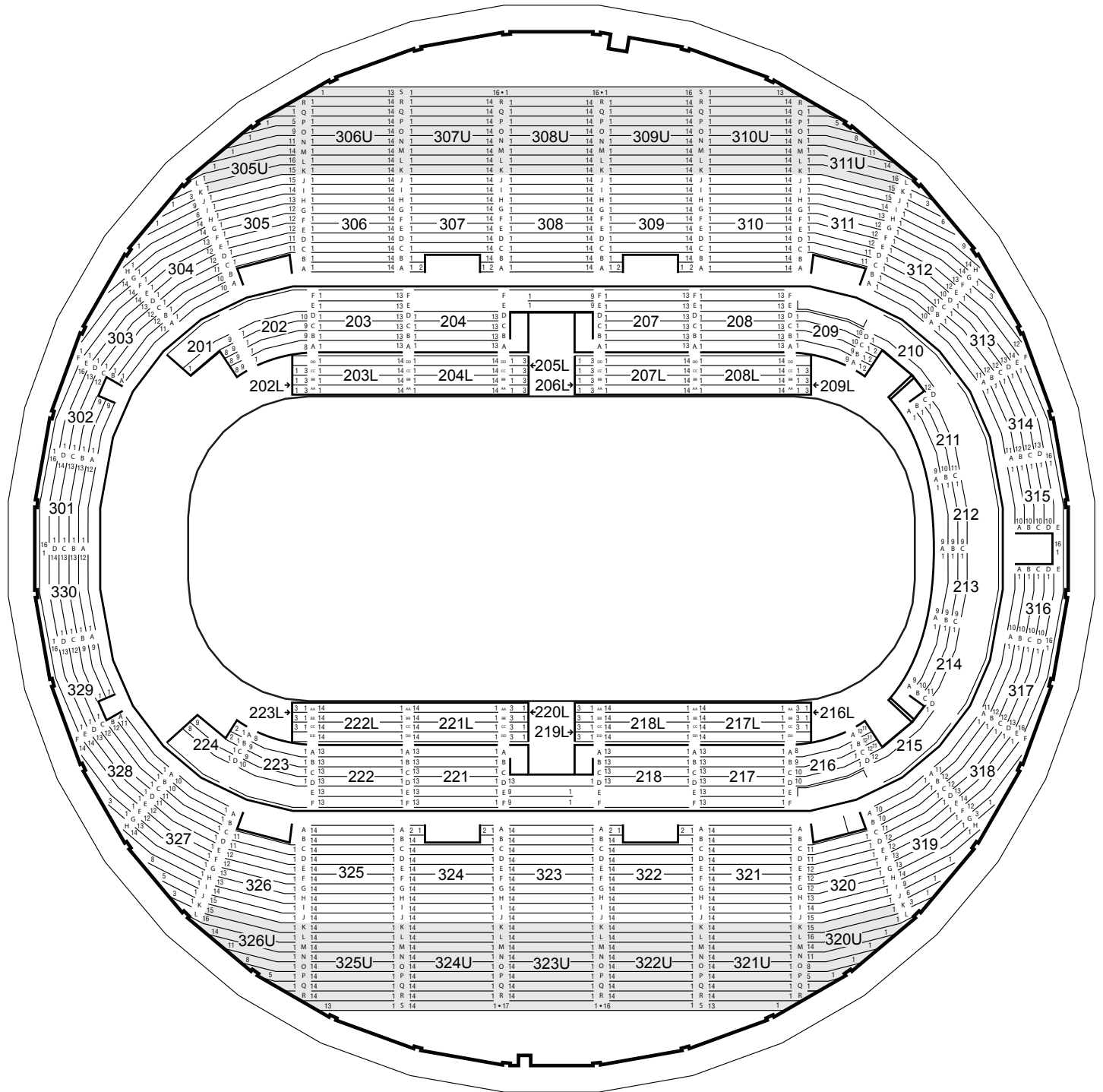

700 Monroe Street
Huntsville, Alabama 35801
256-533-1953
fax 256-551-2203
www.vonbrauncenter.com
marketing@vonbrauncenter.com

MARK C. SMITH CONCERT HALL

The luxurious **Mark C. Smith Concert Hall**, seating 1,955 continental style, is a performing venue for everything from Broadway to ballet and symphonies to concerts. The theatre is also used as a meeting area for conferences and seminars.

The Concert Hall has dressing room accommodations for sixty performers and a double-bay loading dock accessible at stage level through a 12' x 18' service door. The stage has a 54' x 48' performing area, a hydraulic orchestra pit, a 54 line counterweight system, a full orchestra acoustical shell and complete sound and lighting systems. A Green Room reception area is located adjacent to the Concert Hall.

- **COMMERCIAL RENTAL:** \$4,500 per day or 12% of gross ticket receipts after taxes, whichever is greater.
- **NON-COMMERCIAL RENTAL:** \$4,000 per day or 10% of gross ticket receipts after taxes, whichever is greater.
- **NON-COMMERCIAL RENTAL:** Applies to qualified religious, charitable or educational organizations where no admission is charged, no fee is taken, no collection is made or no revenue is derived. Local non-profit organizations that charge admission, take fees, collections or derive revenue may qualify for the non-commercial rental.
- **RENTAL RATES** include basic lighting, heating and/or air conditioning and water as installed. With the exception of basic lighting equipment, all labor, supplies and equipment are considered additional expenses and will be charged at rates as outlined in the Equipment, services & staffing, and AUDIOVISUAL sheets.
- **BALLET ROOM** Rental: \$325 per day
- **MOVE-IN / MOVE-OUT** and rehearsal dates are calculated at sixty percent (60%) of the normal daily rental rates.
- **INSURANCE** can be obtained by the VBC at the applicable rate.

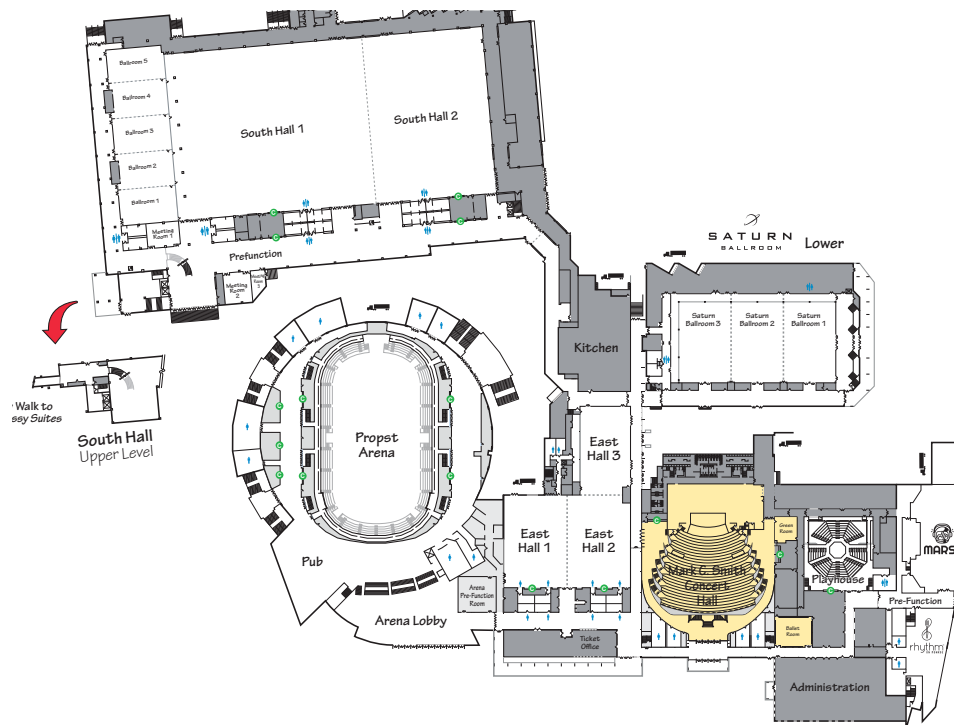
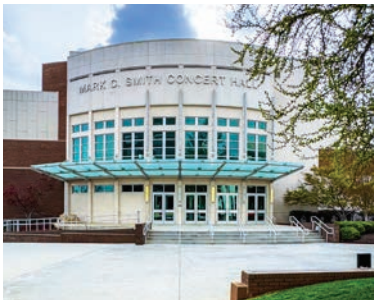

Mark C. Smith Concert Hall Floor Plan

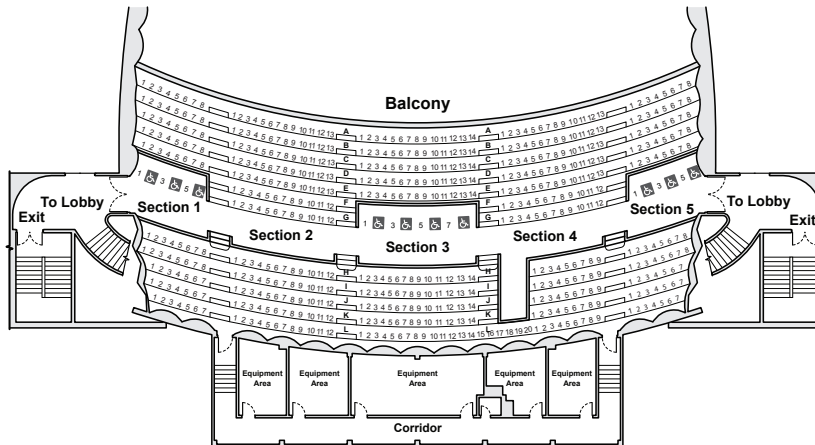
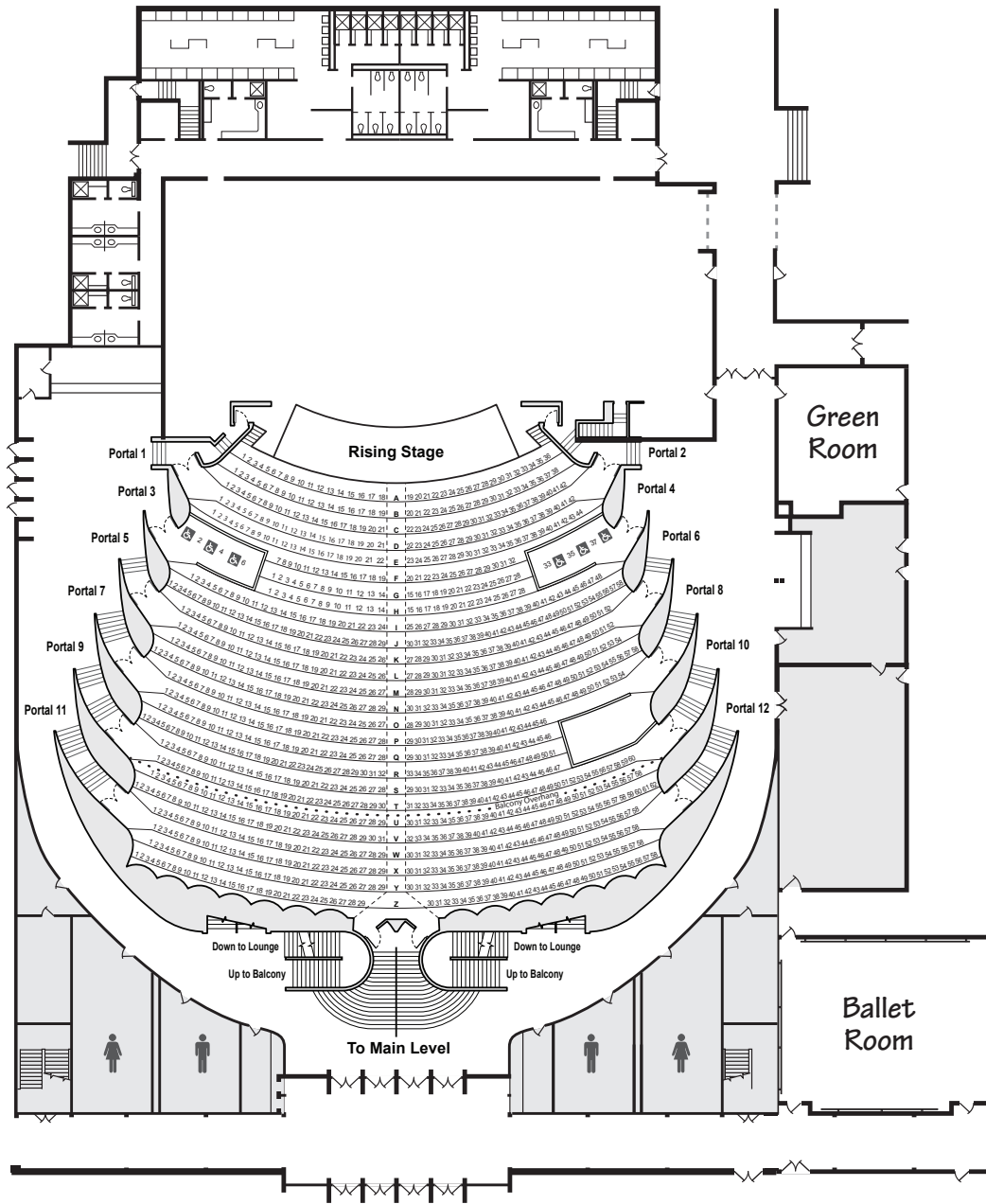

700 Monroe Street
Huntsville, Alabama 35801
256-533-1953
fax 256-551-2203
www.vonbrauncenter.com
marketing@vonbrauncenter.com

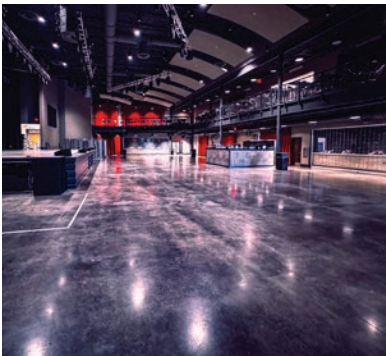

The industrial inspired **Mars Music Hall** is a performing venue with a 1,350-person capacity. The intimate character of the venue's broad, not-a-bad-seat-in-the-house design with its wrapping balcony overlooking a 50 foot wide stage offers great acoustics for a variety of events ranging from concerts to comedy acts and everything in between. The Hall has a sound and lighting system.

- **RENTAL:** \$6,000 including sound & lights.
- **RENTAL RATES** includes lighting, heating and/or air conditioning. All labor, supplies

and equipment are considered additional expenses and will be charged at rates as outlined in Equipment, services & staffing and AUDIOVISUAL sheets.

- **MOVE-IN/MOVE-OUT** dates are calculated at sixty percent (60%) of the normal daily rental rates.
- **INSURANCE** required for events in the Mars Music Hall cannot be obtained by the VBC and it is therefore the sole responsibility of the Lessee to procure sufficient insurance.

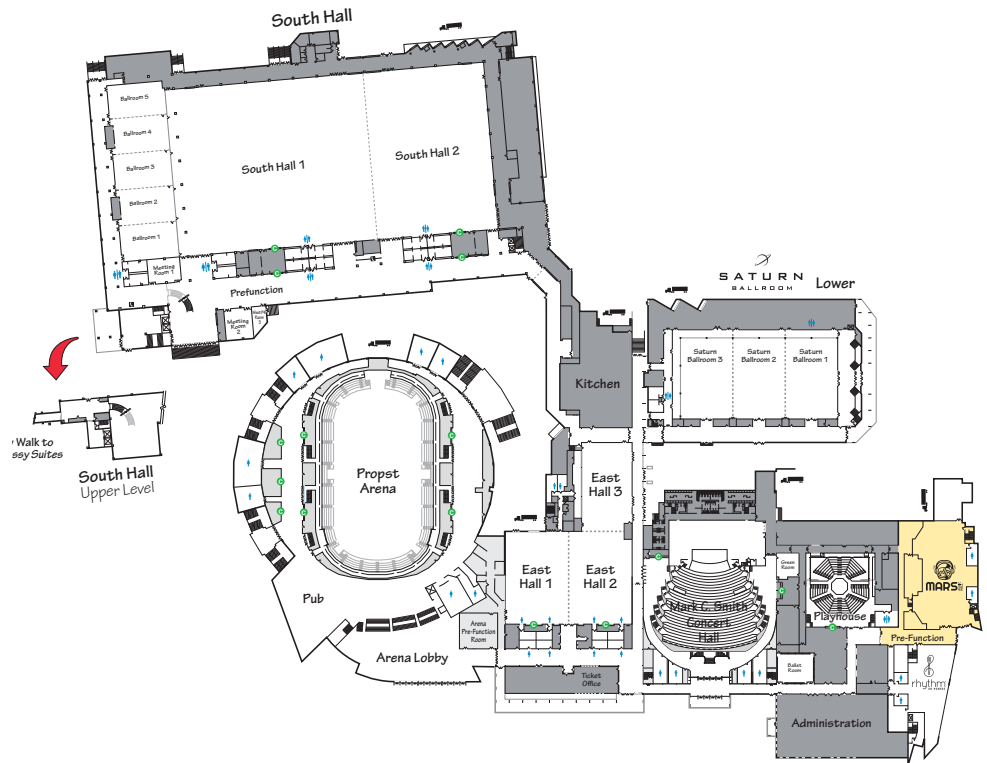

Mars Music Hall Floor Plan

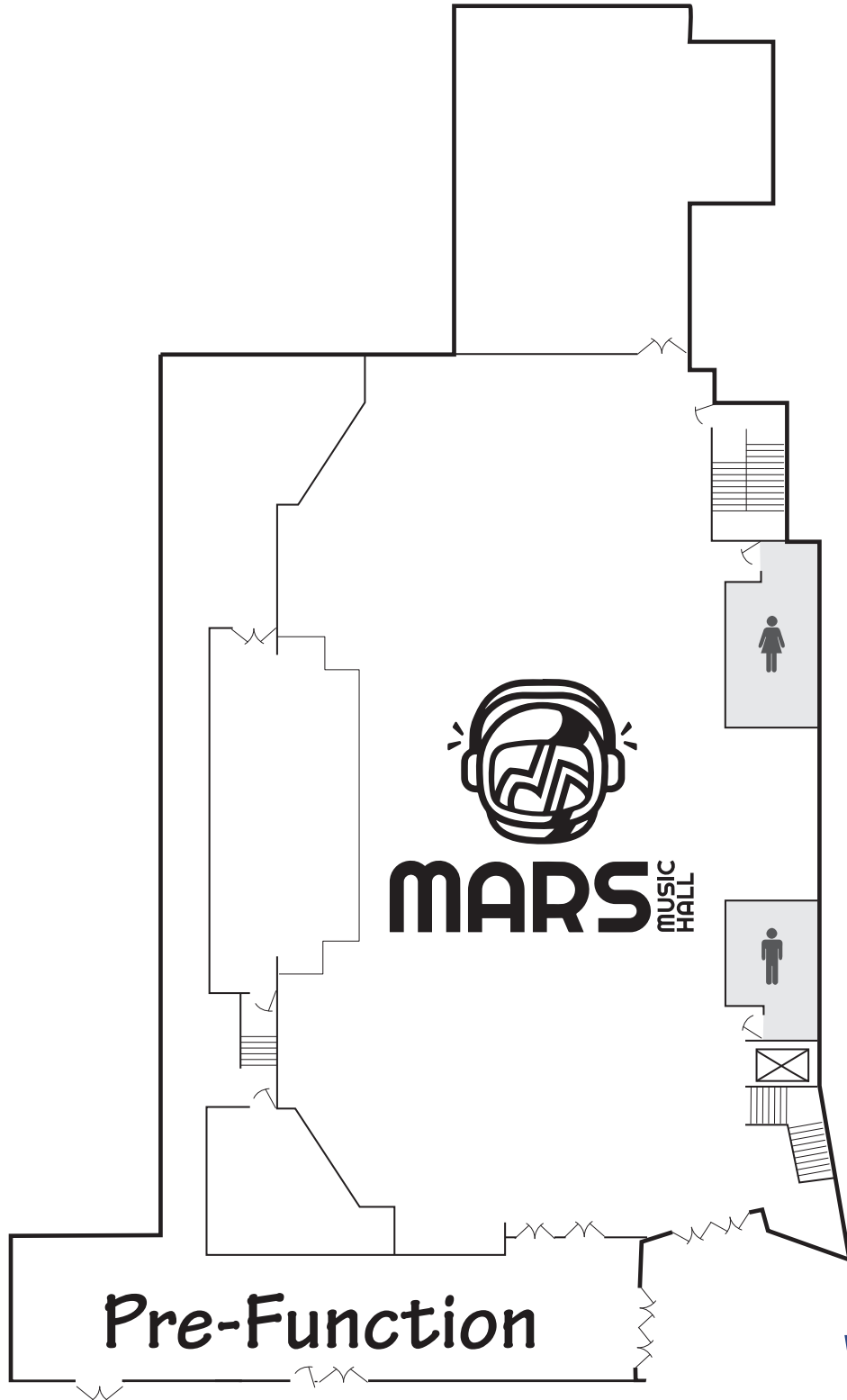

700 Monroe Street
Huntsville, Alabama 35801
256-533-1953
fax 256-551-2203
www.vonbrauncenter.com
marketing@vonbrauncenter.com

RHYTHM ON MONROE

On-Site Restaurant & Rooftop Bar

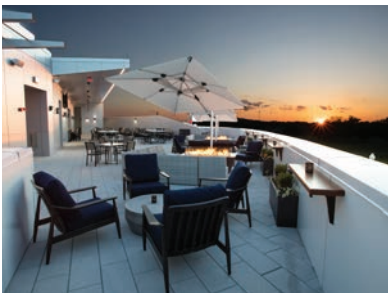

Rhythm on Monroe is a unique restaurant and rooftop bar open daily at 4 pm and 11 am on Saturday and Sunday for brunch. Whether you are looking for dinner and drinks before a show or an evening cocktail overlooking Downtown Huntsville's unique cityscape, Rhythm on Monroe satisfies all needs.

SERVING locally-sourced ingredients, Rhythm on Monroe's menu provides delicious urban fare with unique offerings of classic cuisine. The culinary team brings their traveled talents to the table each night while providing from scratch cooking paired with handmade cocktails, craft brews and a curated wine list.

ENJOY all that is offered with window views or on the rooftop near one of the fire-pit over-looking downtown. No matter where you join us, you will enjoy delightful service with locally sourced fare.

HOURS OF OPERATIONS:

Monday - Closed

Tuesday - Thursday: 4:00 pm - 10:00 pm

Friday: 4:00 pm - 11:00 pm

Saturday: 11:00 am - 11:00 pm

Sunday: 11:00 am - 10:00 pm

WEBSITE: rhythmmonmonroe.com

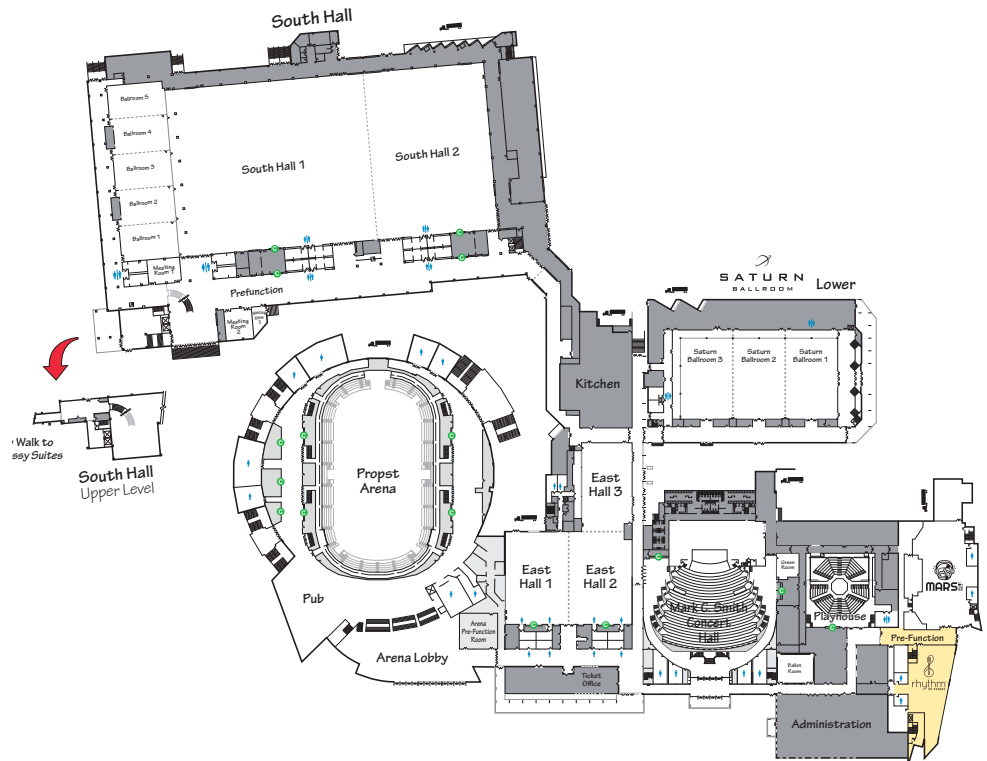

Rhythm on Monroe

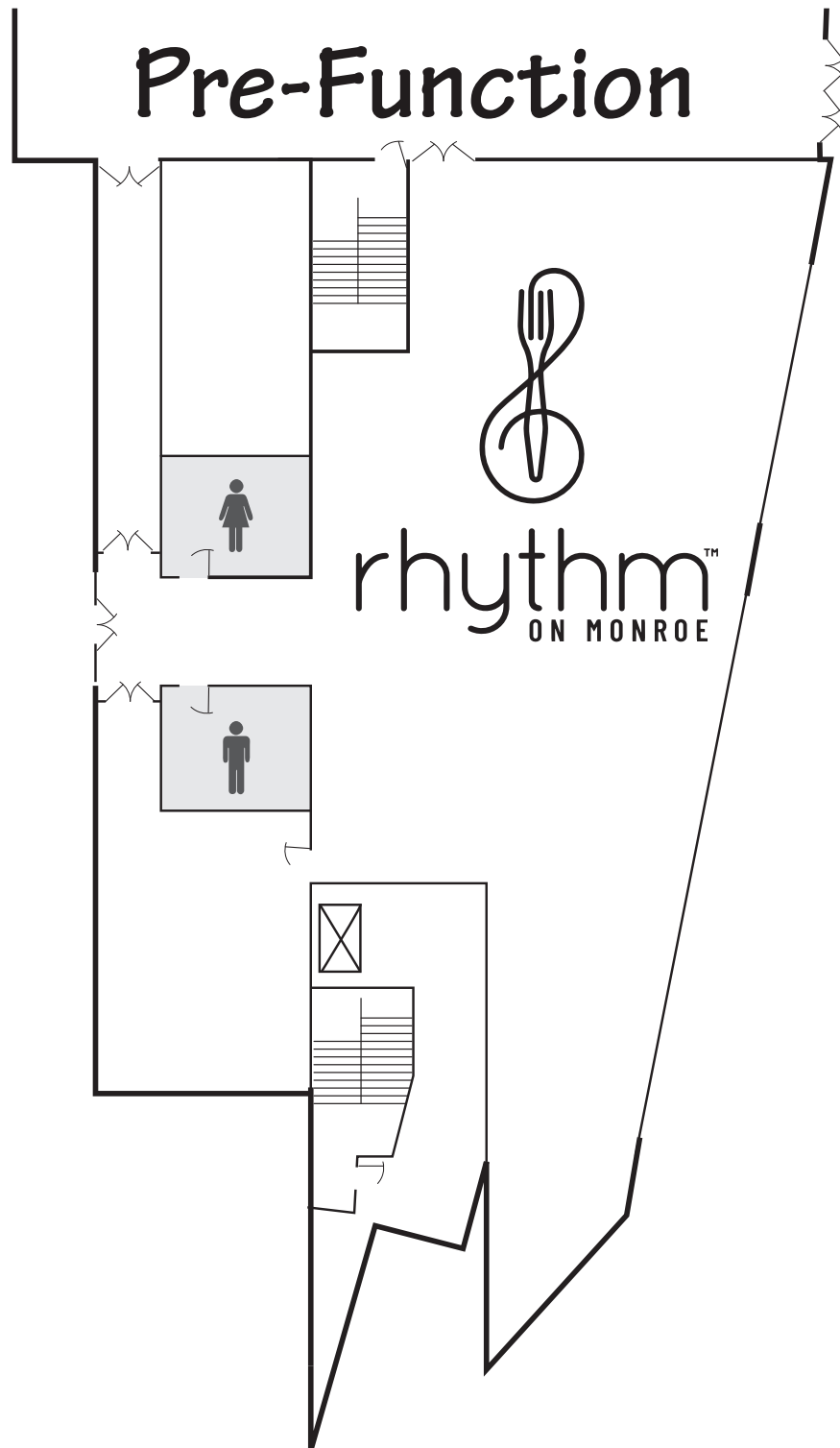

700 Monroe Street
Huntsville, Alabama 35801
256-533-1953
fax 256-551-2203
www.vonbrauncenter.com
marketing@vonbrauncenter.com

EAST HALL

The **East Hall** is a 24,000 square foot banquet, meeting and exhibit hall which can be divided into three separate areas complete with carpet, wall coverings and acoustical ceiling panels. The East Hall is suited for banquets, receptions, conventions, and trade and consumer shows. Located in the center of the Von Braun Center, the East Hall is convenient to all parking areas and other meeting rooms within the facility.

- **RENTAL RATES** include lighting, heating and/or air conditioning and water as installed. All labor, supplies and equipment are considered additional expenses and will be charged at rates as outlined in the **EQUIPMENT, SERVICES & STAFFING, AND AUDIOVISUAL** sheets.

- **MOVE-IN / MOVE-OUT** and rehearsal dates are calculated at sixty percent (60%) of the normal daily rental rates.
- **INSURANCE** can be obtained by the VBC at the applicable rate.

| | CAPACITIES | | | | | | DAILY RATE |
|--------------------------------------|------------|---------|---------|---------|-----------|-----------------|------------|
| | DIMENSIONS | SQ. FT. | THEATER | BANQUET | CLASSROOM | BOOTHS 10' X 8' | |
| Total East Hall Ceiling 15' - 19' | | 24,900 | 3,000 | 1,365 | 1,200 | 160 | \$2,780 |
| East Hall 1 | 79' x 116' | 9,164 | 1,000 | 500 | 550 | 60 | \$1,010 |
| East Hall 2 | 79' x 116' | 9,164 | 1,000 | 500 | 550 | 60 | \$1,010 |
| East Hall 3 | 62' x 106' | 6,572 | 600 | 365 | 465 | 40 | \$950 |

*Utilities available - Power; water; air, phone, cable & internet

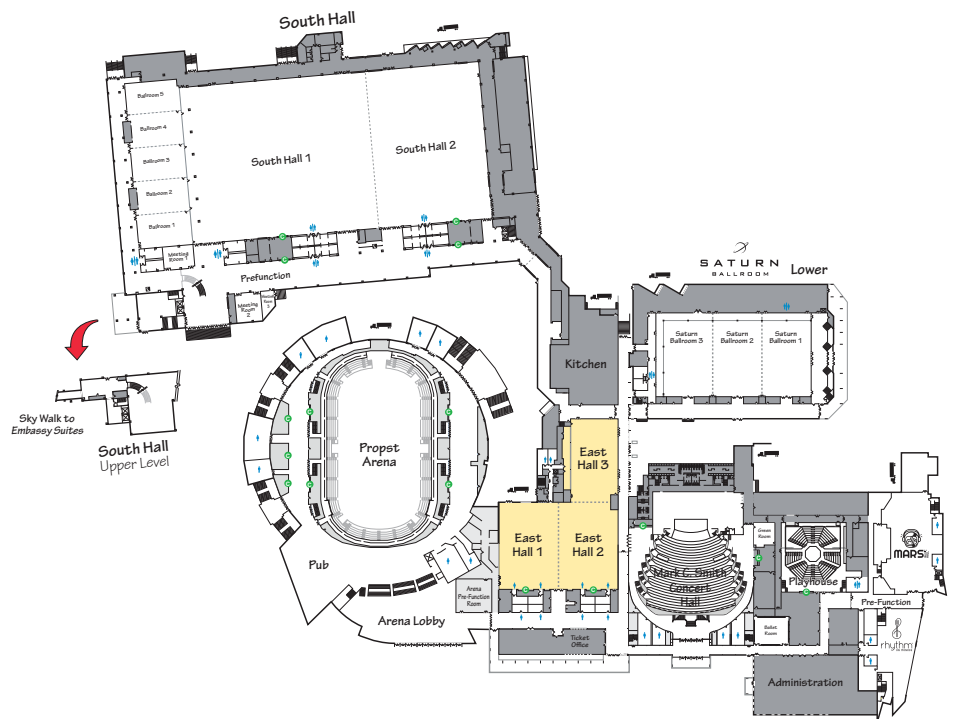

East Hall Floor Plan

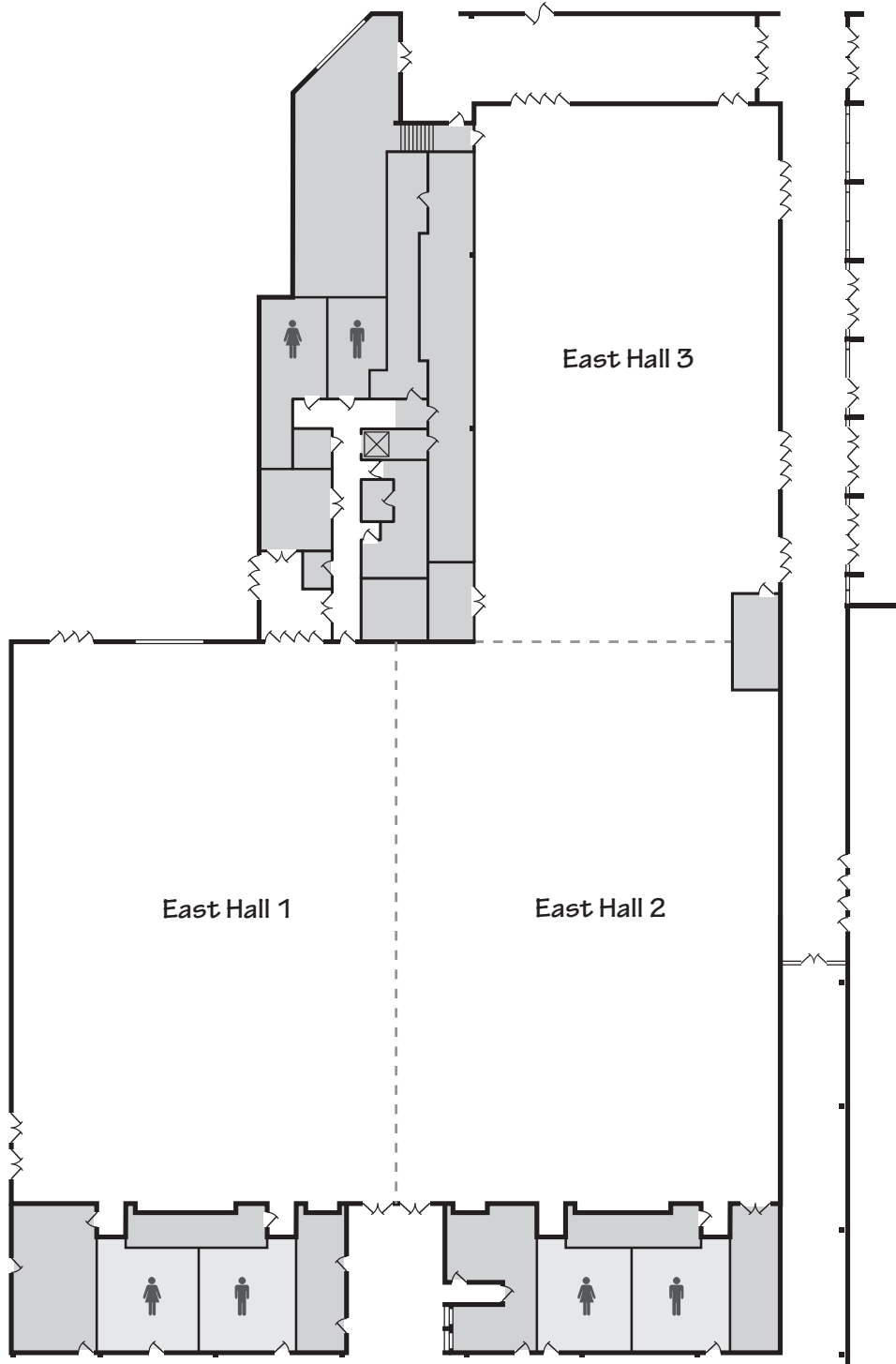

700 Monroe Street
Huntsville, Alabama 35801
256-533-1953
fax 256-551-2203
www.vonbrauncenter.com
marketing@vonbrauncenter.com



SATURN BALLROOM

The **SATURN BALLROOM** is a 23,000 square foot banquet and convention facility which can be divided into three separate areas. Complete with carpet and wall coverings, the Saturn Ballroom provides an elegant setting for food functions and meetings.

Overlooking the Saturn Ballroom main floor, accessible from a perimeter balcony, are twelve meeting rooms ranging in size from 500 square feet to 2,800 square feet. Running the entire length of the three halls is the Saturn Ballroom Gallery. The Gallery measures 227' x 18' and is an excellent reception, pre-function or registration area.



- **RENTAL RATES** include lighting, heating and/or air conditioning and water as installed. All labor, supplies and equipment are considered additional expenses and will be charged at rates as outlined in the Equipment, services & staffing, and AUDIOVISUAL sheets.
- **MOVE-IN / MOVE-OUT** and rehearsal dates are calculated at sixty percent (60%) of the normal daily rental rates.
- **INSURANCE** can be obtained by the VBC at the applicable rate.

| | CAPACITIES | | | | | | DAILY RATE |
|-------------------------------|--------------------------|---------|---------|---------|-----------|--------------------|------------|
| | DIMENSIONS | SQ. FT. | THEATER | BANQUET | CLASSROOM | BOOTHS 10' X 8' | |
| Total Saturn Ballroom Ceiling | 112' x 207' 19' - 24' | 23,184 | 2,300 | 1,200 | 1,500 | 133 | \$5,000 |
| Saturn Ballroom 1 | 112' x 66' | 7,392 | 725 | 400 | 460 | 36 | \$1,800 |
| Saturn Ballroom 2 | 112' x 66' | 7,392 | 725 | 400 | 460 | 36 | \$1,800 |
| Saturn Ballroom 3 | 112' x 75' | 8,400 | 725 | 400 | 460 | 45 | \$1,800 |
| Total Saturn Ballroom Salons | | | | | | | \$2,750 |
| Salon 1 | 38' x 75' | 2,850 | 285 | 190 | 140 | | \$500 |
| Salon 1A | 38' x 36' | 1,368 | 135 | 90 | 65 | | \$325 |
| Salon 1B | 38' x 39' | 1,482 | 145 | 95 | 70 | | \$325 |
| Salon 2 | 38' x 30' | 1,140 | 110 | 75 | 55 | | \$325 |
| Salon 3 | 38' x 72' | 2,736 | 270 | 180 | 135 | | \$500 |
| Salon 3A | 38' x 36' | 1,368 | 135 | 90 | 65 | | \$325 |
| Salon 3B | 38' x 39' | 1,482 | 145 | 95 | 70 | | \$325 |
| Salon 4 | 30' x 35' | 1,050 | 85 | 55 | 40 | | \$300 |
| Salon 5 | 30' x 33' | 990 | 95 | 65 | 50 | | \$300 |
| Salon 6 | 20' x 19' | 380 | | | | | \$300 |
| Salon 7 | 19' x 56' | 1,064 | 105 | 70 | 50 | | \$325 |
| Salon 7A | 19' x 28' | 532 | 50 | 35 | 25 | | \$200 |
| Salon 7B | 19' x 28' | 532 | 50 | 35 | 25 | | \$200 |
| Salon 8 | 20' x 15' | 300 | - | - | - | | \$150 |
| Salon 9 | 11' x 20' | 200 | - | - | - | | \$150 |
| Salon 10 | 19' x 38' | 722 | 45 | 24 | 30 | | \$300 |
| Salon 11 | 20' x 15' | 300 | | | | | \$150 |
| Salon 12 | 20' x 56' | 1,120 | 105 | 70 | 50 | | \$325 |
| Salon 12A | 20' x 28' | 560 | 50 | 35 | 25 | | \$200 |
| Salon 12B | 20' x 28' | 560 | 50 | 35 | 25 | | \$200 |

*Utilities available - Power; phone, cable & internet

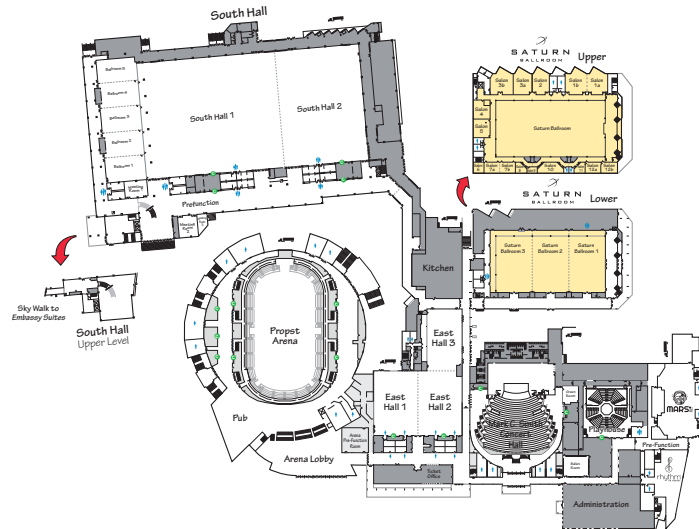

Saturn Ballroom Floor Plan

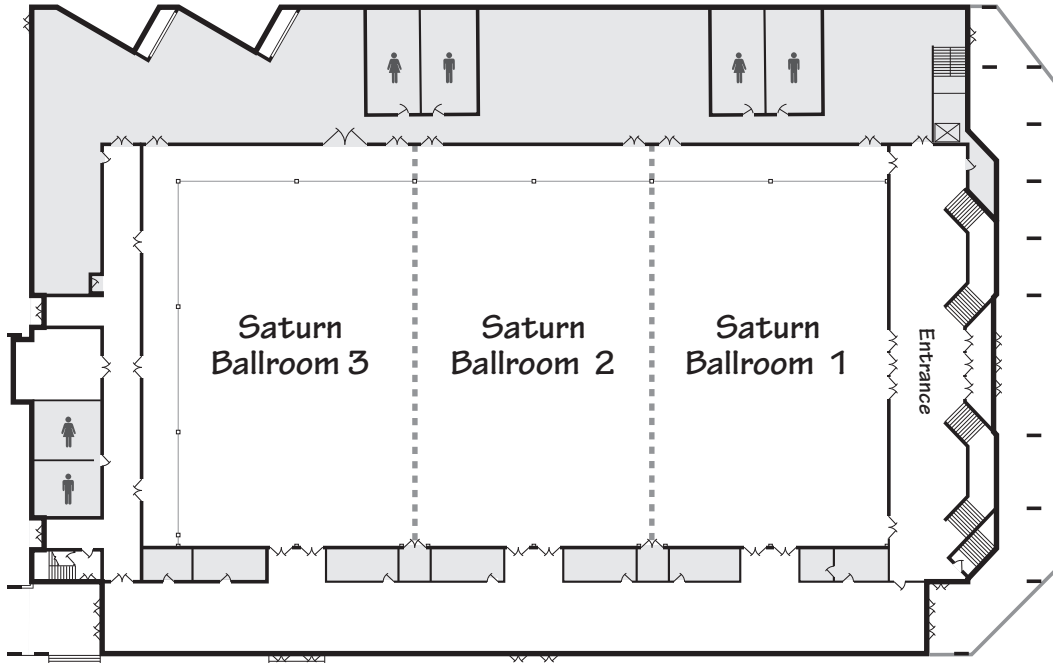

FIRST FLOOR

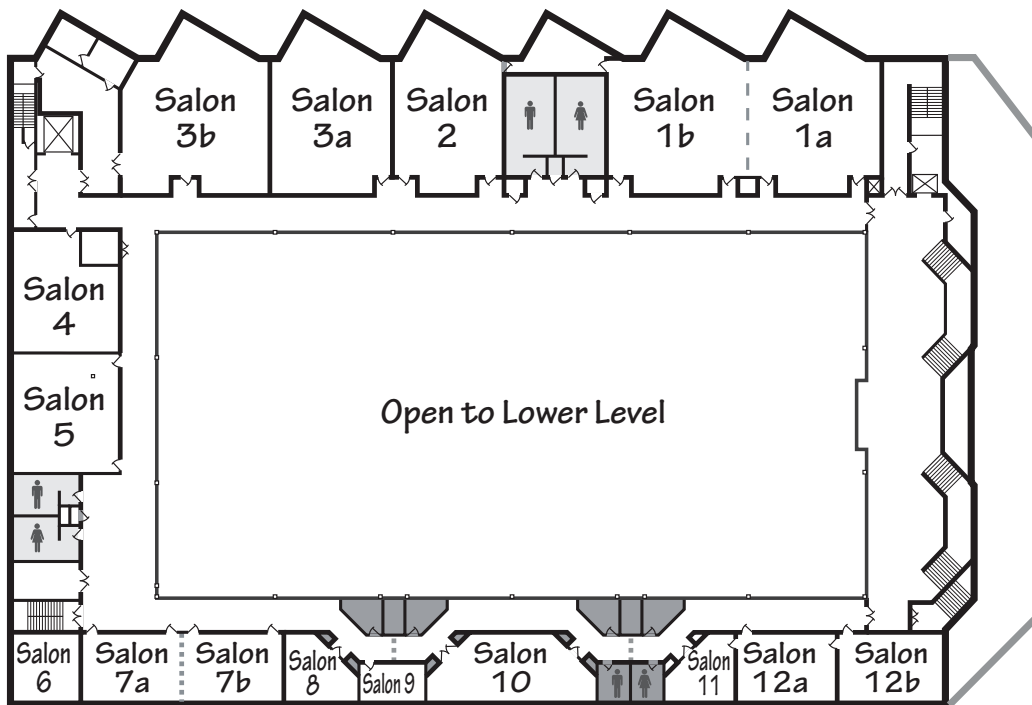

SECOND FLOOR



700 Monroe Street
Huntsville, Alabama 35801
256-533-1953
fax 256-551-2203
www.vonbrauncenter.com
marketing@vonbrauncenter.com

PLAYHOUSE

The **Playhouse** is a highly flexible theatre with in-the-round thrust or proscenium staging and seating capacities up to 330 seats. This fully equipped theatre provides an intimate setting conducive to conferences, lectures and various performing groups.

- **COMMERCIAL RENTAL:** \$850 per day or 12% of gross ticket receipts after taxes, whichever is greater. Commercial rental rate applies to any event where an admission is charged, a fee is taken, a collection is made or any revenue is derived.
- **NON-COMMERCIAL RENTAL:** \$500 per day. Non-commercial rental rate applies to qualified religious, charitable or educational organizations where no admission is charged, no fee is taken, no collection is made or no revenue is derived. Local non-profit organizations that charge admission, take fees, collections or derive revenue may qualify for the non-commercial rental.

- **RENTAL RATES** include seating up to 330, lighting, heating and/or air conditioning and water as installed. With the exception of basic production sound and lighting equipment, all labor, supplies and equipment are considered additional expenses and will be charged at rates as outlined in the Equipment, services & staffing, and AUDIOVISUAL sheets.
- **MOVE-IN / MOVE-OUT** and rehearsal dates are calculated at sixty percent (60%) of the normal daily rental rates.
- **INSURANCE** can be obtained by the VBC at the applicable rate.

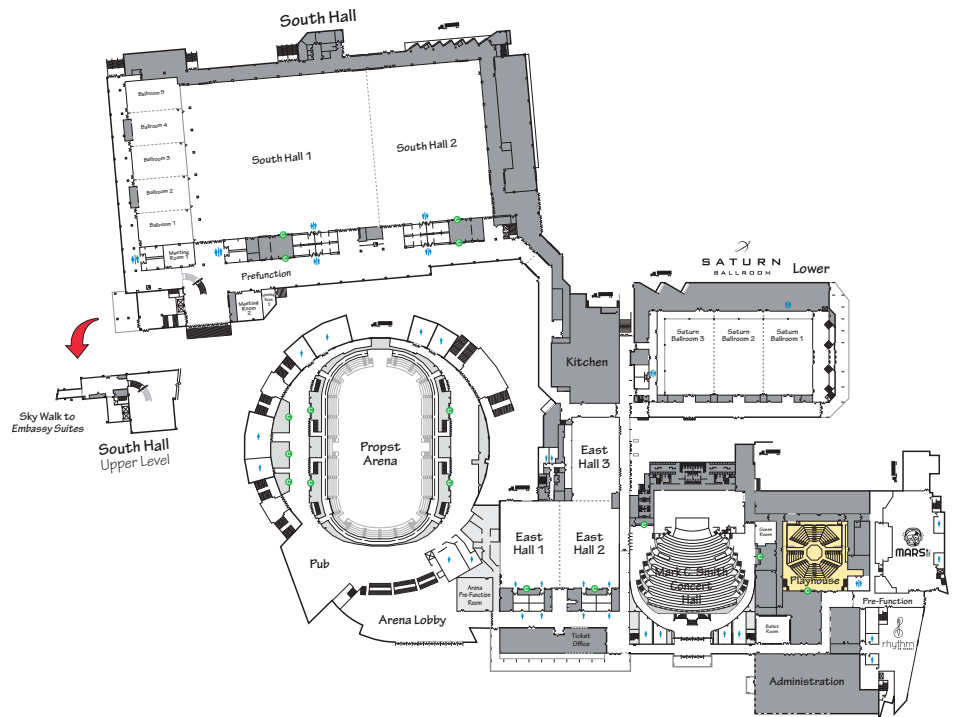

Playhouse Floor Plan

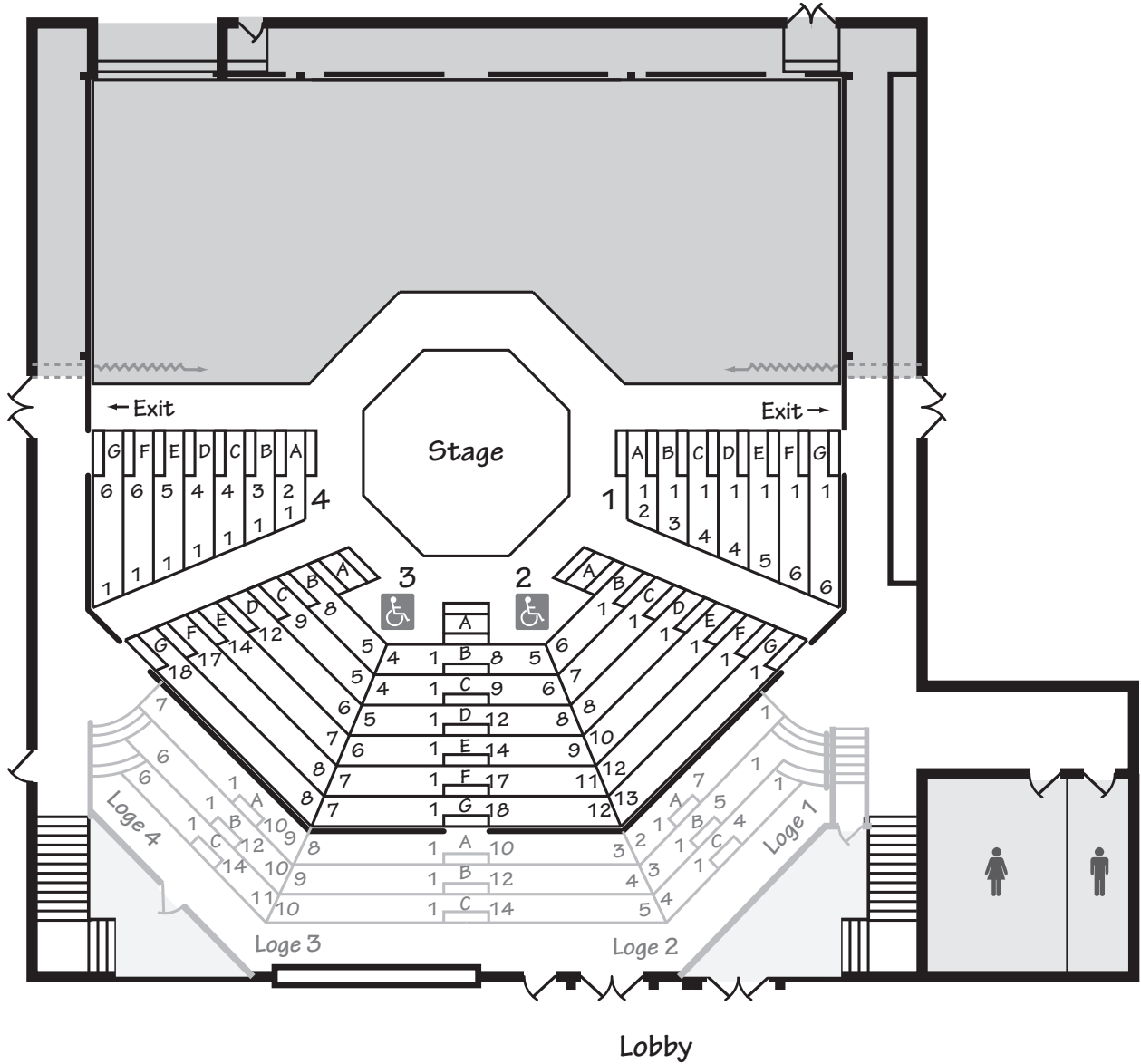

PROSCENIUM CAPACITY: 330



700 Monroe Street
Huntsville, Alabama 35801
256-533-1953
fax 256-551-2203
www.vonbrauncenter.com
marketing@vonbrauncenter.com

SOUTH HALL

The **South Exhibit Hall** has 35' ceilings and a 350 pound per square foot load capacity making it the perfect location for large trade and consumer shows, conventions and banquets.

The South Ballroom overlooking Big Spring International Park is complete with beautiful chandeliers and carpet providing an elegant setting for banquet and social functions.

- **RENTAL RATES** include lighting, heating and/or air conditioning and water as installed. All labor, supplies and equipment are considered additional expenses and will be charged at rates as outlined in the EQUIPMENT, SERVICES & STAFFING, and AUDIOVISUAL sheets.

- **MOVE-IN / MOVE-OUT** and rehearsal dates are calculated at sixty percent (60%) of the normal daily rental rates.
- **INSURANCE** can be obtained by the VBC at the applicable rate.

| | EXHIBIT SPACE | | | | | | |
|--|---------------|---------|---------|---------|-----------|---------------------|---------------|
| | DIMENSIONS | SQ. FT. | THEATER | BANQUET | CLASSROOM | BOOTHS 10' X 10' | DAILY RATE |
| Total South Hall (includes all space) | 210' x 480' | 100,800 | 10,080 | 6,700 | 5,040 | 600 | \$9,260 |
| South Exhibit Hall Ceiling 35' | 210' x 390' | 81,900 | 8,000 | 5,000 | 4,000 | 500 | \$7,530 |
| South Hall 1 | 210' x 240' | 50,400 | 5,000 | 3,360 | 2,520 | 300 | \$4,910 |
| South Hall 2 | 210' x 150' | 31,500 | 3,150 | 2,100 | 1,575 | 200 | \$3,070 |
| South Ballroom Ceiling 18'-22' | 220' x 74' | 16,280 | 1,500 | 1,000 | 750 | 75 | \$2,925 |
| Ballroom 1 | 45' x 74' | 3,330 | 315 | 205 | 150 | 15 | \$665 |
| Ballroom 2 | 45' x 74' | 3,330 | 315 | 205 | 150 | 15 | \$665 |
| Ballroom 3 | 45' x 74' | 3,330 | 315 | 205 | 150 | 15 | \$665 |
| Ballroom 4 | 45' x 74' | 3,330 | 315 | 205 | 150 | 15 | \$665 |
| Ballroom 5 | 40' x 74' | 3,330 | 280 | 185 | 140 | 15 | \$665 |
| Meeting Room 1 | 30' x 40' | 1,200 | 120 | 80 | 60 | | \$275 |
| Meeting Room 2 | 34' x 40' | 1,360 | 135 | 90 | 65 | | \$275 |
| Meeting Room 3 | 20' x 18' | 360 | 30 | | | | \$200 |
| Lobby | | 4,200 | | | | | \$375 |
| Ballroom Pre-function | | 6,432 | | | | | \$600 |
| Exhibit Pre-function | | 10,400 | | | | | \$1,215 |

*Utilities available - Power; water; air, phone, cable & internet

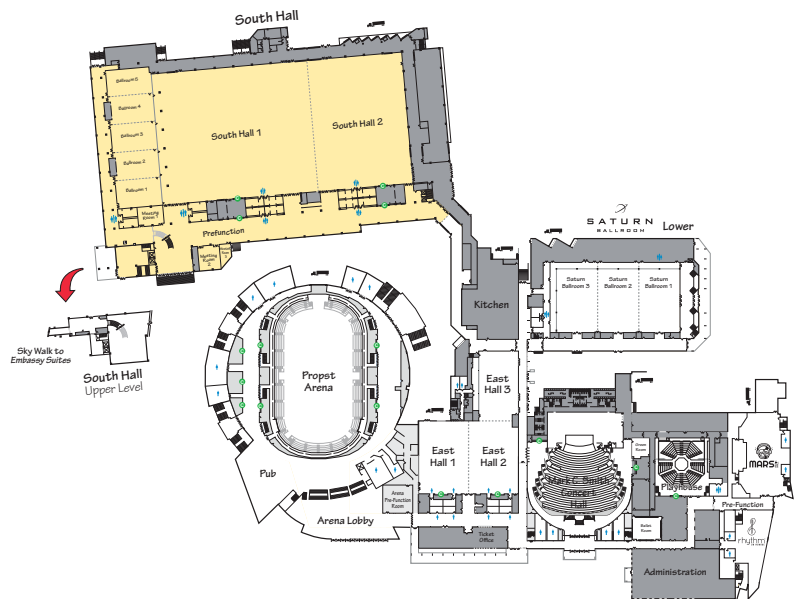

South Hall Floor Plan

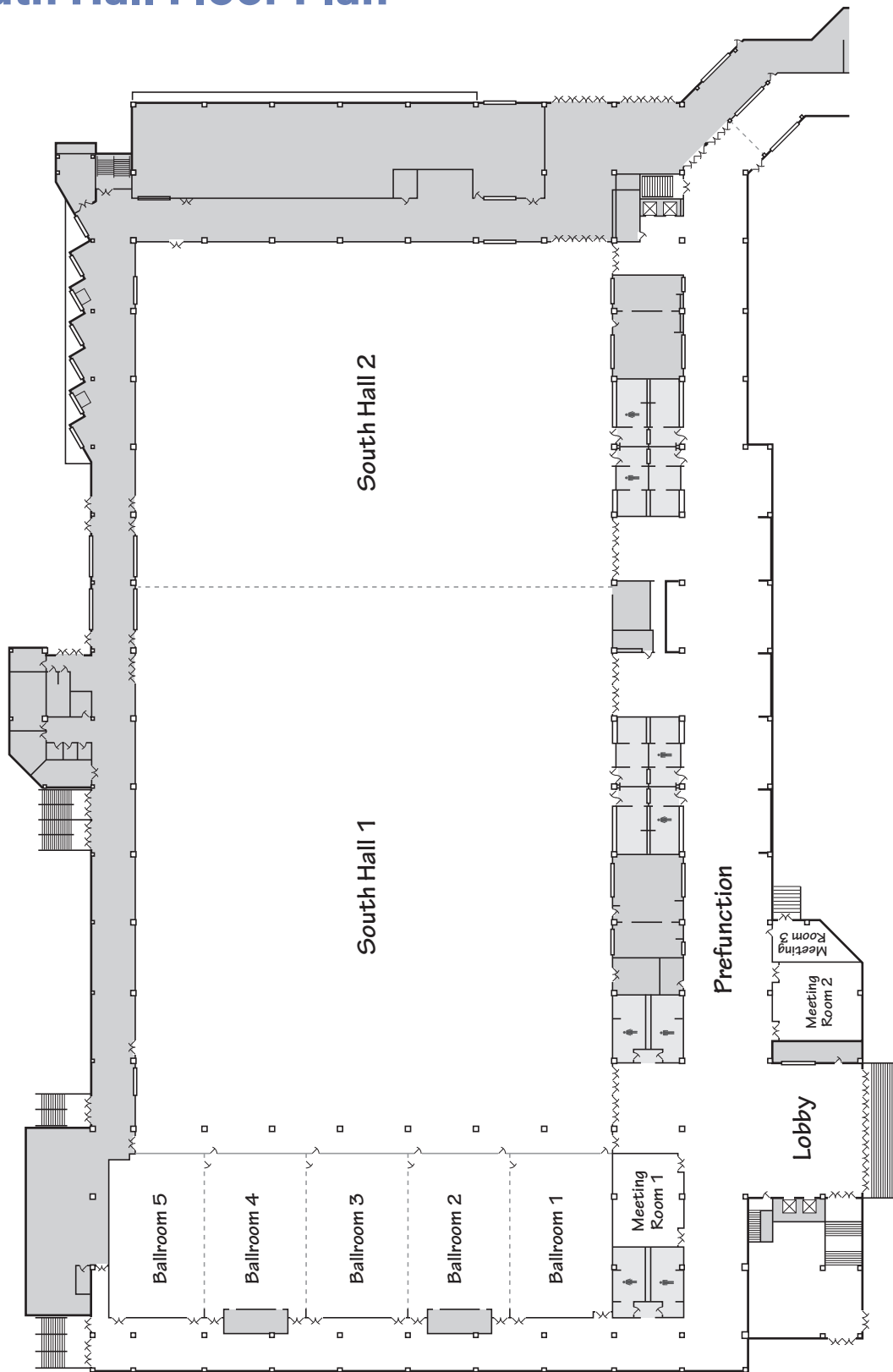

700 Monroe Street
Huntsville, Alabama 35801
256-533-1953
fax 256-551-2203
www.vonbrauncenter.com
marketing@vonbrauncenter.com

MEETING ROOM CAPACITIES

| SOUTH HALL | | | | | | |
|---------------------------|-------------|----------------|------------------|---------|---------|-----------|
| ROOM | DIMENSIONS | SQUARE FOOTAGE | BOOTHS (10'X10') | THEATER | BANQUET | CLASSROOM |
| Total South Hall | 210' x 480' | 100,800 | 600 | 9,500 | 6,700 | 5,040 |
| South Hall 1 | 210' x 240' | 50,400 | 304 | 5,500 | 3,360 | 2,520 |
| South Hall 2 | 210' x 150' | 31,500 | 200 | 2,500 | 2,100 | 1,575 |
| South Hall Ballroom | 210' x 90' | 18,900 | 96 | 1,500 | 1,000 | 750 |
| Lobby/Prefunction | | 20,000 | | | | |
| EAST HALL | | | | | | |
| ROOM | DIMENSIONS | SQUARE FOOTAGE | BOOTHS (10'X8') | THEATER | BANQUET | CLASSROOM |
| Total East Hall | | 24,880 | 160 | 2,150 | 1,365 | 1,200 |
| East Hall 1 | 79' x 116' | 9,164 | 60 | 750 | 500 | 550 |
| East Hall 2 | 79' x 116' | 9,164 | 60 | 750 | 500 | 550 |
| East Hall 3 | 63' x 104' | 6,552 | 40 | 650 | 365 | 330 |
| SATURN BALLROOM | | | | | | |
| ROOM | DIMENSIONS | SQUARE FOOTAGE | BOOTHS (10'X8') | THEATER | BANQUET | CLASSROOM |
| Total Saturn Ballroom | 112' x 207' | 23,184 | 133 | 2,175 | 1,200 | 1,500 |
| Saturn Ballroom 1 | 112' x 66' | 7,392 | 36 | 725 | 400 | 460 |
| Saturn Ballroom 2 | 112' x 66' | 7,392 | 36 | 725 | 400 | 460 |
| Saturn Ballroom 3 | 112' x 75' | 8,400 | 45 | 725 | 400 | 460 |
| MEETING ROOMS | | | | | | |
| ROOM | DIMENSIONS | SQUARE FOOTAGE | | THEATER | BANQUET | CLASSROOM |
| South Hall Ballroom 1 | 75' x 45' | 3,330 | | 315 | 205 | 150 |
| South Hall Ballroom 2 | 75' x 45' | 3,330 | | 315 | 205 | 150 |
| South Hall Ballroom 3 | 75' x 45' | 3,330 | | 315 | 205 | 150 |
| South Hall Ballroom 4 | 75' x 45' | 3,330 | | 315 | 205 | 150 |
| South Hall Ballroom 5 | 75' x 40' | 2,960 | | 280 | 185 | 140 |
| South Hall Meeting Room 1 | 30' x 40' | 1,200 | | 120 | 80 | 60 |
| South Hall Meeting Room 2 | 34' x 40' | 1,360 | | 135 | 90 | 65 |
| South Hall Meeting Room 3 | 20' x 18' | 360 | | 20 | 10 | 10 |
| Salon 1 | 38' x 75' | 2,850 | | 285 | 190 | 140 |
| Salon 1A | 38' x 36' | 1,368 | | 135 | 90 | 65 |
| Salon 1B | 38' x 39' | 1,482 | | 145 | 95 | 70 |
| Salon 2 | 38' x 30' | 1,140 | | 110 | 75 | 55 |
| Salon 3 | 38' x 72' | 2,736 | | 270 | 180 | 135 |
| Salon 3A | 38' x 36' | 1,368 | | 135 | 90 | 65 |
| Salon 3B | 38' x 39' | 1,480 | | 145 | 95 | 70 |
| Salon 4 | 30' x 35' | 1,050 | | 85 | 55 | 40 |
| Salon 5 | 30' x 33' | 990 | | 95 | 65 | 50 |
| Salon 6 | 20' x 19' | 380 | | | | |
| Salon 7 | 19' x 56' | 1,064 | | 105 | 70 | 50 |
| Salon 7A | 19' x 28' | 532 | | 50 | 35 | 25 |
| Salon 7B | 19' x 28' | 532 | | 50 | 35 | 25 |
| Salon 8 | 20' x 15' | 300 | | | | |
| Salon 9 | 11' x 20' | 220 | | | | |
| Salon 10 | 19' x 38' | 722 | | 45 | 24 | 30 |
| Salon 11 | 20' x 15' | 300 | | n/a | 8 | n/a |
| Salon 12 | 26' x 56' | 1,120 | | 105 | 70 | 50 |
| Salon 12A | 19' x 28' | 560 | | 50 | 35 | 28 |
| Salon 12B | 19' x 28' | 560 | | 50 | 35 | 28 |
| Arena Pre-Function | 42' x 45' | 1,890 | | 180 | 120 | 85 |
| Ballet Room | 36' x 47' | 1,692 | | 160 | 110 | 8 |

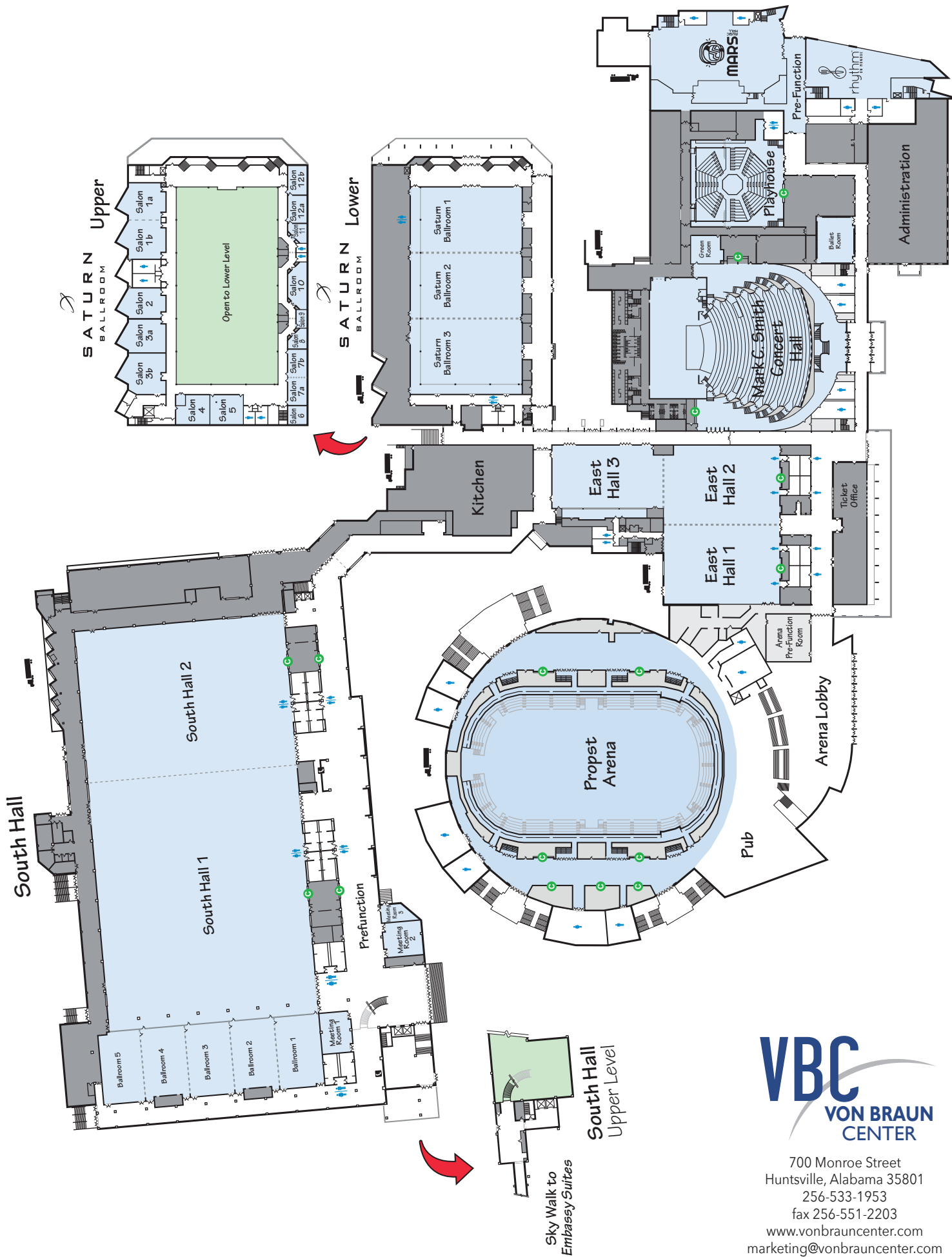

VBC
VON BRAUN
CENTER

700 Monroe Street
 Huntsville, Alabama 35801
 256-533-1953
 fax 256-551-2203
www.vonbrauncenter.com
marketing@vonbrauncenter.com

Sky Walk to
 Embassy Suites
 South Hall
 Upper Level

SERVICES & STAFFING



| SERVICE | RATES |
|---|------------------------------|
| Electrical Usage (Arena only) | \$600/day |
| Electrical Usage (Concert Hall only) | \$400/day |
| Electrical Usage (All Other Locations) | \$100/day |
| Electrical Service | |
| 120v, 20 amp | \$60 per drop per day |
| 120v, 30 amp | \$65 per drop per day |
| 208v, 30-59 amp | \$150 per drop per day |
| 208v, 60-99 amp | \$250 per drop per day |
| 208v, 100-200 amp | \$500 per drop per day |
| Other Electrical Services | rates available upon request |
| Sign Printing | rates available upon request |
| Water Hookup | \$115/day |
| One-time Pump Out Drain | \$150/day |
| Constant Drain | \$115/day |
| Compressed Air Hookup | \$115/day |
| Telephone Extensions | |
| Local | \$200 each/event |
| Long Distance | \$300 each/event |
| Polycom Conference Phone | \$400 each/day |
| Cable | \$150 each/event |
| Special Network Requirements | \$90/hr (2 hr minimum) |
| Internet | |
| RJ45 Drop/Hard Line | \$500 each/event |
| Additional Devices | \$150 each/event |
| Wireless Network Setup | |
| up to 35 attendees | \$30 per access (24 hrs) |
| up to 36-250 attendees | \$900 |
| up to 251-499 attendees | \$1,750 |
| up to 500-999 attendees | \$2,750 |
| 1,000 and above attendees | \$3,750 |
| *includes one SSID and password, each additional SSID | \$150 |
| Catering Services | refer to VBC Catering Guide |
| Tenant Insurance | rates available upon request |
| Excessive Cleanup Fee | \$325 minimum |
| Same Day Change-over Fee | \$325 plus casual labor |

| STAFFING (ALL STAFFING AT 3 HOUR MINIMUM) | RATES |
|--|-----------|
| Armed Security Officer | \$32/hour |
| Uniformed Supervisor | \$27/hour |
| Security Officer (Required for all events) | \$25/hour |
| T-shirt Security | \$25/hour |
| T-Shirt Security Supervisor | \$27/hour |
| Huntsville Police Officer | \$75/hour |
| Ushers | \$25/hour |
| Ticket Takers | \$25/hour |
| Doorguards | \$25/hour |
| Overnight Security | \$27/hour |
| Medical Attendant | \$40/hour |
| Ticket Sellers | \$25/hour |
| Host Coat Check | \$25/hour |
| Casual Labor | \$21/hour |

CONTINUED ON OTHER SIDE

CONTINUED FROM OTHER SIDE

| | |
|--|------------------------------------|
| Production Technician | \$40/hour (4 hour minimum applies) |
| Stage, Sound or Lighting Technician (Concert & Theatrical Production Only) | \$40/hour |
| Arena Video Operator | \$40/hour |
| Spotlight Operator | \$90/show |
| Searcher | \$25/hour |
| Search Supervisor | \$27/hour |

| BOX OFFICE / TICKETING SERVICES | RATES |
|--|-------------------------------|
| Arena | \$700/event* |
| Concert Hall | \$400/event* |
| Playhouse | \$400/event* |
| South Hall, East Hall, Saturn Ballroom | \$400/event* |
| *or 3% of gross ticket sales, whichever is greater | |
| Event Ticket Set Up | |
| Arena | \$500/event |
| Concert Hall | \$400/event |
| Playhouse | \$300/event |
| South Hall, East Hall, Saturn Ballroom | \$300/event |
| Credit Card Fee | 4% of total credit card sales |
| (Mastercard, Visa, Discover, American Express) | |
| Advertising Agency Services | 15% |

All tickets sold at the VBC are on the Ticketmaster computerized ticketing system.

| PARKING | RATES |
|---|------------|
| Clinton Avenue Parking Lot | \$10/space |
| South Hall Covered Garage | \$10/space |
| Monroe Street Parking Lot | \$10/space |
| Reserved Lessee Parking (subject to availability) | \$15/space |
| Special Parking Needs (subject to availability) | |
| Trailer without Vehicle | \$10/day |
| Trailer with Vehicle | \$20/day |
| Small Box Truck | \$10/day |
| Large Box Truck | \$20/day |
| Parking Attendant | \$21/hour |
| Parking Lead | \$23/hour |

EQUIPMENT



| EQUIPMENT | RENTAL RATES |
|---|------------------------------|
| Tables (select from 8' or 6' rectangular, 4' or 5' round, or 6'x18" classroom) | \$13/day |
| Draped or Skirted Tables | \$18/day |
| Cocktail Tables | \$13/day |
| Exhibit Booth / Divider Curtains 16' tall | \$10/foot/event |
| Exhibit Booth / Divider Curtains 14' tall Velour | \$12/foot/event |
| Exhibit Booth / Divider Curtains 12' tall | \$5/foot/event |
| Exhibit Booth / Divider Curtains 8' tall | \$3.50/foot/event |
| Exhibit Booth / Divider Curtains 3' tall | \$3/foot/event |
| Chairs (1-500) | \$1 each |
| Chairs (+500) | \$0.80 each |
| Chavari Chairs | \$7 each |
| Bleacher Seating (includes chairs) | \$5 seat/event |
| Staging (carpet) | \$2.75/sq ft day |
| Wenger Hard Deck Staging | \$3/sq ft day |
| Stage Ramp | \$50/day |
| Handicap Ramp | \$200/day |
| Plastic Dance Floor (White, Black or Wood Grain) | \$2.50/sq ft |
| Marley Dance Floor | \$500 + tape |
| Podium | \$30/day |
| Flip Chart | \$20/day |
| Easel | \$6/day |
| Dry Erase Board with markers | \$25/day |
| Portable Safe | \$30/day |
| In-House Two-Way Radio | \$25/day |
| Fire Extinguisher | \$30/day |
| Pianos (rates include one tuning) | |
| Baldwin Uprights | \$200/day |
| 5' Baby Grand | \$250/day |
| 7' Grand | \$300/day |
| Steinway 9' Grand (Concert Hall) | \$400/day |
| Piano Tuning | \$120 per piano |
| Fog Machine | \$105/day |
| Forklift includes driver | \$450/day |
| Scissor Lift | \$300/half day |
| Driver | \$55 plus driver/hour |
| Rope & Stanchion (per 8' section) | \$30/hour |
| Photocopies | \$8 each/day |
| Basketball Floor includes timers | \$0.25 each |
| Stage Barricade | \$3,000/event |
| Ticket Drop Box | \$525/event |
| Coat Rack | \$10/day |
| Coat Check (Set-up) | \$25/day |
| Premium Furniture Rental | \$55 + Casual Labor/hour |
| Exhibitor Services & Equipment | Rates available upon request |
| | Rates available upon request |



VIDEO

RENTAL RATES

| | |
|---|------------|
| Arena Video System | \$2000/day |
| Full use of arena video boards (boards run VBC content until show time) | |
| Single Screen Package | \$2200/day |
| Two screens (7x12 or 8x14), Two dress kits, Two projectors (5k or 6k), video distribution amp | |
| Dual Screen Package | \$1100/day |
| Screen (7x12 or 8x14), dress kit, projector (5k or 6k), video distribution amp | |
| 4K Projector | \$400/day |
| 5k/6k Projector | \$500/day |
| 7k/8k Projector | \$775/day |
| 10k Projector | \$1100/day |
| 15k Projector | \$1400/day |
| Long Throw Projection lens | \$120/day |
| Requirement depends on projector placement | |
| Video Distribution Amp | \$55/day |
| Projector Fly Cage | \$80/day |
| Projector Cart/Table | \$25/day |
| Video Camera | \$350/day |
| Video Switcher (basic) | \$250/day |
| Video Switcher (upgrade) | \$500/day |
| 7x12 Projection Screen | \$120/day |
| 7x12 Dress Kit | \$120/day |
| 8x14 Projection Screen | \$175/day |
| 8x14 Dress Kit | \$175/day |
| 9x16 Projection Screen | \$250/day |
| 9x16 Dress Kit | \$250/day |
| 12x20 Projection Screen | \$350/day |
| 12x20 Dress Kit | \$350/day |
| Tripod Projection Screen | \$50/day |
| 32" Tabletop TV | \$150/day |
| 65" TV on rolling stand | \$400/day |
| Confidence Video Monitor (27") | \$100/day |
| Confidence Video Monitor (42") | \$200/day |
| Wireless Presenter (Clicker) | \$30/day |
| Laptop | \$100/day |

AUDIO

RENTAL RATES

| | |
|---|-------------------------|
| Playhouse Sound System | Included in Room Rental |
| Mixer, basic venue speakers, 2 wired mics, 2 audio monitors, 1 DI Box | |
| Concert Hall Basic System | \$1000/day |
| Mixer, basic venue speakers, 2 wired mics, 2 audio monitors, 1 DI Box | |
| Concert Hall Full System | \$3000/day |
| Full EAW PA, EAW Subs, Front Fills, Mixer, 2 wired mics, 2 audio monitors, 1 DI Box | |
| Concert Hall Audio (no subs) | \$2000/day |
| Full EAW PA, Front Fills, Mixer, 2 wired mics, 2 audio monitors, 1 DI Box | |

CONTINUED

| | |
|--|------------|
| Arena Audio System | \$2000/day |
| Full venue speaker system, mixer, 2 wired mics, 2 audio monitors, 1 DI Box | |
| Small Audio Mixer | \$100/day |
| 32 Channel Digital Mixer | \$200/day |
| Midas Pro2 Mixer System | \$500/day |
| DI Box | \$20/day |
| Speaker | \$100/day |
| Wired Microphone | \$20/day |
| Wireless Microphone (Handheld, Lav, or Headset) | \$80/day |
| Mic Stand (without mic) | \$10/day |
| Press Mult Box | \$100/day |
| Portable Sound System | \$250/day |
| 1 mixer, 1 wired microphone, 1 DI Box, 1 speaker | |

DECORATING

RENTAL RATES

| | |
|-------------------------|-----------------|
| Taffeta Wall | \$10/ft (width) |
| Taffeta Column | \$100/each |
| Taffeta Wheel (8 Spoke) | \$500/each |

LIGHTING

RENTAL RATES

| | |
|-------------------|------------|
| Focal/Wash | \$25/day |
| LED Uplight | \$35/day |
| Gobo Fixture | \$35/day |
| Followspot | \$150/day |
| Custom Metal Gobo | \$150/each |
| Custom Glass Gobo | \$250/each |
| Hazer | \$175/day |
| Mirror Ball | \$100/day |

LABOR

RENTAL RATES

| | |
|--|-----------|
| Production Technician | \$40/hr |
| 4hr minimum, First 8 hours worked, 8a-12a | |
| Production Technician Premium Time | \$60/hr |
| Any hour exceeding 8 hours in a day OR 12a-8a | |
| Rigger | \$60/hr |
| Teams of three, 4hr minimum | |
| Rigger Premium Time | \$90/hr |
| Any hour exceeding 8 hours in a day OR 12a-8a | |
| Music Hall Production Technician | \$400/day |
| Technician to run Audio, Lighting, and/or Video in Mars Music Hall | |

All equipment listed above is subject to availability.

**Production Technician required with audiovisual equipment.*

PROPST ARENA VIDEO PRODUCTION REQUIREMENTS & SPECIFICATIONS



OUTPUT

- **MAIN BOARDS** (1 each East and West):
 22' by 12' LED screens, 352 pixels tall by 640 pixels wide. High Definition 16:9 ratio.
- **FASCIA BOARDS** (1 each East and West):
 4' by 99' LED screens, 64 pixels tall by 1536 pixels wide. These boards can be segmented in any combination up to 8 64x192 panels or windows.
- **CONCOURSE MONITORS:** (17 including 4 in private suites)
 47" LCD flat panels may optionally play Arena media, a second input, or Comcast cable channels.
- **SOUND OUTPUT:**
 In room sound is distributed array in 80 speakers plus subs around the roof hub. Concourse LCD monitors and pendant speakers also play the sound outputs.

INPUT REQUIREMENTS

- **PICTURES, PHOTOS or SLIDES:**
 - .PNG and .JPG files are acceptable.
 - Graphics must be created using an RGB color space.
 - Graphics must be in the pixel size of the target window.
 - Powerpoint slides can be converted complete with pictures and captions
 No transitions are to be used in the Powerpoint setup
 Set the page setup to 16:9
- **VIDEOS:**
 - Must be created in an RGB color space using 16:9
 - Pixel resolution must match the intended screen.
 - Any HD format is acceptable (16:9)
 Must be saved as an AVI file
 No compression
 59.94 frames per second
 Sound **MUST** be interleaved (frame by frame)
- **OTHER:**
 - BlueRay discs are an acceptable feed.
 - Your HD camera, PC or Laptop (WXGA resolution) are also acceptable feeds.
 - Two VBC-owned pan-tilt-zoom high definition cameras are mounted on the east and west ends of the Propst Arena near the main boards. These can serve as screen input or picture in picture.
 - All content including cameras may be recorded to our BlueRay HDD Recorder.

| VIDEO SERVICE | RATES |
|---|--|
| SCREEN RENTAL | \$840 per day, all screens, monitors and PTZ cameras |
| GRAPHICS PRO SERVICES: | |
| Integration Service | \$75 per hour for creation, conversion, programming (2-hour minimum) |
| EVENT OPERATION SERVICES | |
| Video Operator | \$40 per hour, typical setup, event and strike 5 hours |
| <i>We will estimate pricing based on your individual needs.</i> | |

All equipment listed above is subject to availability.