

See where the water takes you.

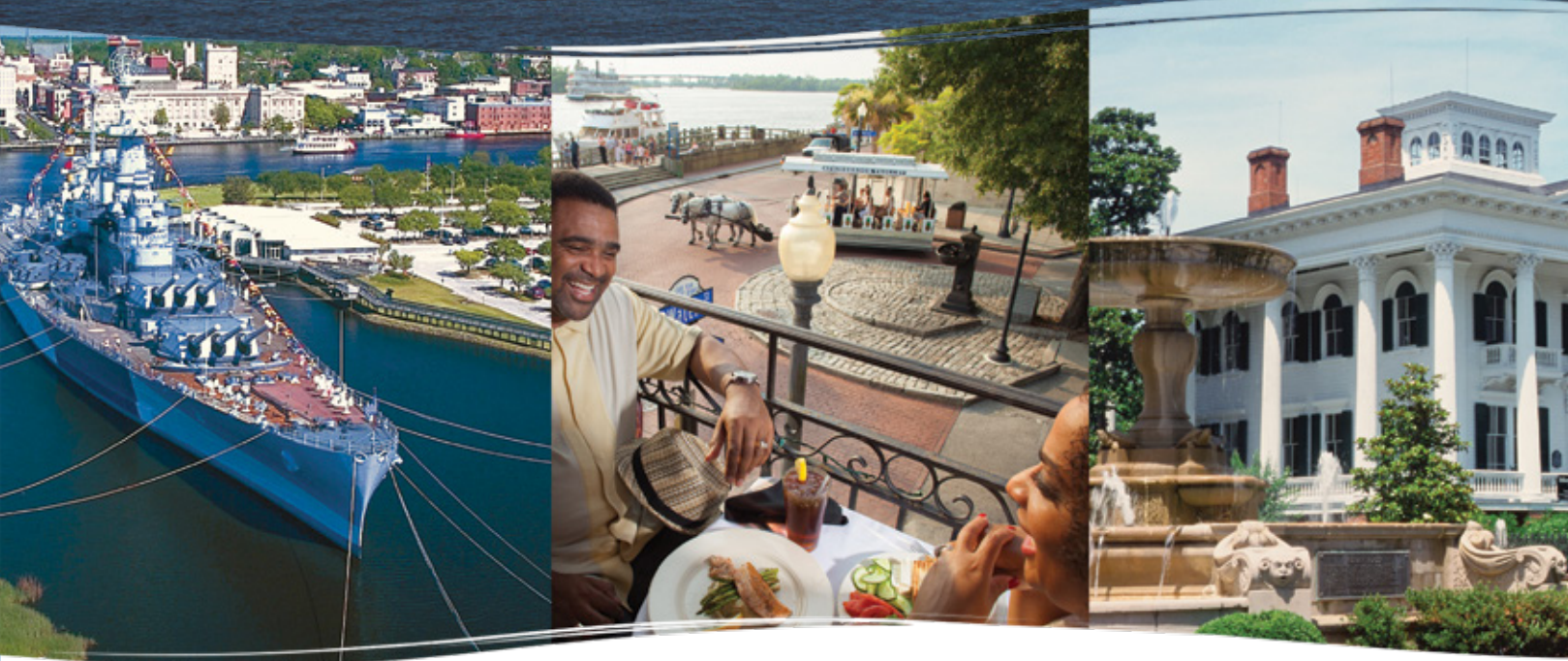





## INSPIRING MEETINGS START WITH INSPIRING SETTINGS

With an award-winning, bustling riverfront, National Register Historic District and nearby island beaches, people are naturally drawn to Wilmington, N.C. Our mild climate and rich culture – including more than 200 restaurants, shops and attractions in the downtown area alone – offer something for everyone. Whether it's just for a meeting or event, or staying for a few days before or after, Wilmington is the kind of destination planners seek out for their meetings and events.

Specializing in small-and medium-size meetings, we offer a multitude of indoor and outdoor meeting and convention facilities and natural settings, as well as an exceptional range of attractions, personalized and professional service, and all the right elements for increasing your meeting attendance at this favorite meeting and vacation destination.

## CONVENTION DISTRICT CONNECTED BY A SCENIC RIVERWALK



Wilmington is one of N.C.'s favorite vacation destinations and a natural to become your next favorite meetings destination.

Our multiuse Convention District is located riverfront and within Wilmington's downtown River District, all connected by a nearly two-mile scenic Riverwalk that makes it easy for attendees to get around. We cater to small businesses, associations, corporations, family reunions or somewhere in between. From state-of-the-art wireless exhibit halls and elegant ballrooms to the irresistible charm of a historic home with soul stirring porch views as a special event venue option, our variety of venues is unmatched and always appealing.

For something a little more traditional but still far from the ordinary convention center, the sleek, 107,000-square-foot Wilmington Convention Center

is the largest convention center on N.C.'s coast. Located downtown, it offers sweeping riverfront views and plenty of natural light that helps bring the outdoors in. Adjacent to the convention center is the Port City Marina and Pier 33. Networking and socializing becomes a breeze when it takes place on or by the water.

Other downtown meeting facilities include the historic Coastline Conference and Event Center, which retains the charm of its red brick railroad depot days while offering modern amenities. Nearby, the Hotel Ballast Tapestry Collection by Hilton offers 20,000-square-feet of meeting space, plus an on-site Ruth's Chris Steak House. The full-service Embassy Suites Wilmington Riverfront Hotel located adjacent to the Wilmington Convention Center provides convenient accommodations for visitors and events held at the convention center.



# THE LARGEST CONVENTION CENTER ON NORTH CAROLINA'S COAST

The maritime-themed Wilmington Convention Center offers meeting capabilities up to 2,000 people and a variety of spaces. Its surroundings lead to a positive frame of mind and productivity with access to water, fresh air, and wellness and networking activities offered during breaks. Multiple nearby hotels all located within walking distance and connected by nearly two miles of Riverwalk along the Cape Fear River make it easy for attendees to get around.



## Other details:

- 30,000-square-foot Exhibit Hall
- Full A/V, sound systems, lighting controls, concessions and Internet
- 30-foot ceiling height
- Drive-in floor access suited for tractor trailers
- 5,784 square feet of additional meeting space with option to divide into 8 separate rooms
- 12,000-square-foot Grand Ballroom with option to divide into 6 separate rooms
- 12,000 square feet of outdoor space on the Event Lawn
- 15,000+ square-foot pre-function space
- Covered outdoor riverfront seating with spectacular river views
- 580+ space parking deck
- LEED® certification
- Wilmington International Airport (ILM) four miles away

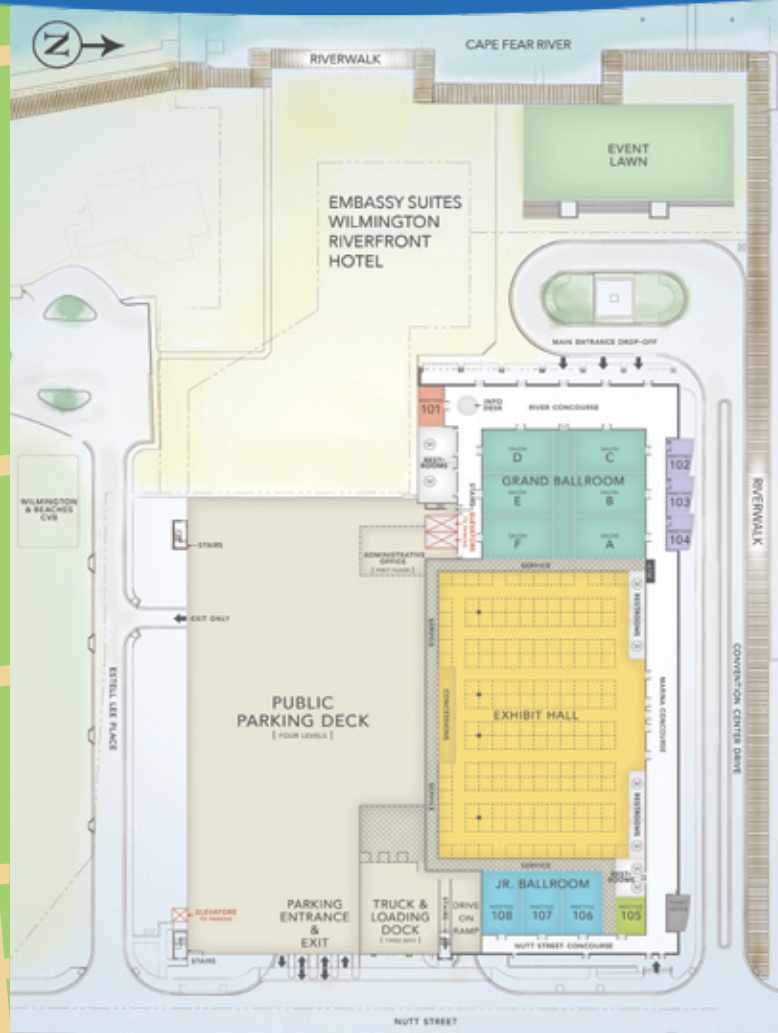

# CONVENTION DISTRICT MEETING AND CONVENTION HOTELS

Wilmington offers outstanding accommodations and meeting facilities. The Embassy Suites Wilmington Riverfront Hotel located adjacent to the Wilmington Convention Center offers 186 guest suites and 3,000 square feet of meeting space with a near 360 degree roof top bar. The Hotel Ballast Tapestry Collection by Hilton features 272 guest rooms and suites and 20,000 square feet of meeting and banquet space, while the Courtyard by Marriott Wilmington Downtown/Historic District has 124 guest rooms and suites and over 1,800 square feet of event space. The Best Western Plus Coastline Inn's 53 guest rooms and suites all boast riverfront views, along with 10,150 square feet of meeting space at the adjacent Coastline Conference and Event Center. And the Hampton Inn Downtown provides overflow rooms for meetings and conventions with 92 guest rooms and suites and a 1,222 square foot meeting room.

For a complete hotel and lodging list, visit [NCCoastalMeetings.com](http://NCCoastalMeetings.com)



## Meeting and Convention Hotels

	Number of Guest Rooms & Suites	Number of Meeting Rooms	Theater Capacity	Classroom Capacity	Banquet Capacity
Embassy Suites Wilmington Riverfront Hotel	186	7	375	200	260
Hotel Ballast Tapestry Collection by Hilton	272	14	800	400	500
Courtyard by Marriott Wilmington Downtown/Historic District	124	3	80	48	70
Best Western Plus Coastline Inn	53	5	950	500	700
Hampton Inn Downtown	92	1	60	40	60

## Unique Off-Site Meeting and Event Venues

Venues like the Battleship NORTH CAROLINA, Civil War era historic homes, breweries, an event pier and more provide unexpected choices for meeting and event attendees.

128 South

Airlie Gardens

Bakery 105

Battleship NORTH CAROLINA

Bellamy Mansion Museum

Cameron Art Museum

Hannah Block Historic USO

North Waterfront Park

Pier 33

Thalian Hall Center for Performing Arts

The Beam Room at Front Street Brewery

The River Room

Union Station

Wilson Center





# EXPERIENCE THE PERKS OF MEETING IN A COASTAL DESTINATION WITH THE CONVENIENCES AND AMENITIES OF A BIG CITY

From our choice location and superb facilities, to all there is to do when your meetings adjourn, Wilmington allows you to defy convention when planning your next meeting or event. And thanks to good weather year-round, it's an ideal location for outdoor events.

## A Distinctive Destination

- Voted as America's Best Riverfront
- Combines the city's historic charm with modern design and new attractions
- 230-plus block National Register Historic District is one of the largest in the country
- Downtown walkable access to entertainment, shops, and cafes, many of which offer outdoor dining and views of Wilmington's spectacular sunsets over the river
- Three nationally recognized beaches just minutes from Wilmington: Carolina Beach, Kure Beach and Wrightsville Beach

## Maximum Registration Potential

- Many groups max out their registration at meetings and events held here
- Unlimited pre- and post-vacation opportunities
- The University of North Carolina Wilmington offers an abundance of academic resources and speakers for meeting and event planners

## Plenty to See and Do

- Visitors and groups can choose from an assortment of water- and land-based tours including history, craft beer, horse-drawn carriage and Segway tours, kayak/canoe excursions, narrated cruises, behind the scenes film tours and culinary adventures
- The area hosts a busy lineup of festivals and special events throughout the year that may already be taking place during planned meetings and conventions
- Multiple championship golf courses located nearby

## Affordability

- Hotels typically offer off-season rates November through March
- Sunday arrivals and mid-week arrival and departure patterns are most affordable
- Downtown location and Convention District make it less costly and more convenient for attendees to enjoy the city and off-site activities

# NORTH CAROLINA'S MOST ACCESSIBLE COASTAL DESTINATION

Wilmington is located between the Cape Fear River and the Atlantic Ocean in southeastern N.C., just minutes away from three island beaches. It's convenient to get here whether traveling by car, plane or even boat, and easy to navigate once you arrive.

## By Car:

The major east/west interstate transportation artery I-40 leads directly to Wilmington, which is also served by U.S. highways 17, 74/76, 117 and 421. The area also features convenient access via the state's numerous interstate highways.

## By Plane:

Wilmington International Airport (ILM) provides the area and southeastern N.C. with major commercial and general aviation services. 910.341.4333, flyilm.com

## Distance In Miles

Asheville, NC .....	318	Norfolk, VA .....	250
Atlanta, GA .....	413	New York, NY .....	599
Charleston, SC .....	167	Raleigh, NC .....	123
Charlotte, NC .....	203	Washington, DC .....	360
Greensboro, NC .....	184	Winston Salem, NC .....	210
North Myrtle Beach, SC ...	60	Interstate I-95 .....	73

## Carriers Include:

Delta  
American Airlines  
United Airlines

## Non-Stop Destinations:

New York (LGA)  
Atlanta (ATL)  
Charlotte (CLT)  
Philadelphia (PHL)  
Washington DC (DCA)  
Dulles/Washington DC (IAD)  
Chicago (ORD)  
Dallas Fort Worth (DFW)

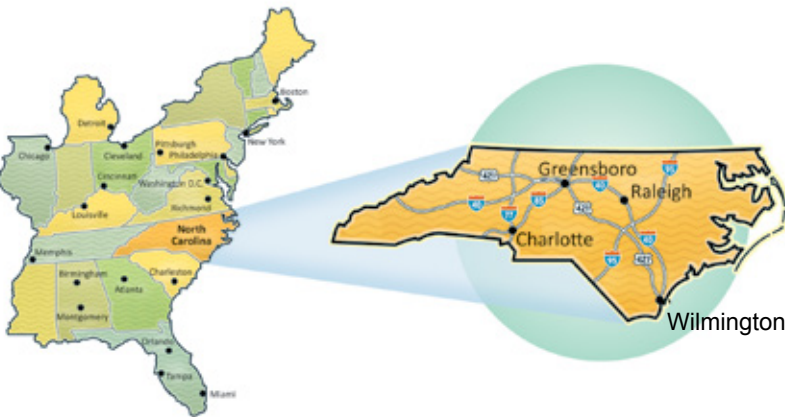

# A MEETING LOCATION THAT FEELS LIKE A VACATION

Meeting in Wilmington means variety for everyone! Attendees can arrive early or stay late to enjoy a wide variety of things to see and do.



## Pre- and Post-Vacation Ideas

- History buffs should head to **Burgwin-Wright Museum House & Gardens**, with its Colonial furnishings, 18th-century kitchen, and an outstanding period garden
- Explore the Victorian-era gardens and antebellum architecture at the **Bellamy Mansion Museum of History & Design Arts**
- Ride along the brick-lined streets of downtown in a **Springbrook Farms Horse-Drawn Carriage**
- Take a scenic cruise aboard **Wilmington Water Tours** or the **Cape Fear Riverboats**
- See real movie locations on the **Hollywood Location Walk of Old Wilmington**
- Tour the **Battleship NORTH CAROLINA**, former home to almost 2,000 men; she earned 15 battle stars for her distinguished service during World War II
- **Cape Fear Museum of History & Science** features the rich history, science and cultures of N.C.'s southern coast
- The **Wilson Center**, **Thalian Hall**, and many other venues offer a variety of live theater and concert performance options
- Explore **Historic Airlie Gardens**, encompassing 67 acres of beautiful Gilded Age gardens and lakes
- The kids will love **Jungle Rapids Family Fun Park**, with a water park, go-carts, jungle golf, laser tag, climbing wall, arcade and more
- Explore **Cameron Art Museum**, a collection of fine art, design and crafts
- Slip back into simpler times at the **Carolina Beach Boardwalk**, or hike through **Carolina Beach State Park** to see Venus flytraps in their indigenous environment
- **Fort Fisher State Historic Site**, site of the largest land/sea battle of the Civil War, and the **North Carolina Aquarium at Fort Fisher**, named one of the top aquariums in the country, are both located in Kure Beach
- Learn to paddleboard or surf at one of **Wrightsville Beach's** many camps, or end the day with a chartered sunset cruise aboard the **Wrightsville Beach Scenic Tours and Water Taxi**

## Services

The Wilmington and Beaches Convention & Visitors Bureau will help you plan the perfect meeting and find the best places for everything from meeting, eating, and sleeping to plugging in, working out and logging on.

## Virtual Tour of Convention District

[360.WilmingtonConventionDistrict.com](http://360.WilmingtonConventionDistrict.com)

## Contact Us

Find out more about the area's meeting hotels, facilities and unique venues.

**John W. Sneed II, CHSP**

Vice President of Sales & Services

800.650.9064, ext. 125 or 910.332.8757

[jsneed@wilmingtonandbeaches.com](mailto:jsneed@wilmingtonandbeaches.com)

[NCCoastalMeetings.com](http://NCCoastalMeetings.com)

**Wilmington.C.**  
River District & Island Beaches

**505 Nutt Street, Unit A, Wilmington, NC 28401 | [NCCoastalMeetings.com](http://NCCoastalMeetings.com) | 800.650.9064**

*Official publication of the Wilmington and Beaches Convention & Visitors Bureau*