

VISIT  
**THE WOODLANDS**  
— T E X A S —



OFFICIAL  
*MEETING PLANNER  
GUIDE*



# Table of Contents

## VISIT THE WOODLANDS TEXAS

### Visit The Woodlands Staff:



**Josie Lewis**  
Director of Sales  
(281) 210-3483

[Josie.Lewis@visitthewoodlands.com](mailto:Josie.Lewis@visitthewoodlands.com)



**Mariana Almanza-Cook**  
Sales and Servicing Coordinator  
(281) 210-3470

[Mariana.Almanza@visitthewoodlands.com](mailto:Mariana.Almanza@visitthewoodlands.com)

### Official Convention and Visitors Bureau

2801 Technology Forest Blvd  
The Woodlands, TX 77381  
(281) 363-2447  
[visitthewoodlands.com](http://visitthewoodlands.com)

### Follow us:

@VisitTheWoodlands  
 @VisitTheWoodlands  
 @TheWoodlandsCVB

- 4 Introduction
- 6 Welcome Map
- 8 Hotels at a Glance
- 10 Hotels & Venues
- 14 Our Services
- 15 Team Building Activities
- 16 After the Meeting / Dining
- 18 Hotel Layouts
- 23 Airports & Transportation





“

*This hardly  
feels like work.*

WE HEAR THAT A LOT.

Here, events come together effortlessly. With all the hosting capabilities of a larger city, neighboring proximity to major Houston airports, and one of the region's top shopping, dining and entertainment areas, The Woodlands is a place of ideal paradox and a breath of fresh air. Lively, yet serene. Urban, yet spacious. Refined, yet casual.

WELCOME TO THE WOODLANDS.



## The Woodlands at a Glance:

**14** *hotel  
properties*

  
**TWO BOAT HOUSES**  
*with watersport  
equipment rentals*

  
**PREMIER**  
*shopping  
& dining*

  
**12,000 ACRES**  
*of protected  
pine forests*

  
**GLOBALLY  
RECOGNIZED**  
*outdoor  
concert  
venue*

*Walkable  
destination*  
(220 MILES OF TRAILS)

**MORE THAN**  
**2,200**  
*hotel rooms*

*Over  
300 holes*  
OF GOLF ON  
CHAMPION-DESIGNED  
COURSES



  
**25**  
**MINUTE**  
**DRIVE FROM**  
**IAH**  
**AIRPORT**

**OVER 135**  
*parks and  
green spaces*

  
**FREE**  
*trolley*  
**AROUND TOWN**

*Meeting space:*  
**160,000** **SQ.FT.**  
**TOTAL**



# Welcome to The Woodlands



**Embassy Suites**

**Hughes Landing**

**Lakes Edge Boat House**

Lake Woodlands Dr.

Hughes Landing Blvd.

**Town Center Trolley**

Lake Robbins Dr.

**Town Green Park**

**Riva Row Boat House**

Riva Row

**Glade Cultural Center & Gallery**

Woodlands Pkwy.

Hyatt Place

Lake Front Cir.

Hilton Garden Inn

Residence Inn Market Street

**Lake Woodlands Crossing**

Grogans Mill Rd.

Hyatt Centric

Cinemark

**Market Street**

Visitor Kiosk

**The Cynthia Woods Mitchell Pavilion**

**The Waterway Marriott**

**Waterway Square**

**The Westin**

Waterway Square Pl.

Lake Robbins Dr.

**The Woodlands Waterway**

**Swan Boats**

Timberloch Pl.

**George Mitchell Nature Preserve**

**Texas Tree Ventures**

**The Woodlands Resort**

Candlewood Suites  
Fairfield Inn & Suites

**Medical Plaza Dr.**

Residence Inn  
Lake Front

Courtyard  
by Marriott

Drury Inn  
& Suites

Best Western Plus

Lake Front Cir.

**Pinecroft Center**

Lake Woodlands Dr.

**The Woodlands Mall**

45

45

Robinson Rd.

Woodlands Pkwy.

Glen Loch Dr.

Grogans Mill Rd.



# Hotels at a Glance

GATHER, NETWORK AND STAY WITH PURPOSE  
AT HOTELS AND SPACES DESIGNED TO  
PLEASE ATTENDEES WITH DIVERSE INTERESTS  
AND DISCERNING TASTES.

We get it. Coordinating accommodations for guests while also finding the right event space is a huge task. The Woodlands has 14 different hotel properties many with flexible meeting spaces and modern conveniences. And with most hotels located in or near Town Center area, coordinating evening activities for groups is a breeze.



Hotel	# of rooms	Total meeting space
The Woodlands Resort & Conference Center	406	60,000+ square feet
The Woodlands Waterway Marriott Hotel & Convention Center	343	70,000+ square feet
The Westin at The Woodlands	302	10,000+ square feet
Embassy Suites by Hilton The Woodlands at Hughes Landing	205	3,300 square feet
Drury Inn & Suites Houston The Woodlands	147	833 square feet
Hyatt Place Houston The Woodlands	146	3,940 square feet
Hilton Garden Inn The Woodlands	117	2,200 square feet

Hotel	# of rooms	Total meeting space
Residence Inn Houston The Woodlands / Market Street	96	N/A
Candlewood Suites Houston The Woodlands	91	425 square feet
Residence Inn Houston The Woodlands / Lake Front Circle	90	N/A
Courtyard by Marriott Houston The Woodlands	90	625 square feet
Fairfield Inn & Suites Houston The Woodlands	83	288 square feet
Hyatt Centric The Woodlands	70	2,700 square feet
Best Western Plus The Woodlands	62	1,000 square feet



# THE WATERWAY MARRIOTT HOTEL & CONVENTION CENTER

- 70,000 square feet of event space
- Stunning Waterway views
- Walking distance to Town Center area
- Concierge level
- On-site restaurant and bar
- Deluxe guest rooms and suites
- Spa and fitness center



**343** HOTEL ROOMS

70,000+  
SQUARE FEET  
TOTAL EVENT SPACE  
TROLLEY STOP



For more information, go to  
[visitthewoodlands.com/waterwaymarriott](http://visitthewoodlands.com/waterwaymarriott)



# THE WESTIN AT THE WOODLANDS

- More than 10,000 square feet of event space
- Central location in the Waterway Square area
- Italian-inspired restaurant
- Deluxe guest rooms and suites
- Fitness center and infinity pool
- Poolside terrace and bar with cabanas
- Full-service Starbucks®



**302** HOTEL ROOMS

10,000+  
SQUARE FEET  
TOTAL EVENT SPACE  
TROLLEY STOP



For more information, go to  
[visitthewoodlands.com/thewestin](http://visitthewoodlands.com/thewestin)





# THE WOODLANDS RESORT & CONFERENCE CENTER

- Over 60,000 square feet of event space
- Four on-site restaurants (including a renowned steakhouse)
- Two on-site golf courses
- Full schedule of daily activities offered year-round
- 21 on-site tennis courts
- Complimentary shuttle service to Town Center
- Full-service spa and fitness center
- The Forest Oasis Waterpark and Lazy River



For more information, go to  
[visitthewoodlands.com/woodlandsresort](http://visitthewoodlands.com/woodlandsresort)



406 *HOTEL ROOMS*



60,000+  
 SQUARE FEET

*TOTAL EVENT SPACE*

**FREE SHUTTLE**



# Unique Venues

HOME TO MANY PRIVATE SPACES DESCRIBED AS MODERN, HIP OR UNCONVENTIONAL, THE WOODLANDS IS THE PERFECT PLACE TO HOST AN EVENT THAT'S OUTSIDE THE BOX.

## WOODFOREST BANK CLUB

- 1,600 square feet of event space
- Two patio decks, each 1,200 square feet
- Three full-service bars
- A/V capabilities

## THE WOODLANDS COUNTRY CLUB

- Over 5,000 square feet of event space
- Patios with panoramic golf course views
- Three award-winning golf courses
- A/V capabilities

## GLADE CULTURAL CENTER & GALLERY

- Over 6,000 square feet of event space
- Art gallery setting with patio overlooking the lake
- Full-service and open catering options available
- High-tech A/V capabilities and valet service

## THE PAVILION EVENT CENTER

- 21,000 square feet of event space
- Full bar and catering services
- Separate event suites
- A/V capabilities





# Our Services

WE'RE HERE TO MAKE YOUR LIFE EASIER! VISIT THE WOODLANDS IS YOUR DEDICATED RESOURCE TO HELP WITH PLANNING A SUCCESSFUL EVENT AND ENSURING YOU CAN FOCUS ON ALL THE IMPORTANT DETAILS WHILE WE TAKE CARE OF THE LOGISTICS.



# Team Building Activities

FROM THRILLING CHALLENGES TO FRIENDLY, COMPETITIVE FUN, THE WOODLANDS HAS A WIDE RANGE OF OPTIONS PERFECT FOR MEMORABLE TEAM BUILDING OUTINGS.



For more information, go to [visitthewoodlands.com/servicing](https://www.visitthewoodlands.com/servicing)

## TOPGOLF

Plan a fun golf outing that's perfect for any skill level at Topgolf.

- Over 100 climate-controlled hitting bays
- Full-service restaurant and bar
- Private event rooms
- Free Wi-Fi
- Rooftop terrace with fire pit

## IFLY

Let your group experience the thrill of skydiving — no airplane jumping required.

- Flight enhancement options
- On-site catering available
- Private event rooms



## SPEEDSPORTZ

Hit the gas pedal and race for bragging rights at the outdoor go-karting track Speedsportz.

- Specializes in group events for up to 500 people
- Team-building relay-style race competition
- Two 1,200-square-foot patios
- 1,120-square-foot meeting room
- On-site catering available

## TEXAS TREEVENTURES

Groups will bond quickly at this thrilling aerial ropes adventure course through the treetops.

- Three-level aerial adventure course
- Over 70 challenging and thrilling course elements
- Catering options available

## BOWLERO

Go for nostalgia with an upscale twist with a group bowling event at Bowlero.

- 40 bowling lanes
- Arcade
- Sports bar and food
- Private event rooms
- Free Wi-Fi



# After the Meeting

WITH ONE OF THE NATION'S TOP-RANKED OUTDOOR CONCERT VENUES, REGIONALLY ACCLAIMED SHOPPING, AND EXCITING NIGHTLIFE AND ENTERTAINMENT, ATTENDEES WILL FIND PLENTY OF PLACES TO EXPLORE AND MANY WAYS TO FILL THEIR FREE TIME.



## LIVE MUSIC

- The Cynthia Woods Mitchell Pavilion
- Waterway Nights live concert series
- Rock the Row live concert series
- Concerts in the Park live concert series

## NIGHTLIFE

- Como Social Club Poolside Terrace + Bar
- Local Pour
- Blend Bar
- Baker Street Pub
- The Goose's Acre
- Plus more!



## SHOPPING

- **Market Street:** outdoor upscale retail area with shopping, dining, a hotel and movie theater
- **The Woodlands Mall:** over 160 brand-name retailers in a spacious indoor shopping environment

For more information, go to [visitthewoodlands.com/attractions](http://visitthewoodlands.com/attractions)

# Dining

FIND A REASON TO INDULGE, AT ANY TIME OF DAY, FOR ANY OCCASION.



## WATERFRONT VIEWS

- Truluck's Seafood Steak & Crab House
- Fogo de Chão
- Broken Barrel
- Churrascos
- Sorriso
- Cyclone Anaya's



## BRUNCH & COFFEE SPOTS

- Blue Door Coffee
- Sweet Paris Crêperie
- Levure Bakery
- Snooze: an AM Eatery
- Black Walnut Café



## GROUP PRIVATE DINING OPTIONS

- Amerigo's Grille
- Black Walnut Café
- Brio Tuscan Grille
- Churrascos
- Como Social Club Poolside Terrace + Bar
- CRÚ Food & Wine Bar
- Del Frisco's Grille
- Fielding's Local Kitchen + Bar
- Fleming's
- Fogo de Chão
- Grotto
- Jasper's Gourmet Backyard Cuisine
- Kirby's Prime Steakhouse
- Landry's Seafood
- Local Pour
- Morton's Grille
- Perry's Steakhouse
- Rico's Mexican Grill
- Robard's Steakhouse
- The Goose's Acre
- The Refuge
- The Republic Grille
- Sorriso
- Tommy Bahama
- TRIS
- Truluck's Seafood Steak & Crab House

For a complete list of restaurants, go to [visitthewoodlands.com/dining](http://visitthewoodlands.com/dining)



THE WATERWAY MARRIOTT  
HOTEL & CONVENTION CENTER

- MEETING ROOMS
- BALLROOMS
- RESTROOMS

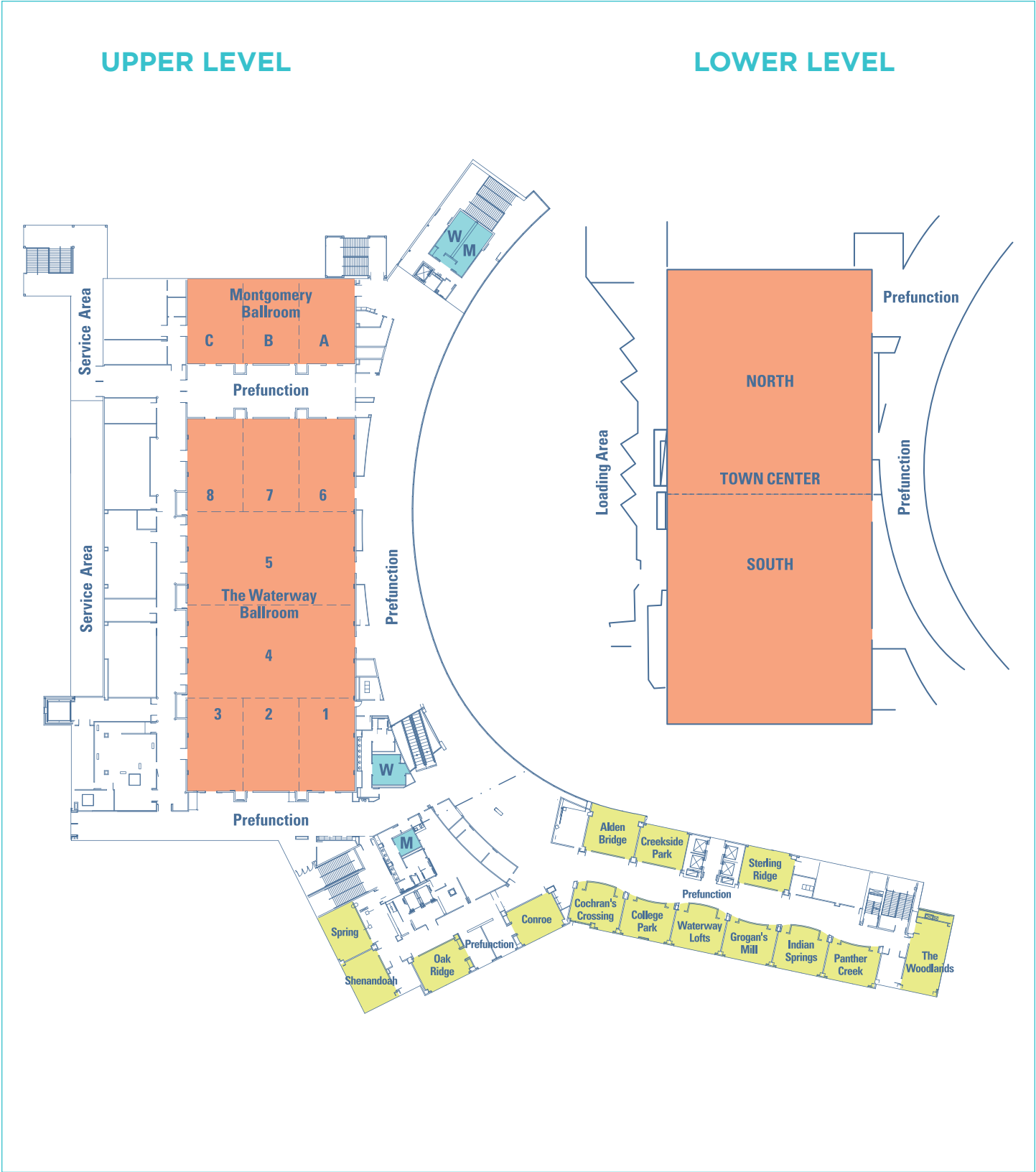

MEETING ROOM	DIMENSIONS	SQ. FT.	CLASS-ROOM	U-SHAPE	THEATER	BANQUET	RECEPTION	CONF.
The Town Center Exhibit Hall	286x130x20	37,180	2,300	-	4,900	3,000	4,500	-
The Town Center North	130x143x20	18,590	1,050	-	2,300	1,600	2,400	-
The Town Center South	130x143x20	18,590	1,050	-	2,300	1,600	2,400	-
The Waterway Ballroom	200x90x16	18,000	1,100	-	2,430	1,800	2,400	-
Waterway 1	30x50x16	1,500	96	35	182	100	200	35
Waterway 2	30x50x16	1,500	96	35	182	100	200	35
Waterway 3	30x50x16	1,500	96	35	182	100	200	35
Waterway 1-3	90x50x16	4,500	288	50	600	320	600	50
Waterway 4	90x50x16	4,500	288	50	600	320	600	50
Waterway 5	90x50x16	4,500	288	50	600	320	600	50
Waterway 4-5	90x100x16	9,000	575	-	1,200	700	1,200	-
Waterway 6	30x50x16	1,500	96	35	182	100	200	35
Waterway 7	30x50x16	1,500	96	35	182	100	200	35
Waterway 8	30x50x16	1,500	96	35	182	100	200	35
Waterway 6-8	90x50x16	4,500	288	50	600	320	600	50
The Montgomery Ballroom	90x45x16	4,050	200	-	540	320	520	-
Montgomery A	30x45x16	1,350	75	38	154	100	160	35
Montgomery B	30x45x16	1,350	75	38	154	100	160	35
Montgomery C	30x45x16	1,350	75	38	154	100	160	35
Alden Bridge	24x26x12	624	25	25	70	40	60	28
Sterling Ridge	19x28x12	532	24	24	50	30	50	24
Creekside Park	19x26x12	494	24	24	50	30	-	22
The Woodlands	19x40x12	760	40	30	80	50	70	34
Panther Creek	18x28x12	504	24	24	50	30	50	24
Indian Springs	18x28x12	504	24	24	50	30	50	24
Grogan's Mill	18x28x12	504	24	24	50	30	50	24
College Park	18x27x12	486	24	24	50	30	48	24
Cochran's Crossing	18x27x12	486	24	24	50	30	48	24
Conroe Conference Room	19x26x12	494	-	-	-	-	-	10
Oak Ridge Conference Room	19x26x12	494	-	-	-	-	-	10
Shenandoah	19x28x12	532	24	24	50	30	50	24
Spring	19x27x12	513	24	15	30	20	-	15
Waterway Lofts	25x15x12	375	18	-	30	20	35	20



THE WOODLANDS RESORT & CONFERENCE CENTER

- MEETING ROOMS
- BALLROOMS
- RESTROOMS

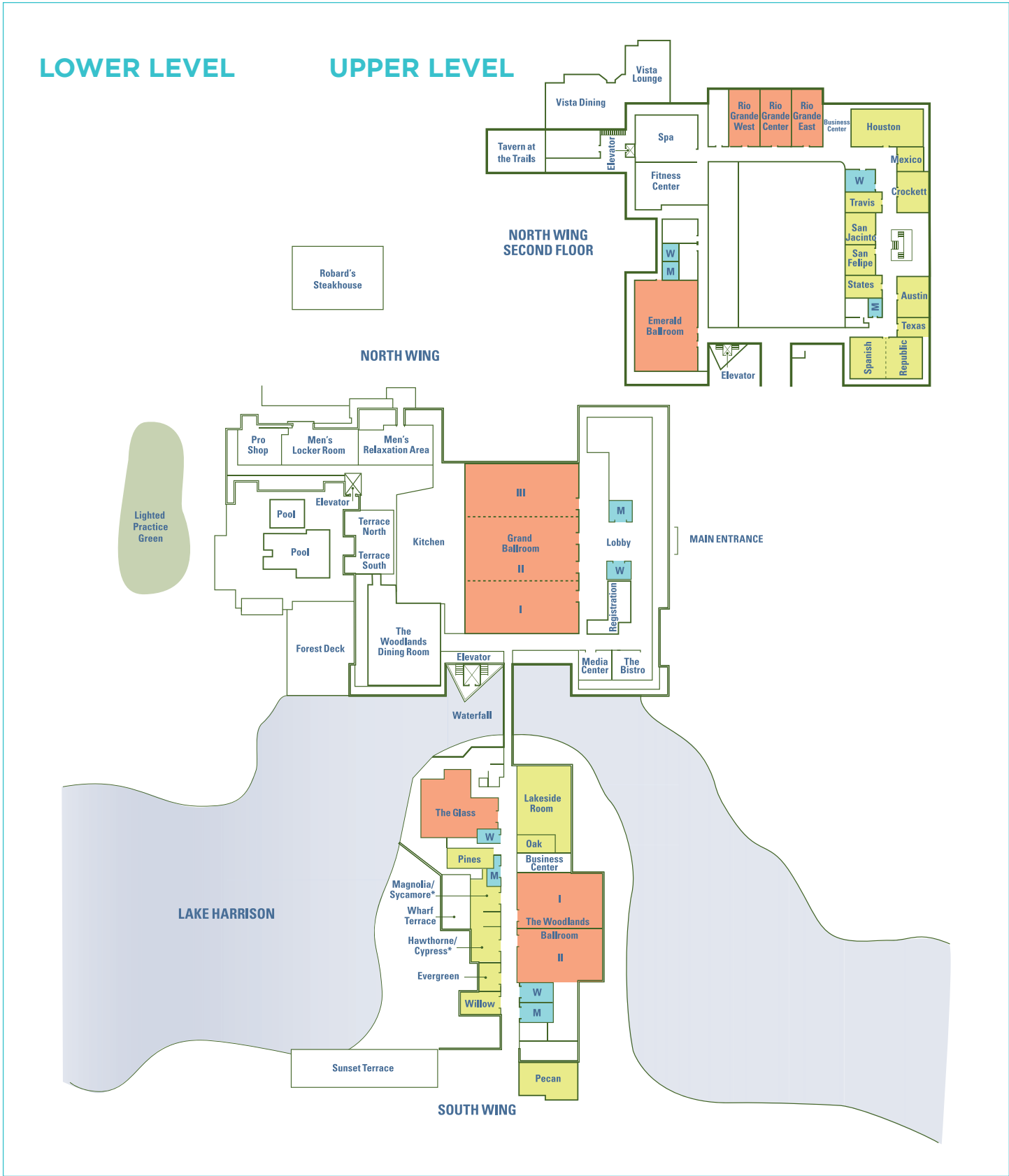

	North Wing (First Floor)								
	MEETING ROOM	DIMENSIONS	SQ. FT	CLASS-ROOM	U-SHAPE	THEATER	ROUNDS	SEMI-ROUNDS	CONF.
North Wing (First Floor)	Grand Ballroom I	85x49	4,165	160	64	336	280	140	25+
	Grand Ballroom II	85x60	5,100	220	68	450	350	175	25+
	Grand Ballroom III	85x49	4,165	160	64	336	280	140	25+
	Grand Ballroom I, II, & III	85x158	13,430	560	-	1,240	980	490	-
	Emerald Ballroom	64x60	3,840	-	-	-	250	125	-
	Rio Grande West	38x29	1,102	48	24	75	64	32	20
	Rio Grande Center	38x32	1,216	48	24	75	64	32	20
	Rio Grande East	38x29	1,102	48	24	75	64	32	20
	Rio Grande Ballroom	38x90	3,420	120	50	200	180	90	-
	Houston	40x54	2,160	100	40	150	100	50	20
North Wing (Second Floor)	Mexico	20x25	500	18	12	25	16	8	14
	Crockett	29x39	1,131	50	24	70	48	24	20
	Austin	29x39	1,131	50	24	70	48	24	20
	Texas	20x25	500	18	12	25	16	8	14
	Republic	39x34	1,326	50	27	70	72	36	20
	Spanish	39x34	1,326	50	27	70	72	36	20
	Spanish/Republic	39x68	2,652	100	48	180	144	72	-
	States	19x34	646	28	16	40	24	12	16
	San Felipe	30x29	870	32	20	60	40	20	20
	San Jacinto	30x29	870	32	20	60	40	20	20
South Wing	Travis	19x34	646	28	16	40	24	12	16
	Vista Dining	32x34	1,088	50	32	120	50	25	20
	Vista Lounge	44x25	1,100	-	-	-	64	32	-
	The Glass	54x69	3,061	-	-	-	120	-	-
	Lakeside Room	56x74	4,144	170	40	300	250	125	-
	Oak	39x19	741	30	18	40	32	16	20
	The Woodlands Ballroom I	60x50	3,000	140	46	300	220	110	-
	The Woodlands Ballroom II	60x50	3,000	140	46	300	220	110	-
	The Woodlands Ballroom I & II	60x100	6,000	280	78	600	430	225	-
	Pines	49x30	1,123	40	20	84	48	36	28
South Wing	Magnolia	34x27	918	40	18	50	48	24	20
	Sycamore (Lower Level)	34x27	918	40	18	50	48	24	20
	Wharf Terrace	64x27	1,728	-	-	-	180	90	-
	Hawthorne	33x27	891	40	18	50	48	24	20
	Cypress (Lower Level)	33x28	924	40	18	50	48	24	20
	Evergreen	30x23	690	24	16	40	40	20	20
	Willow	28x43	1,204	50	24	64	64	32	20
	Pecan	60x39	2,070	70	24	130	90	45	36
	Sunset Terrace	194x178	7,800	-	-	250	200	-	-



# THE WESTIN AT THE WOODLANDS

- MEETING ROOMS
- BALLROOMS

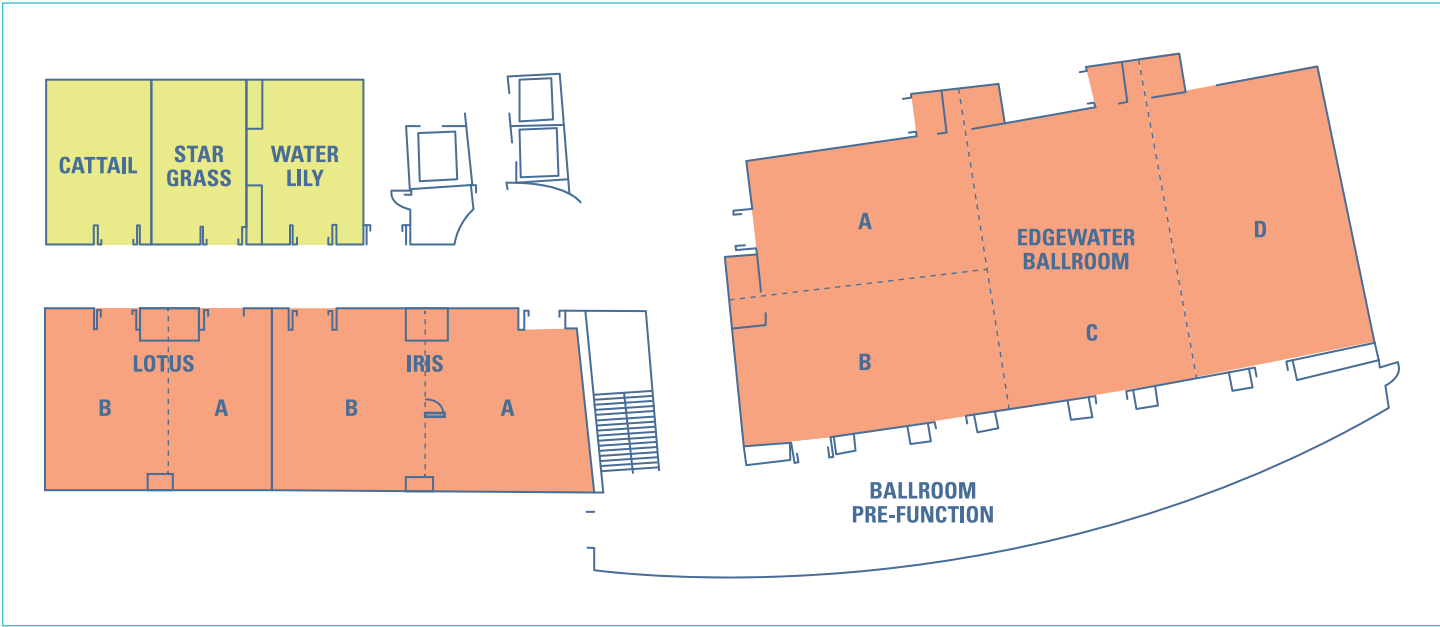

MEETING ROOM	DIMENSIONS	SQ. FT.	CLASS-ROOM	U-SHAPE	THEATER	BANQUET	RECEPTION	CONF.
Edgewater Ballroom	52x110	5,697	336	-	609	400	609	-
Edgewater A	25x40	1,018	48	20	100	60	112	20
Edgewater B	26x47	1,249	54	24	110	70	127	20
Edgewater C	52x35	1,780	108	26	168	130	191	24
Edgewater D	52x32	1,636	108	26	168	120	178	24
Edgewater A-B	52x44	2,265	108	34	234	130	239	24
Edgewater A-C	52x79	4,061	270	52	432	280	430	44
Edgewater C-D	52x66	3,416	216	38	384	240	369	36
Edgewater Foyer	21x135	2,771	-	-	-	-	200	-
Iris	29x57	1,653	78	28	174	110	167	28
Iris A	29x30	876	36	14	72	50	87	16
Iris B	29x27	777	36	12	60	50	80	12
Iris Foyer	25x48	1,203	-	-	-	-	-	-
Lotus	29x40	1,147	51	22	108	60	116	20
Lotus A	29x19	540	24	10	48	30	54	12
Lotus B	29x21	607	24	10	54	30	61	12
Lotus Foyer	12x71	853	-	-	-	-	-	-
Cattail	29x16	460	12	10	36	20	45	12
Stargrass	30x16	477	21	10	42	20	47	12
Water Lily	30x18	545	24	10	42	20	54	12



# Airports & Transportation

TAKE A DIRECT FLIGHT TO A SERENE DESTINATION WITH ALL THE BEST EVENT AMENITIES — ALL JUST A SHORT WALK OR FREE TROLLEY RIDE APART.

Designed to feel far away from it all yet convenient to get to, The Woodlands is located in close proximity to both major Houston airports. Many visitors choose a direct flight into **Houston's George Bush Intercontinental Airport (IAH)**, just a 25-minute drive from the heart of The Woodlands. Houston's **William P. Hobby Airport (HOU)** is also a convenient option, just a 45-minute drive away.

- Town Center Trolley
- Hotel shuttles
- Rideshares (Uber and Lyft)
- Taxis







VISIT  
**THE WOODLANDS**  
— T E X A S —

For inquiries, please email  
**[sales@visitthewoodlands.com](mailto:sales@visitthewoodlands.com)**

Follow us:

 **Facebook** @VisitTheWoodlands  
 **Instagram** @VisitTheWoodlands  
 **Twitter** @TheWoodlandsCVB

**[visitthewoodlands.com](http://visitthewoodlands.com)** | © 2019 Visit The Woodlands. All rights reserved.