

Exhibition Hall Level

FIRST FLOOR

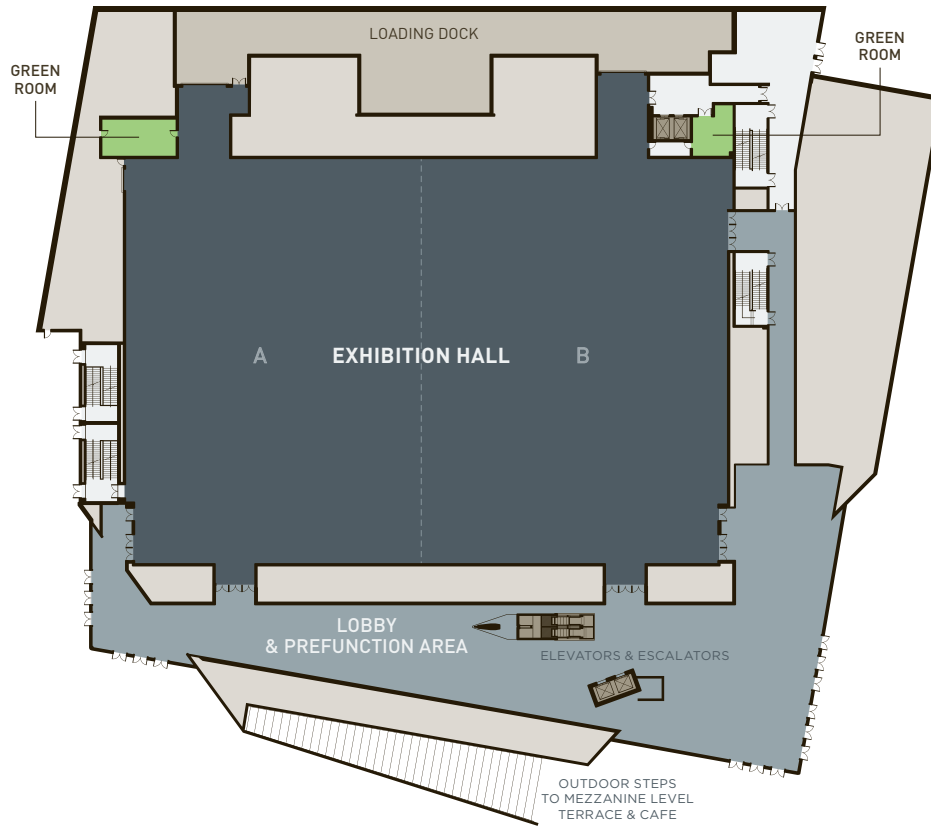

EXHIBITION HALL LEVEL	SIZE		CAPACITY					
	L x W x H	SQ. FT.	BANQUET 72" ROUNDS	RECEPTION	THEATER	CLASSROOM	8' x 10' BOOTHS	10' x 10' BOOTHS
EXHIBITION HALL	184 x 264 x 35	48,576	2,500	4,860	4,500	2,500	288	218
Exhibition Hall A	184 x 132 x 35	24,288	1,180	2,420	2,184	1,260	154	109
Exhibition Hall B	184 x 132 x 35	24,288	1,180	2,420	2,184	1,260	155	109
PREFUNCTION AREA	—	18,862	—	1,880	—	—	12	12

MEETING ROOMS & JUNIOR BALLROOM LEVEL	SIZE		CAPACITY			
	L x W x H	SQ. FT.	BANQUET 72" ROUNDS	RECEPTION	THEATER	CLASSROOM
MEETING ROOMS						
Meeting Room 1	34 x 27 x 12	918	50	90	98	56
Meeting Room 2	34 x 27 x 12	918	50	90	98	60
Meeting Room 3	32 x 29 x 12	928	50	90	105	55
Meeting Room 4	27 x 27 x 12	729	40	75	88	47
Meeting Room 5	33 x 26 x 12	858	50	85	97	52
Meeting Room 6	33 x 29 x 12	957	50	95	105	55
Meeting Room 7	34 x 29 x 12	986	50	95	119	66
Meeting Room 8	32 x 28 x 12	896	50	90	105	62
Meeting Room 9	32 x 28 x 12	896	50	90	105	62
Meeting Room 11	35 x 25 x 12	875	50	85	91	54
Meeting Room 12	35 x 22 x 12	770	50	75	87	51
BOARD ROOM	31 x 28 x 12	868	—	—	—	—

Meeting Rooms & Junior Ballroom Level

THIRD FLOOR

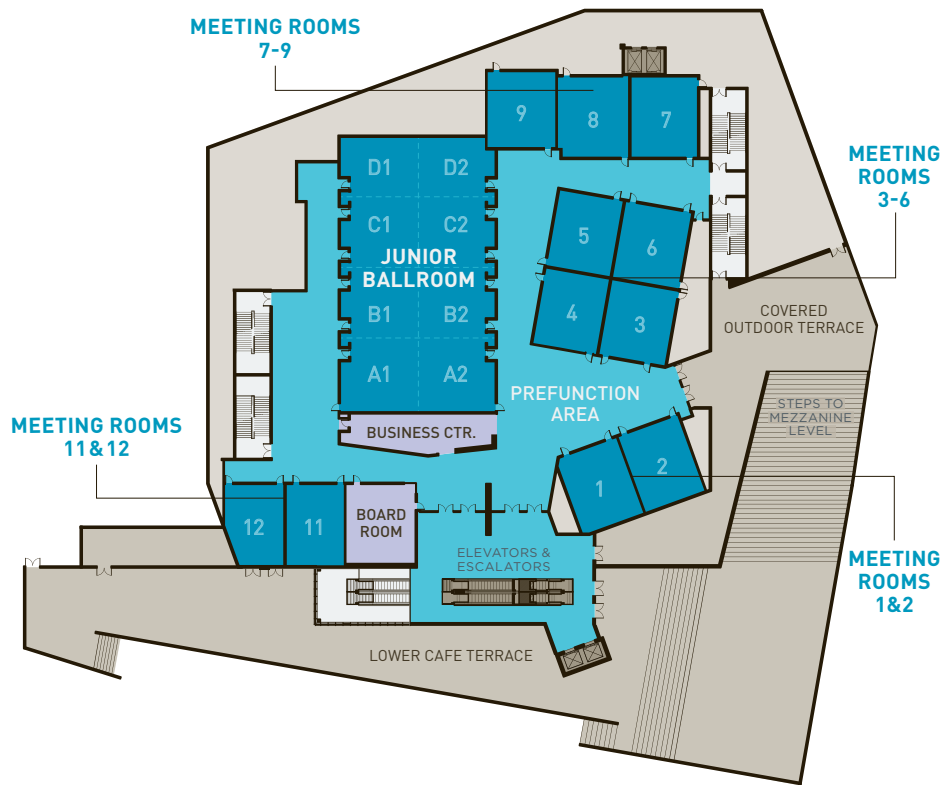

MEETING ROOMS & JUNIOR BALLROOM LEVEL	SIZE		CAPACITY			
	L x W x H	SQ. FT.	BANQUET 72" ROUNDS	RECEPTION	THEATER	CLASSROOM
JUNIOR BALLROOM	120 x 57 x 12	6,840	470	680	702	396
Junior Ballroom A & B	62 x 57 x 12	3,534	230	350	376	186
Junior Ballroom C & D	57 x 57 x 12	3,249	200	325	338	162
Junior Ballroom A, B & C	92 x 57 x 12	5,244	370	525	588	318
Junior Ballroom B, C & D	87 x 57 x 12	4,959	350	500	520	270
Junior Ballroom A	57 x 33 x 12	1,881	140	180	200	102
Junior Ballroom B	57 x 30 x 12	1,710	90	170	156	90
Junior Ballroom C	57 x 30 x 12	1,710	90	170	156	90
Junior Ballroom D	57 x 27 x 12	1,539	80	150	156	81
Junior Ballroom A1	28 x 33 x 12	924	50	90	123	64
Junior Ballroom A2	28 x 33 x 12	924	50	90	123	64
Junior Ballroom B1	28 x 30 x 12	840	50	85	96	48
Junior Ballroom B2	28 x 30 x 12	840	60	85	96	48
Junior Ballroom C1	28 x 30 x 12	840	60	85	96	48
Junior Ballroom C2	28 x 30 x 12	840	60	85	96	48
Junior Ballroom D1	28 x 27 x 12	756	50	75	84	45
Junior Ballroom D2	28 x 27 x 12	756	50	75	84	45
PREFUNCTION AREA	—	10,976	—	1,100	—	—
COVERED TERRACE	—	5,383	120	540	—	—
LOWER CAFE TERRACE	—	18,862	446	1,900	—	—

Grand Ballroom Level

FOURTH FLOOR

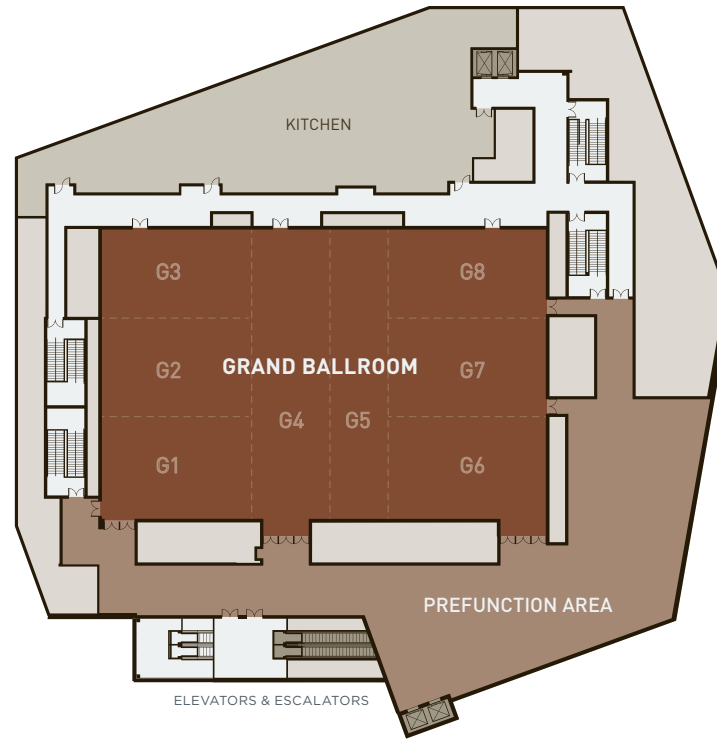

GRAND BALLROOM LEVEL	SIZE		CAPACITY					
	L x W x H	SQ. FT.	BANQUET 72" ROUNDS	RECEPTION	THEATER	CLASSROOM 18" TABLES	8' x 10' BOOTHES	10' x 10' BOOTHES
GRAND BALLROOM	112 x 172 x 24	19,264	1,260	2,000	1,936	1,070	108	86
Grand Ballroom G1-G5	112 x 113 x 24	12,762	800	1,265	1,440	831	—	—
Grand Ballroom G4-G8	112 x 117 x 24	13,153	810	1,310	1,550	840	—	—
Grand Ballroom G1-G4	112 x 86 x 24	9,957	620	965	1,040	570	—	—
Grand Ballroom G5-G8	112 x 86 x 24	9,429	620	965	1,040	570	—	—
Grand Ballroom G1-G3	112 x 55 x 24	6,111	380	615	702	378	—	—
Grand Ballroom G4	112 x 31 x 24	3,724	200	350	350	228	—	—
Grand Ballroom G5	112 x 27 x 24	2,805	—	—	—	—	—	—
Grand Ballroom G4-G5	112 x 58 x 24	6,529	400	650	728	378	—	—
Grand Ballroom G6-G8	112 x 58 x 24	6,624	400	650	728	372	—	—
Grand Ballroom G1	55 x 37 x 24	2,005	130	200	192	105	—	—
Grand Ballroom G2	55 x 38 x 24	2,093	130	210	192	126	—	—
Grand Ballroom G3	55 x 37 x 24	2,013	120	200	192	126	—	—
Grand Ballroom G1-G2	75 x 55 x 24	4,098	250	410	391	261	—	—
Grand Ballroom G2-G3	75 x 55 x 24	4,106	250	410	391	267	—	—
Grand Ballroom G6	58 x 37 x 24	2,250	130	215	216	123	—	—
Grand Ballroom G7	58 x 38 x 24	2,228	130	220	252	132	—	—
Grand Ballroom G8	58 x 37 x 24	2,146	130	215	228	129	—	—
Grand Ballroom G6-G7	75 x 58 x 24	4,478	280	435	487	282	—	—
Grand Ballroom G7-G8	75 x 58 x 24	4,374	280	435	492	282	—	—
PREFUNCTION AREA	—	10,526	300	1,180	—	—	25	20

* MAY BE USED FOR HOSPITALITY OR BACK-OF-HOUSE SERVICE ONLY.